

# NIGHTSTAND

BUILD TIME = 1 DAY | EST. COST TO BUILD = \$100-150 | SKILL LEVEL = BEGINNER

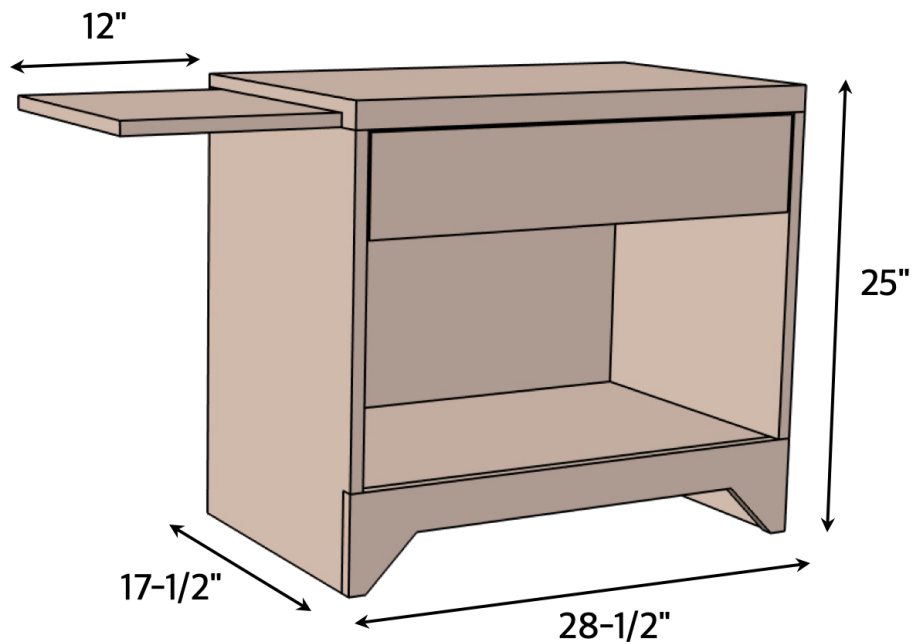

## REQUIRED TOOLS

- ☐ Kreg Pocket Hole Jig
- ☐ Drill/Driver
- ☐ Kreg Track Saw
- ☐ Jig Saw
- ☐ Brad Nailer
- ☐ Tape Measure
- ☐ Pencil
- ☐ Safety Glasses
- ☐ Hearing Protection

## MATERIALS

- ☐ 3/4" x 4' x 8' Plywood Sheet
- ☐ 1/4" x 2' x 4' Plywood Sheet
- ☐ 1 x 2 x 8' Select Pine Board
- ☐ 1 x 4 x 8' Select Pine Board
- ☐ 3/4" Iron On Edge Banding
- ☐ 2" Iron On Edge Banding
- ☐ 1-1/4" Pocket Screws
- ☐ 1-1/4" Brad Nails
- ☐ 1-1/4" Wood Screws
- ☐ Wood Glue

# CUT LIST

## 3/4" x 4' x 8' Plywood

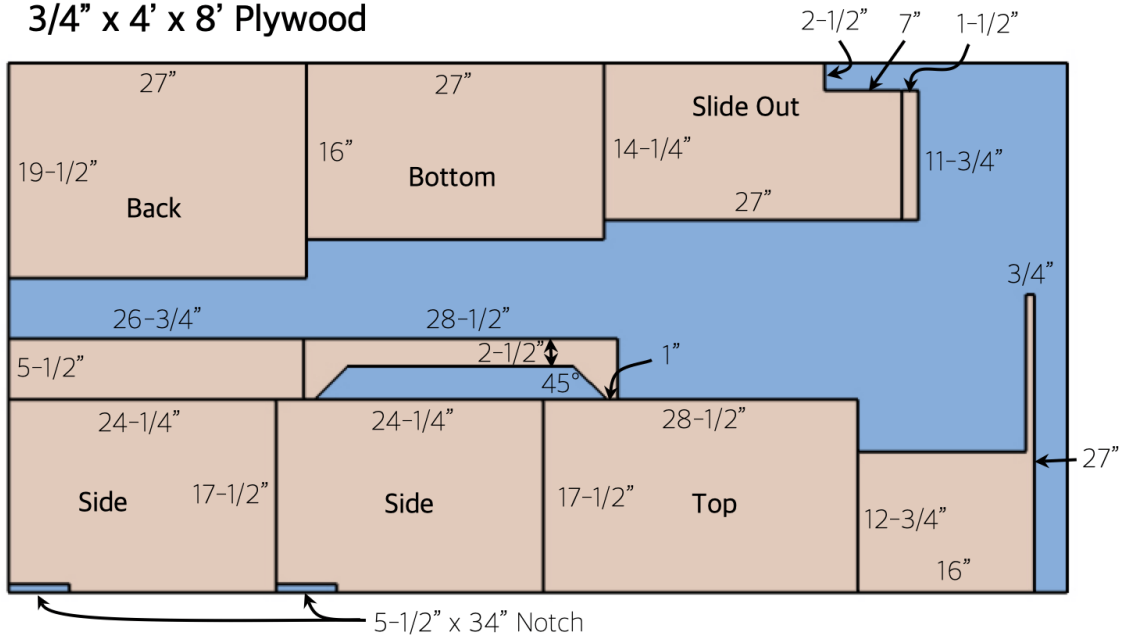

## 1 x 2 x 8' Board

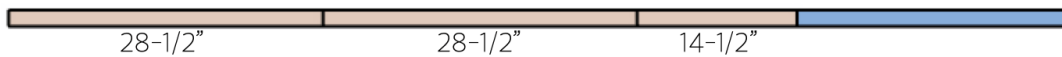

## 1 x 4 x 8' Board

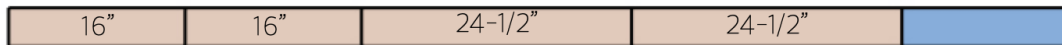

## 1/4" x 2' x 4' Plywood

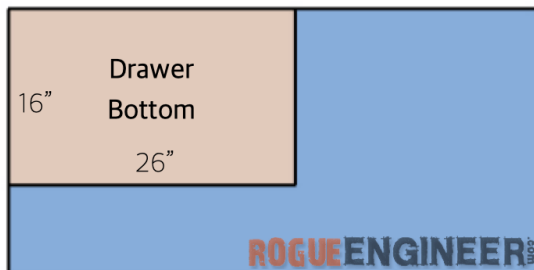

STEP  
1

Drill pocket holes and  
assemble base with  
1-1/4" pocket screws

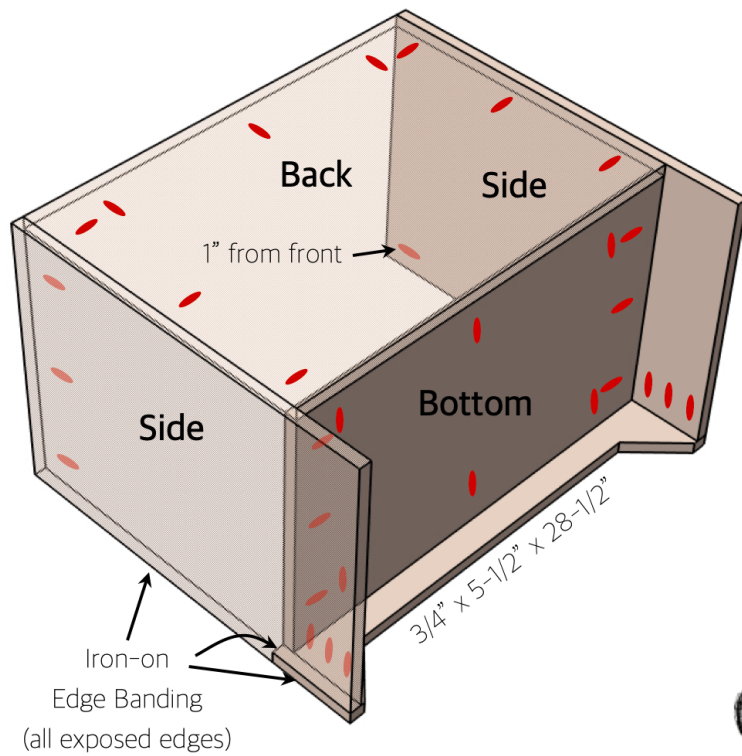

STEP  
2

Attach 1x2s to top  
using **wood glue** and  
1-1/4" brad nails

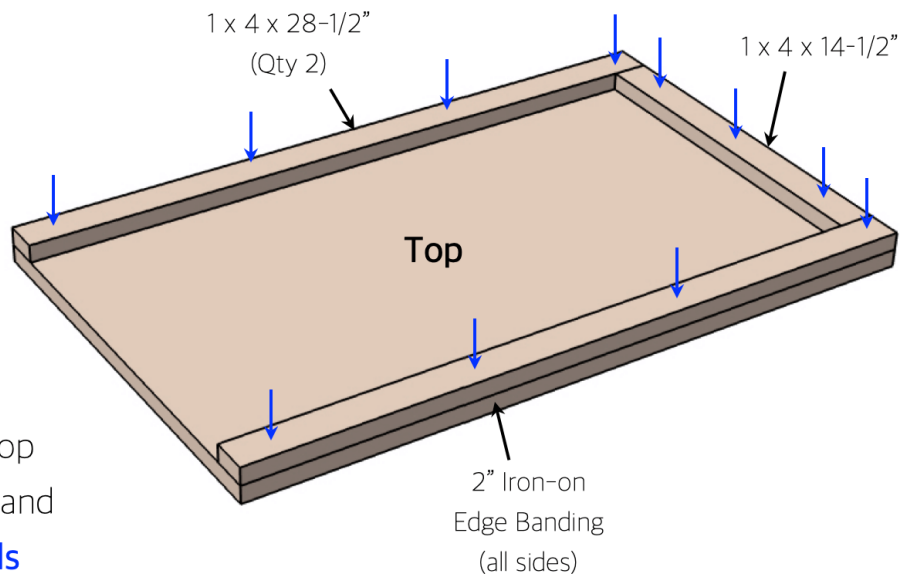

STEP  
3

Attach base to top with  
1-1/4" pocket screws

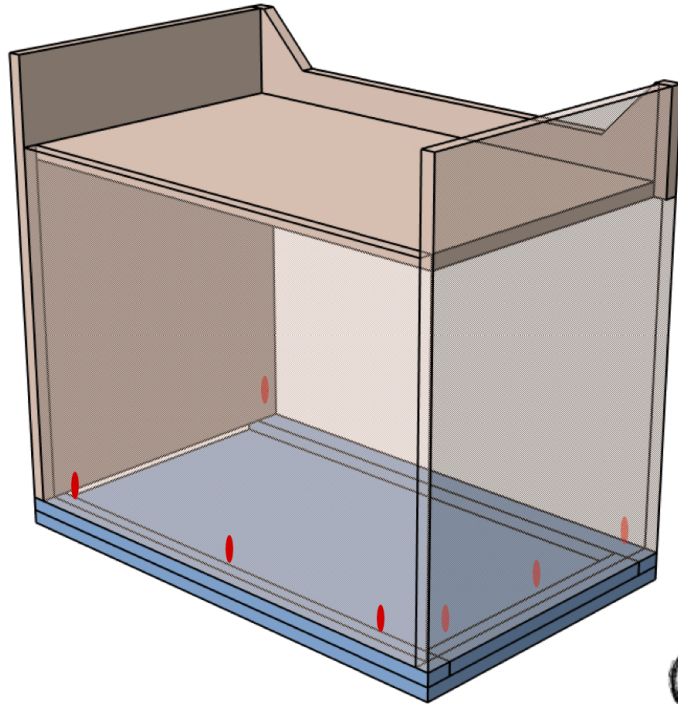

STEP  
4

Attach slide out  
support using  
wood glue and  
1-1/4" brad nails.

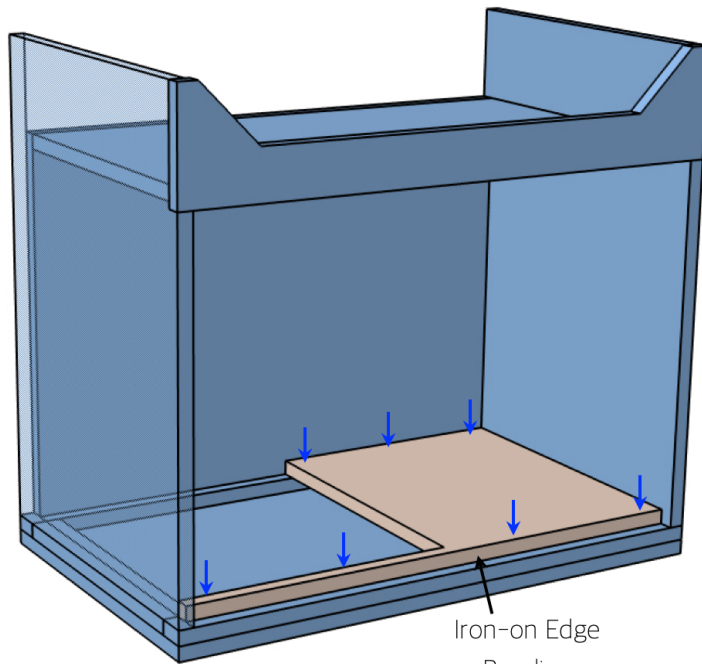

## STEP 5

Insert slide out and attach stop with **1-1/4" wood screws**.  
If desired, cut hole in top and back for flush mount outlets

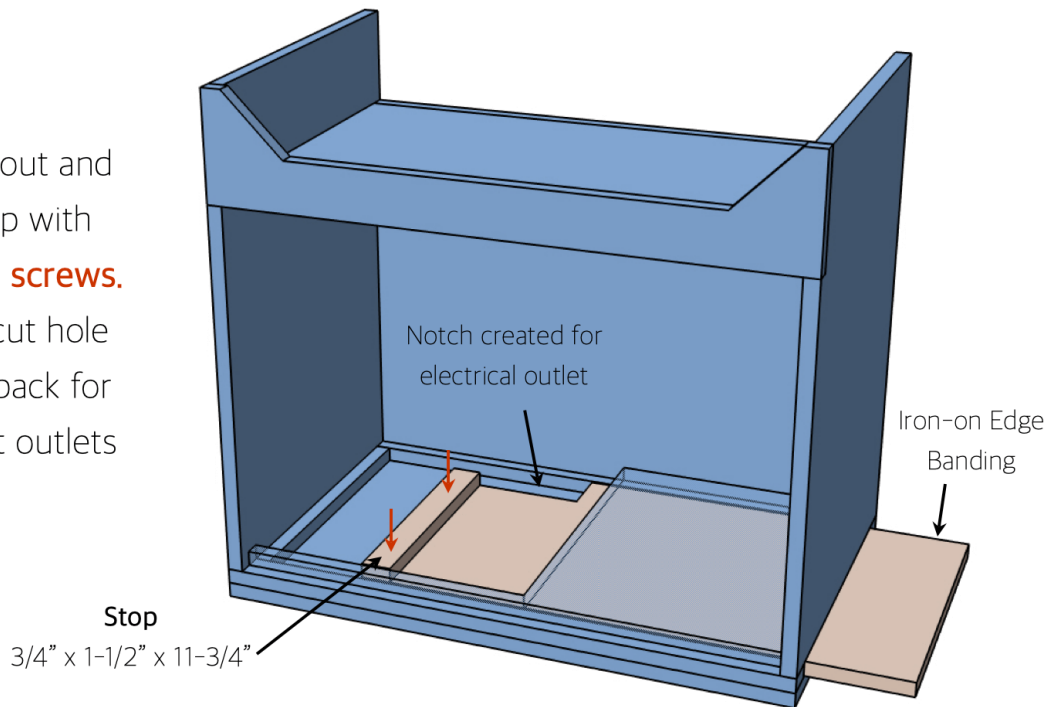

## STEP 6

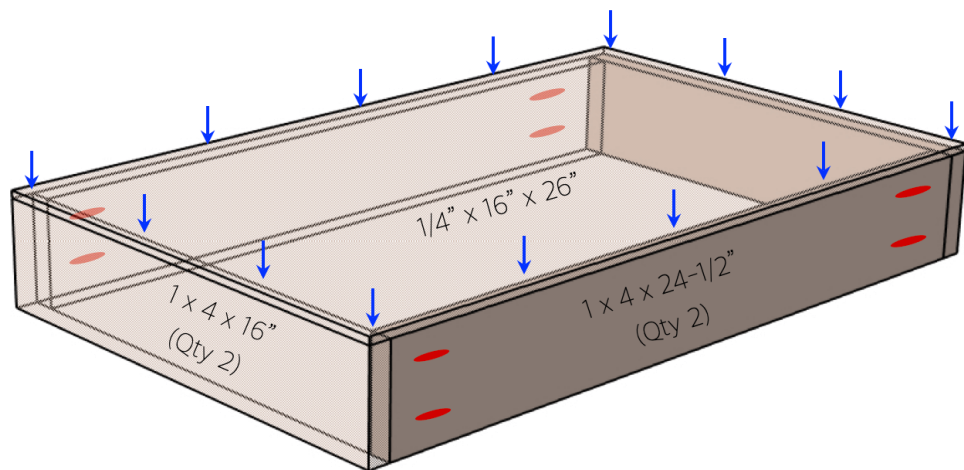

**Drill pocket holes** and assemble drawer box with **wood glue**,  
**1-1/4" pocket screws**, and **1-1/4" brad nails**



STEP  
7

Install drawer using  
**16" drawer slides** and  
included hardware.  
The Kreg drawer slide  
jig will help with  
installation.

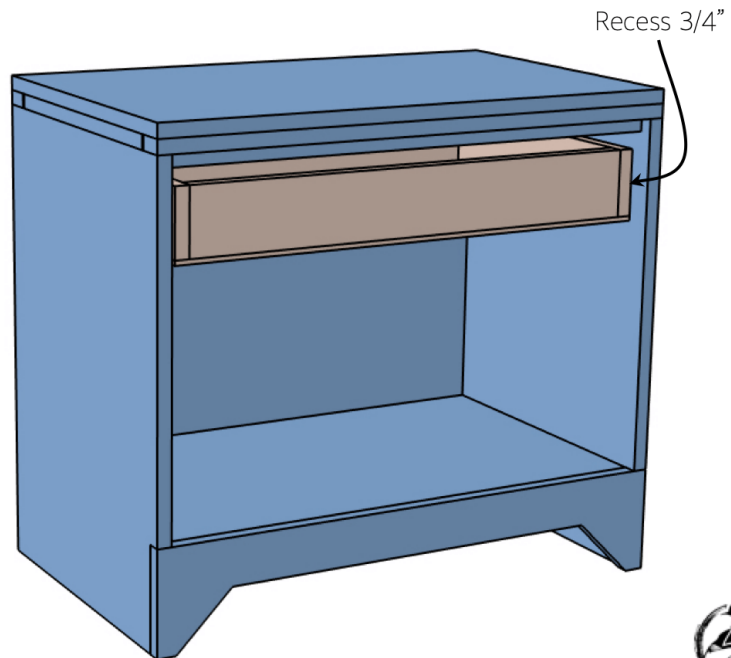

STEP  
8

Install drawer front  
and pulls as desired.  
Pull for slide out will  
require an **8-32 x 1"**  
**hanger bolt.**

