

Charleston Crafted

DIY BUILT-IN DRESSER WITH CUBBIES

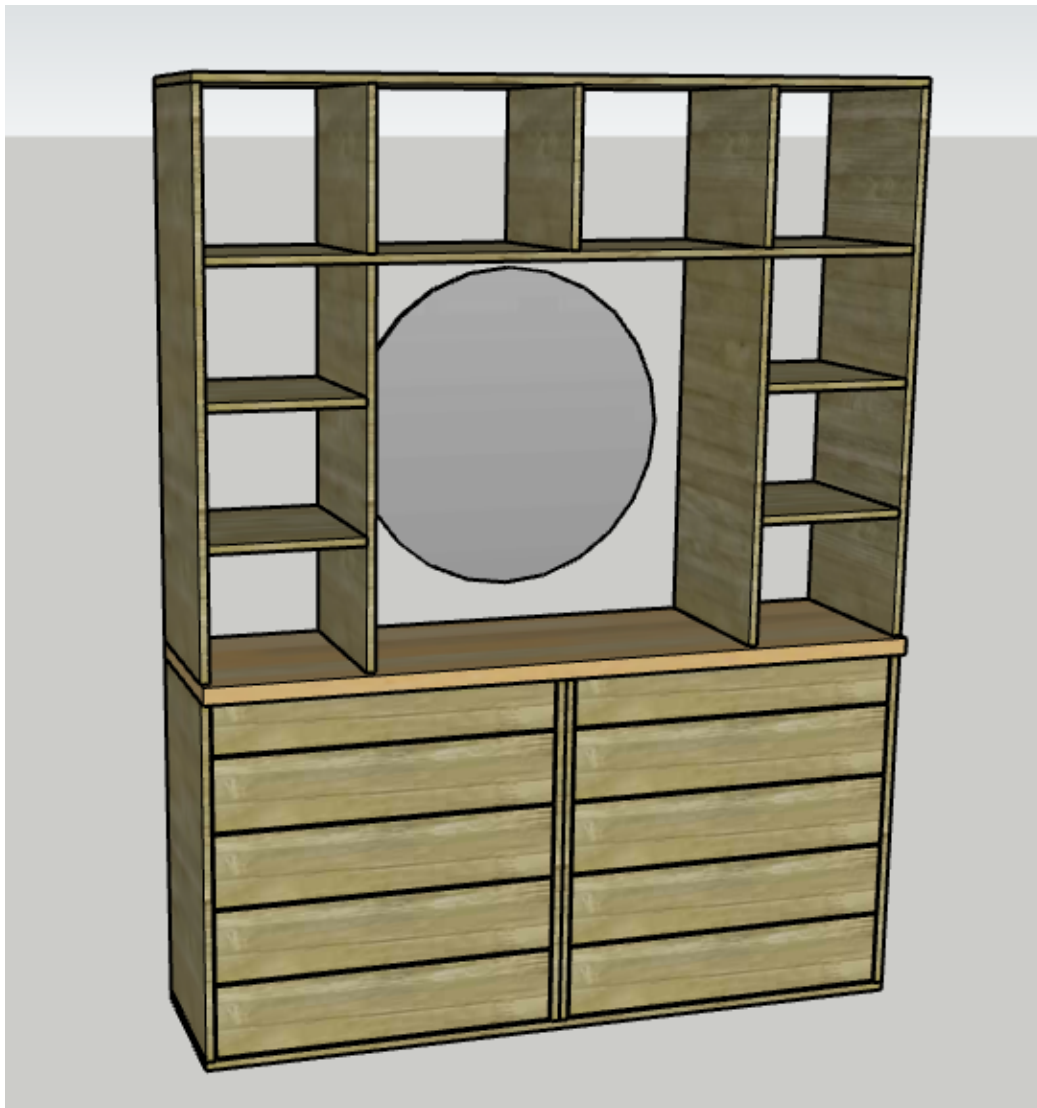

PLANS CREATED BY CHARLESTON CRAFTED

FOR MORE INFORMATION ON THIS PLAN VISIT:
WWW.CHARLESTONCRAFTED.COM

INTRODUCTION

Have the perfect space in your closet for a built in dresser vanity with loads of storage? Look no further than this plan. After you build this project, you'll have 10 drawers, cubbies for storage and a great work surface with room for a mirror.

The plans are easy to follow, but please contact Sean@CharlestonCrafted.com if you have any questions! If you'd like to see our version live in action, check out our blog post at www.charlestoncrafted.com

SUPPLY LIST

- (3) 4' x 8' x 3/4" plywood
- (1) 4' x 8' x 1/4" plywood
- (2) 1 1/2" x 3 1/2" x 8' boards
- (1) 6' butcher block (or 1 additional sheet of plywood)
- (1) 6" baseboard
- (10) sets of 14" drawer slides
- (10) Drawer pulls of choice
- Wood glue
- 1 1/4" pocket hole screws
- 1" brad nails

CUT LIST

Drawer Cuts

- (4) Skinny Drawer Sides- 3 1/2 x 14 1/2" x 3/4"
- (4) Skinny Drawer Front/Back- 3 1/2 x 14 1/2" x 3/4"
- (2) Skinny Drawer Faces- 4 1/4 x 29 1/4" x 3/4"
- (16) Drawer Sides- 5 1/2 x 14 1/2" x 3/4"
- (16) Drawer Front/Back- 5 1/2 x 14 1/2" x 3/4"
- (8) Drawer Faces- 6 1/4 x 29 1/4" x 3/4"
- (10) Drawer Bottoms- 28 5/8 x 14 1/2" x 1/4"

Dresser Cuts

- (1) Dresser Bottom- 62 1/4" x 15 1/2" x 3/4"
- (2) Dresser Dividers- 30 3/4" x 15 1/2" x 3/4"
- (2) Dresser Sides- 30 3/4" x 15 1/2" x 3/4"
- (1) Dresser Top- 60 1/4" x 16 1/2" x 1 1/2"

Cubby Cuts

- (2) Cubby Outsides- 46 3/4" x 15 1/2" x 3/4"
- (1) Cubby Top- 62 1/4" x 15 1/2" x 3/4"
- (1) Upper Cubby Bottom- 60 3/4" x 15 1/2" x 3/4"
- (2) Side Cubby Insides- 33" x 15 1/2" x 3/4"
- (7) Cubby Dividers- 13" x 15 1/2" x 3/4"

2x4 Base Cuts

- (2) Front and Back Base- 1 1/2" x 3 1/2" x 62 1/4"
- (4) Base Middle Supports- 1 1/2" x 3 1/2" x 12 1/2"

STEP ONE- ASSEMBLE 2X4 BASE

- Drill two pocket holes on each 3 1/2" end of the Base Middle Supports.
- Using wood glue and pocket hole screws, attach two Base Middle Supports to the inside of the Front and Back Bases, all the way flush with the edges.
- Attach the remaining two Base Middle Supports the same way, spread evenly between the others.

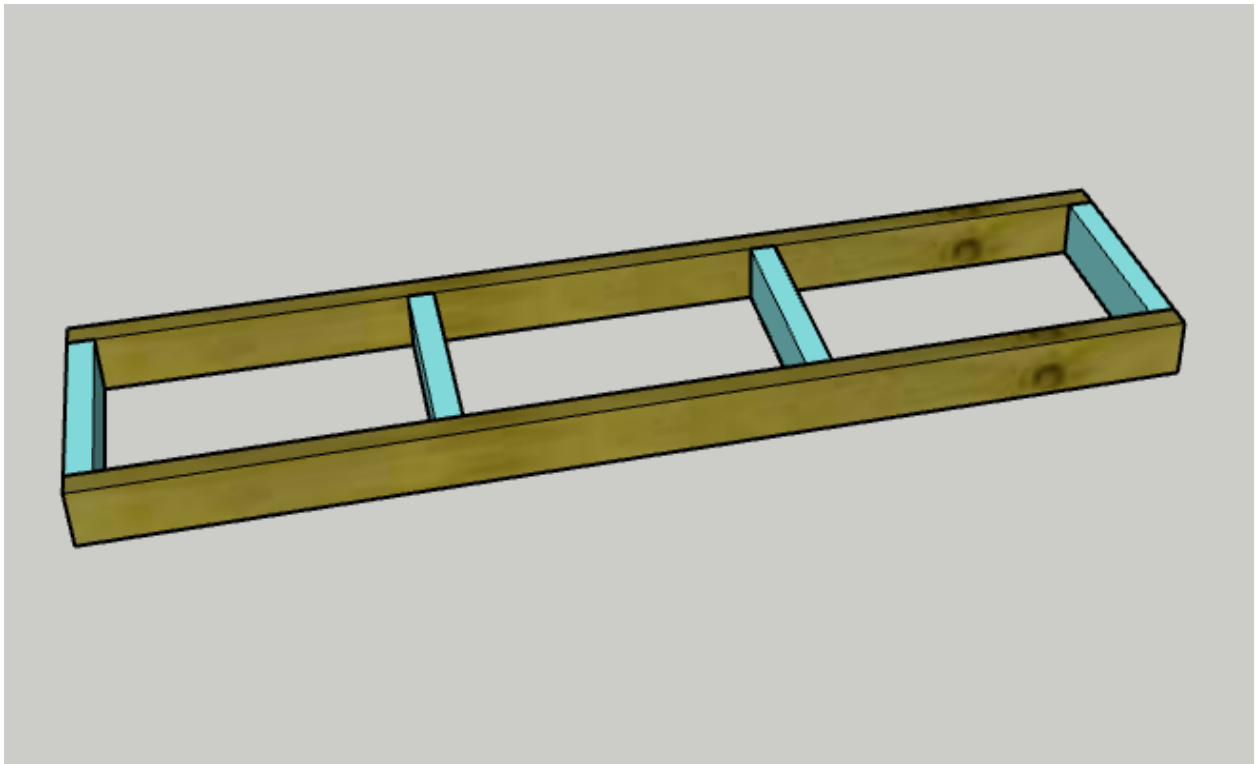

STEP TWO- ASSEMBLE DRESSER BODY

- Drill two pocket holes on each 15 1/2" side of the Dresser Sides and Dresser Dividers.
- Using wood glue and nails, attach the Dresser Bottom to the 2x4 base created in step one.
- Using wood glue and pocket hole screws, attach the two Dresser Sides on the top of the Dresser Bottom, all the way flush with the edges.
- Use wood glue and clamps to attach the two Dresser Dividers together with the pocket holes facing out.
- Using wood glue and pocket hole screws, attach the Dresser Dividers to the Dresser Bottom at the center point.

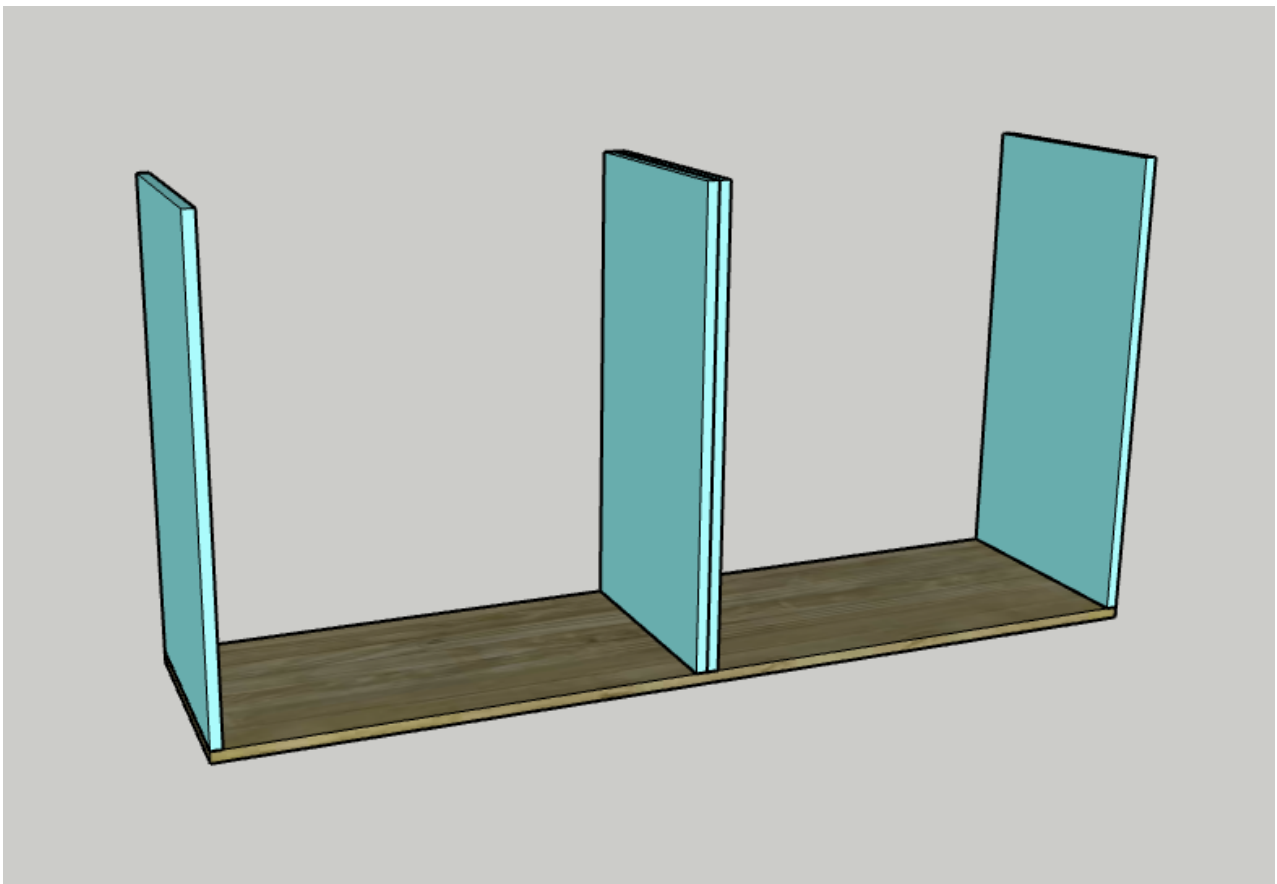

STEP THREE- ATTACH BUTCHER BLOCK TOP

- If you don't have access to a butcher block slab, glue two pieces of 3/4" plywood together with the dimensions listed in the cut list.
- Using wood glue and pocket hole screws, attach the Dresser Top to the base unit.
- Attach with pocket hole screws on the two Dresser Sides and two Dresser Dividers.



STEP FOUR- BUILD SKINNY DRAWERS

- Drill two pocket holes in each 3 1/2" end of the Skinny Drawer Fronts/Backs.
- Using wood glue and pocket hole screws, attach two Skinny Drawer Front/Back pieces to the inside of two Skinny Drawer Sides to form a rectangle.
- Using wood glue and 1" brad nails, attach a Drawer Bottom to the underside of the drawer box.
- Using wood glue and clamps, attach a Skinny Drawer Face to the front of the drawer box, flush along the bottom and centered on the drawer.
- Repeat for a second skinny drawer.

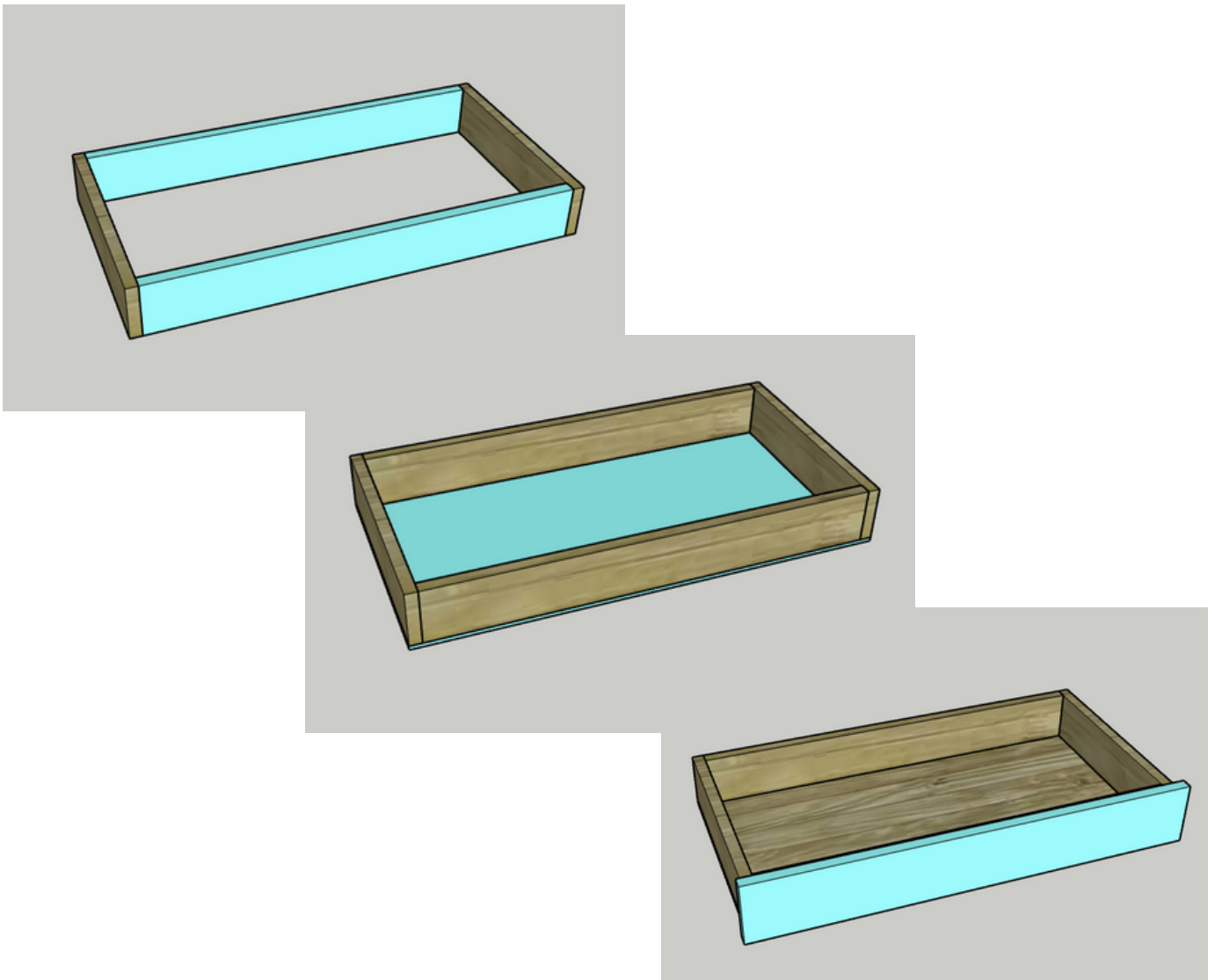

STEP FIVE- BUILD DRAWERS

- Drill two pocket holes in each 5 1/2" end of the Drawer Fronts/Backs.
- Using wood glue and pocket hole screws, attach two Drawer Front/Back pieces to the inside of two Drawer Sides to form a rectangle.
- Using wood glue and 1" brad nails, attach a Drawer Bottom to the underside of the drawer box.
- Using wood glue and clamps, attach a Skinny Drawer Face to the front of the drawer box, flush along the bottom and centered on the drawer.
- Repeat for seven more drawers.

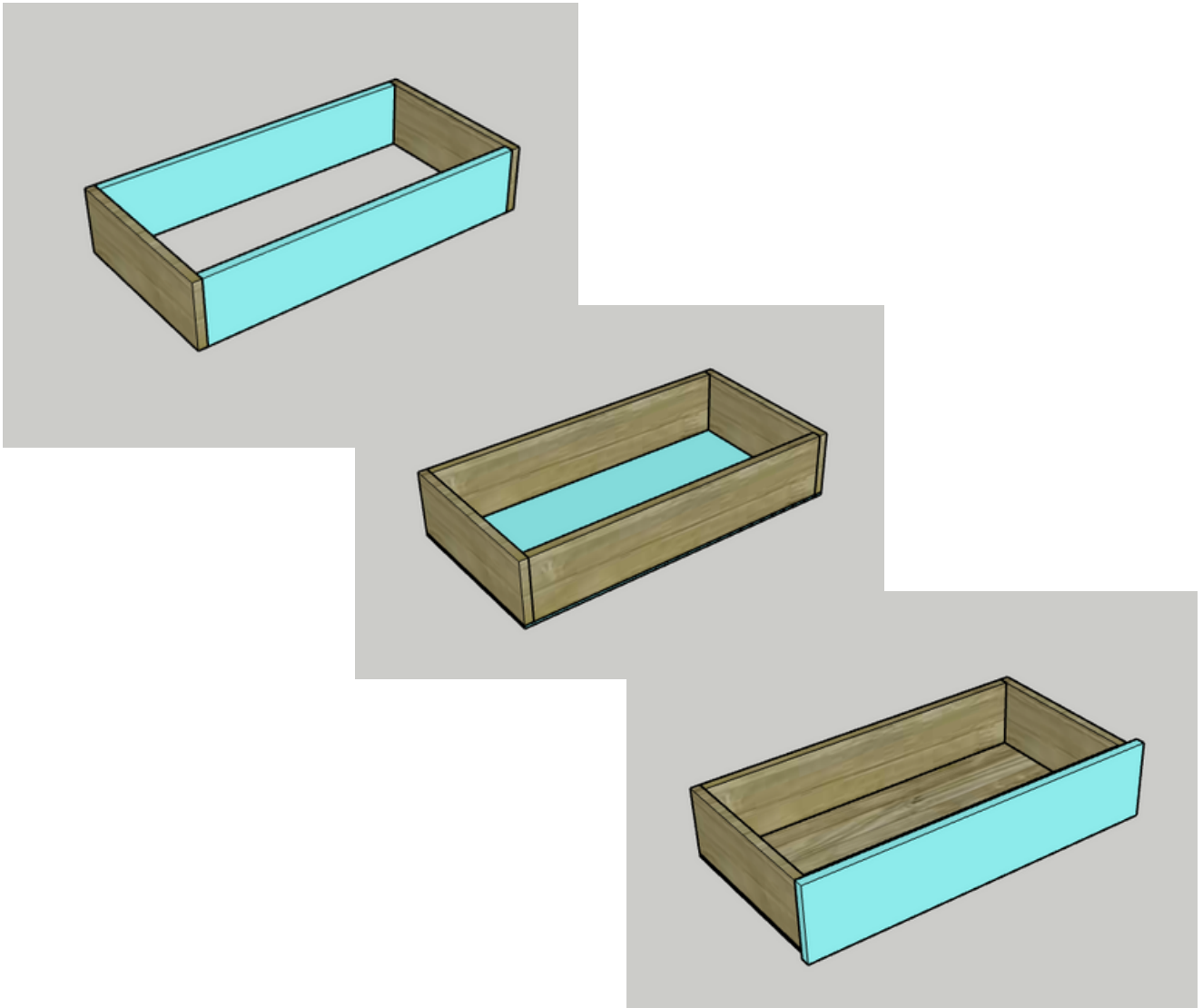

STEP SIX- INSERT DRAWERS

- Insert drawer slides into base of the dresser and align with drawer boxes. There should be 1/4" gap at the top and bottom of each side and between each drawer.

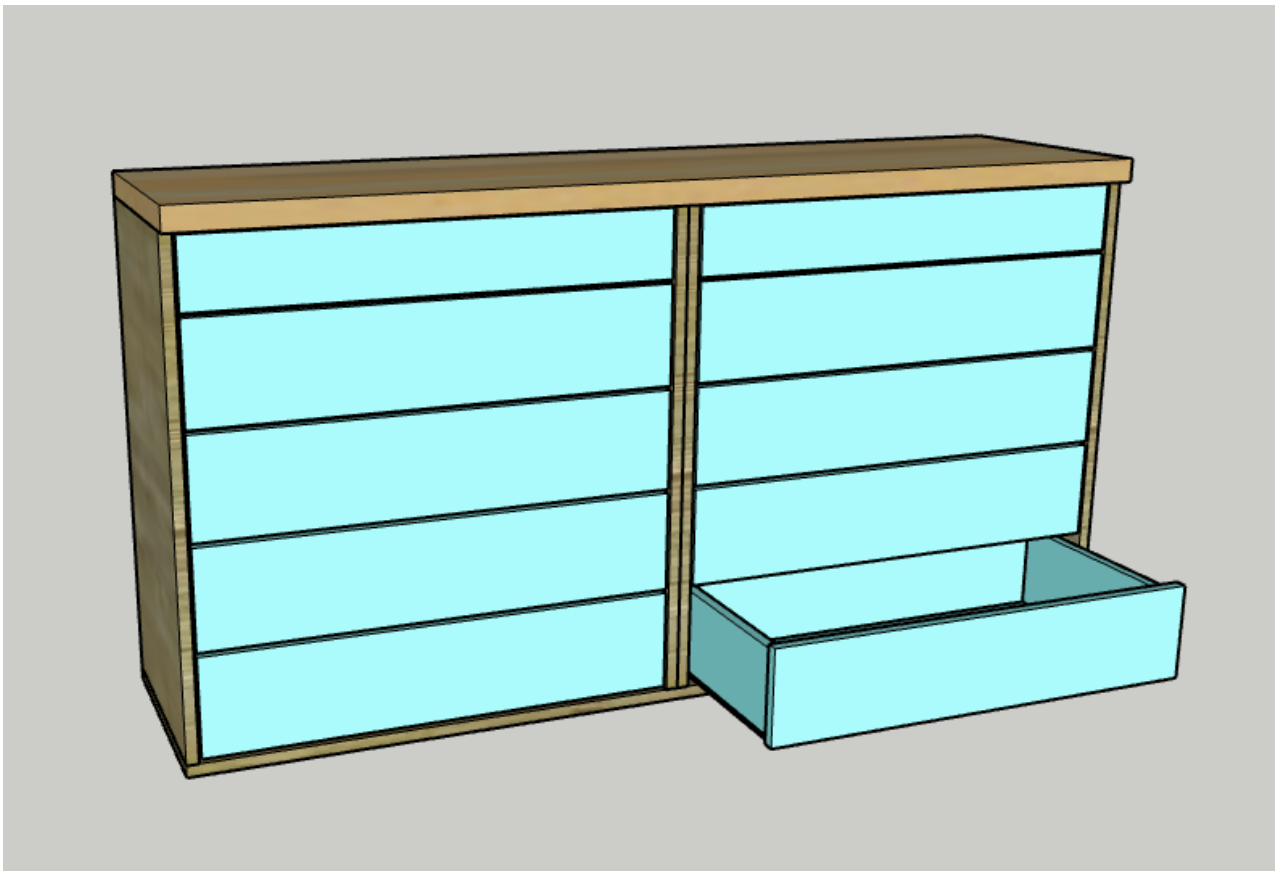

STEP SEVEN- ASSEMBLE UPPER CUBBIES

- Drill two pocket holes into each 15 1/2" end of the Cubby Outsides, Upper Cubby Bottom, and three Cubby Dividers.
- Using wood glue and pocket hole screws, attach the Cubby Outsides to the Cubby Top flush on the edge.
- Using wood glue and pocket hole screws, attach two Cubby Dividers to the underside of the Cubby Top with 13" from each Cubby Outside.
- Using wood glue and pocket hole screws, attach the remaining Cubby Divider centered between the other two, with approximately 16 1/4" between each.
- Using wood glue and pocket hole screws, attach the Upper Cubby Bottom to the dividers and sides.

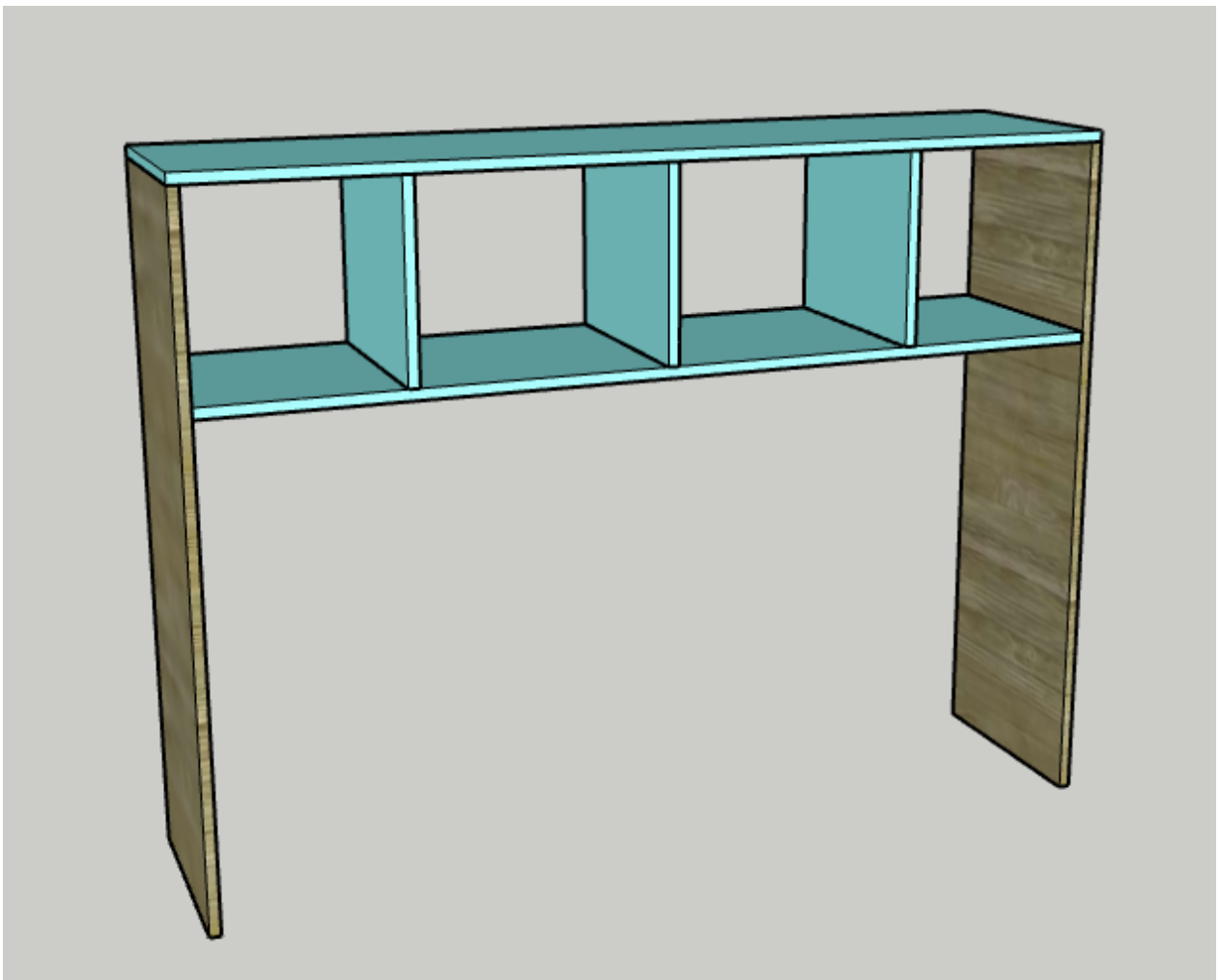

STEP EIGHT- ASSEMBLE SIDE CUBBIES

- Drill two pocket holes into each 15 1/2" end of the Side Cubby Insides and four remaining Cubby Dividers.
- Using wood glue and pocket hole screws, attach the two Side Cubby Insides to the underside of the Upper Cubby Bottom, 13" from the Cubby Outsides and aligned directly underneath the Cubby Dividers above.
- Using wood glue and pocket hole screws, attach two Cubby Dividers to the Side Cubby Insides and Cubby Outsides with 13" in between.
- Repeat for the other side.

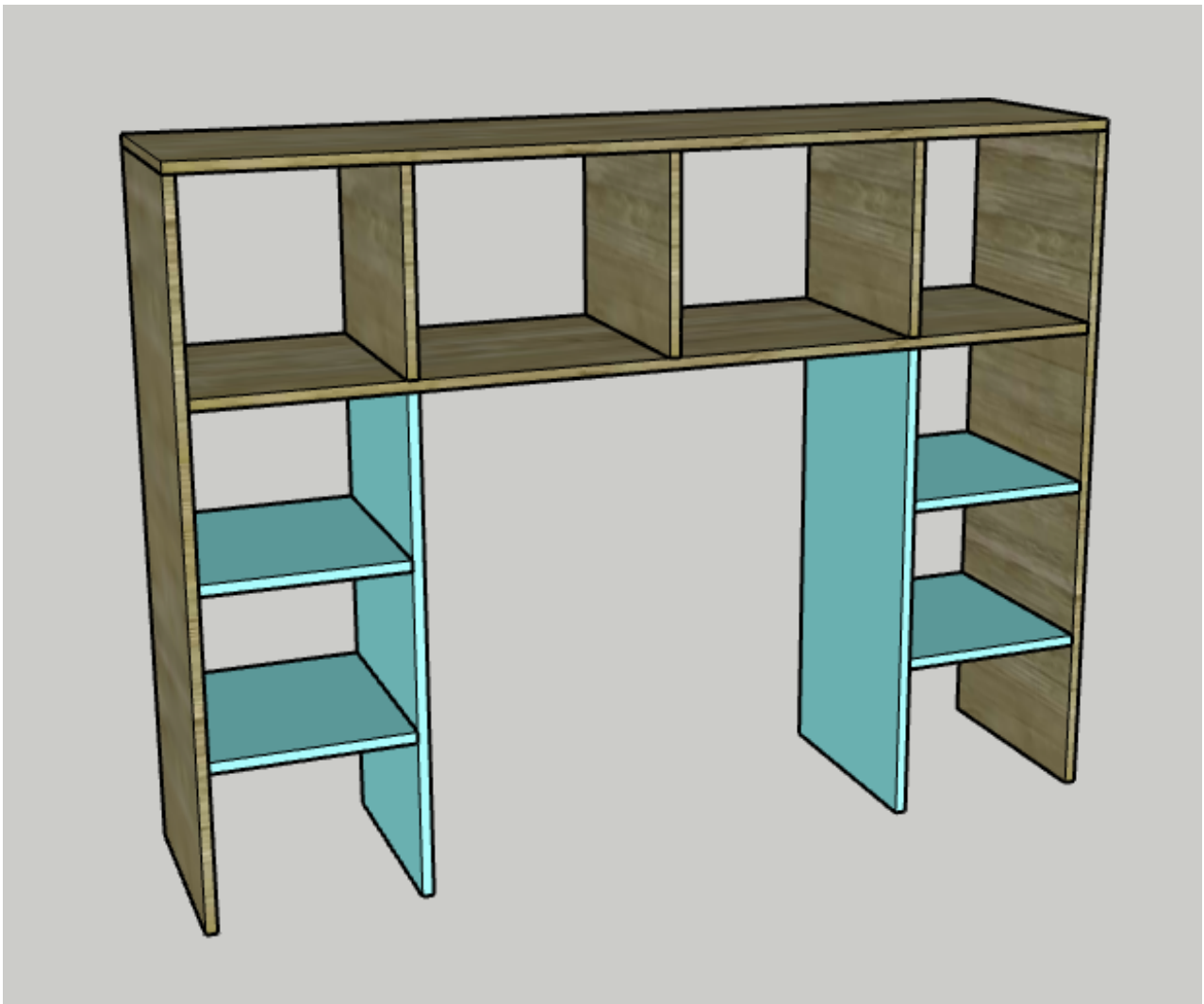

STEP NINE- ATTACH CUBBIES TO BASE

- Using wood glue and pocket hole screws, attach the cubby unit to the Dresser Top. It should be flush on the outside and back of the Dresser Top.
- Add a piece of baseboard molding across the bottom to cover the 2x4 base.
- Ensure the unit is attach to the studs in the wall for safety purposes, using brackets.



STEP TEN- ACCESSORIZE

- Fill the drawers and cubbies to your heart's content.
- Add a mirror up to 28" in diameter between the cubbies.

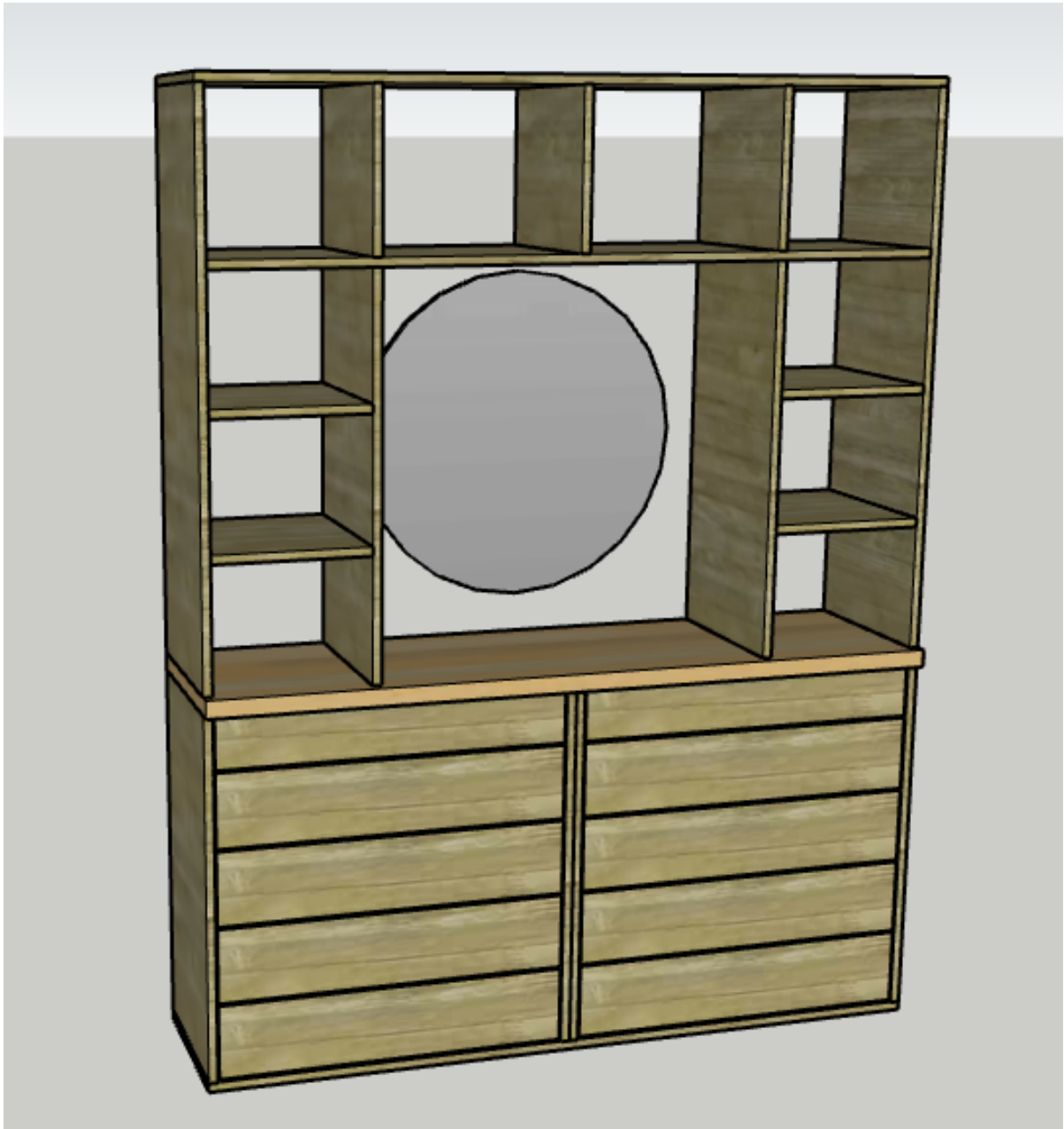

FINAL STEP- ENJOY!

- Enjoy your handiwork and tag @CharlestonCrafted on Instagram with a picture!

Charleston
Crafted