

Charleston Crafted

ROLLING VERTICAL SCRAP WOOD STORAGE



PLANS CREATED BY CHARLESTON CRAFTED

FOR MORE INFORMATION ON THIS PLAN VISIT:

WWW.CHARLESTONCRAFTED.COM

INTRODUCTION

If you have scrap wood piling up all around you, you need this rolling vertical scrap wood storage station. This is the perfect scrap wood storage system because it includes racks for laying long pieces of boards, cubbies for shorter cutoffs, and space for leaning plywood.

The plans are easy to follow, but please contact Sean@CharlestonCrafted.com if you have any questions! If you'd like to see our version live in action, check out our blog post at www.charlestoncrafted.com

SUPPLY LIST

- (1)- 4' x 8' x 3/4" plywood sheet
- (7)- 8' 2x4s
- (4)- 3" locking casters
- 1 1/4" Kreg pocket hole screws
- 2 1/2" Kreg pocket hole screws
- Wood glue

CUT LIST

- (1) Base- 72" x 24" x 3/4"
- (1) Plywood Edge- 72" x 3" x 3/4"
- (5) Vertical Posts- 60" x 3 1/2" x 1 1/2"
- (1) Horizontal Post- 72" x 3 1/2" x 1 1/2"
- (20) Racks- 12" x 3 1/2" x 1 1/2"
 - 10 degree angle on one end
- (1) Cubby Back- 72" x 9 1/2" x 3/4"
- (4) Cubby Sides- 11 1/4" x 9 1/2" x 3/4"

STEP ONE- ATTACH CASTERS

- Attach casters to the underside of the Base.

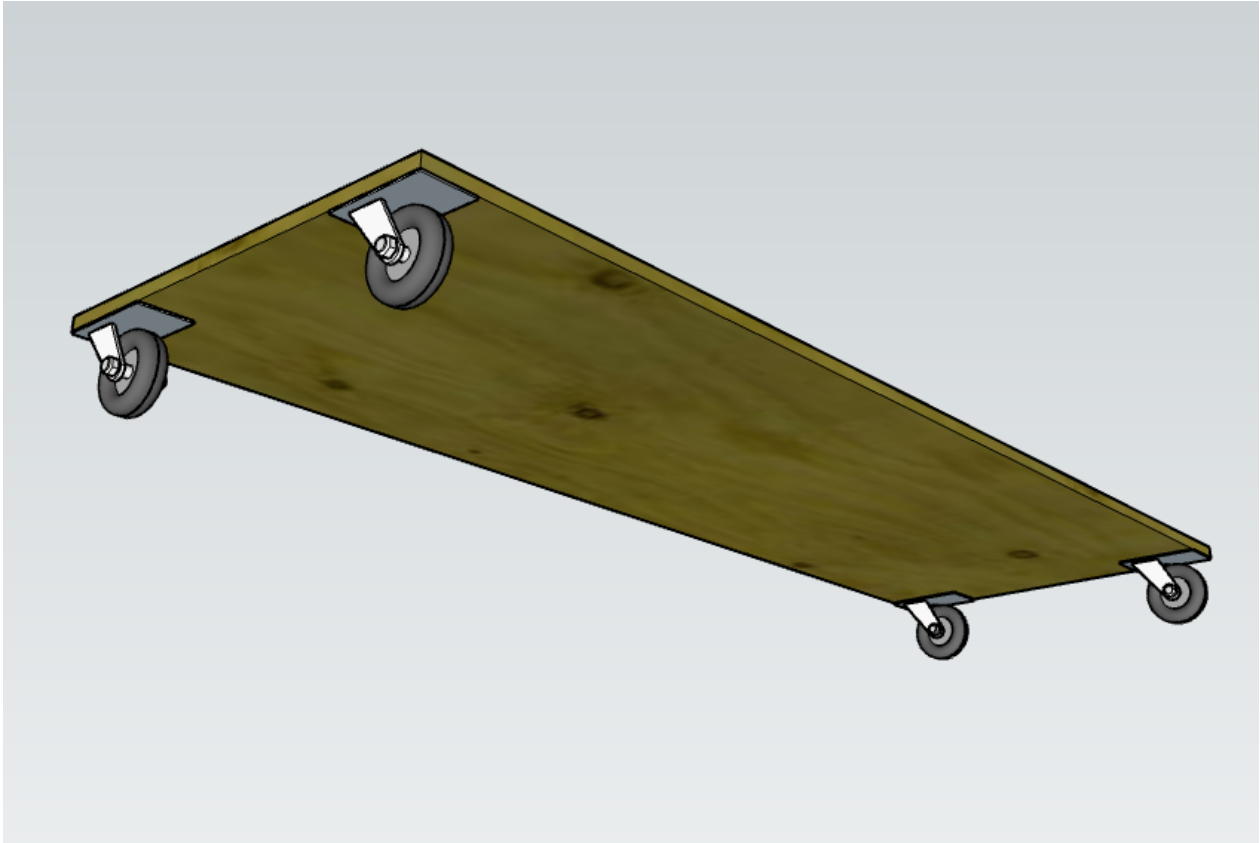

STEP TWO- ATTACH PLYWOOD EDGE

- Drill five pocket holes along one long side of the Plywood Edge.
- Using wood glue and pocket screws, attach the Plywood Edge along one side of the Base.

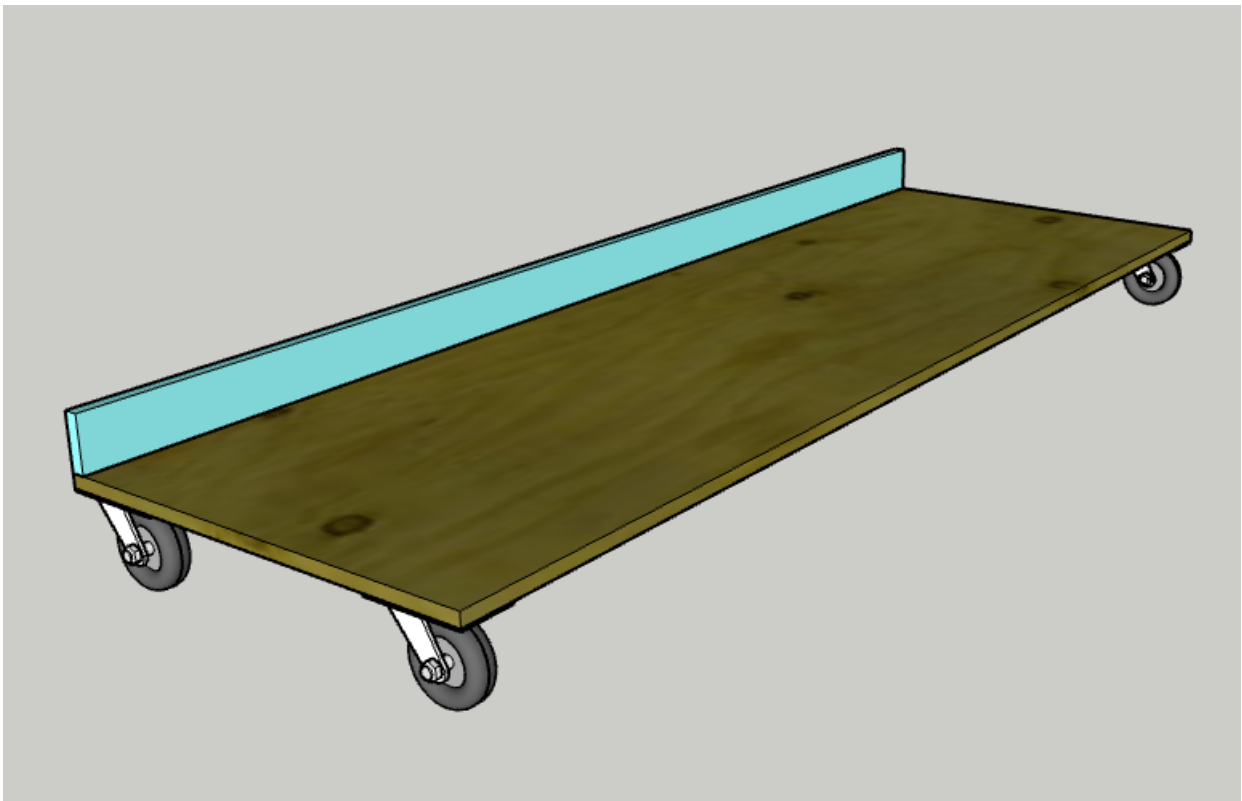

STEP THREE- ATTACH SCRAP CUBBIES

- Drill five pocket holes along one long side of the Cubby Back.
- Using wood glue and pocket screws, attach the Cubby Back to the Base 11 1/4" from the edge.
- Drill two pocket holes on one 9 1/2" and one 11 1/4" side of each Cubby Side.
- Using wood glue and pocket screws, attach two of the Cubby Sides on the far edges of the Base and the other two Cubby Sides spaced out depending on your needs.

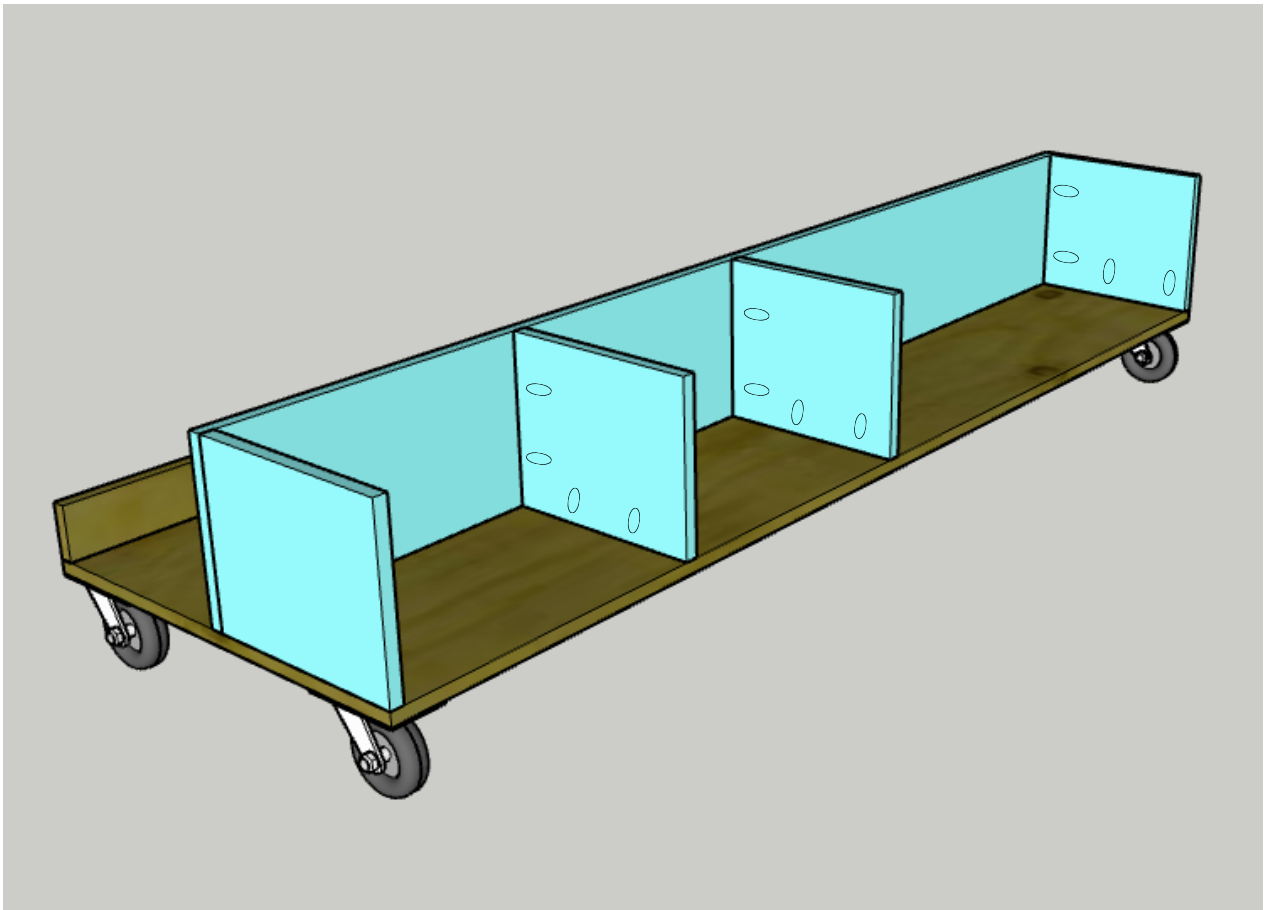

STEP FOUR- ATTACH VERTICAL BEAMS

- On each of the Vertical Posts, drill two 3/4" pocket holes on one end and two 1 1/2" pocket holes on the other end.
- Using wood glue and pocket screws, attach the Vertical Posts to the Horizontal Post with the 1 1/2" pocket hole side. Attach one Vertical Post on each end, one in the middle and the other two spaced evenly between.
- Using wood glue and pocket screws, attach the five Vertical Posts to the Base flush along the back of the Cubby Back.
- Insert a 2" screw through Cubby Back into each Vertical Post for added stability.

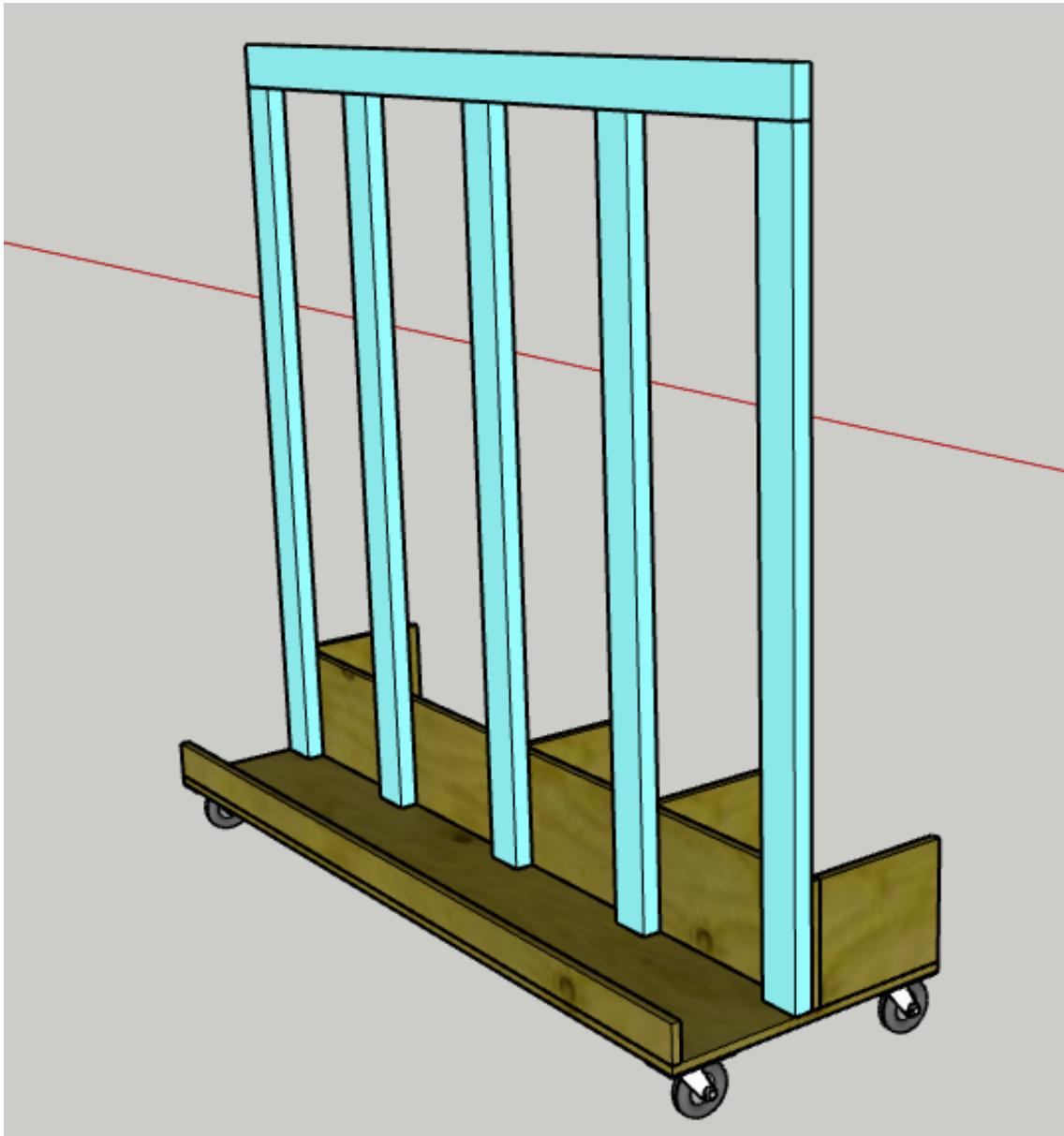

STEP FIVE- ATTACH RACKS

- Drill two pocket holes on the angled end of each of the 20 Racks.
- Using wood glue and pocket screws, attach the first five Racks into the Vertical Posts along the top edge of the Cubby Back.
- Using a Rack as a spacer, continue to attach each Rack up each Vertical Post.

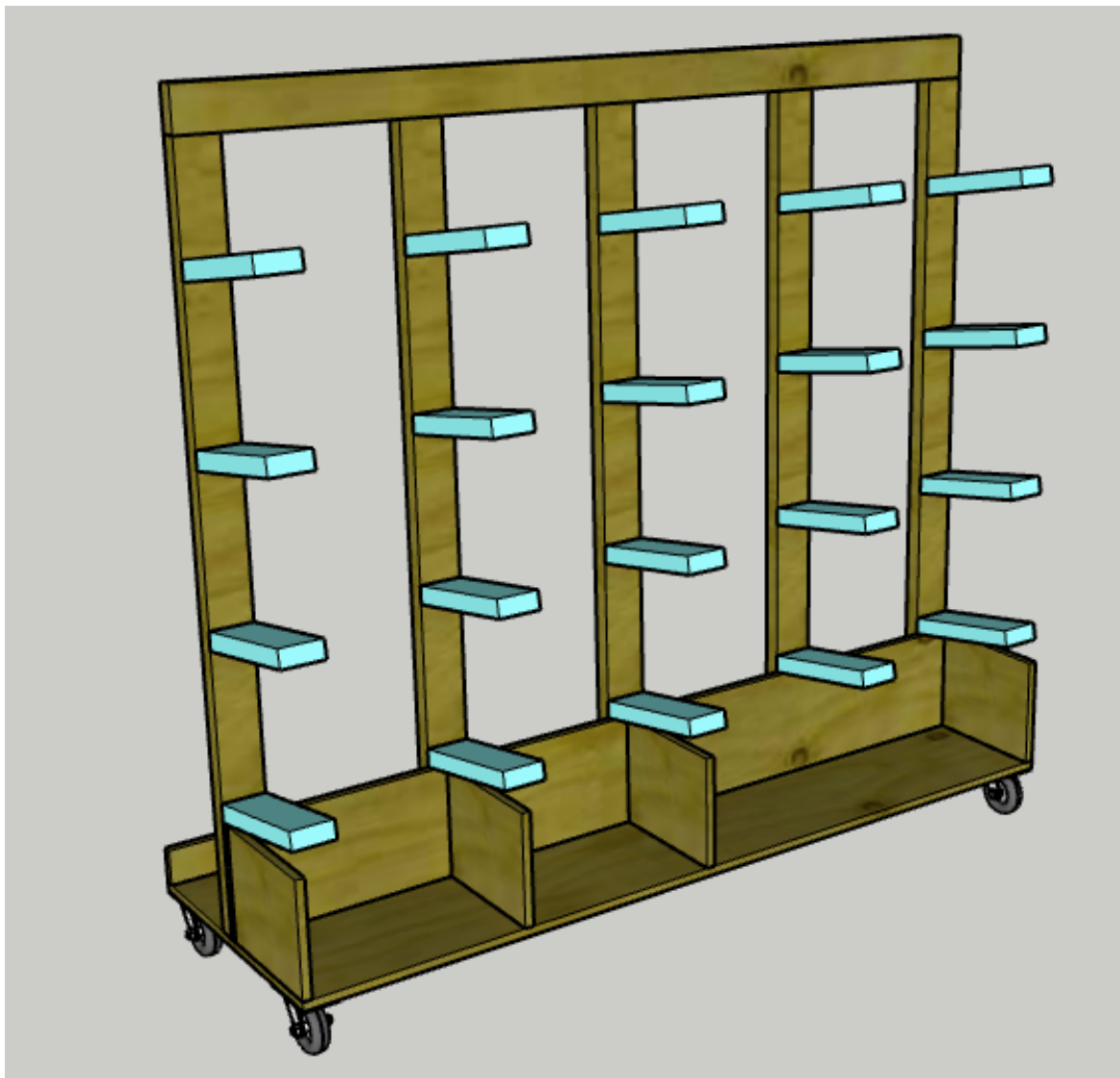

STEP SIX- LOAD IT UP

- Load in all your wood. Place long boards along the racks, small scraps in the cubbies, and lean plywood on the back side.



FINAL STEP- ENJOY!

- Enjoy your handiwork and tag @CharlestonCrafted on Instagram with a picture!

Charleston
Crafted