

Rolling Mirror Bathroom Wall Cabinet

Difficulty

Advanced

Elevate a simple wall cabinet into something amazing by swapping traditional doors for rolling round mirrors. Use this cabinet for a unique medicine cabinet, vanity mirror, or over the toilet organization. A perfect, modern storage solution for any room.





Tools

Kreg Tools



Other Tools

- Jigsaw
- Miter Saw
- Square
- Tape Measure
- Clamps
- Drill (cordless)
- Glue Gun
- Router
- Sander
- Workbench
- Router Circle Jig

Materials

Wood Products

- 1** Board , 1x12 , 96"
- 1** Board , 1x6 , 36"
- 2** Board , 1x4 , 72"
- 1** Plywood , 1/4" Thick , Quarter Sheet
- 2** Square Dowel , 3/4" X 3/4" , 36"

Hardware & Supplies

- 2** 16" Diameter Mirror
- 24** 1-1/4" Pocket Hole Screws
- 50** 1-1/4" 18 Gauge Brad Nails
- 1** Wood Glue

Cut List & Parts

- 2 Sides , 3/4" X 9" X 18-5/8"
- 2 Top & Bottom , 3/4" X 8-1/4" X 28"
- 1 Shelf , 3/4" X 5-1/2" X 28"
- 1 Plywood Panel , 1/4" X 17-5/8" X 28-1/2"
- 2 Center Rails , 3/4" X 3/4" X 28"
- 2 Fame Frame , 3/4" X 1-1/2" X 28"

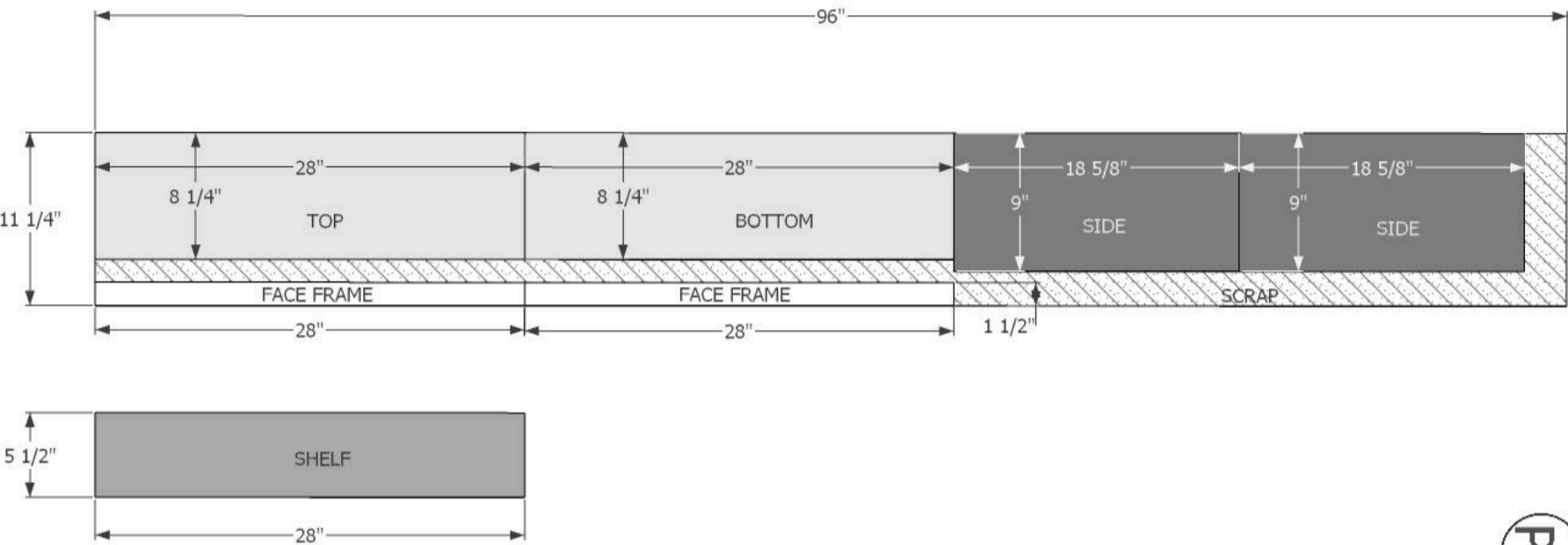

Directions

1

Cut boards and Gooves

Following the cut diagram, use a Kreg Accu-Cut and circular saw or table saw to cut your box pieces to size from a 1 x 12 x 96" and a 1 x 6 x 36" board.

Cut two at 8-1/4" x 28"

Cut two at 9" x 18-5/8"

Cut one at 5-1/2" x 28"

Grooves need to be cut into the top, bottom and sides to accommodate a 1/4" inset plywood panel. This can be done by taking multiple passes using the Kreg Accu-Cut guide track and a circular saw, on a table saw, or by using a router and 1/4" straight cutting bit.

Cut 1/4" x 1/4" grooves along the length of the side pieces, 3-1/4" from the front edge of the board. Cut a 1/4" x 1/4" groove along the length of the top and bottom pieces, but stop 1/4" from either end. Do not cut through the ends of the board.

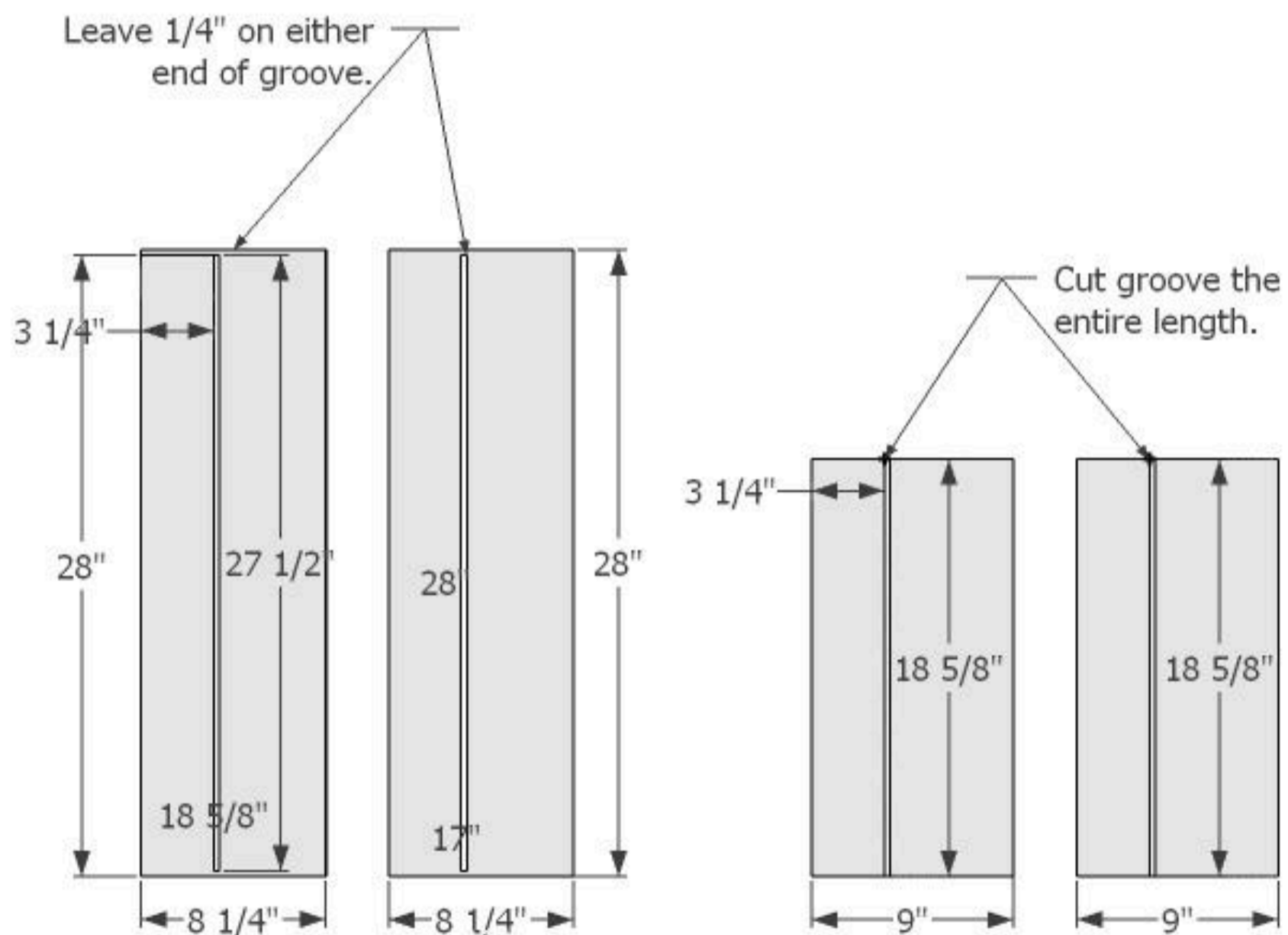

2

Assemble Mirror Frames

Cut 12 trapezoids from 1 x 4 boards, 30 degrees off of square, the longest side measuring 10-1/2".

For each frame: Align 6 trapezoids in a hexagon shape. Measure the exact length between two parallel pieces and cut a scrap piece of wood to fit between them. Apply glue to all adjoining faces and clamp together to create a hexagon.

Allow to dry overnight.

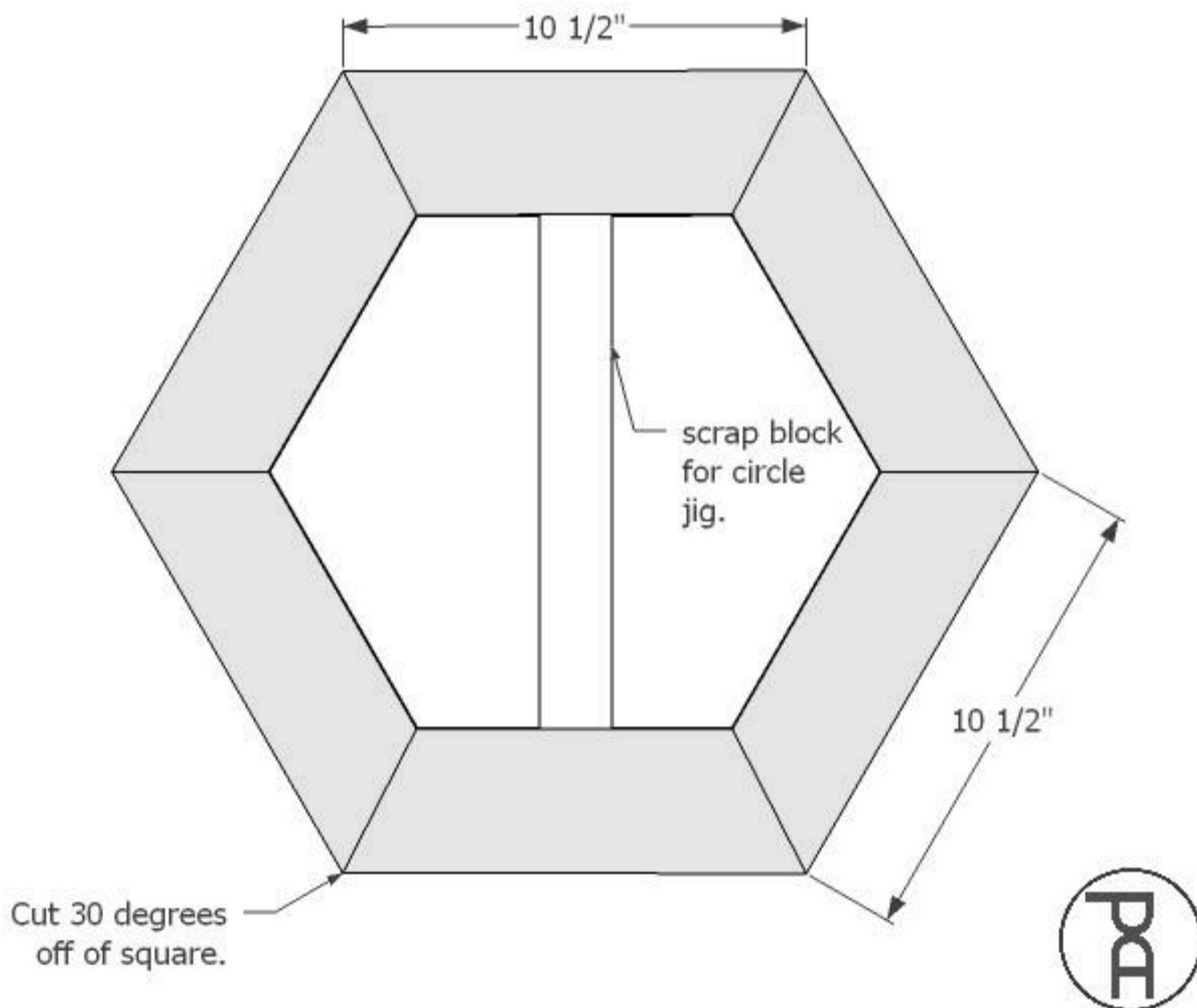

3

Cut Mirror Frames

Using a router and circle jig, bandsaw, or jigsaw, cut a $\frac{3}{4}$ " wide ring with an outer diameter of 17" and an inner diameter of $15\frac{1}{2}$ ".

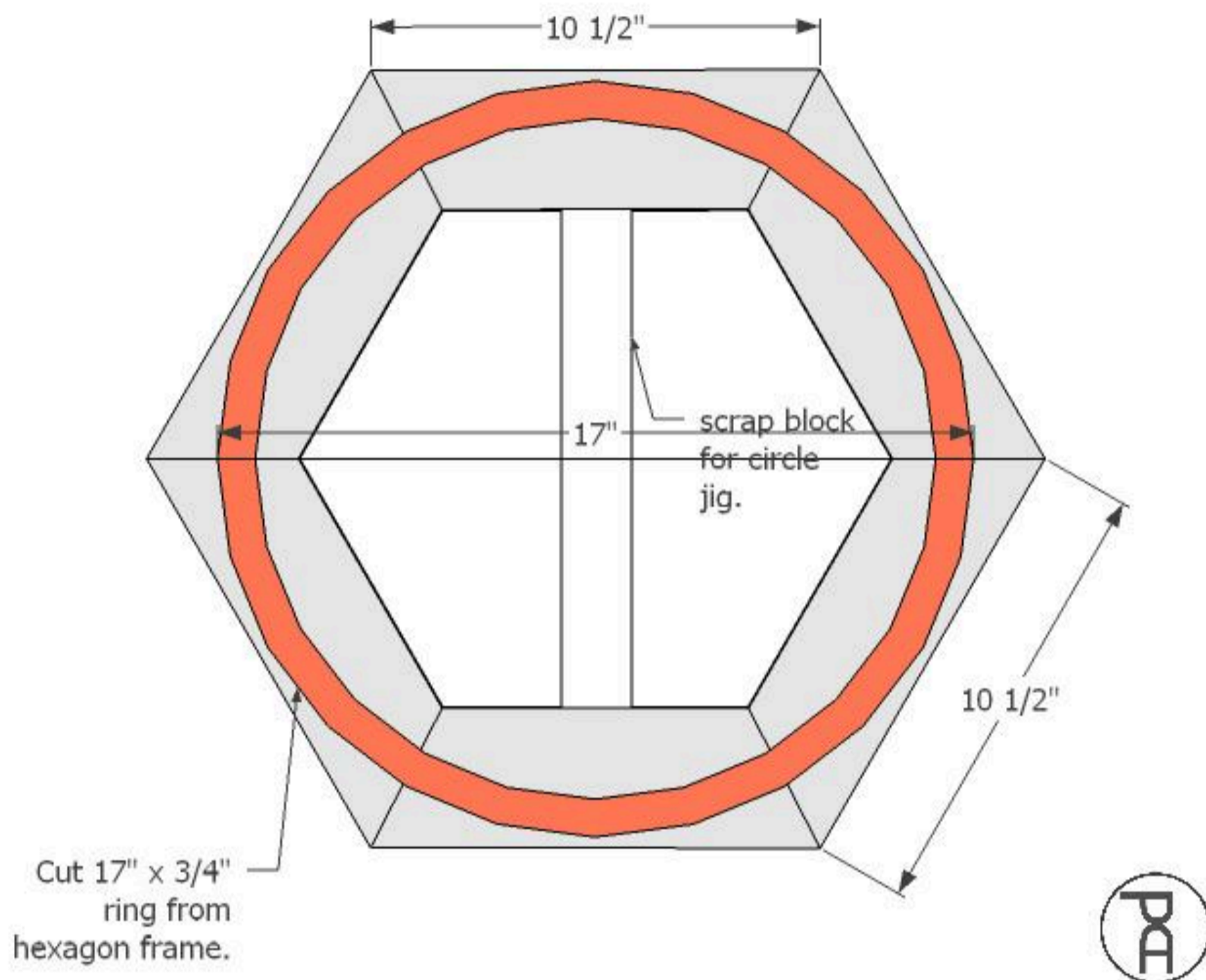

4**Cut Rabbet**

Use a router to cut a 3/8" wide by 1/4" deep rabbet on the inside rim of the mirror frame ring.

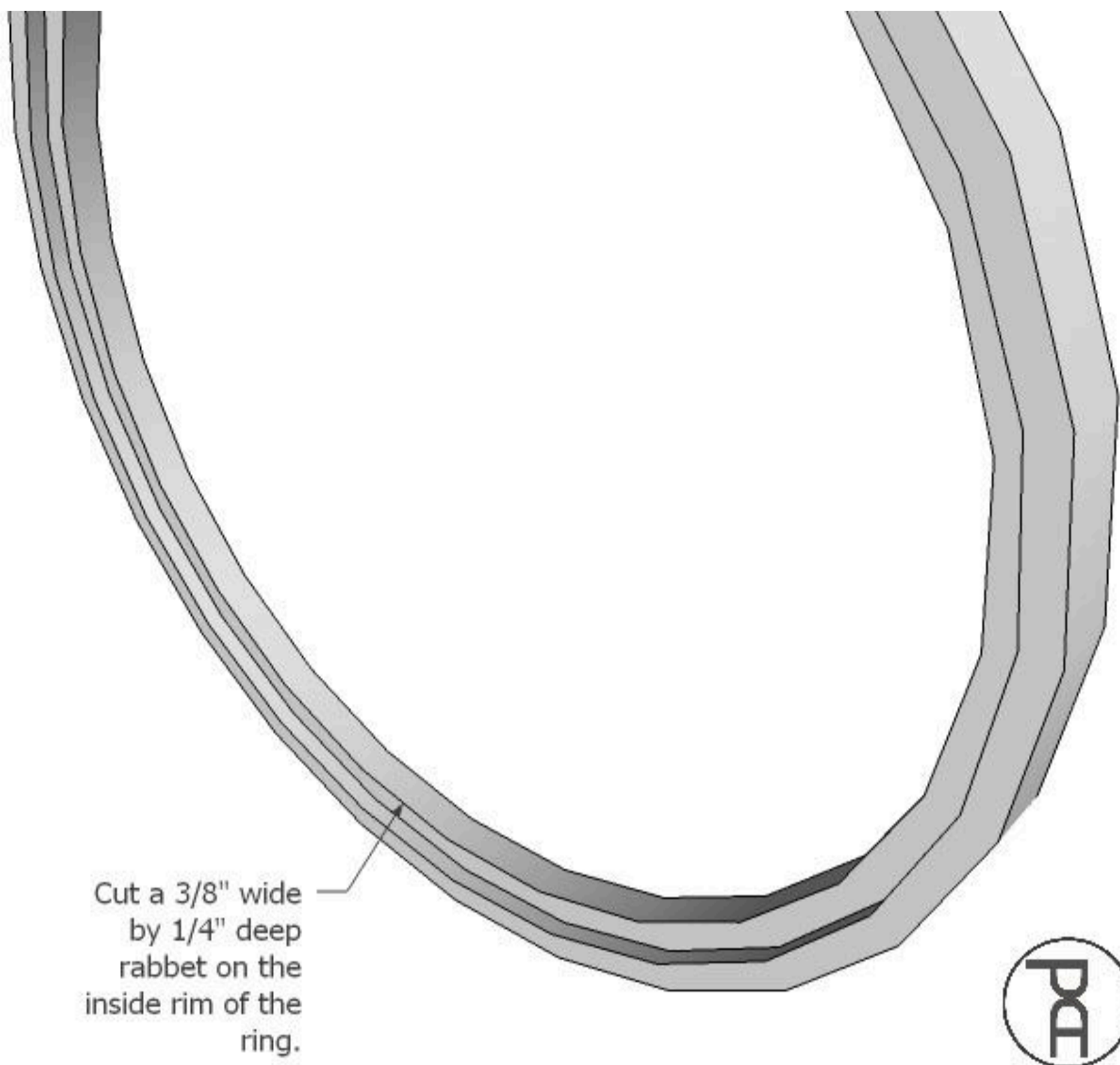

5

Add Mirror to Frame

Sand and apply finish to both mirror frame rings and allow to dry. Inside each each frame, place a 16" diameter, 1/8" thick mirror within the rabbet. Secure in place using hot glue around edges.

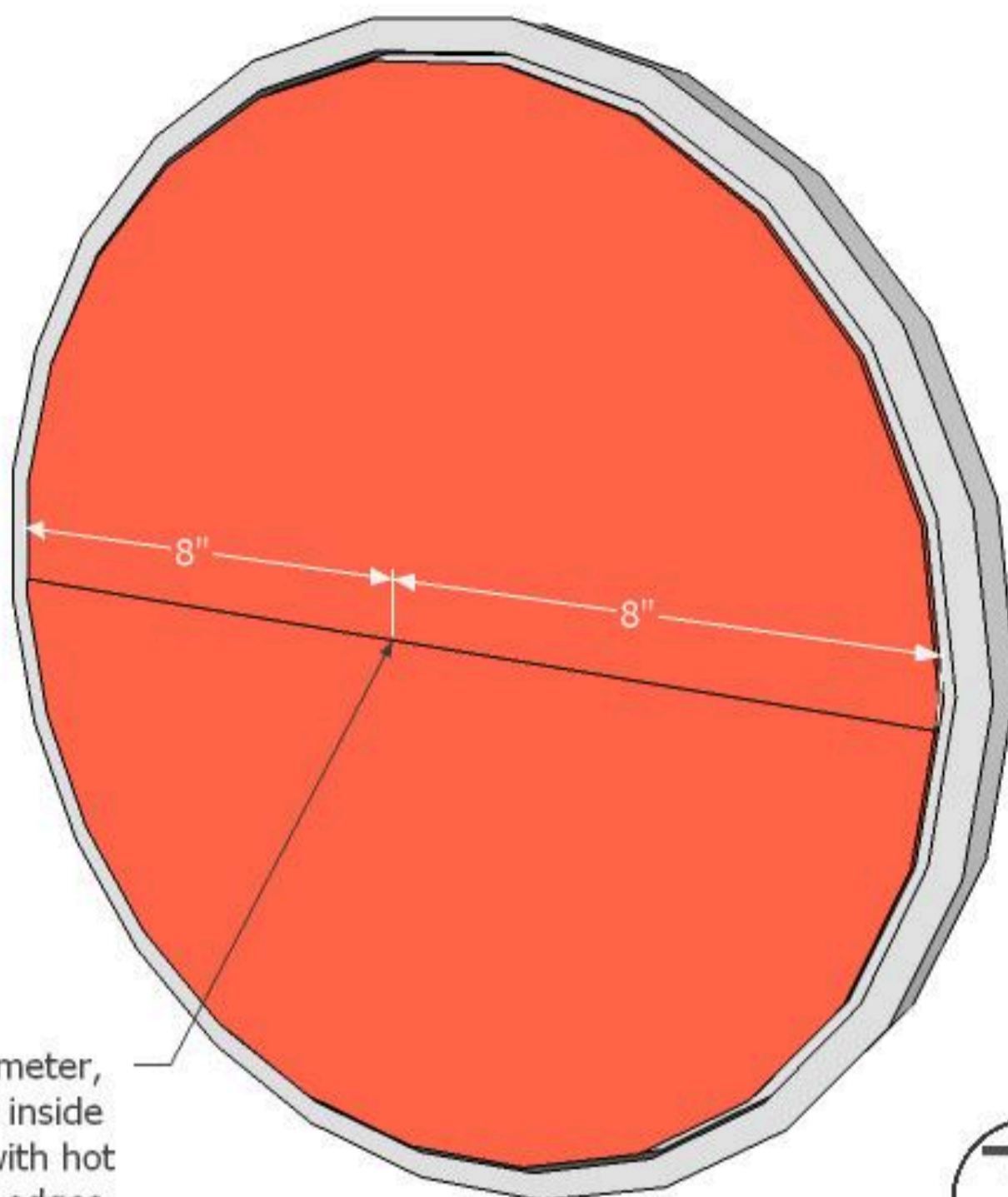

Place 16" diameter,
1/8" thick mirror inside
rabbet and secure with hot
glue around edges.



6

Cut Plywood Panel

Use a Kreg Accu-Cut track and circular saw to cut a $17\frac{5}{8}$ " x $28\frac{1}{2}$ " panel from $\frac{1}{4}$ " plywood or MDF. Measure $1\frac{1}{4}$ " from both short sides and 1" from both long sides. Use a jigsaw to cut two, intersecting, 15" diameter circles.

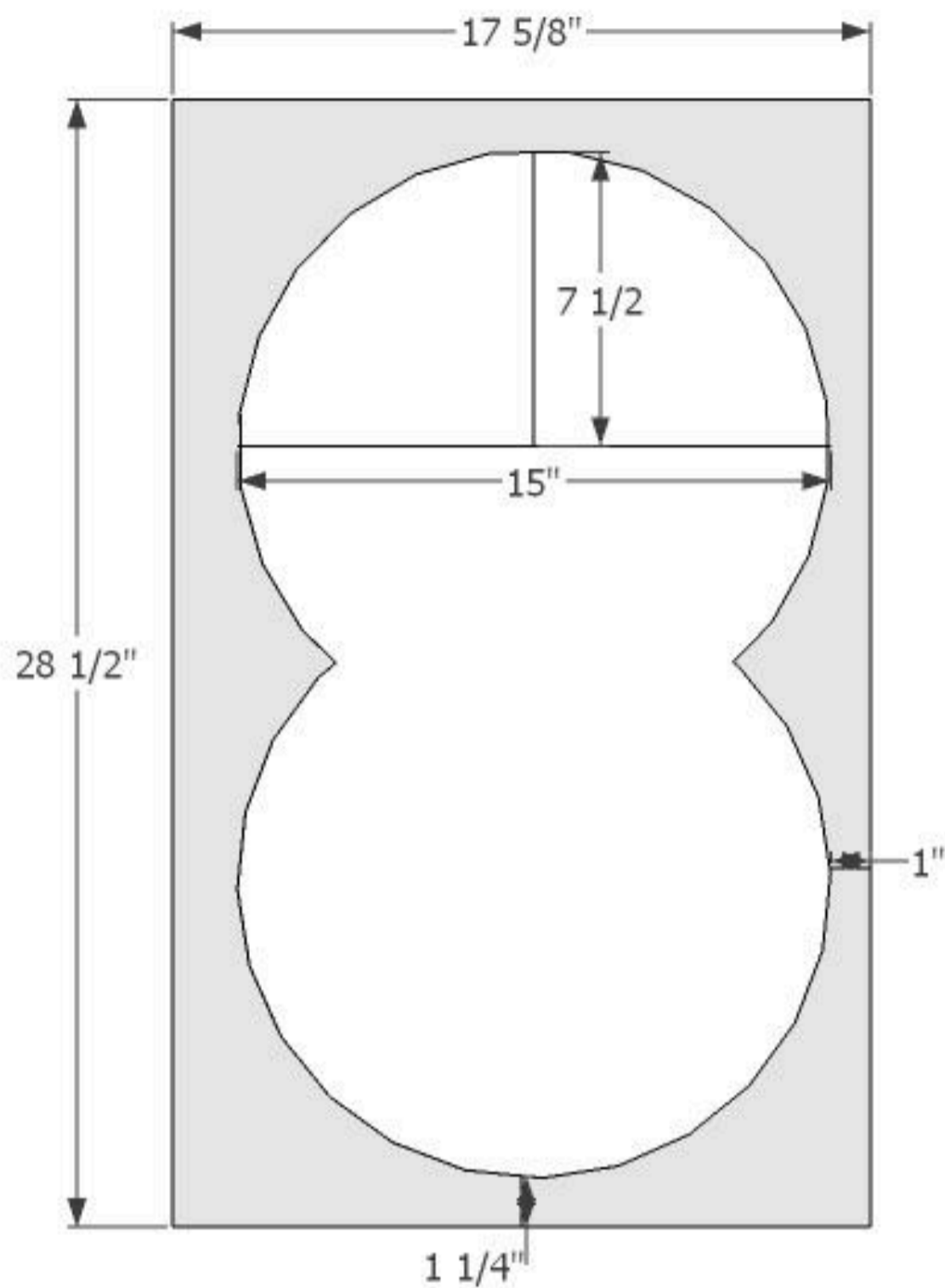

7

Insert Panel Into Sides

Slide the plywood panel into 1/4" grooves of side boards.

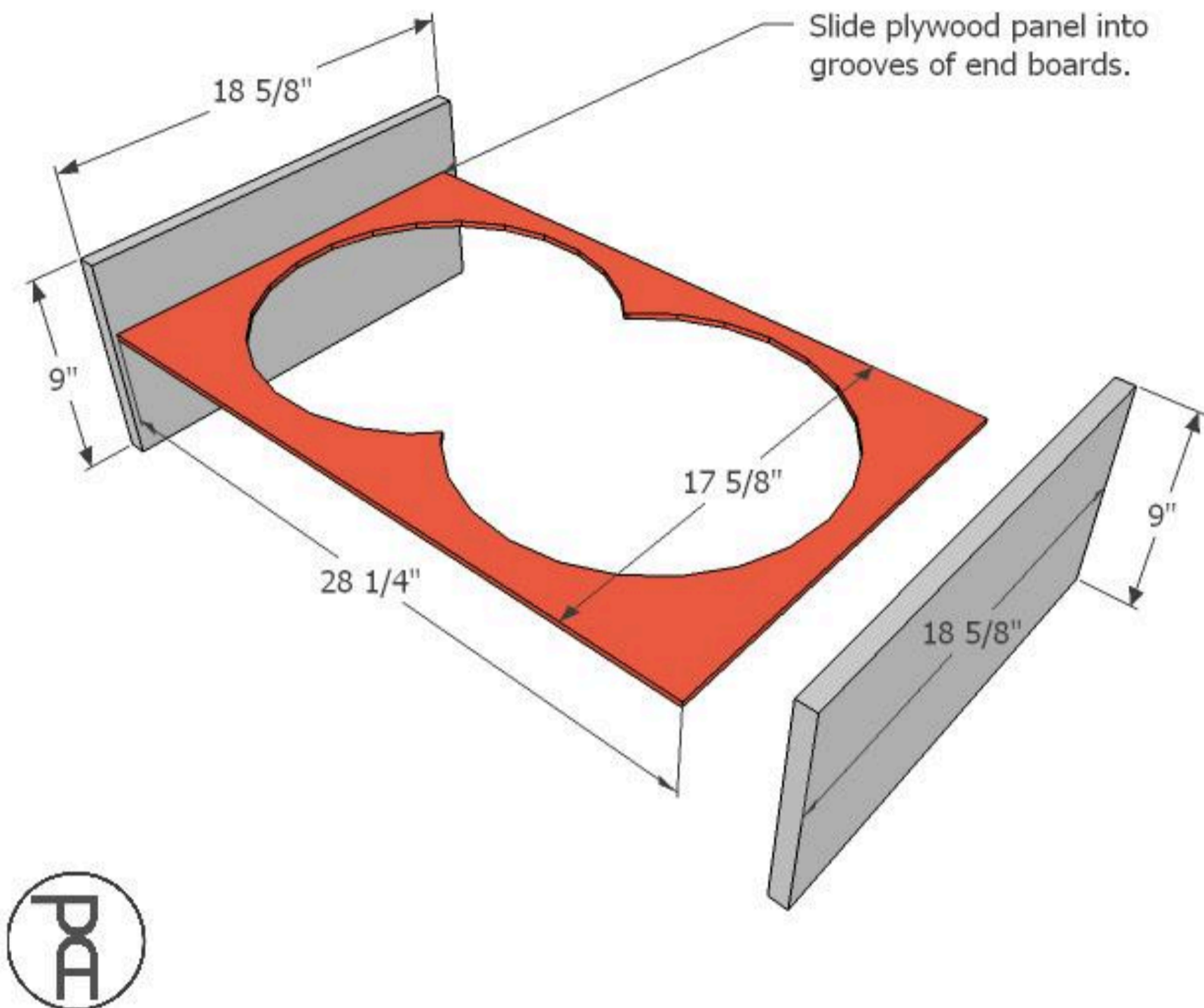

8

Insert Panel Into Top & Bottom

Align the plywood panel inside the grooves of the top and bottom boards. Join top and bottom boards to sides using glue and 1-1/4" screws through 3/4" pocket holes.

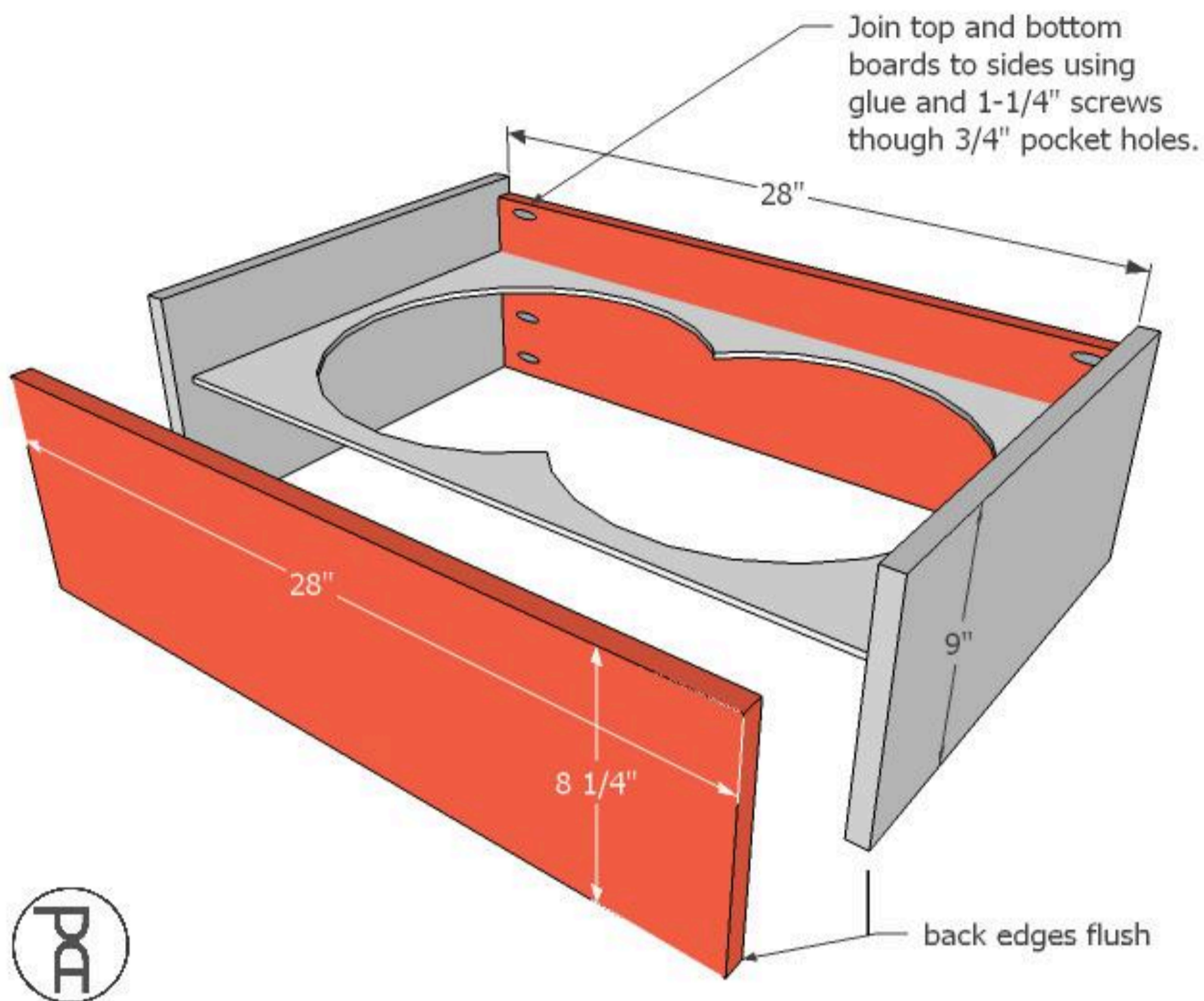

9

Add Shelf

On the inside of the box, align the shelf 8-1/4" from the bottom board. Secure in place using glue and 1-1/4" screws through 3/4" pocket holes.

Sand and apply finish to cabinet box, unattached face frame pieces and center rails.

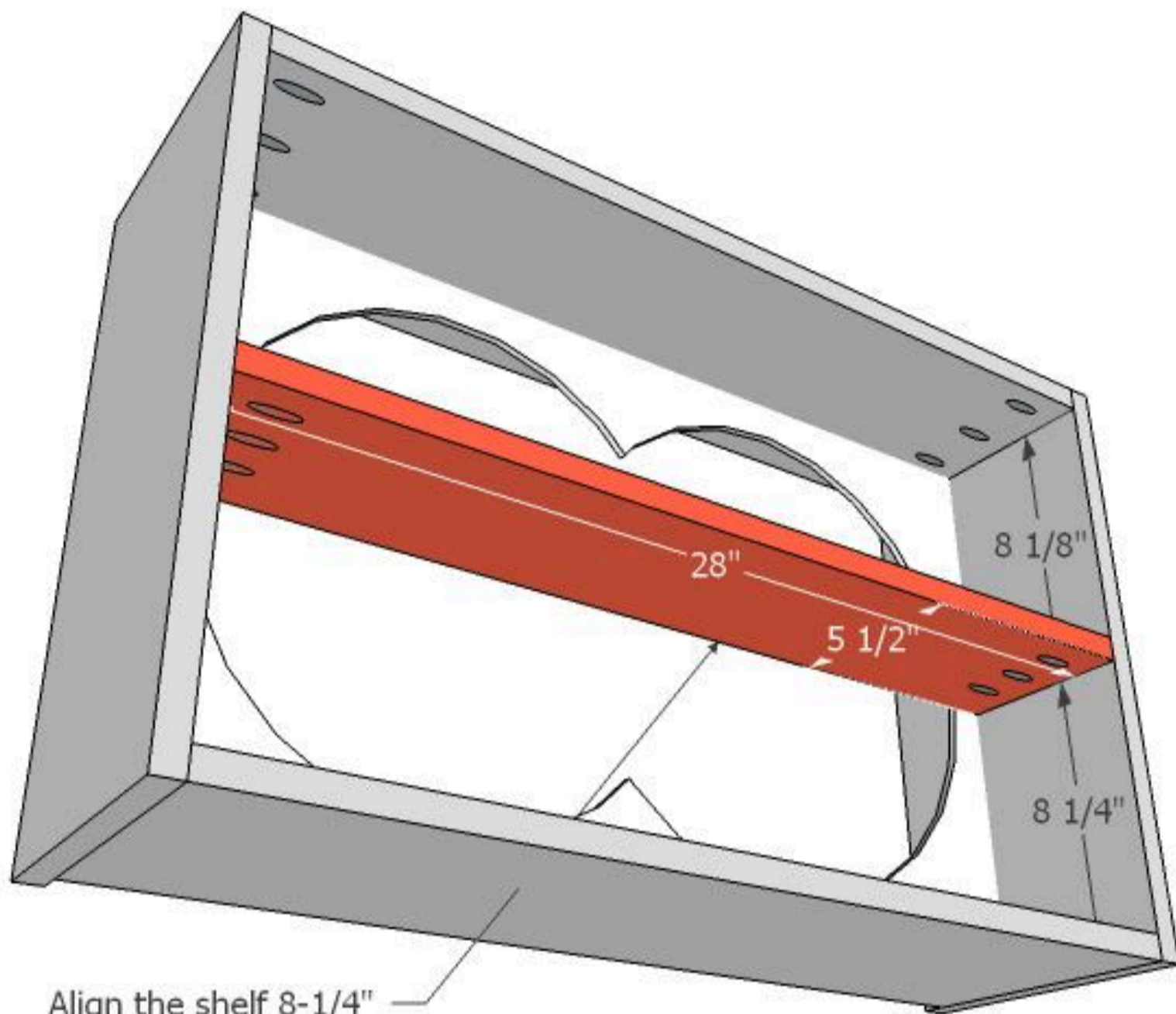

Align the shelf 8-1/4" from the bottom board. Secure in place using glue and 1-1/4" screws through 3/4" pocket holes.



10

Place First Mirror

Place first mirror flush against the front face of the plywood panel.

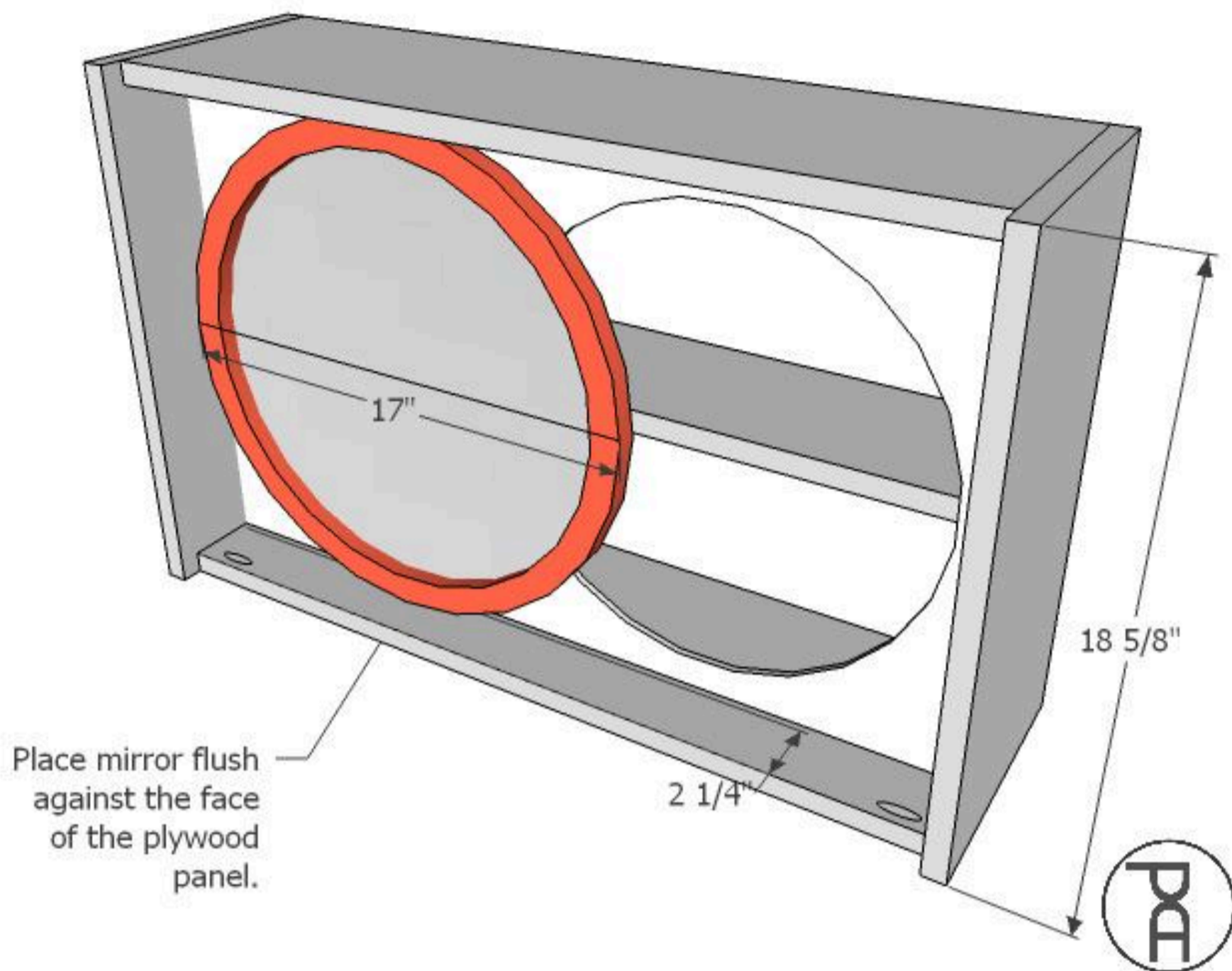

11

Add Center Rails

Place 3/4" x 3/4" x 28" center rails against top and bottom boards, spaced 1-1/2" from the front edge. Secure in place using glue and 1-1/4" brads.

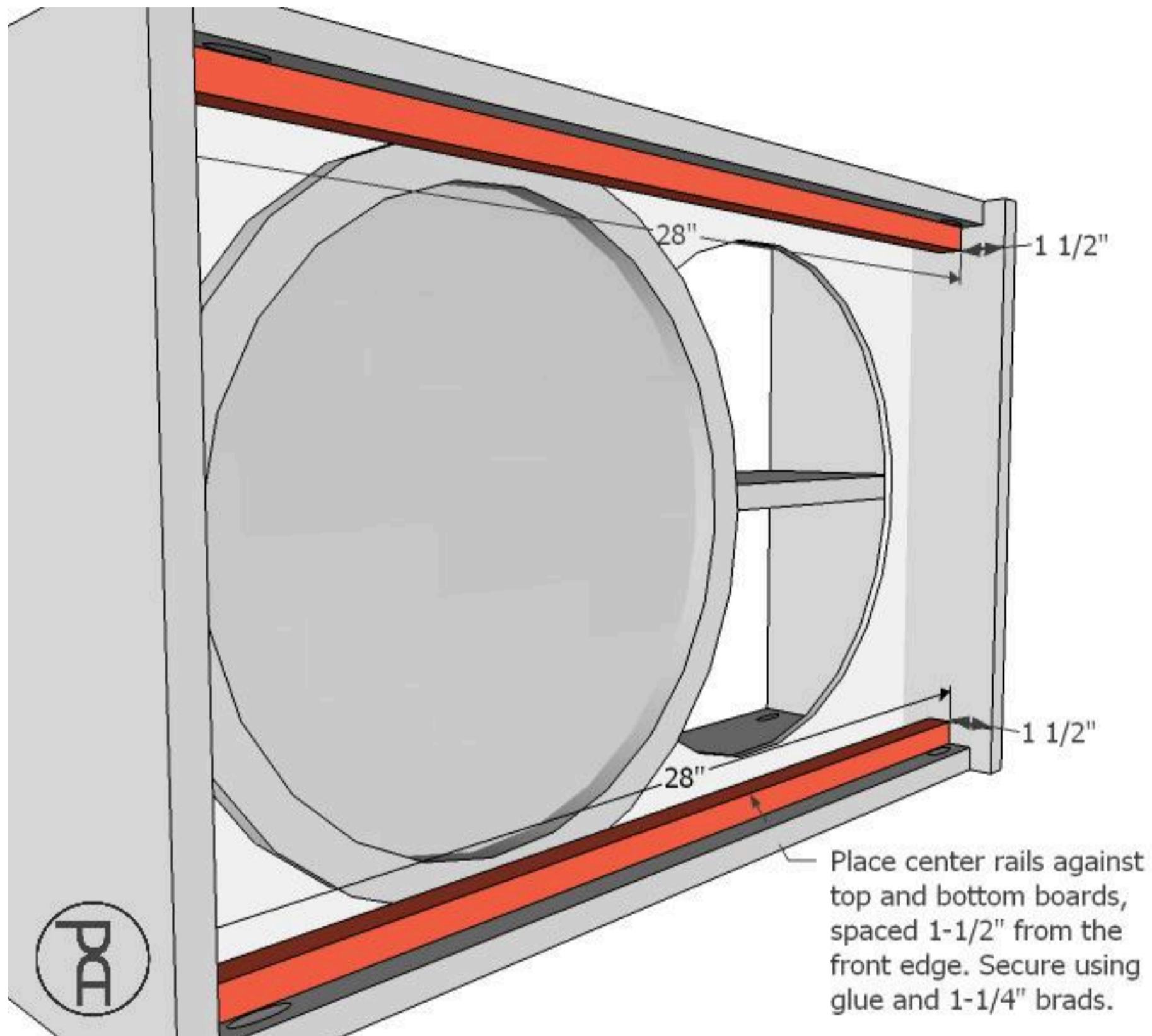

12**Place Second Mirror**

Place the second mirror in place in front of the center rails.

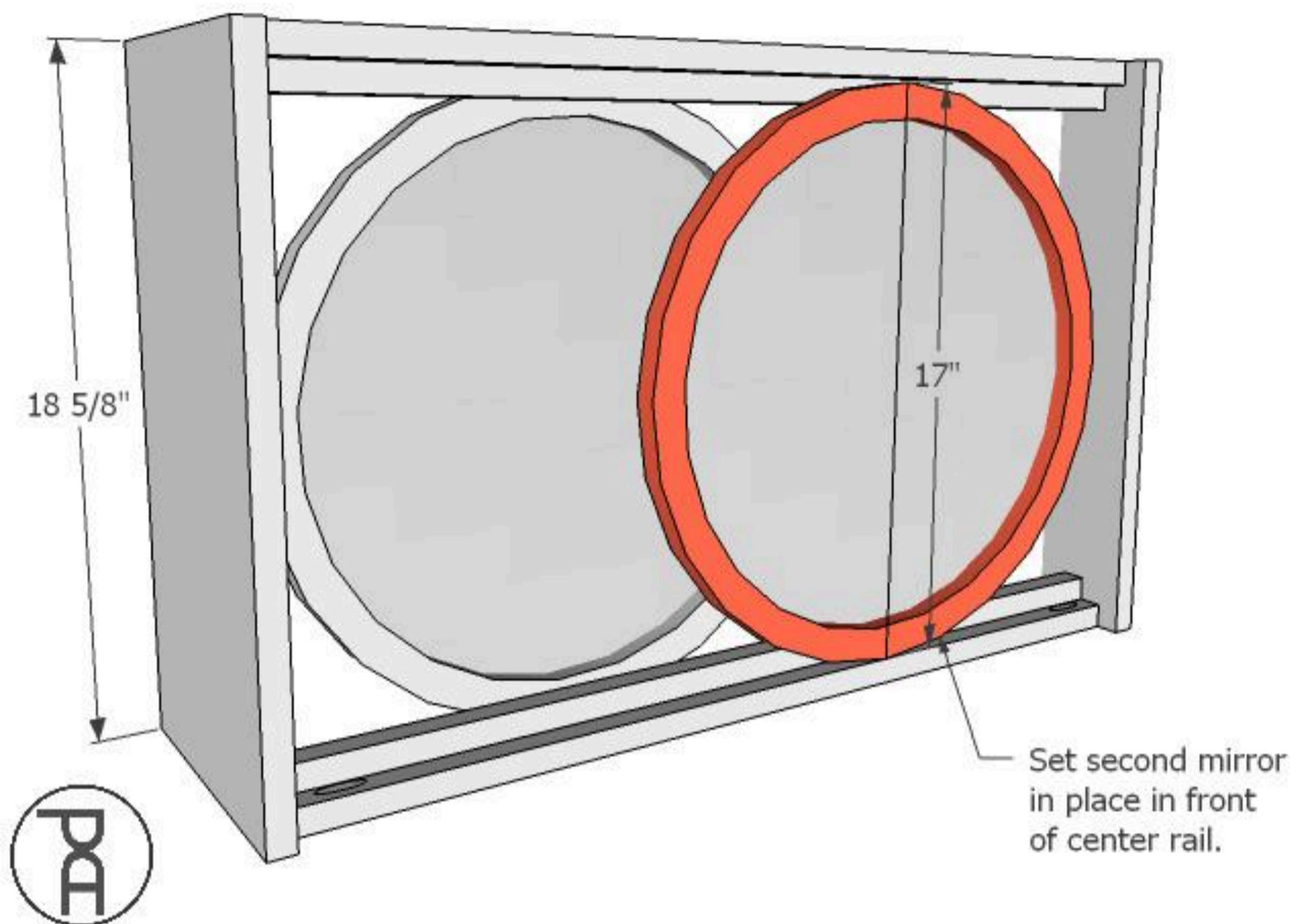

13

Attach Face Frames

Add 1 x 2 x 28" face frames, flush to the front edges of top and bottom boards. Attach using wood glue and 1-1/4" brad nails through the face and ends.

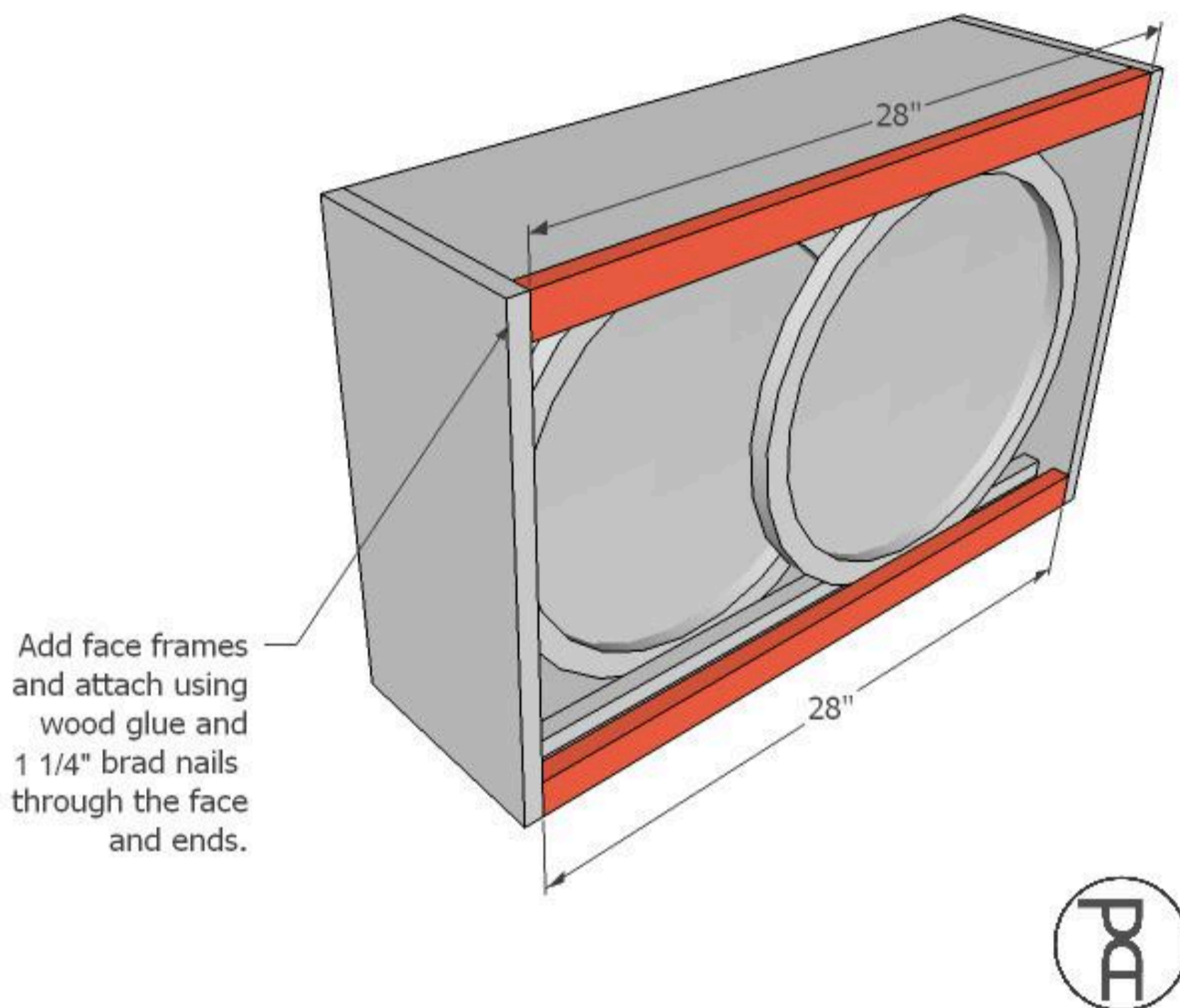

14

Get More Tips and Tricks

Head to www.PneumaticAddict.com for additional DIY tips, ideas, and free building plans.

