

Mid-Century Modern Media Cabinet

By **DIY Huntress**

Difficulty

Moderate

Mid-Century Modern media cabinets don't have to break the bank. Check out how simple it is to build trendy storage on a tight budget! Hint: it only took one sheet of plywood to build!

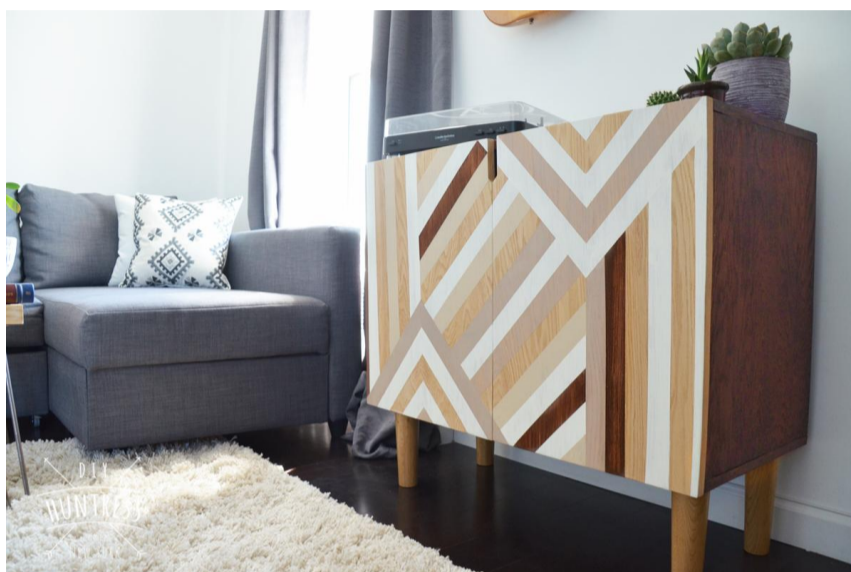
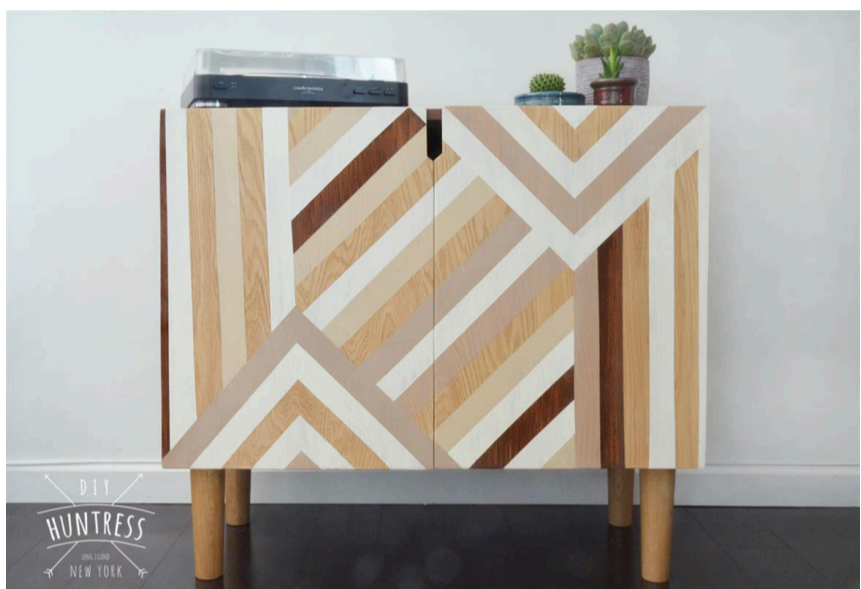

Tools

Kreg Tools



[Accu-Cut™](#)



[Kreg® Pocket-Hole Jig 720](#)



[Cabinet Hardware Jig](#)



[Mobile Project Center](#)

Other Tools

Circular Saw (cordless)

Jigsaw

Square

Clamps

Drill (cordless)

Sander

Materials

Wood Products

1 Plywood , 3/4" Thick , Full Sheet

Hardware & Supplies

4 Full Overlay Door Hinges

25 1 1/4" Pocket Hole Screws

4 Tapered Legs & Hardware

Cut List & Parts

- 1 Top , 15 X 34"
- 1 Bottom , 15 X 34"
- 2 Sides , 15 X 21"
- 1 Shelf , 14 1/2 X 32 1/2"
- 1 Back Panel , 21 X 32 1/2"
- 2 Doors , 17 X 22 1/2"

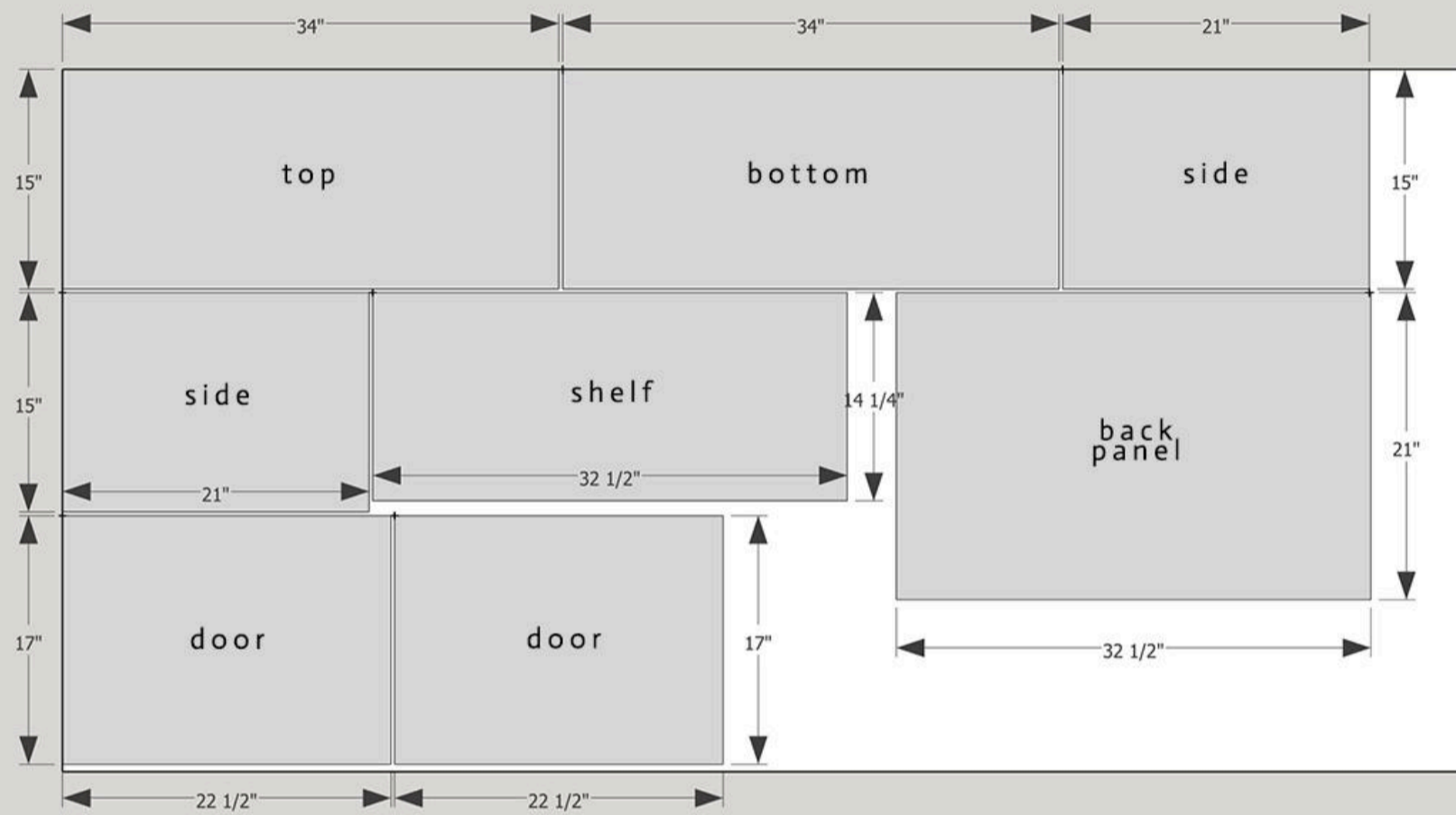

mid-century modern media cabinet -- plans by diy huntress

Directions

1

Check Dimensions

Check the dimensions of the project to make sure it fits your space.

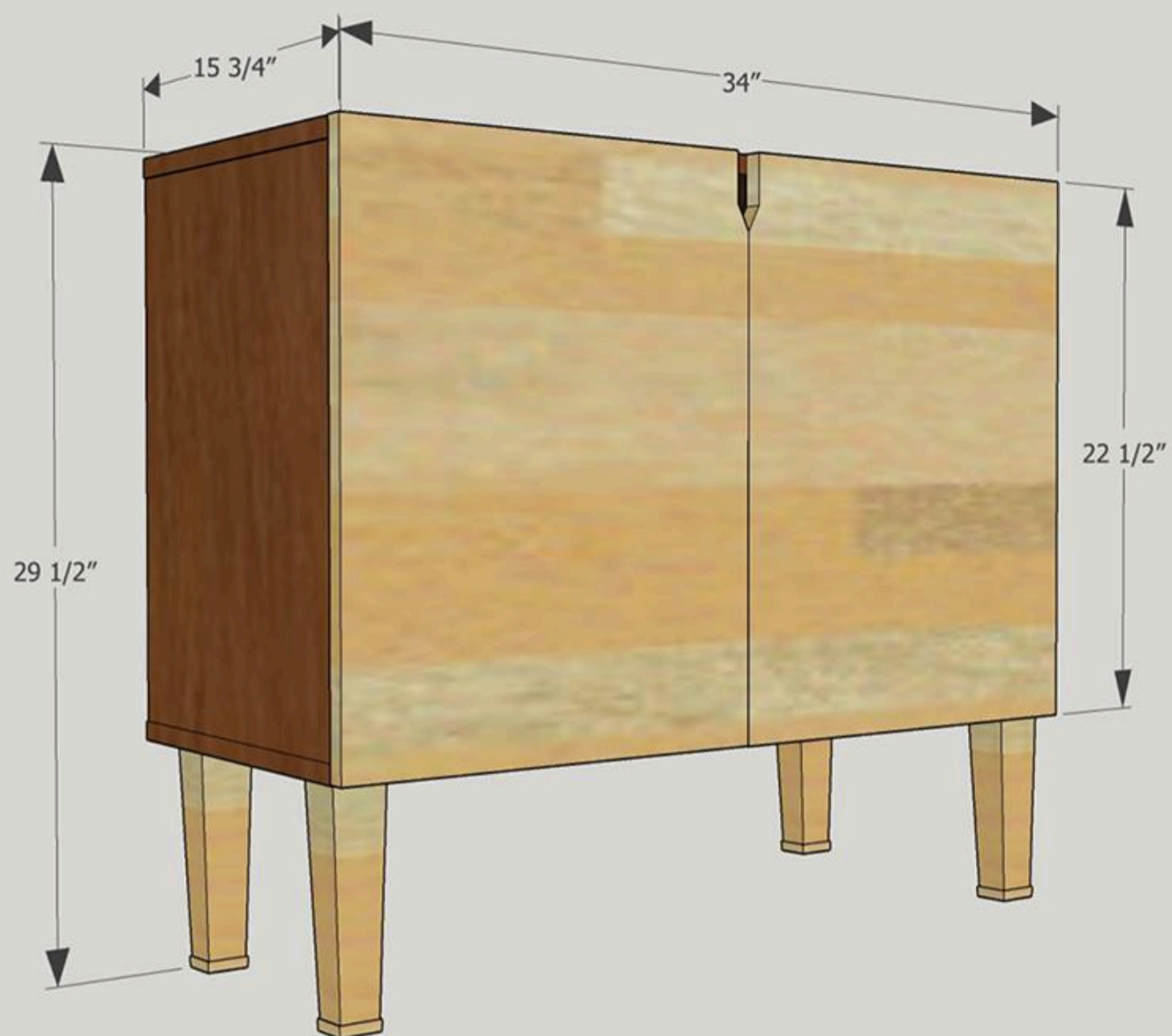

mid-century modern media cabinet -- plans by diy huntress

2

Make Cuts

Use the cut list to make your cuts.

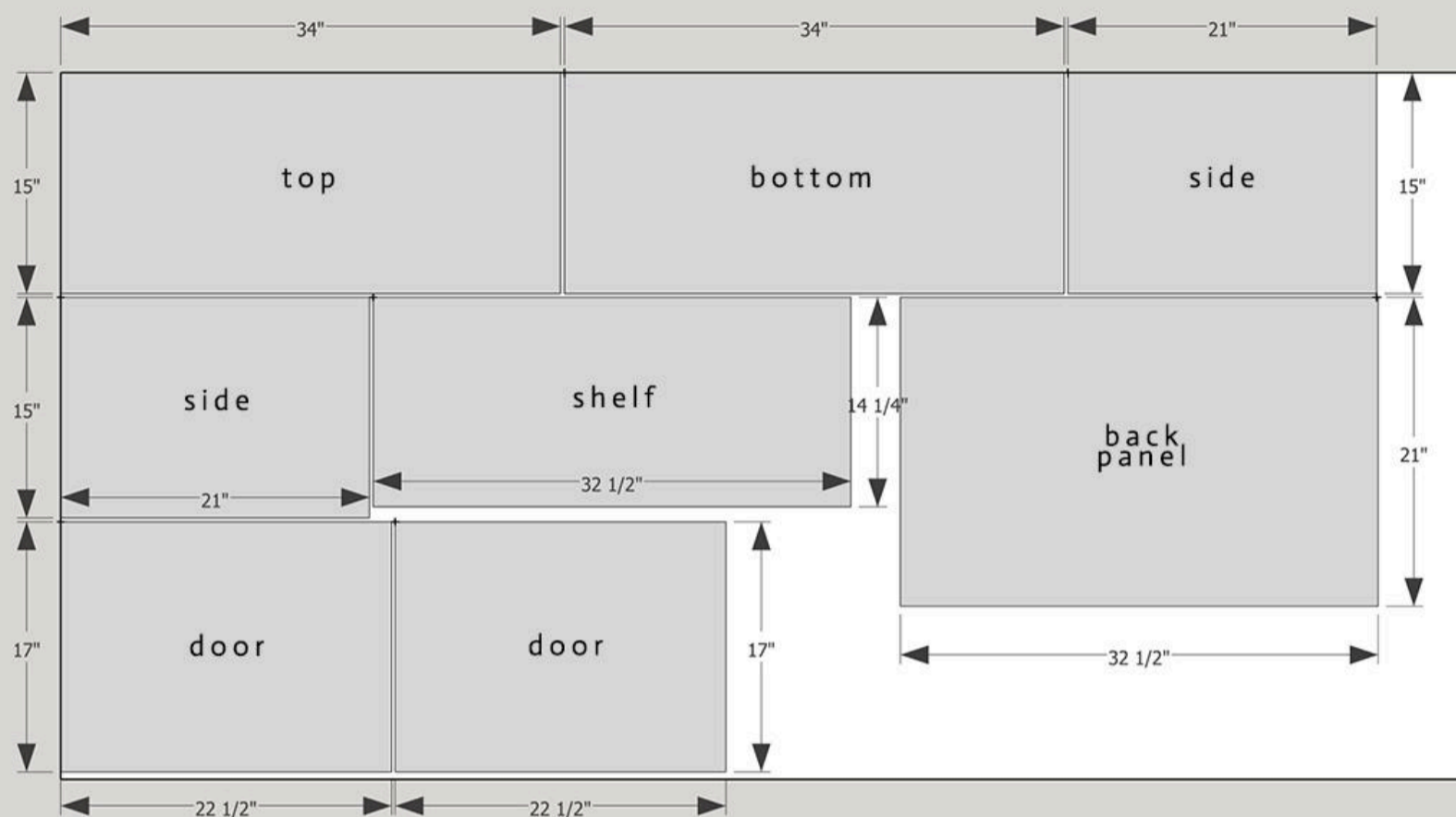

mid-century modern media cabinet -- plans by diy huntress

3

Create Frame

Create your frame by attaching top, bottom, and side pieces with 1 1/4" pocket hole screws and glue.

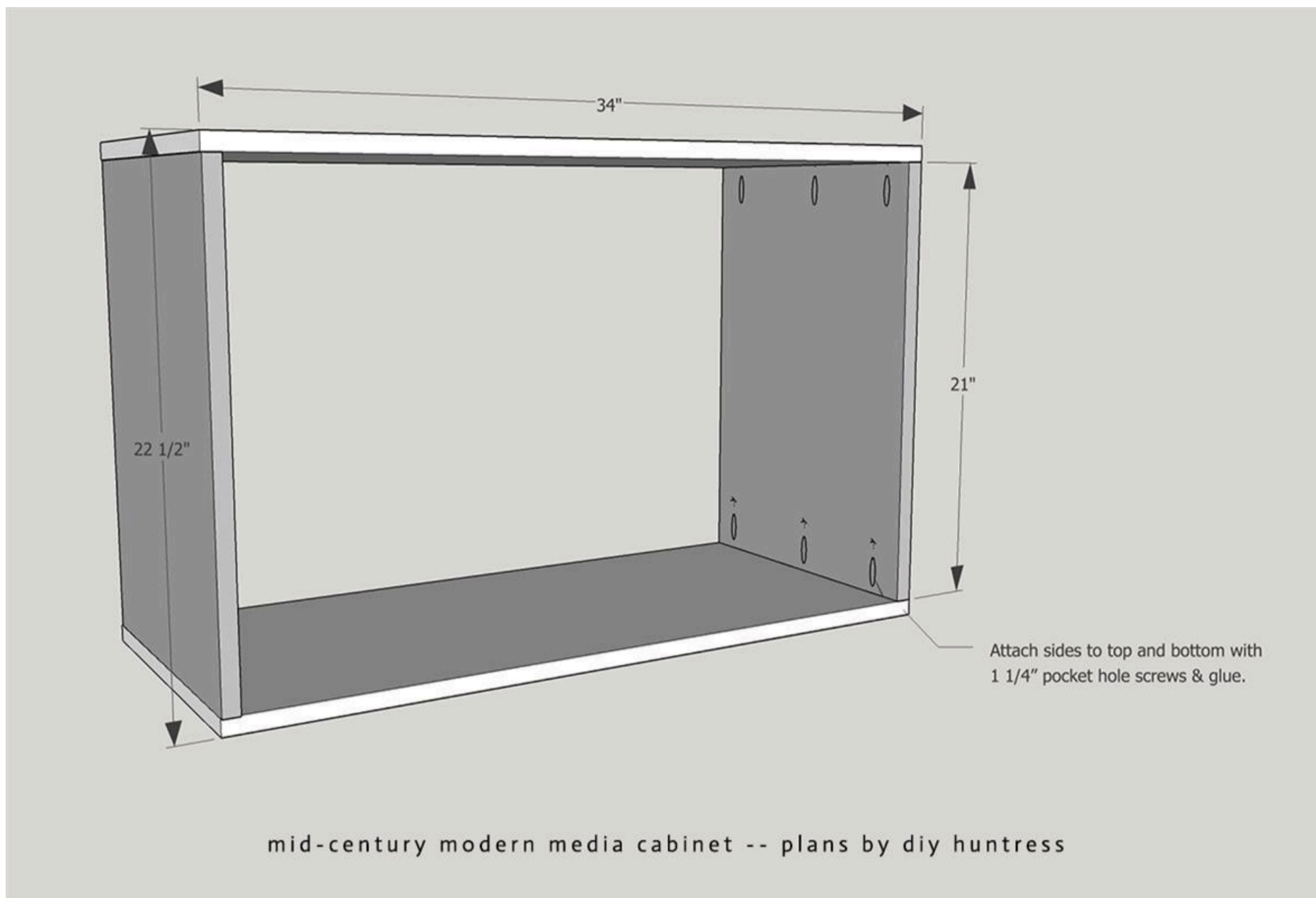

4

Add Back Panel

Add back panel with 1 1/4" pocket hole screws and wood glue.

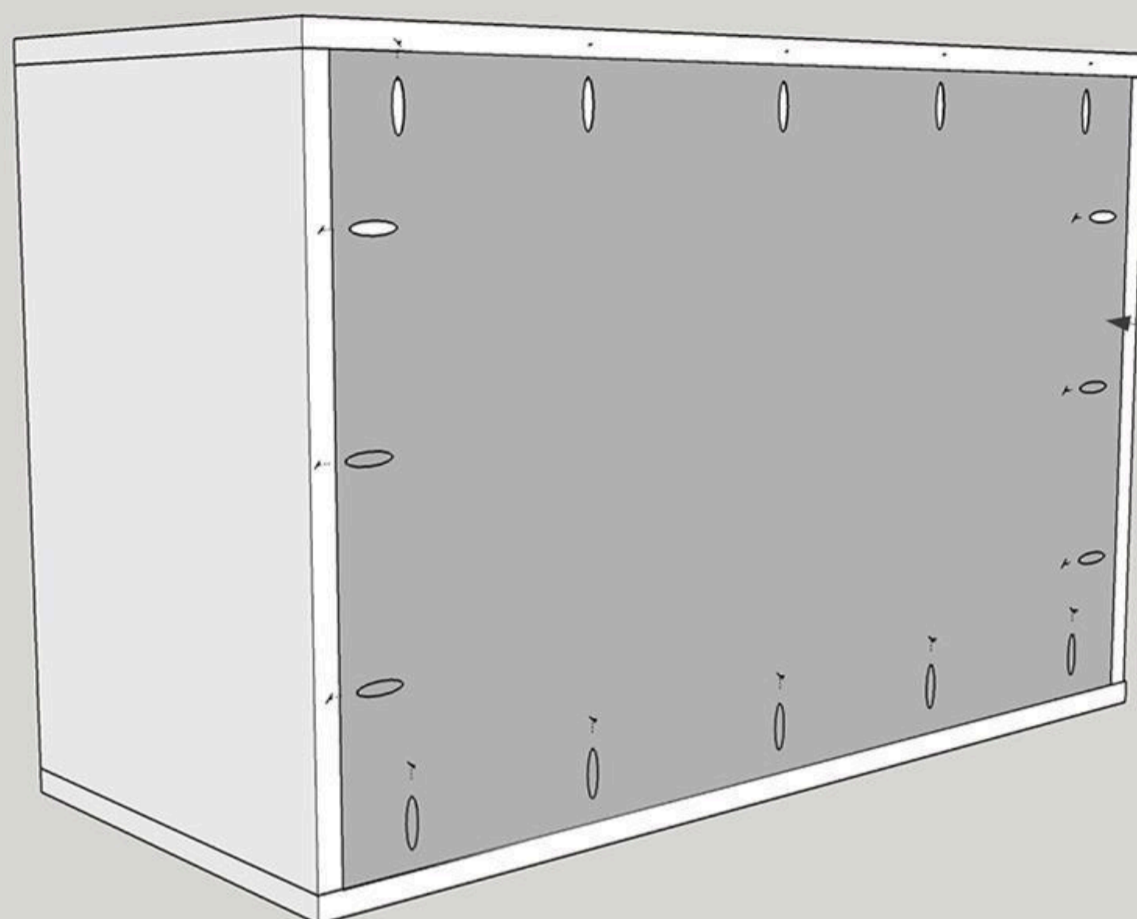

Attach back panel to frame with 1 1/4" pocket hole screws & wood glue.

mid-century modern media cabinet -- plans by diy huntress

5

Add Shelf (Optional)

Add a shelf to your build with 1 1/4" pocket hole screws & wood glue, if needed. I used mine for a 3D printer, so no shelving was added!

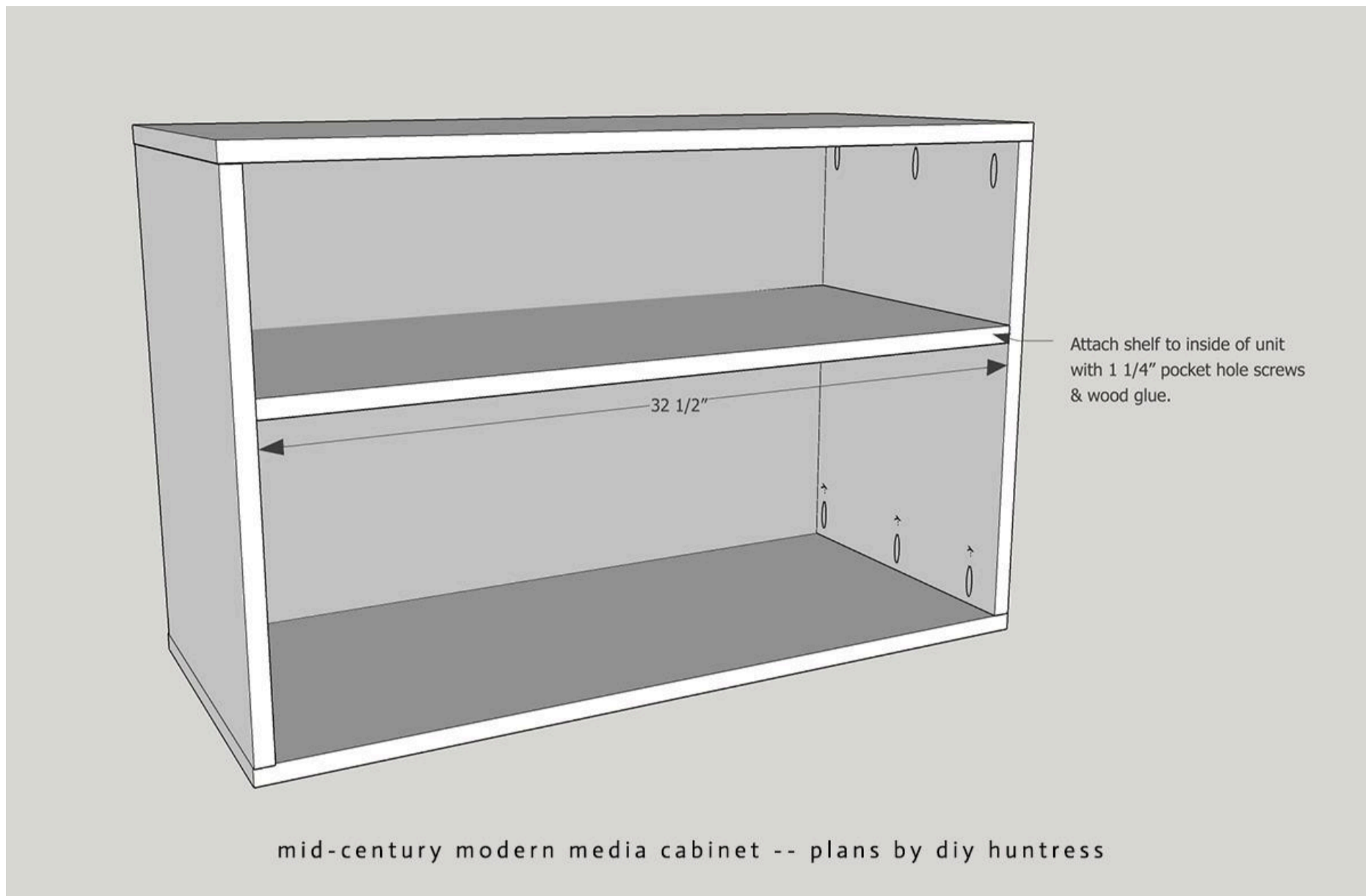

6**Create Handle Cut Outs**

Use a jig saw to create cut outs for the door handles. The ones on this particular cabinet are 1/2" wide and 3" tall on each door.

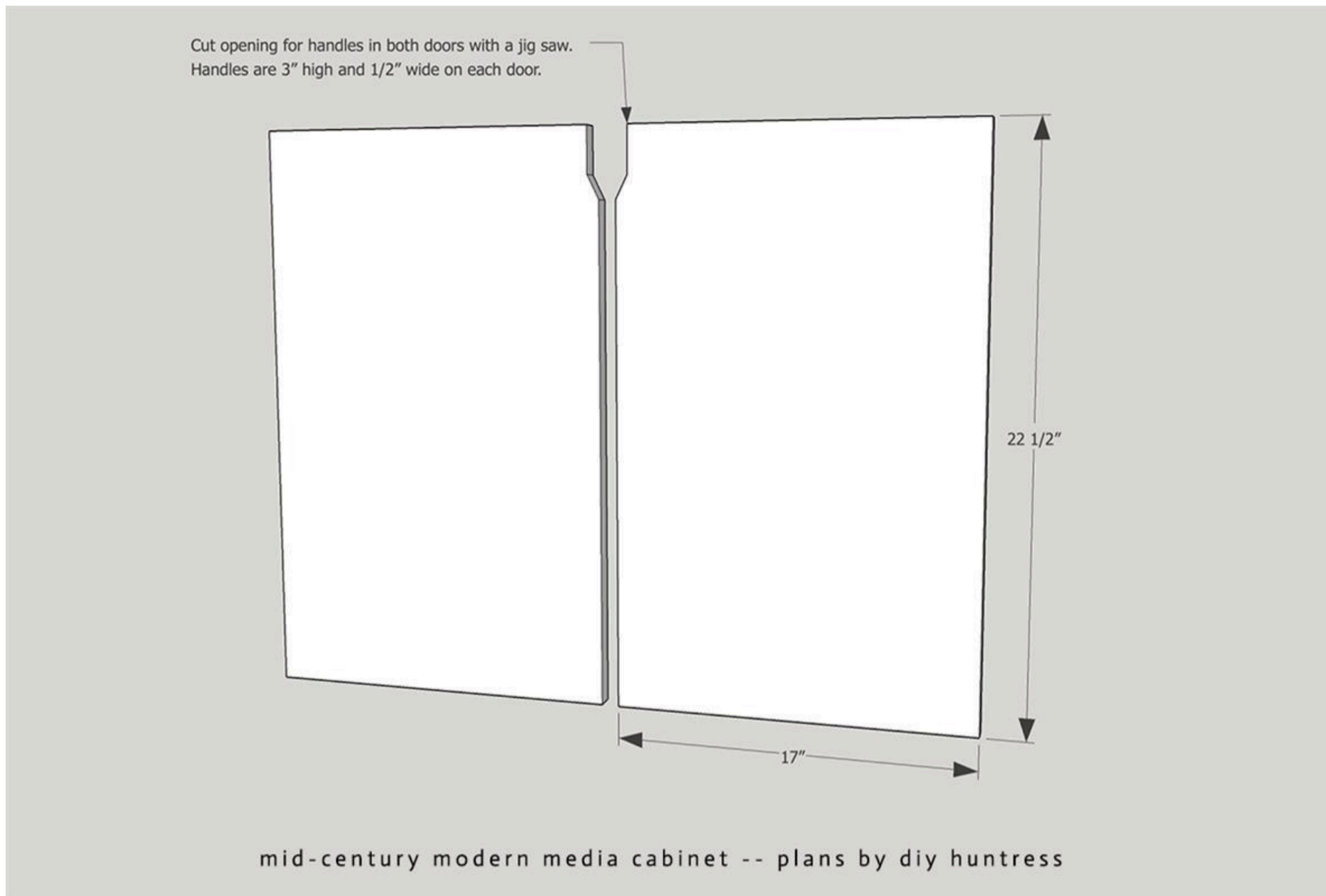

7**Attach Doors**

Use the Kreg cabinet hardware jig to add your full overlay concealed hinges.

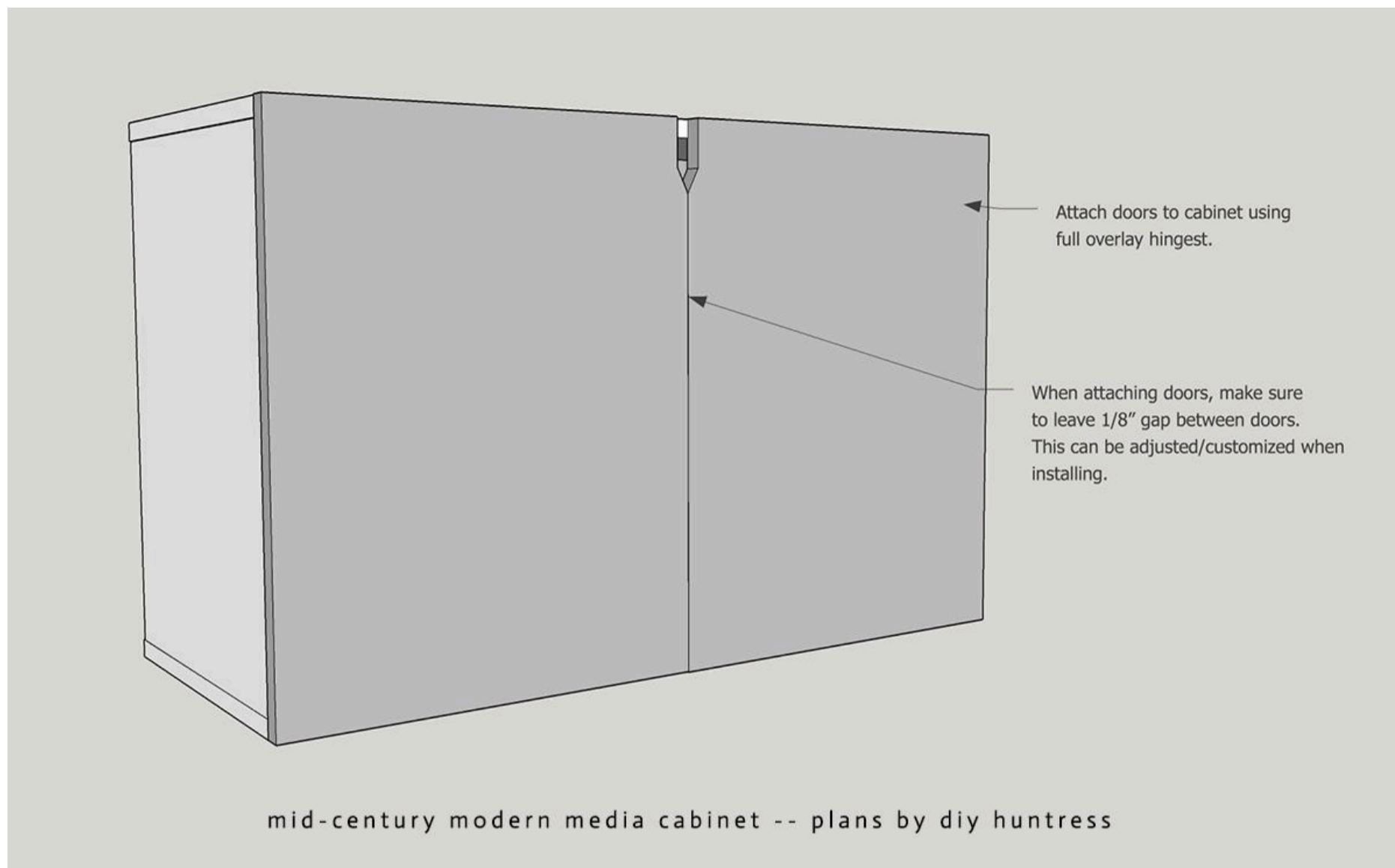

8**Add Legs**

Add your legs as per manufacturer directions. Visit my website at dijhuntress.com for a link to the exact legs used in this build.

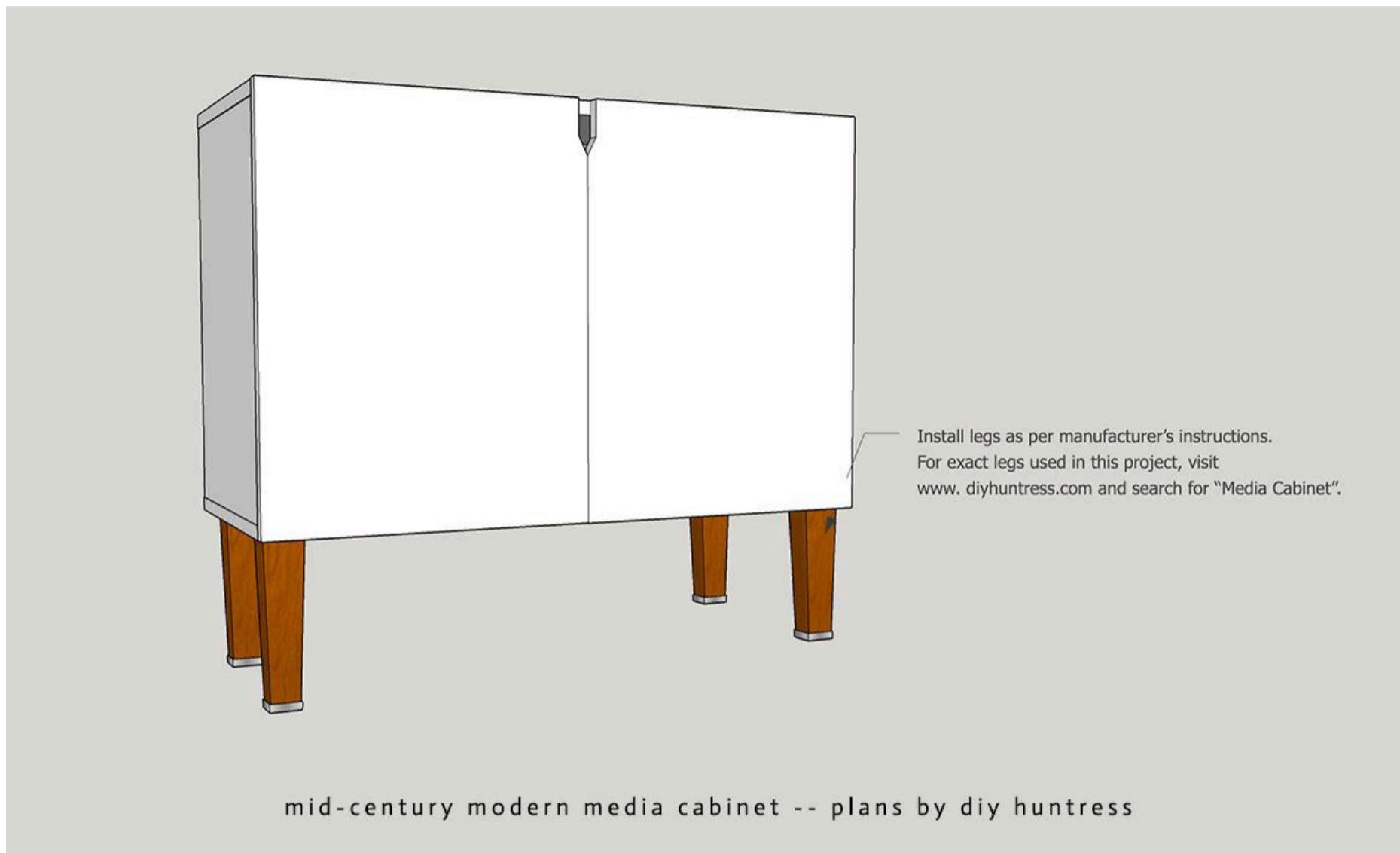

9

Sand & Stain

Stain your piece! Add artwork to the front to help the unit pop!



mid-century modern media cabinet -- plans by diy huntress