

Hot Cocoa Bar

Difficulty

Easy

This simple build perfectly displays all the ingredients for a successful hot chocolate bar. Bring it out for your holiday parties, a winter wedding, or just a fun evening with friends and family. Made primarily from small pieces, you can likely put this together with scraps from other projects.

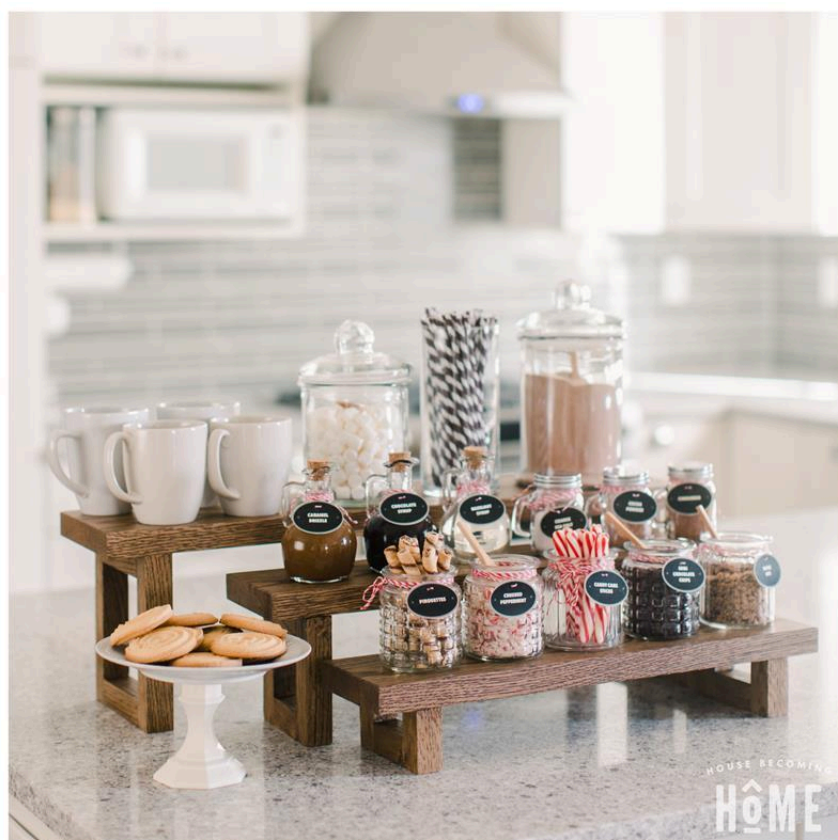
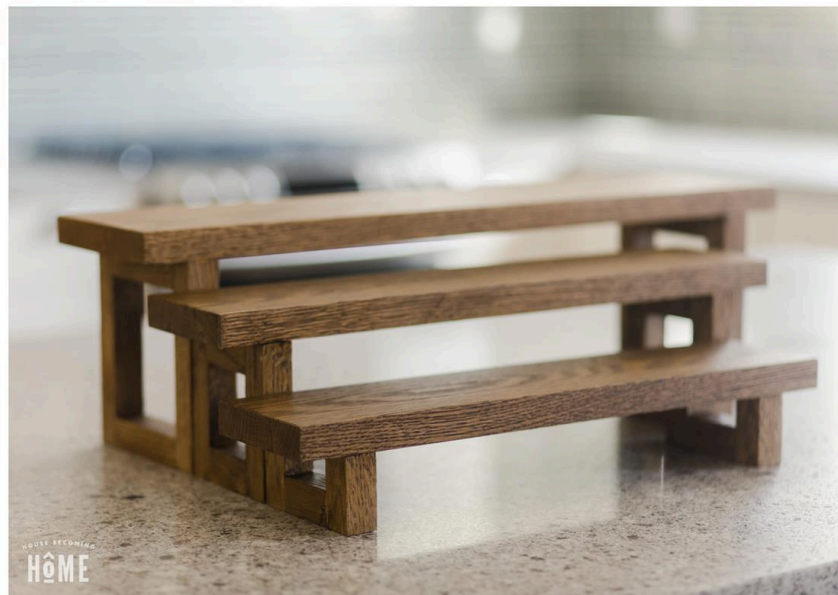

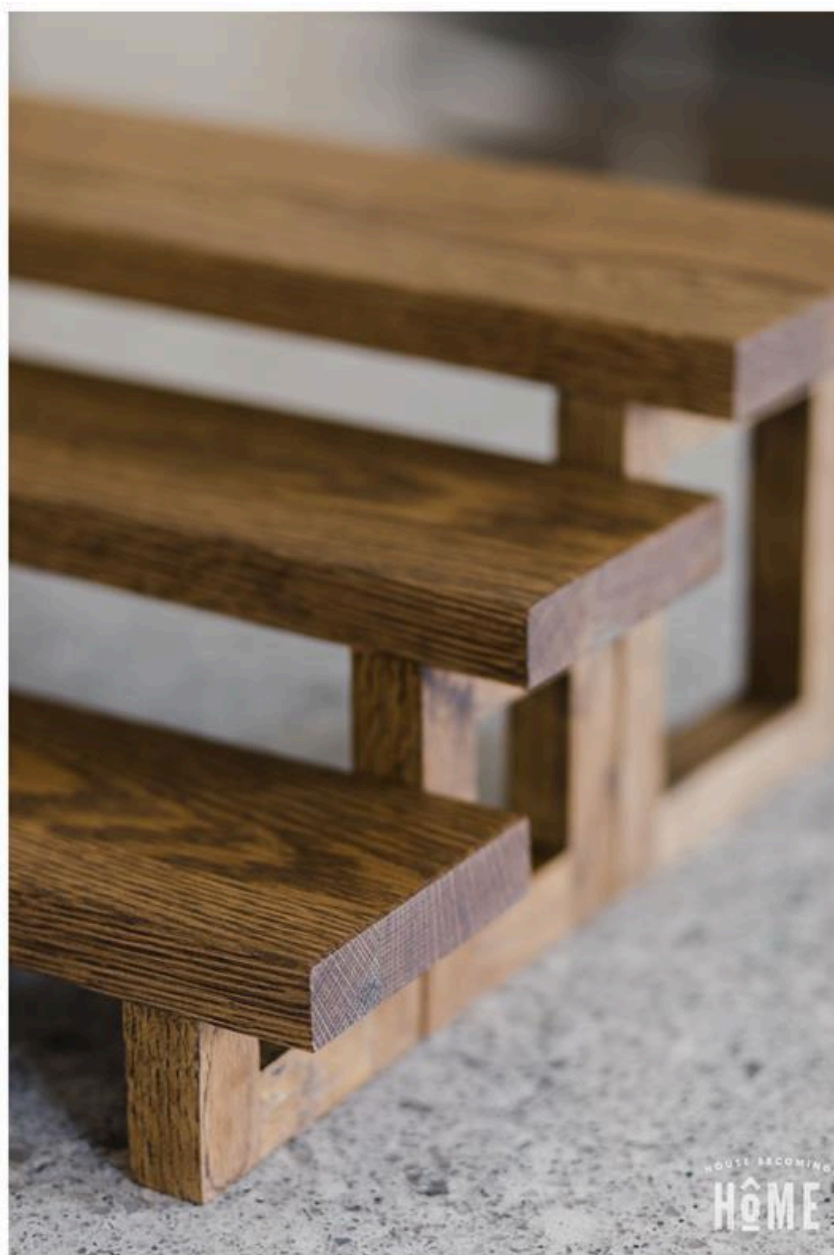

Tools

Kreg Tools

Wood
Project [Wood Project Clamp - 6"](#)
Clamp -
6

Mobile
Project [Mobile Project Center](#)
Center

Other Tools

Miter Saw

Table Saw

Sander

Materials

Wood Products

- 1 Board , 1" X 11-1/2" , 43"
- 2 Board , 1" X 1" , 48"

Hardware & Supplies

- 1 Wood Glue
- 1 Sandpaper
- 1 Wood Stain
- 1 Polyurethane

Cut List & Parts

- 4 Small Tier Legs - Side Pieces , 1"x1"x2-1/4"
- 2 Small Tier Legs - Bottom Pieces , 1"x1"x2-3/4"
- 4 Medium Tier Legs - Side Pieces , 1"x1"x5"
- 4 Medium Tier Legs - Top & Bottom Pieces , 1"x1"x2-3/4"
- 4 Large Tier Legs - Side Pieces , 1"x1"x7"
- 4 Large Tier Legs - Top & Bottom Pieces 1"x1"x , 1"x1"x4-1/4"
- 1 Small Tier Top , 1"x20"x4-3/4"
- 1 Medium Tier Top , 1"x22"x4-3/4"
- 1 Large Tier Top , 1"x27"x6-1/4"

Directions

1

Cut Lumber

Cut lumber to size, then organize into groups: small, medium, and large tiers.



2**Assemble Small Tier Legs**

Using wood glue and clamps, assemble the legs of the small tier.

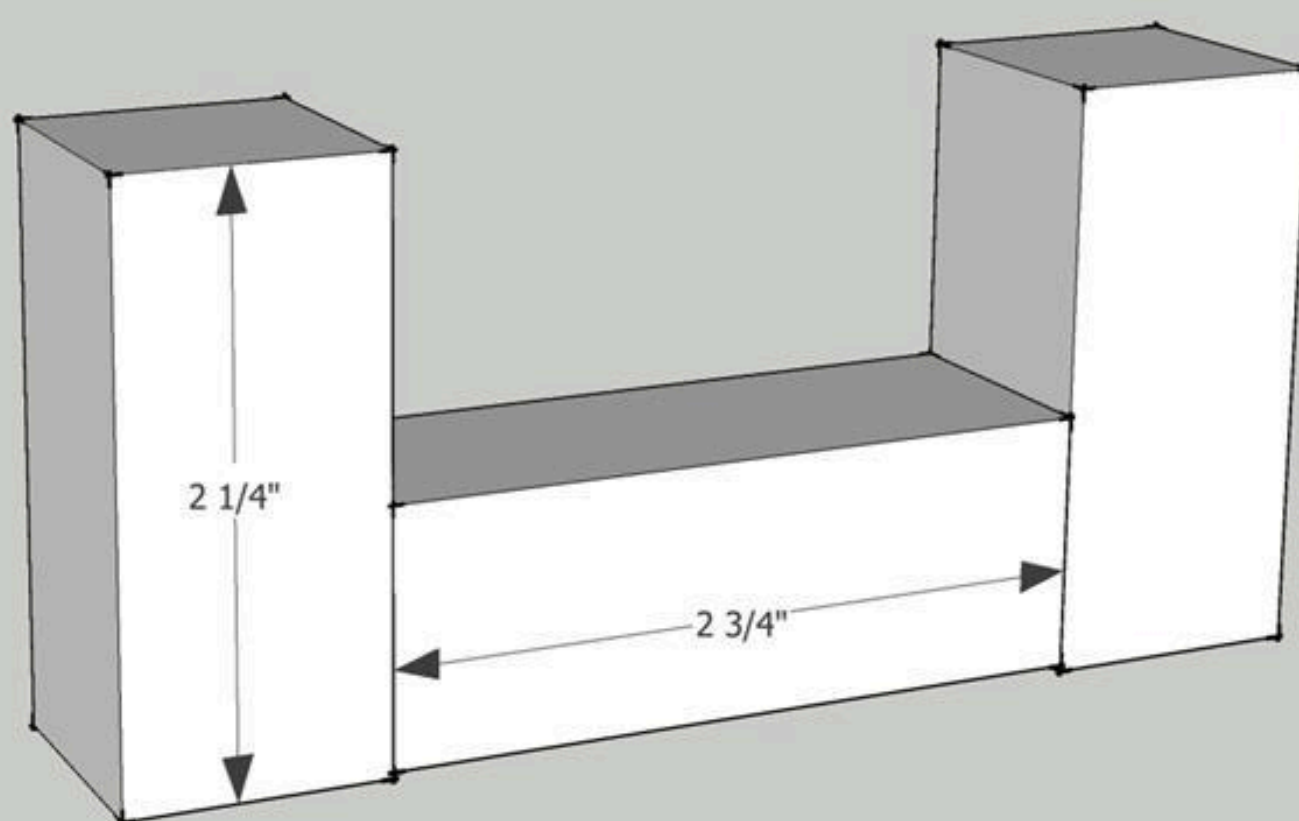

HOUSE BECOMING
HÔME

3**Assemble Medium Tier Legs**

Using wood glue and clamps, assemble the legs of the medium tier.

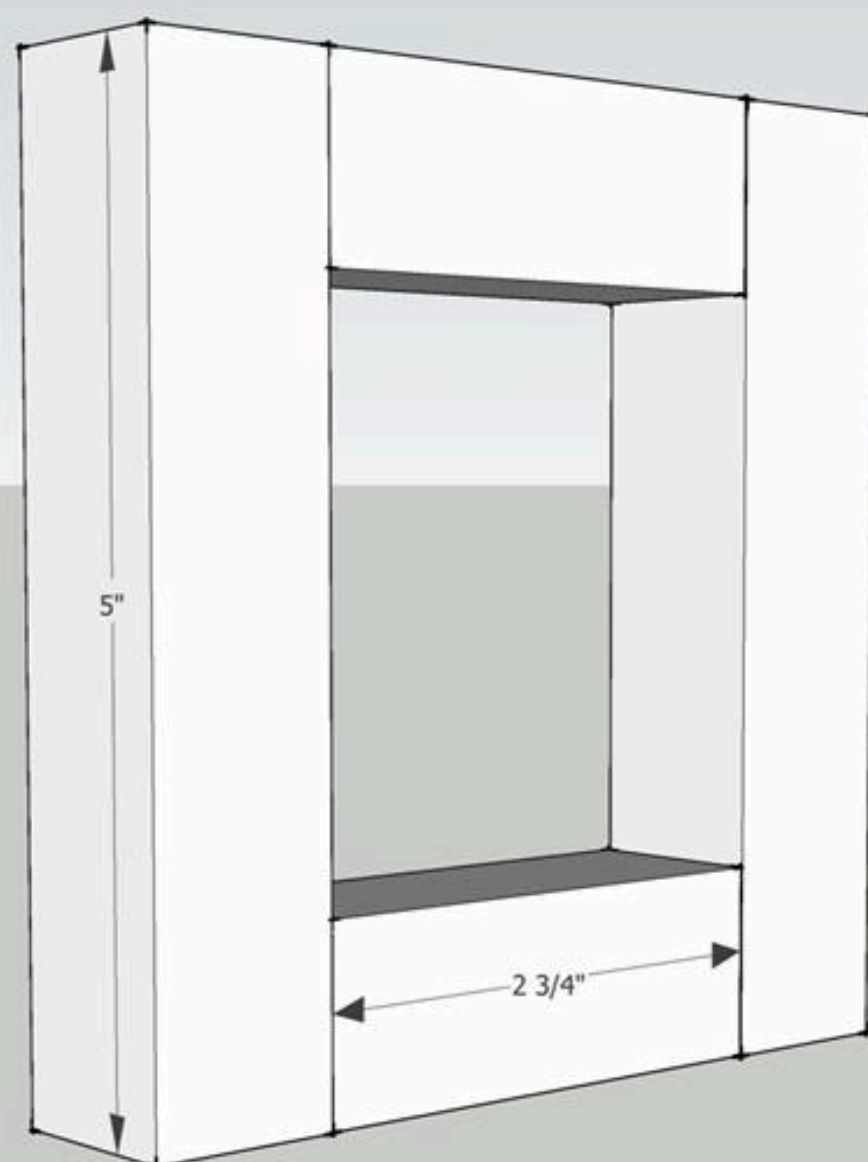

HOUSE BECOMING
HÔME

4**Assemble Large Tier Legs**

Using wood glue and clamps, assemble the legs of the large tier.

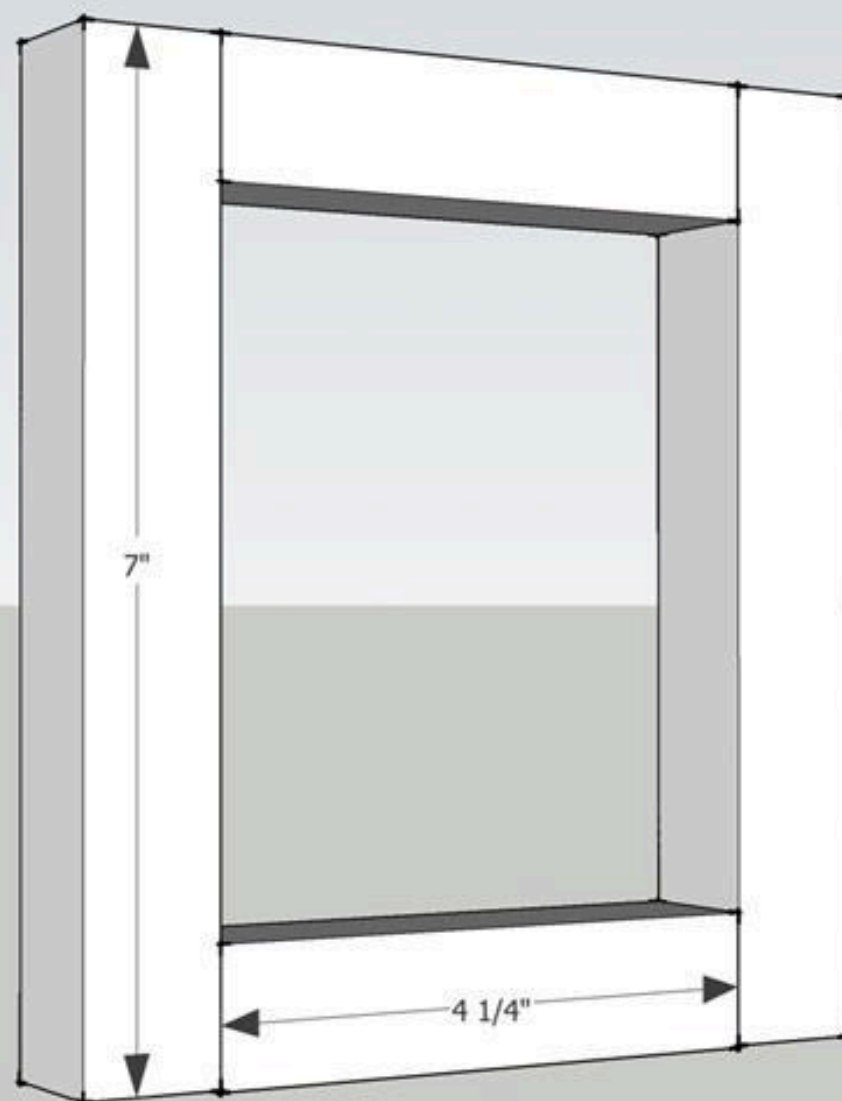

HOUSE BECOMING
HÔME

5**Attach Legs to Small Tier Top**

Using wood glue and clamps, attach completed legs to the small tier top, 1-1/2" from the edge. Use a carpenter's square to ensure legs are attached at 90 degrees.

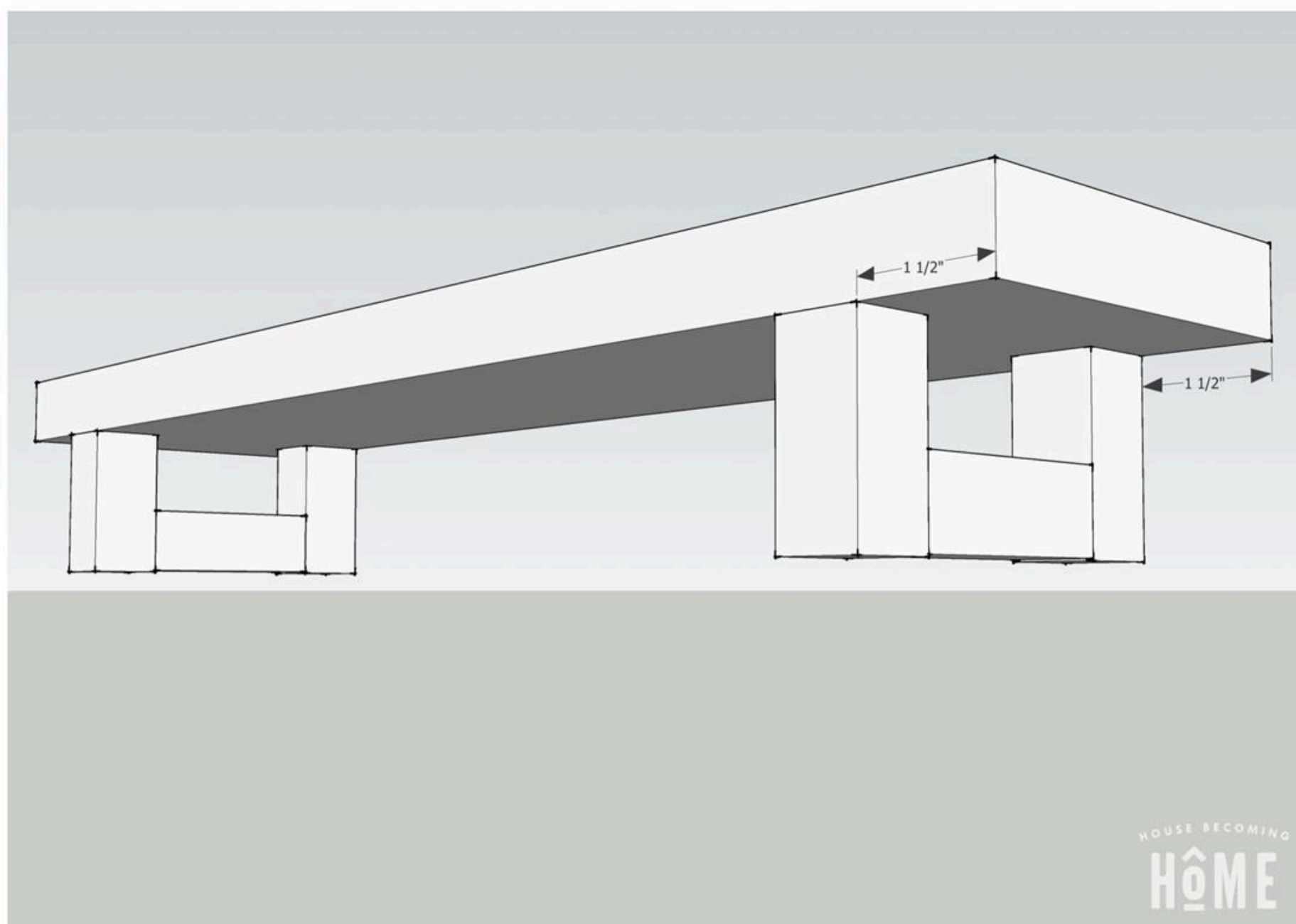

6**Attach Legs to Medium Tier Top**

Using wood glue and clamps, attach completed legs to the medium tier top, 1-1/2" from the edge. Use a carpenter's square to ensure legs are attached at 90 degrees.

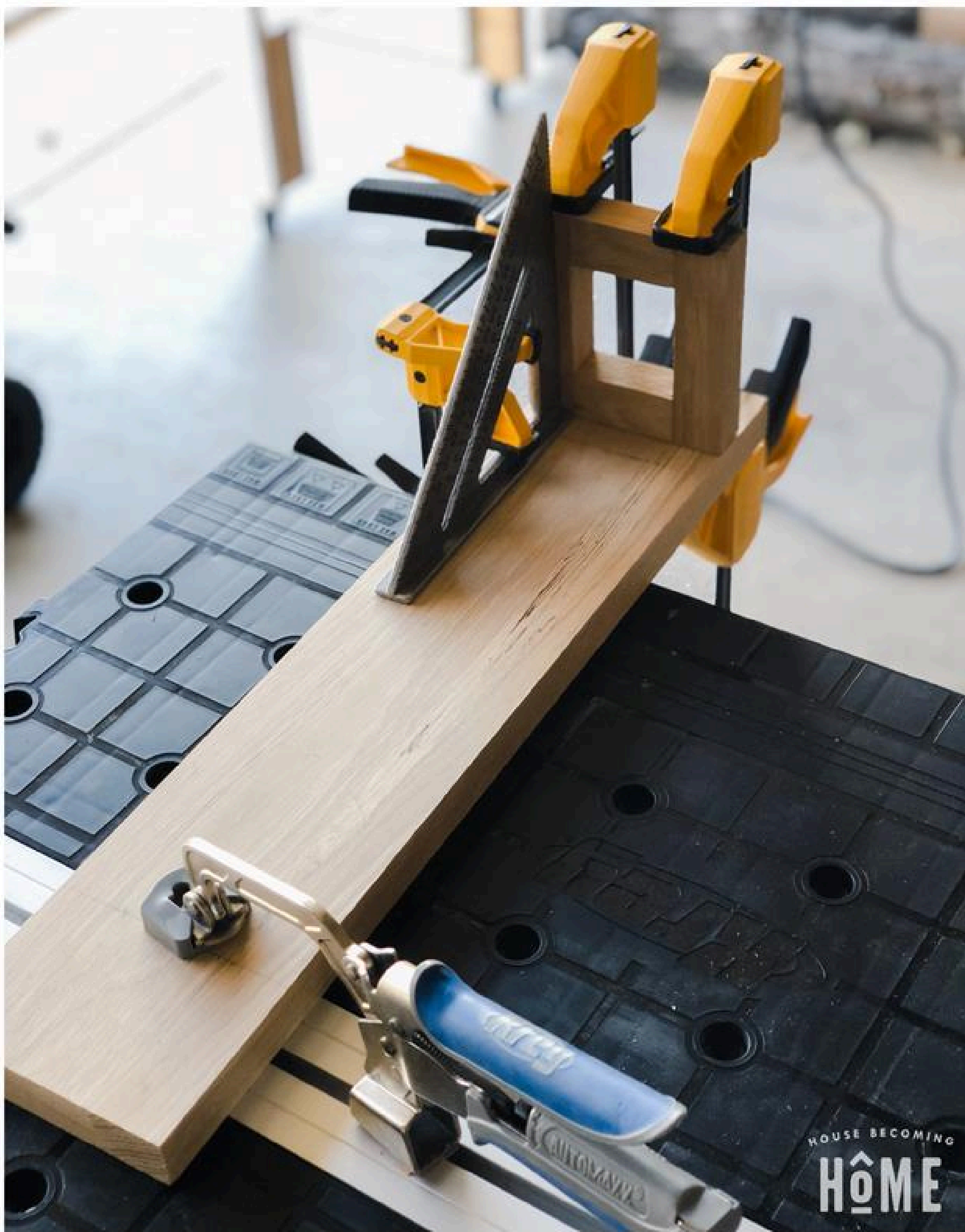

7

Attach Legs to Large Tier Top

Using wood glue and clamps, attach completed legs to the large tier top, 1-1/2" from the edge. Use a carpenter's square to ensure legs are attached at 90 degrees.

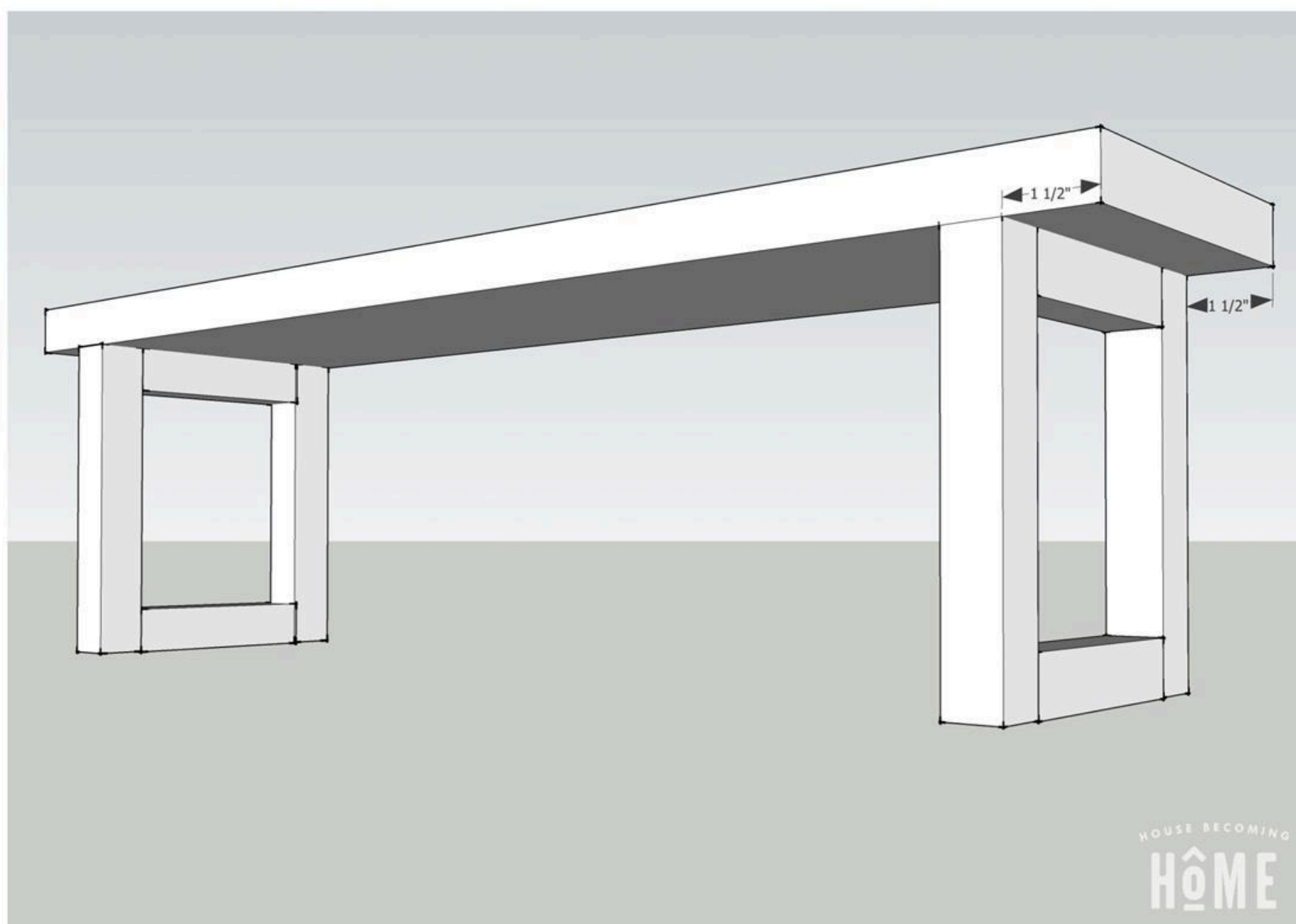

8

Sand

Sand all faces and the legs of each tier.

9

Stain

Stain all faces and legs of each tier. Once stain is dry, protect with several layers of polyurethane.

