

# DIY Over-the-Toilet Shelf

By **The Awesome Orange**

Difficulty

Easy

Have a small bathroom that is lacking storage? Well I have the perfect DIY Over-The-Toilet Shelf project to help you out! Display the pretty stuff and hide the not so pretty necessities behind the doors!





# Tools

## Kreg Tools

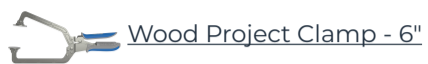

## Other Tools

Miter Saw

Square

Table Saw

Tape Measure

Drill (cordless)

Sander

# Materials

## Wood Products

**1** Board , 1x6 , 96"

**1** Board , 1x6 , 72"

**1** Plywood , 1/4" Thick , Half Sheet

## Hardware & Supplies

**28** 1 1/4" Pocket Holes Screws

**3** 1 1/4" Wood Screws (For French Cleat)

**1** Wood Glue

**1** Sandpaper

**1** Stain/Finish

# Cut List & Parts

- 4 Shelves , 18" X 5.5" X 3/4"
- 2 Sides , 27.5" X 5.5" X 3/4"
- 1 Bottom Shelf Trim , 18" X 2" X 3/4"
- 2 Doors , 10 1/4" X 9 1/2" X 1/4"
- 1 French Cleat , 18" X 3.5" X 3/4"

## DIY OVER-THE-TOILET SHELF CUT LIST

(1) 1X6X96

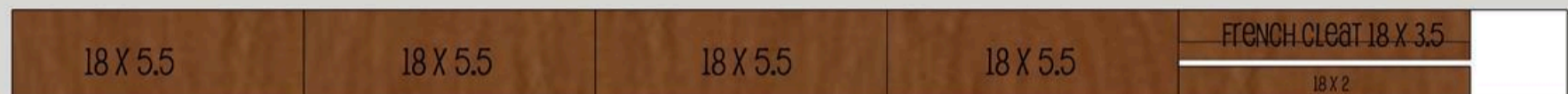

(1) 1X6X72

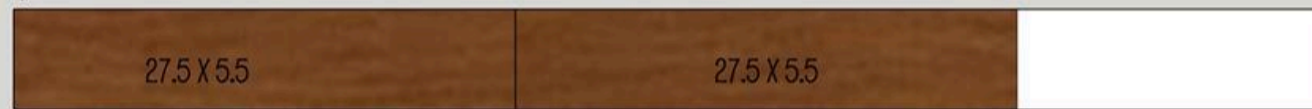

(1) 1/4 X 24 X 48



THE awesome orange

# Directions

1

## Check Dimensions & Cut List

Prior to starting this project, check the dimensions and cut list.





## 2

### Rip Dados

Using the table saw rip dados in two shelf pieces to create the tracks that the doors will slide in. You can also use a router, if preferred. On the top shelf the dados will be  $1/4$ " deep and bottom shelf need to be  $1/8$ " deep. This will allow proper installation of the doors.

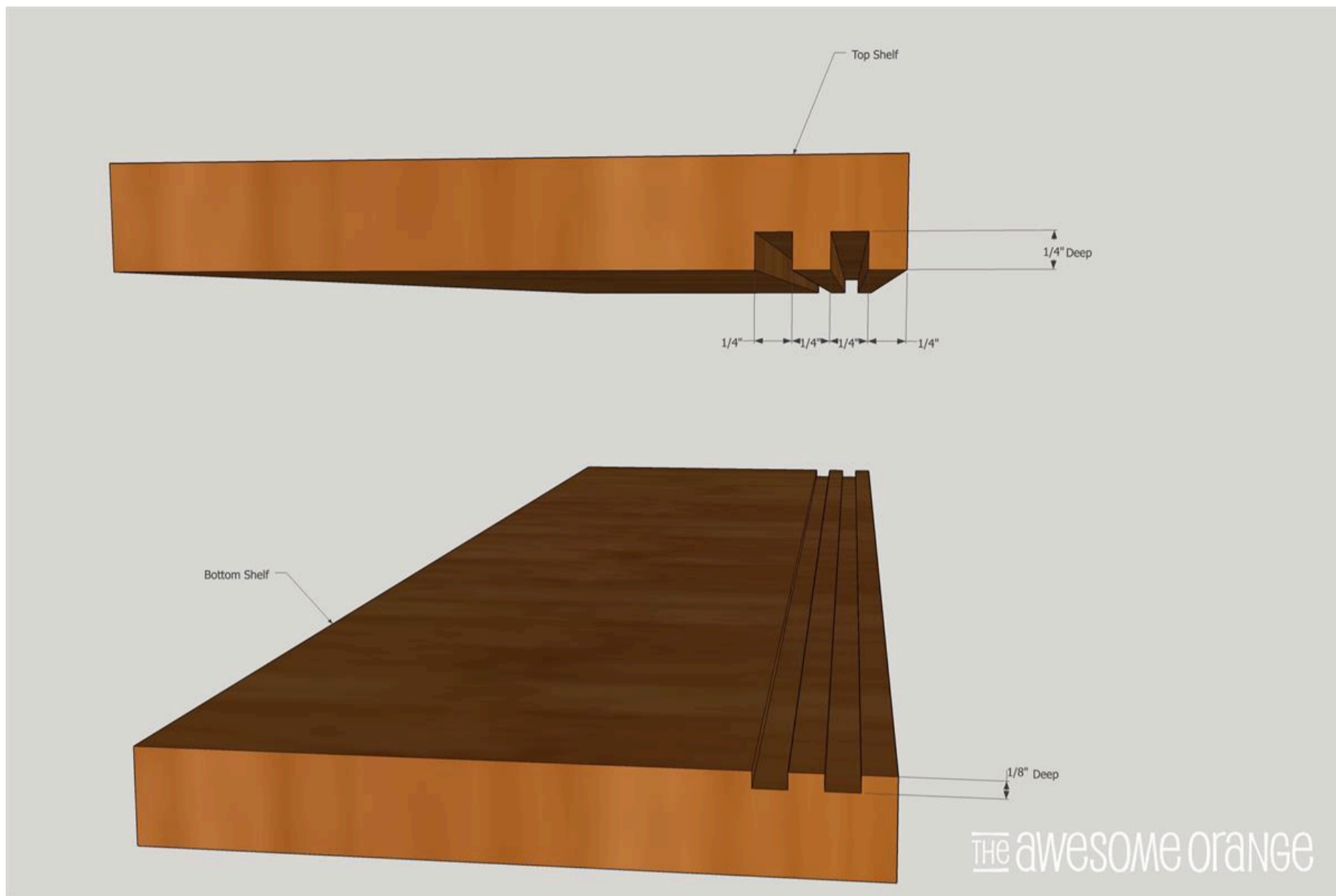

3

**French Cleat**

Rip the french cleat at a 45 degree angle on the table saw.

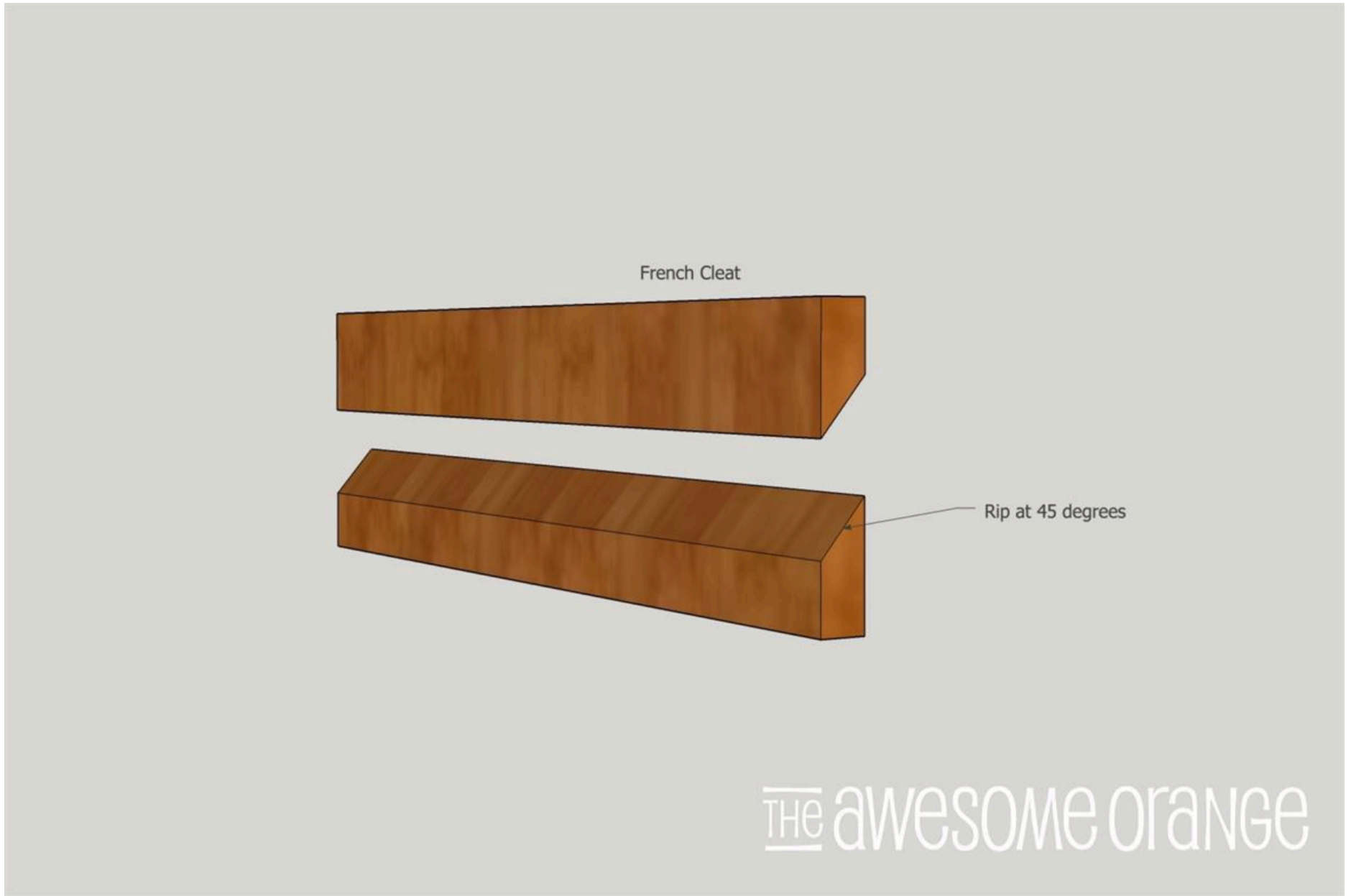

# 4

## Start Assembly

Drill 3/4" pocket holes and assemble using wood glue and 1 1/4" pocket holes screws. Start assembling with the two sides, bottom shelf and trim, then working your way up the shelves. Pay close attention to orientation of bottom and top shelf with dados. If they aren't oriented correctly doors won't work. (See picture for best pocket hole orientation.)





5

### Install French Cleat

Install top of french cleat with countersunk 1 1/4" wood screws.



6

**Attach Top**

Using 1 1/4" pocket hole screws and wood glue attach top.



7

**Finger Pulls**

Drill 1" finger holes pulls 2" from top and 2" from side.



8

### Finish It!

Sand and then finish it in your choice of stain, paint, or sealer! And then lastly install doors. Place back door in back dado at the top and it will fall into bottom dado. Repeat with front door. Waxing the dado track will help with opening and closing the doors.

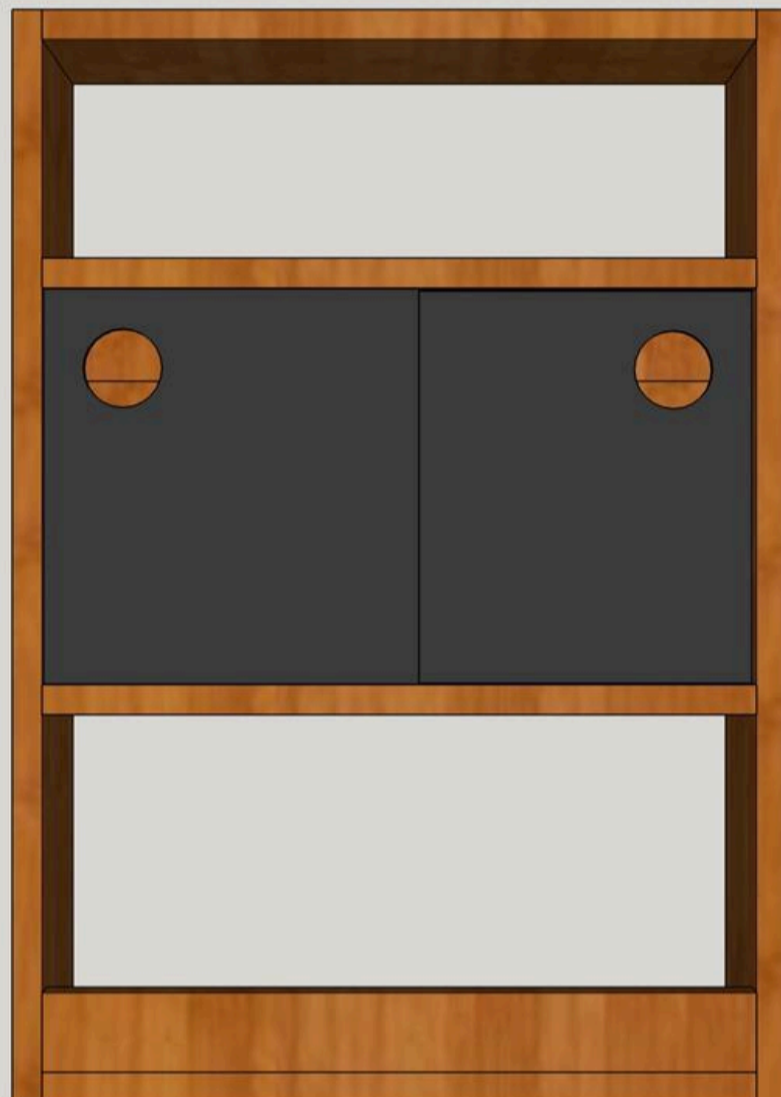

THE awesome orange

9

Visit [www.theAwesomeOrange.com](http://www.theAwesomeOrange.com)

Visit [www.theAwesomeOrange.com](http://www.theAwesomeOrange.com) for more photos of this build!

# THE awesome Orange

## Build Loud, Build Wild

---