

# Cottage Style Bookshelf

Difficulty

Moderate

A classic cottage style bookshelf complete with tongue and groove backing. I designed this simple bookshelf with clean, easy lines and a nod to the cottage aesthetic. It's plenty deep shelf space at over 12 inches can hold almost any size book. Tons of storage and two adjustable shelves.







# Tools

## Kreg Tools

- Accu-Cut™  
[Accu-Cut™](#)
- Kreg®  
Pocket-Hole Jig 720  
[Kreg® Pocket-Hole Jig 720](#)
- Shelf Pin Jig with 1/4"  
[Shelf Pin Jig with 1/4" Bit](#)

## Other Tools

- Circular Saw (cordless)
- Miter Saw
- Table Saw
- Tape Measure
- Drill (cordless)
- Sander

# Materials

## Wood Products

- 1 Plywood , 3/4" Thick , Full Sheet
- 1 Plywood , 3/4" Thick , Half Sheet
- 4 Board , 2x2 , 72"
- 1 Board , 1x2 , 96"
- 2 Board , 1x3 , 72"
- 6 Tongue & Groove , 1x6 , 96"

## Hardware & Supplies

- 50 1 1/4" Pocket Hole Screws
- 4 2" Wood Screws
- 24 1 1/4" Wood Screws

# Cut List & Parts

- 4 Legs , 2 X 2 @ 59 1/4"
- 4 Side Trim , 1 X 3 @ 12"
- 2 Side Panels , 3/4" X 12 X 56 1/2"
- 2 Shelves , 3/4" X 12 X 31 1/2"
- 1 Top (Carcass) , 3/4" X 12 X 33"
- 2 Shelf Trim , 1 X 3 @ 31 1/2"
- 1 Shelf Trim , 1 X 3 @ 31 1/2"
- 2 Shelves (Movable) , 3/4" X 12 X 31 1/4"
- 2 Shelf Trim (Movable) , 1 X 2 @ 31 1/4"
- 1 Top , 3/4" X 15 3/4" X 36"
- 6 Backing (Tongue & Groove) , 1 X 6 @ 57 1/4"

# Directions

1

## Dimensions

Overall dimensions: 60"h x 36"w x 15 3/4"d

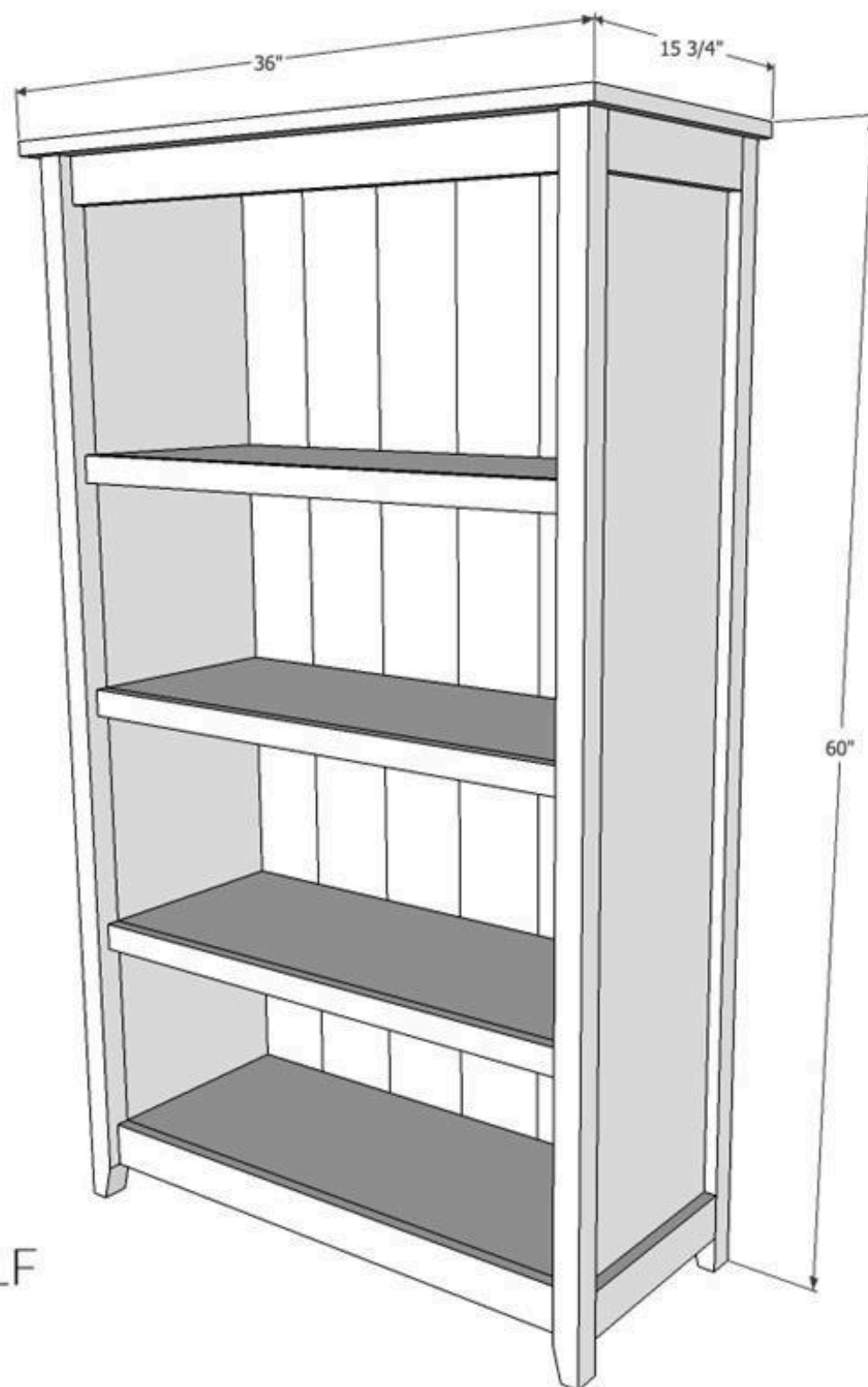

COTTAGE BOOKSHELF  
DIMENSIONS

JAIMECOSTIGLIO.COM

2

### Step 1

Create the tapered end on each leg using a jigsaw or table saw.

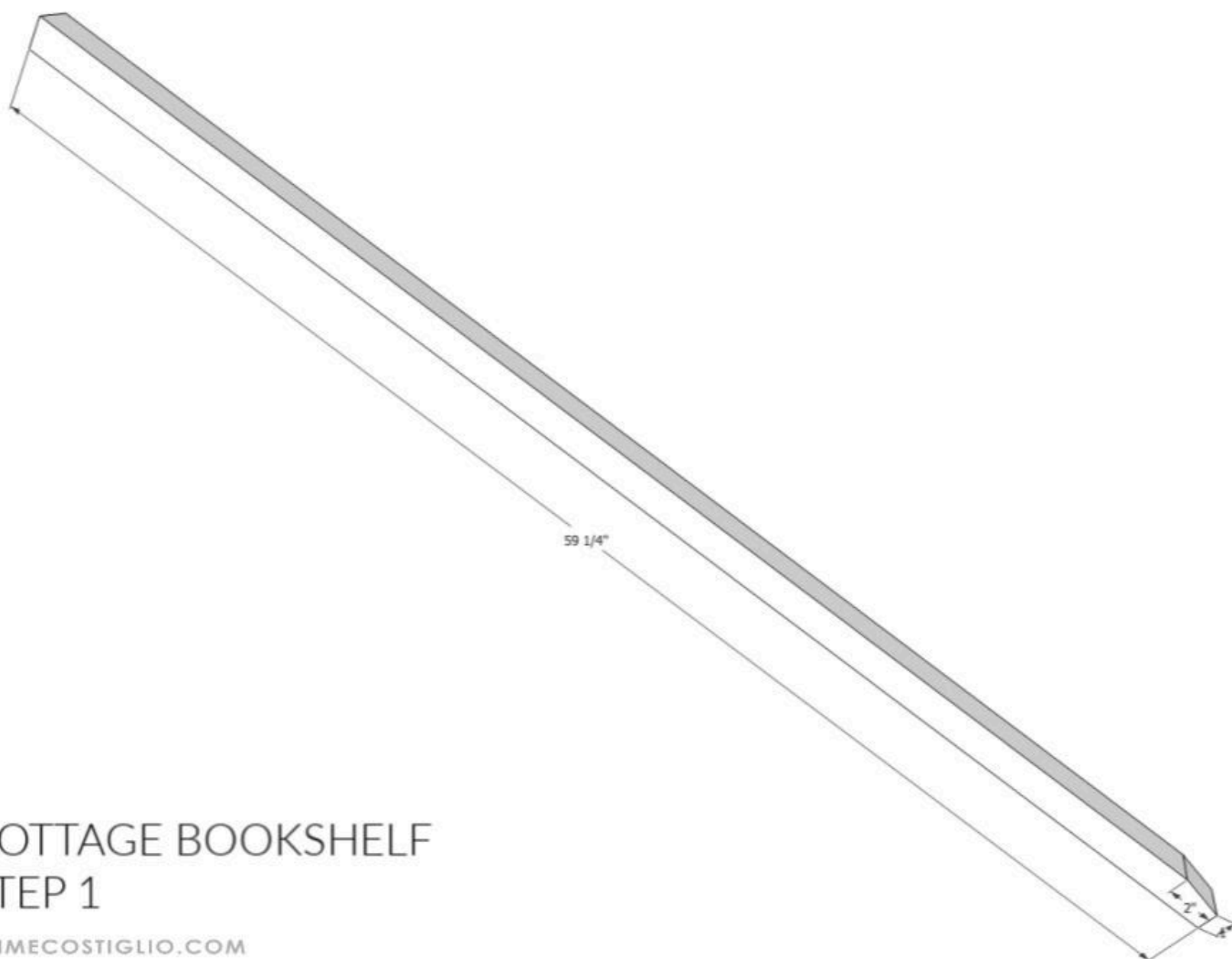

COTTAGE BOOKSHELF  
STEP 1

JAIMECOSTIGLIO.COM

**3****Step 2**

Attach the side panel cross supports using pocket holes and 1 1/4" pocket hole screws. Make 2.

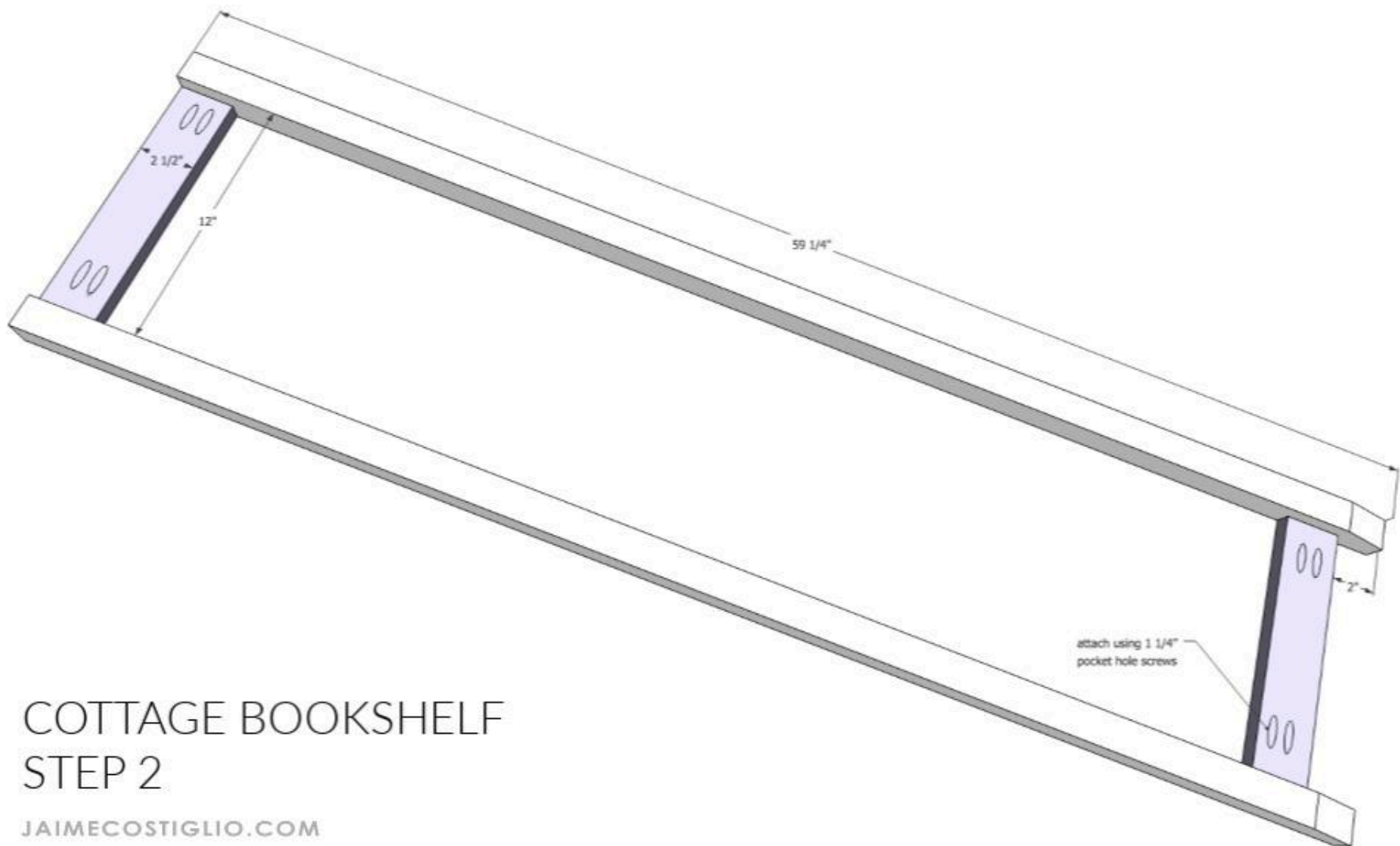

COTTAGE BOOKSHELF  
STEP 2

JAIMECOSTIGLIO.COM



**4****Step 3**

Attach the side panel into the frame using 1 1/4" pocket hole screws. Make 2.

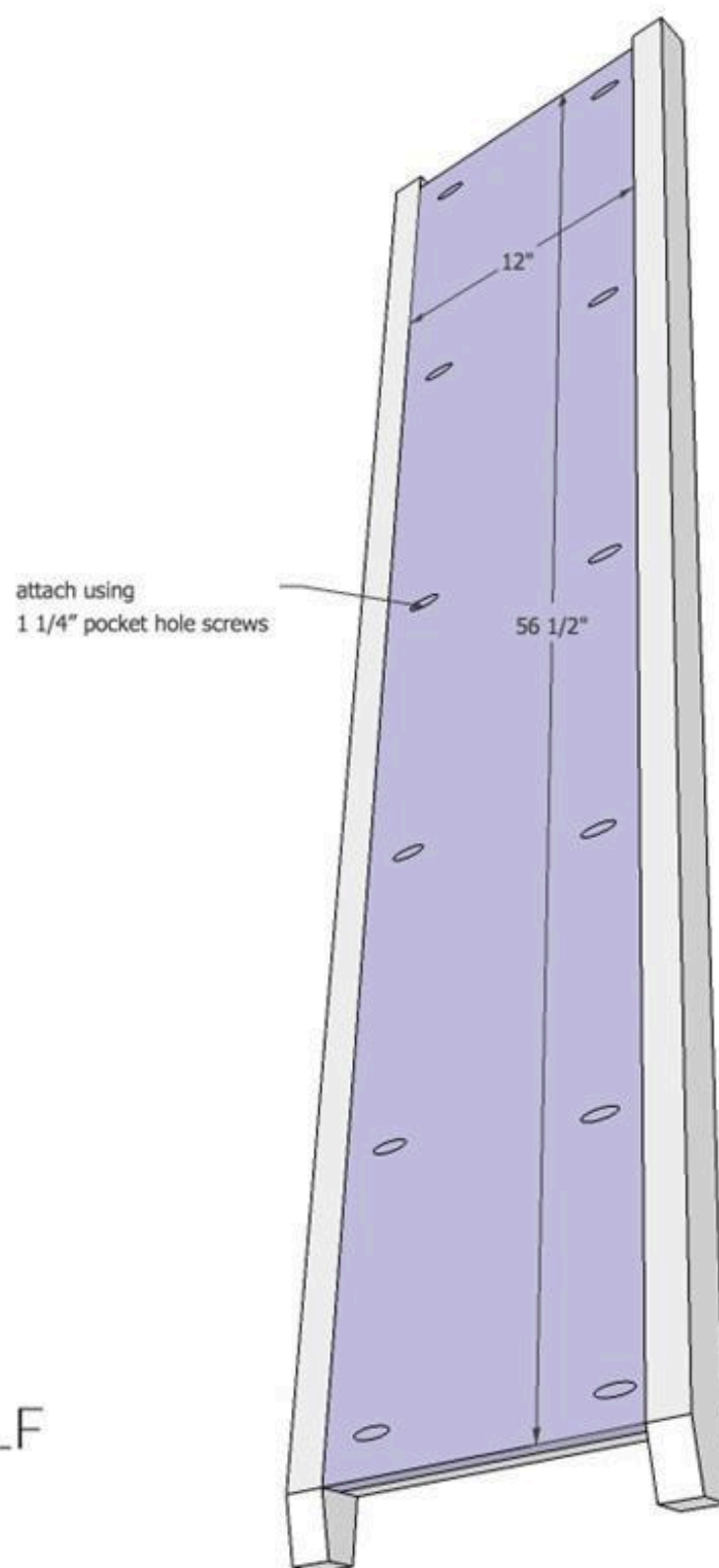

COTTAGE BOOKSHELF  
STEP 3

JAIMECOSTIGLIO.COM



5

#### Step 4

Attach fixed shelves to side panel using 1 1/4" pocket hole screws.

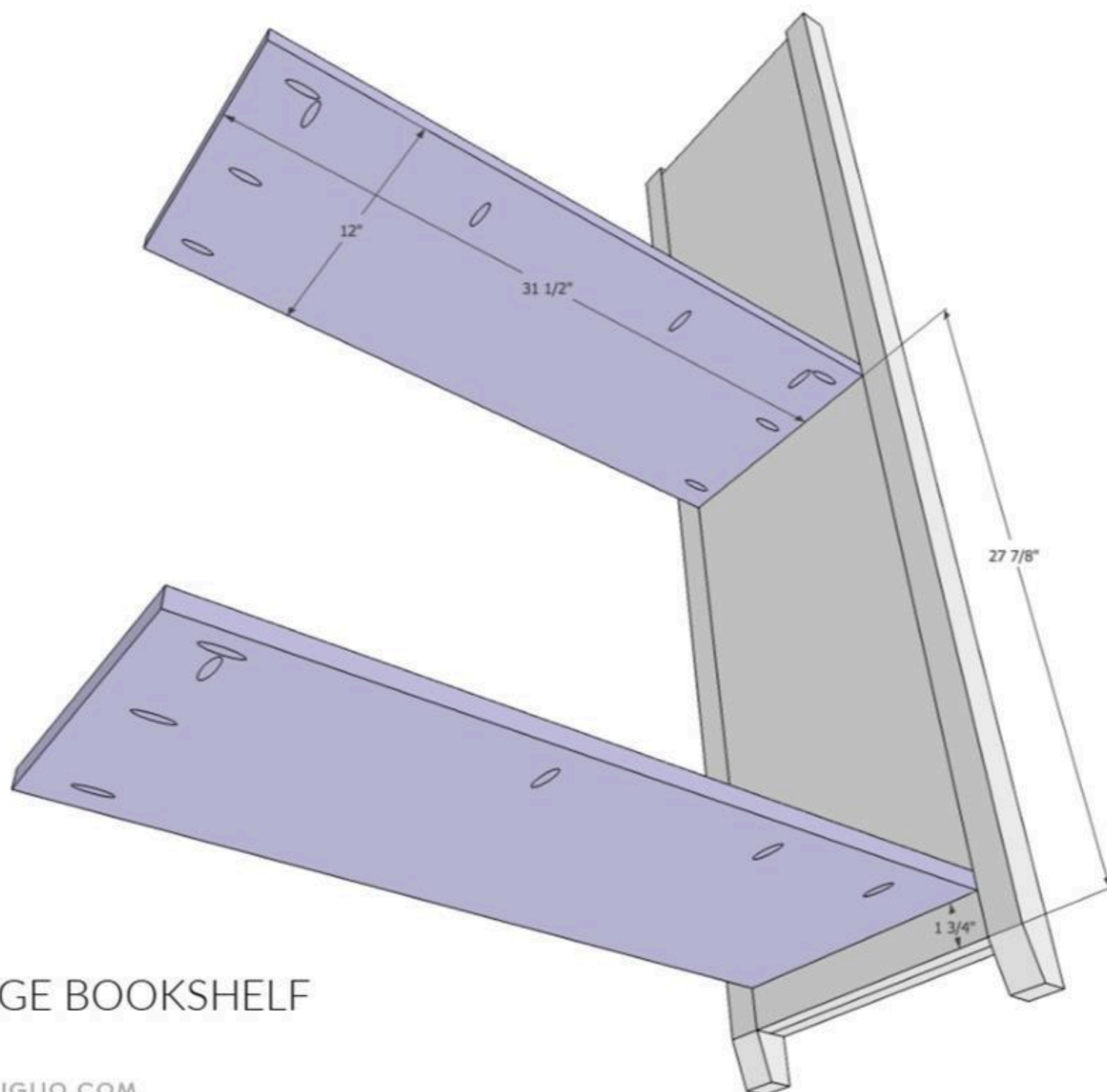

COTTAGE BOOKSHELF  
STEP 4

JAIMECOSTIGLIO.COM

6

## Step 5

Attach second side panel to other end of fixed shelves using 1 1/4" pocket hole screws.

# COTTAGE BOOKSHELF STEP 5

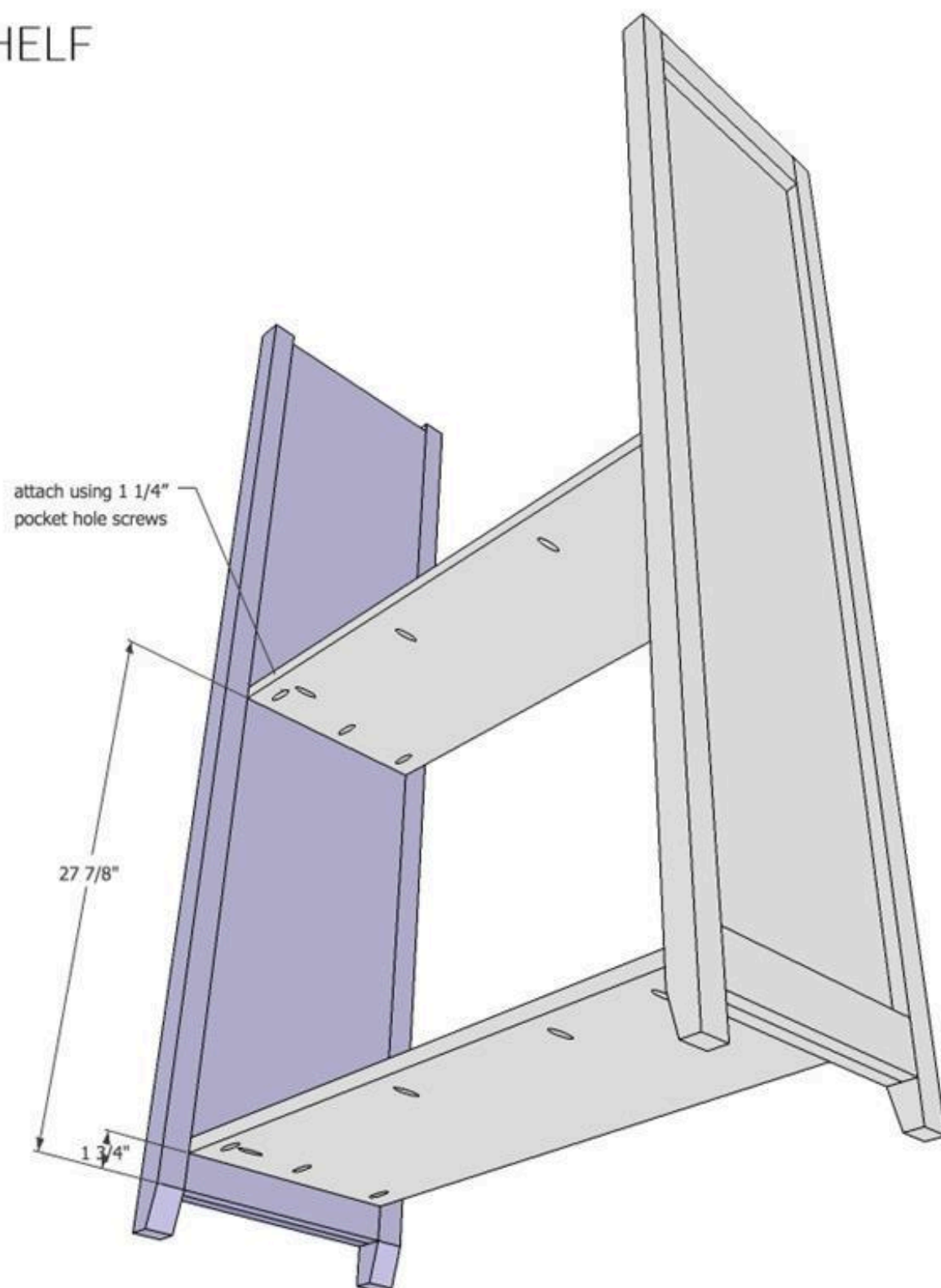

JAIMECOSTIGLIO.COM

**7****Step 6**

Attach carcass top to side panels using countersunk 2" wood screws.

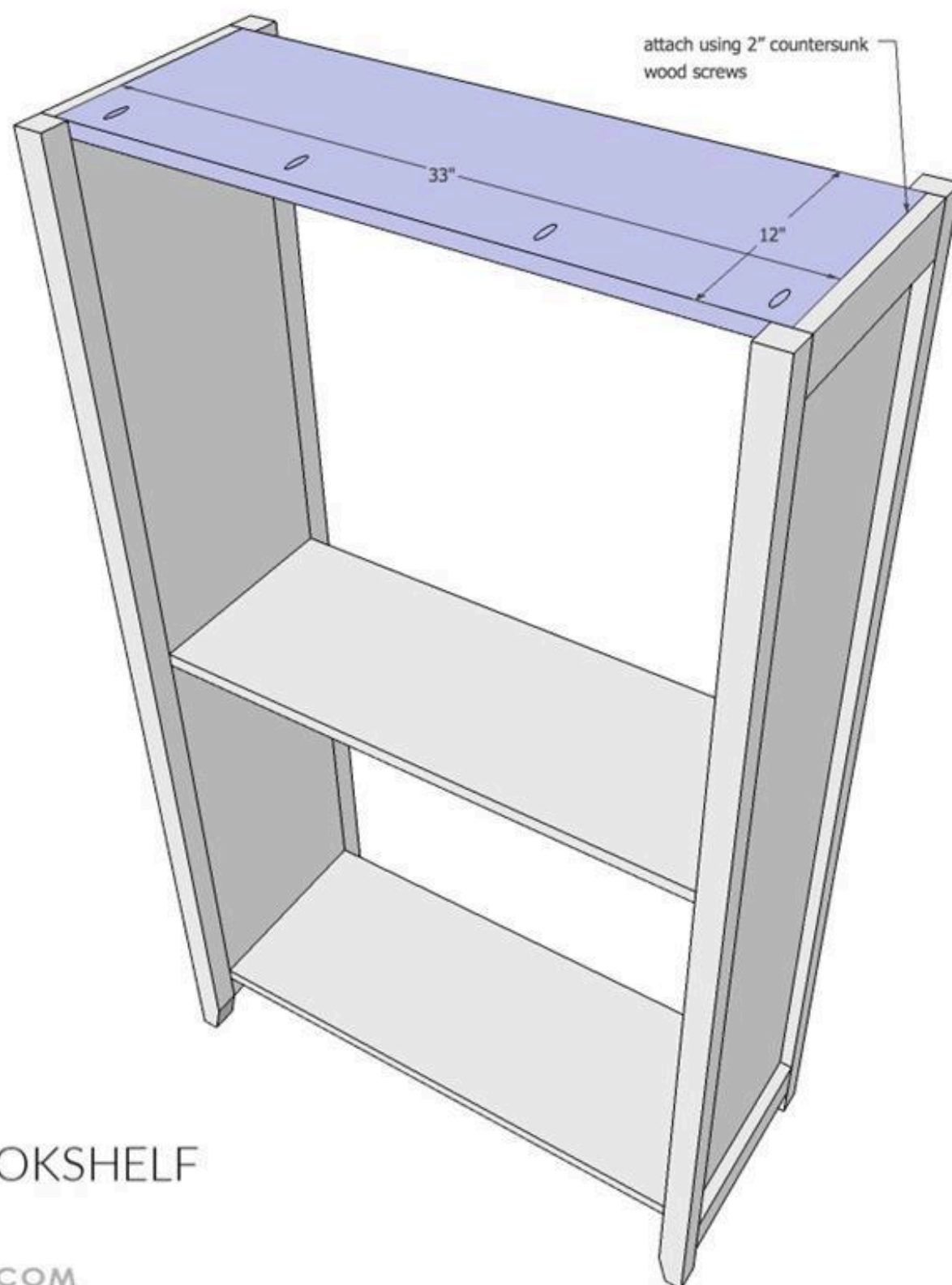

COTTAGE BOOKSHELF  
STEP 6

JAIMECOSTIGLIO.COM

8

## Step 7

Attach front trim to shelves using 1 1/4" pocket hole screws.

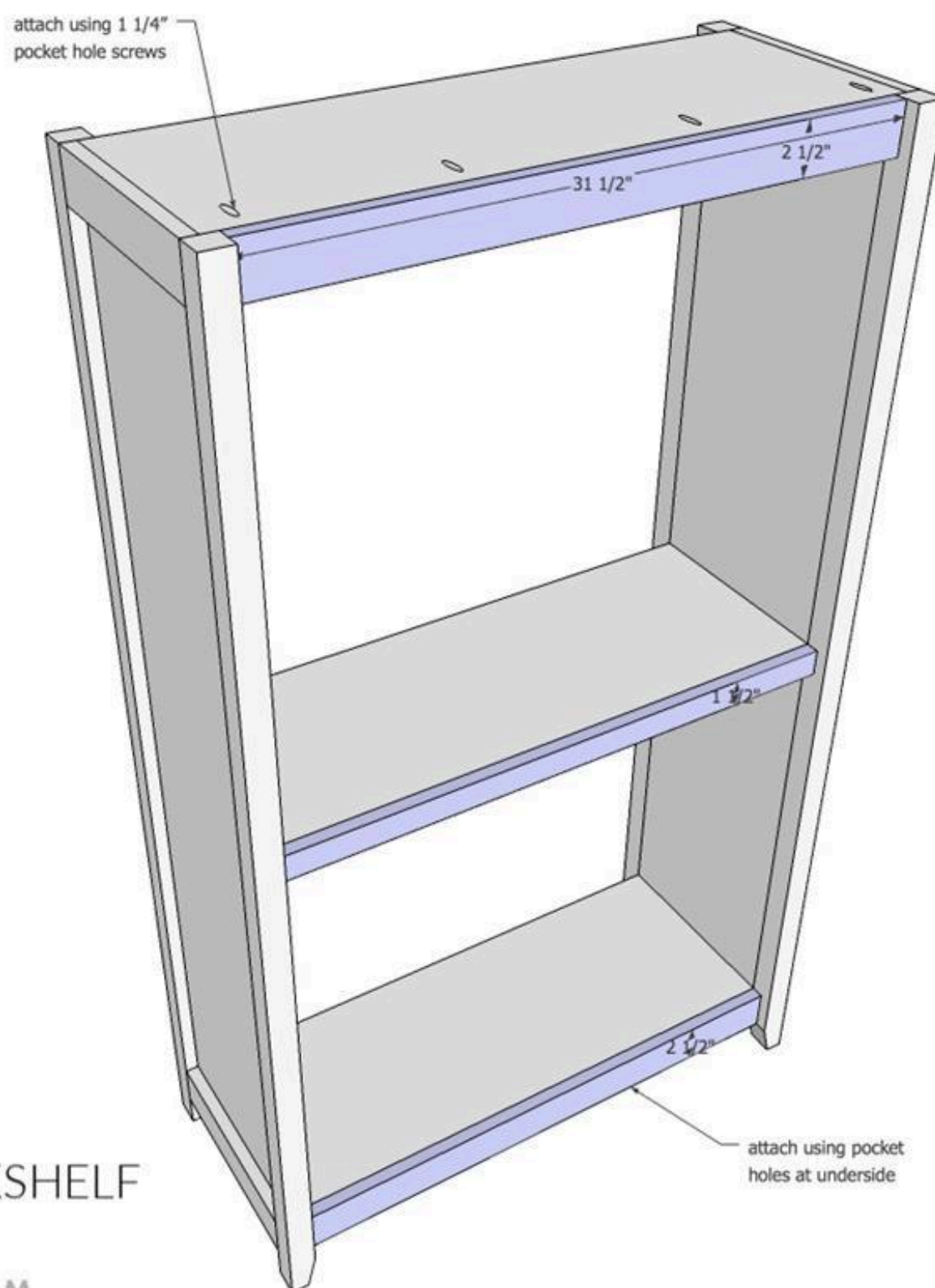

COTTAGE BOOKSHELF  
STEP 7  
JAIMECOSTIGLIO.COM

9

### Step 8

Attach top to carcass using countersunk 1 1/4" wood screws.

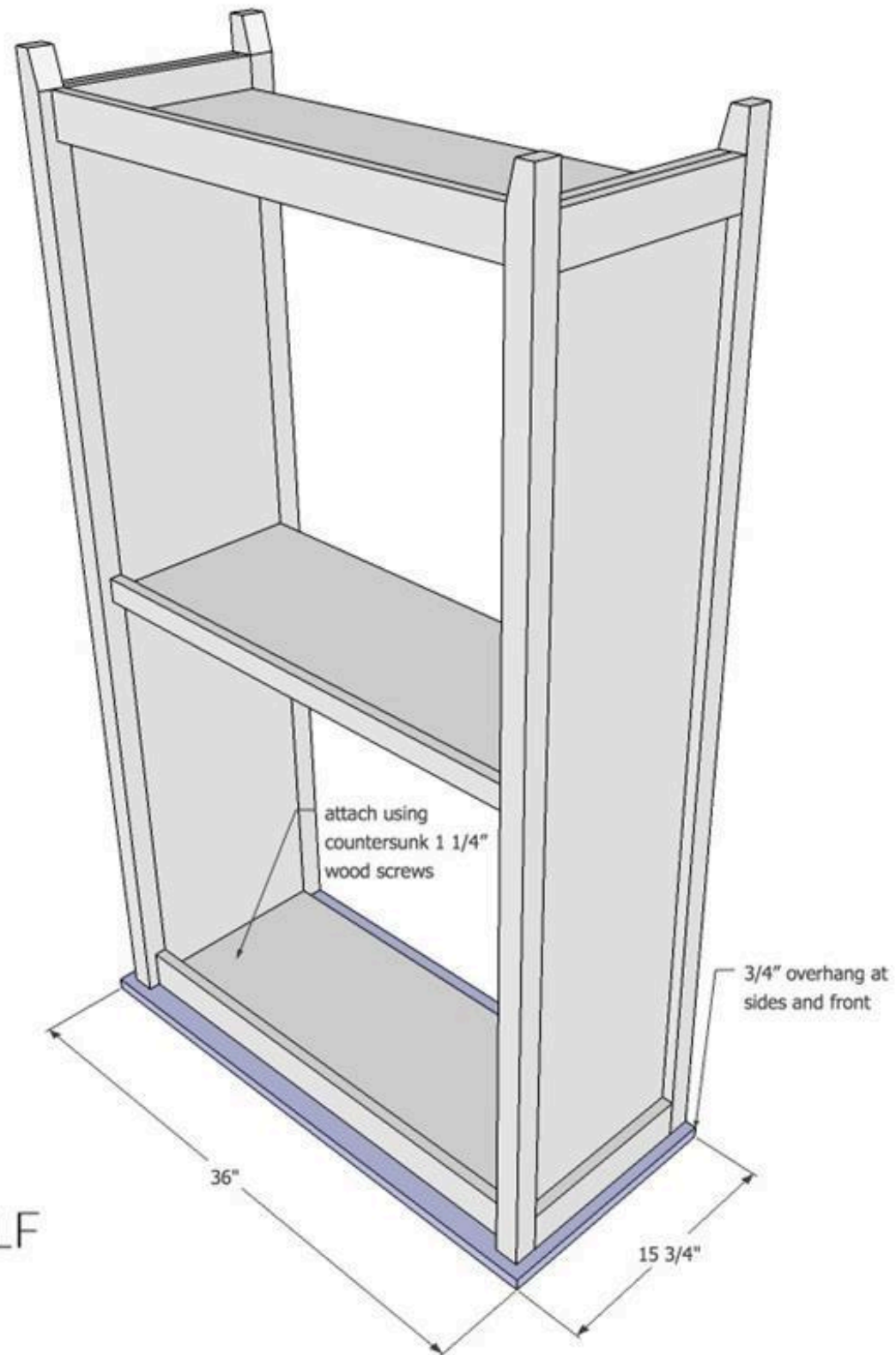

COTTAGE BOOKSHELF  
STEP 8

JAIMECOSTIGLIO.COM



**10****Step 9**

Make two movable shelves. Attach front trim to shelf using 1 1/4" pocket hole screws.

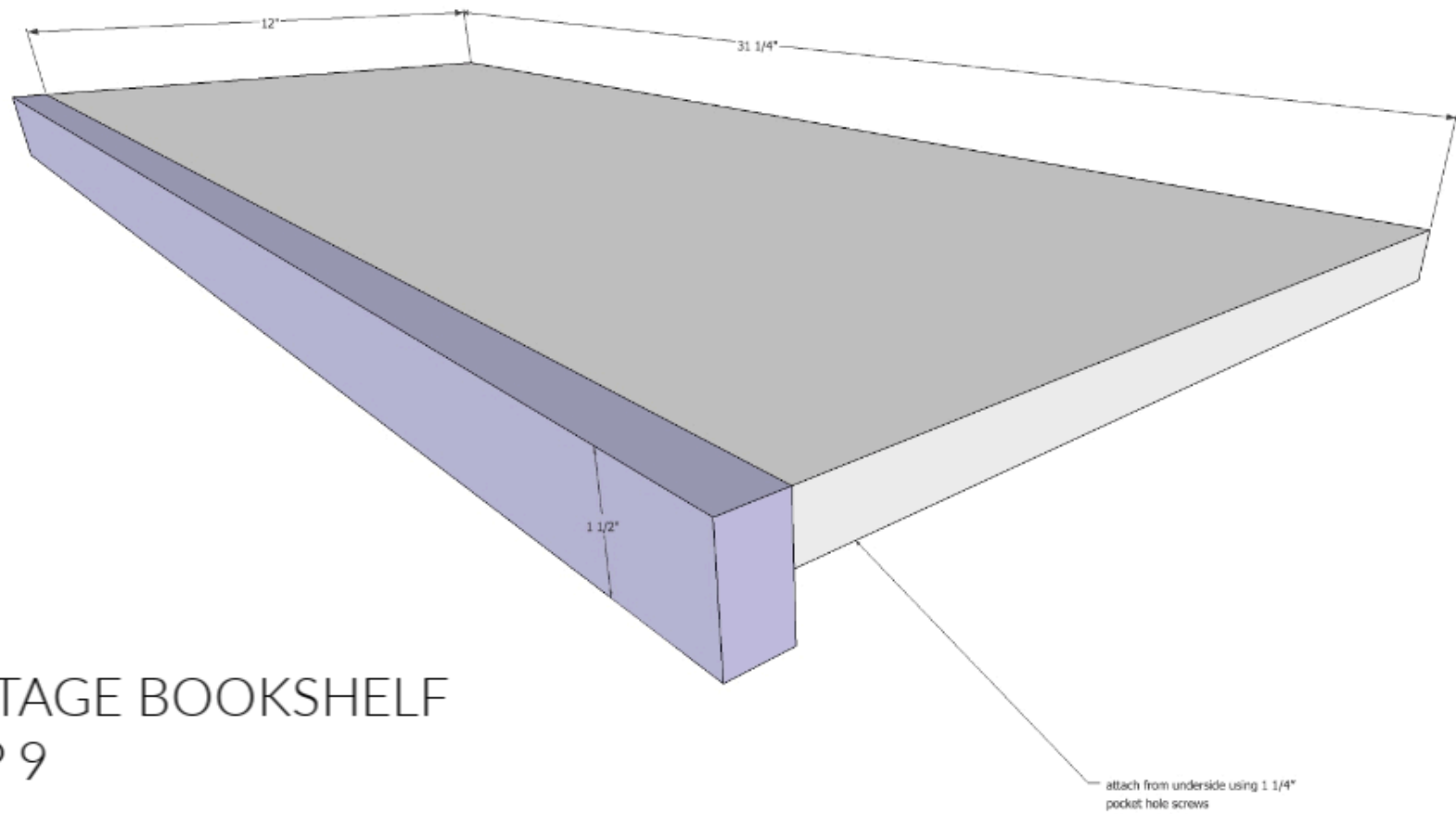

COTTAGE BOOKSHELF  
STEP 9

JAIMECOSTIGLIO.COM

11

## Step 10

Attach tongue and groove backing to carcass using countersunk 1 1/4" wood screws.

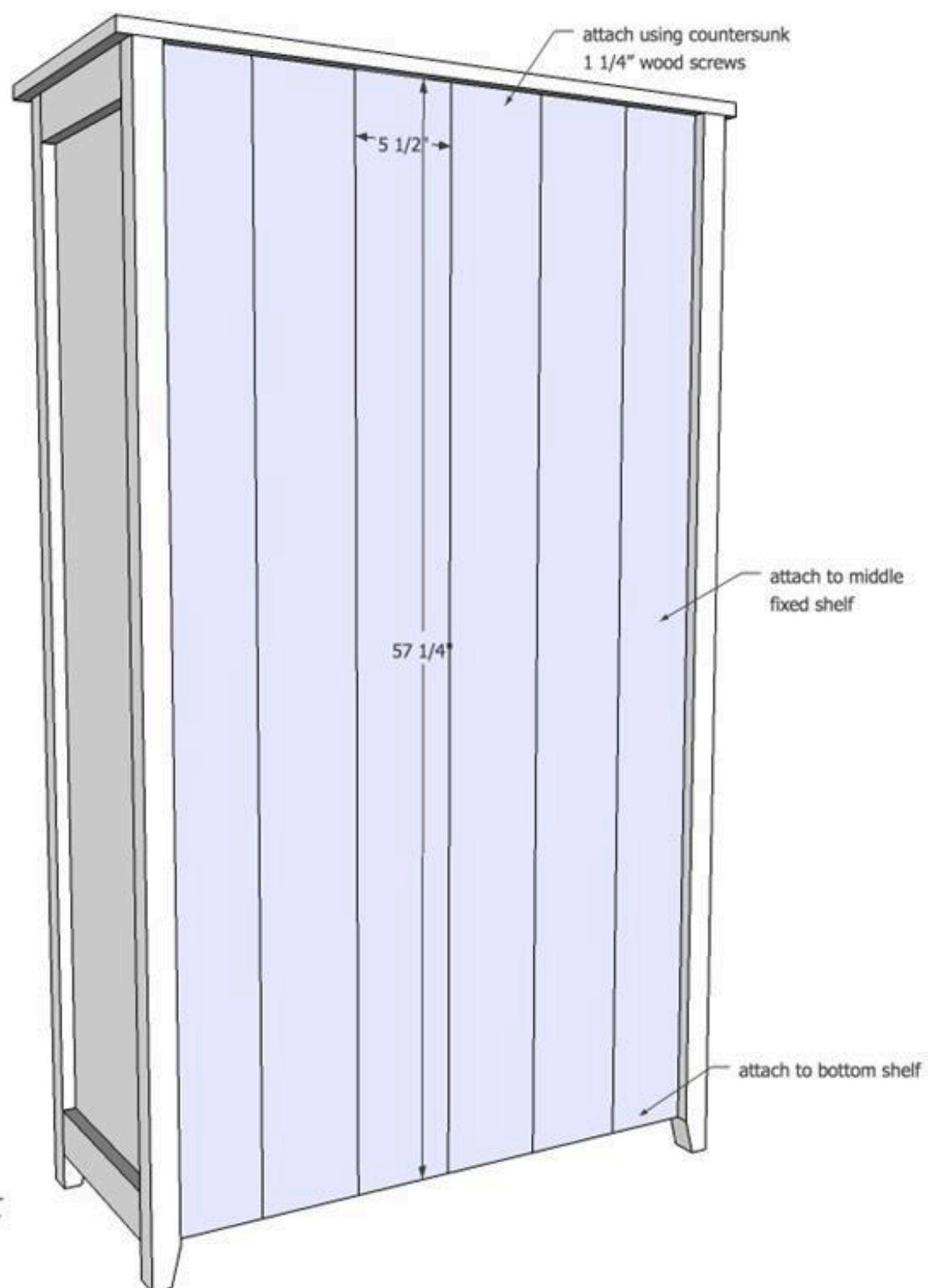

COTTAGE BOOKSHELF  
STEP 10