

Buffet Cabinet with Drawers

Difficulty
Moderate

This is an advanced build for a really quality buffet cabinet with 4 drawers. This is a stunning piece of furniture that is sturdy and sure to stand the test of time. This build is a slightly more complicated- with drawers and doors, but is a fun and creative build.





Tools

Kreg Tools

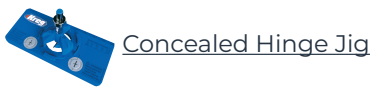

Other Tools

Circular Saw (corded)

Jigsaw

Miter Saw

Drill (cordless)

Sander

Nail Gun

Materials

Wood Products

2 Plywood , 3/4" Thick , Full Sheet

1 Plywood , 1/4" Thick , Full Sheet

2 Board , 2x4 , 96"

8 Board , 2x2 , 96"

1 Board , 1x2 , 96"

6 Board , 1x4 , 96"

1 Plywood , 3/4" Thick , Half Sheet

Hardware & Supplies

4 Cabinet Door Hinges (See Kreg Hinge Concealed Jig Instructions For Type Needed)

4 Drawer Slides

6 Drawer And Door Handles Or Knobs

50 2 1/2" Pocket Hole Screws

50 1 1/4" Pocket Hole Screws

10 2 1/2" Grabber Screws

8 Simpson A21 (2" X 1-1/2" 90 Degree Angle) Ties (To Attach Table Top)

20 1/2" Screws

1 Wood Glue

100 Finish Nails + Nail Gun

Cut List & Parts

- 2 Bottom Frame Pieces , 60 3/4" 2x4
- 2 Bottom Frame Pieces , 18" 2x4
- 2 Bottom Frame Pieces , 15" 2x4
- 4 Frame Pieces , 34 1/2" 2x2
- 4 Frame Pieces , 18" 2x2
- 3 Frame Pieces , 63 3/4" 2x2
- 2 Frame Pieces , 31 1/2" 2x2
- 4 Frame Pieces , 15" 2x2
- 2 Frame Peices , 33" 2x2
- 2 Shelf Supports , 15" 1x2
- 3 Drawer Supports , 20" 2x2
- 2 Trim Pieces , 18 1/4" 1x4
- 1 Trim Piece , 67 3/4" 1x2
- 4 Trim Pieces , 24 7/16" 1x2
- 4 Trim Pieces , 20 1/4" 1x4
- 1 Table Top , 69" X 19"- 3/4" Plywood
- 8 Drawer Box Sides , 16" X 5 1/2"- 3/4" Plywood
- 4 Drawer Box Bottoms , 18 1/4" X 16"- 3/4" Plywood
- 4 Drawer Box Backs , 18 1/4" X 5 1/2"- 3/4" Plywood
- 4 Drawer Fronts , 19 7/8" X 6 5/8"- 3/4" Plywood
- 1 Buffet Backing , 38" X 66 3/4"- 1/4" Plywood
- 2 Shelves , 20 3/4" X 16 1/2"- 3/4" Plywood

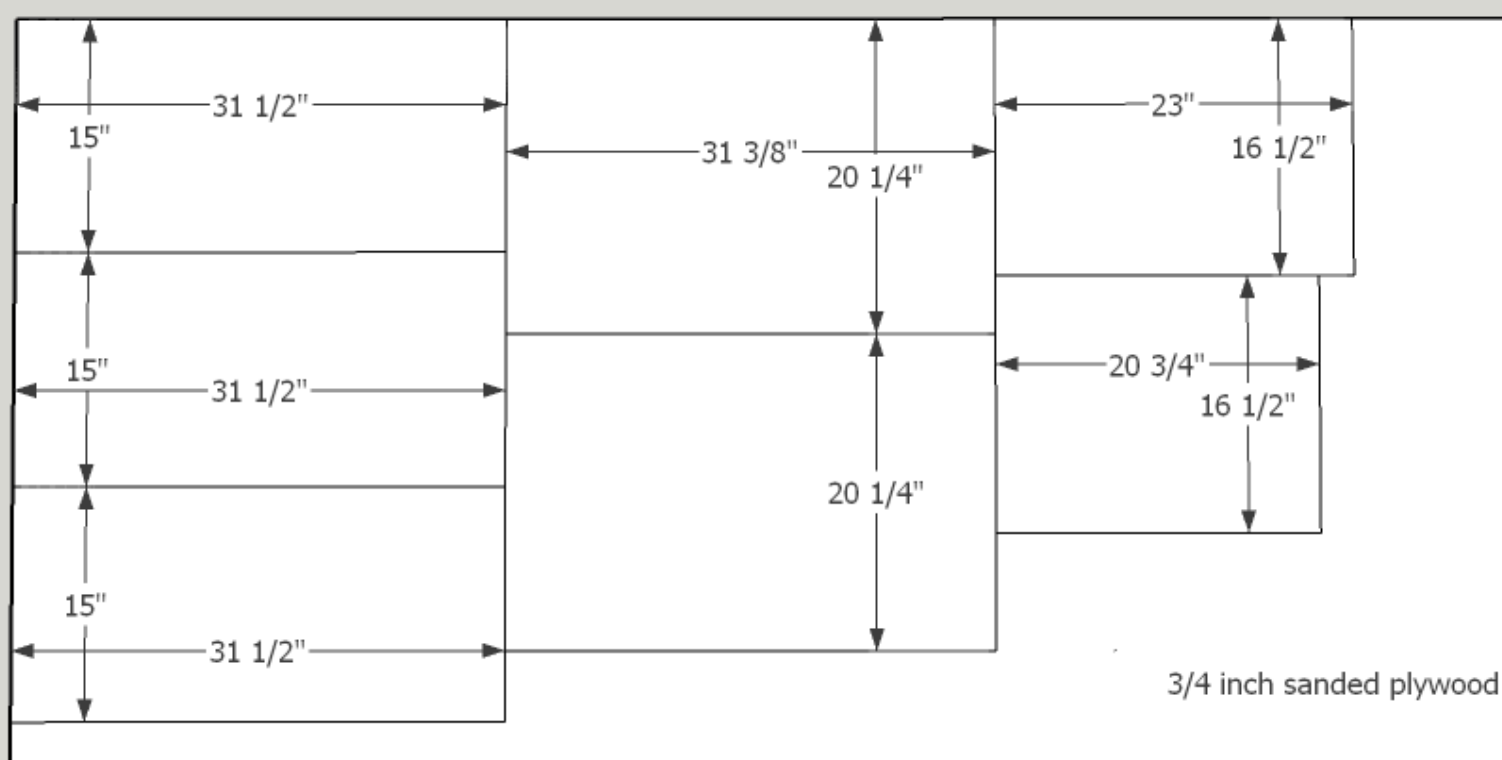

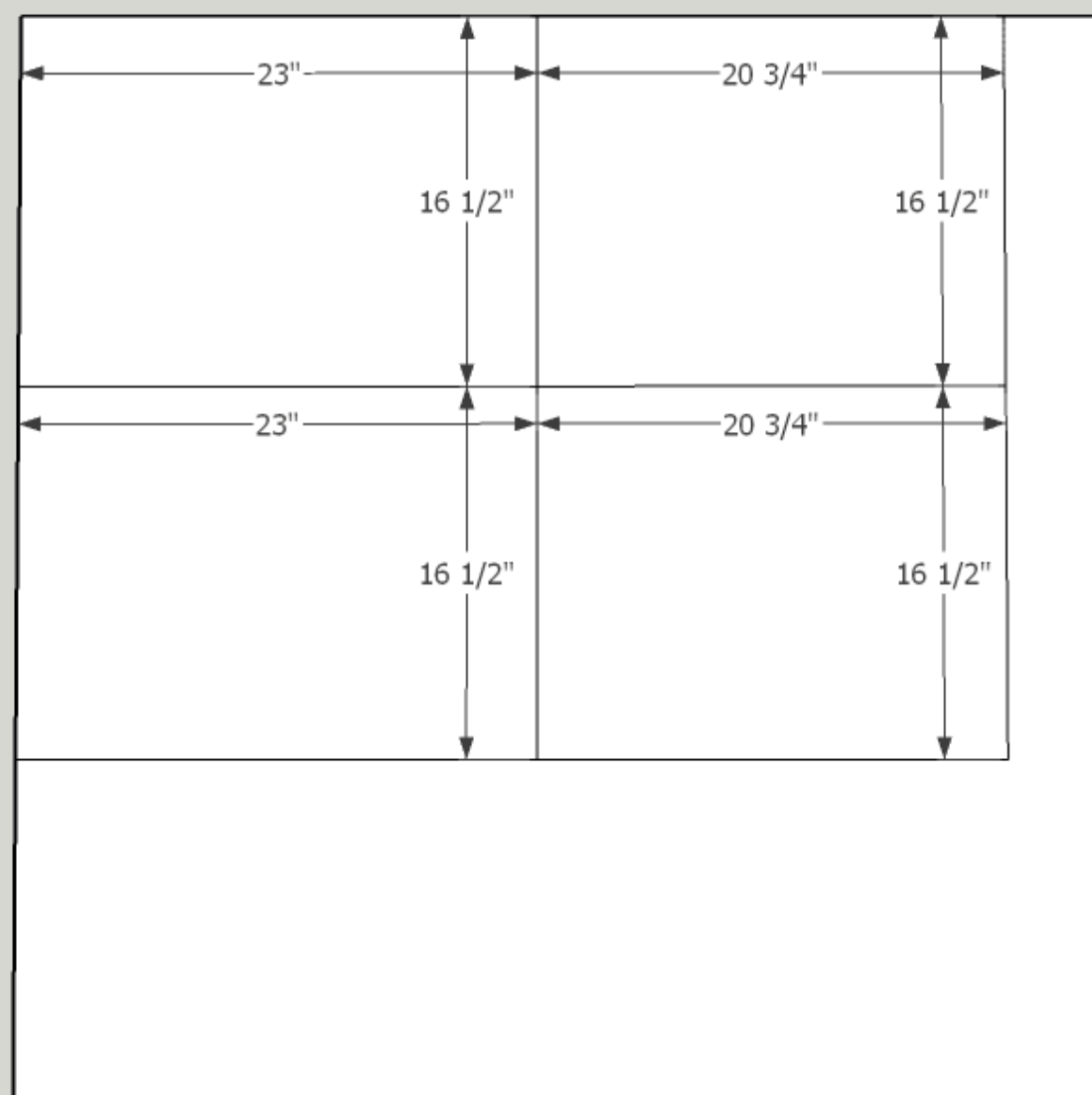

3/4" plywood

see plans for detailed cuts for shelves.

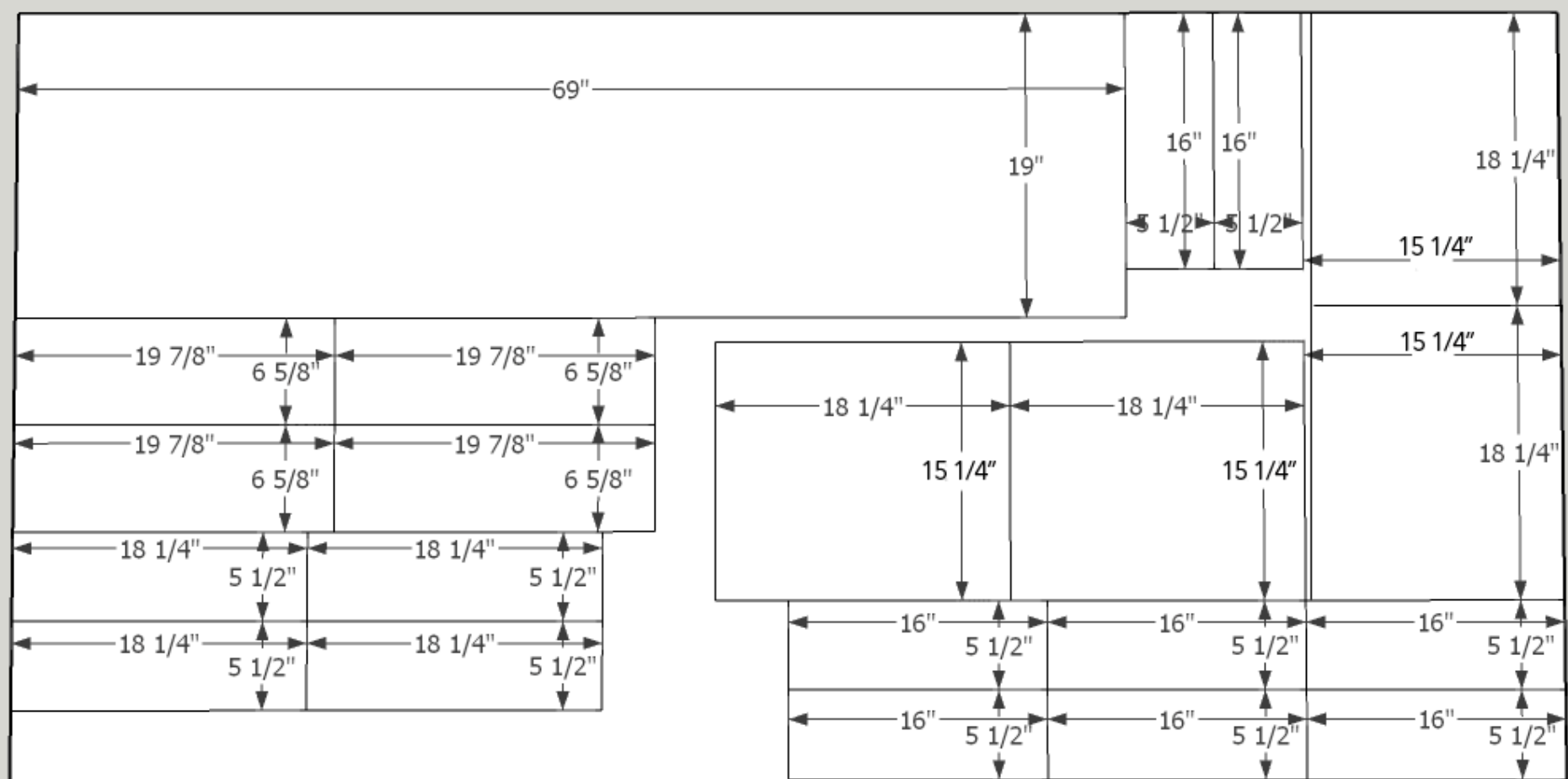

3/4" plywood

Directions

1

Build Base Frame

Cut 2- 63 3/4" 2x4's. Drill pocket hole screws in both ends.

Cut 2- 15" 2x4's. Drill pocket hole screws in both ends.

Cut 2- 18" 2x4's.

Using wood glue and 2 1/2 inch pocket hole screws, attach your 2x4's to create a base frame.

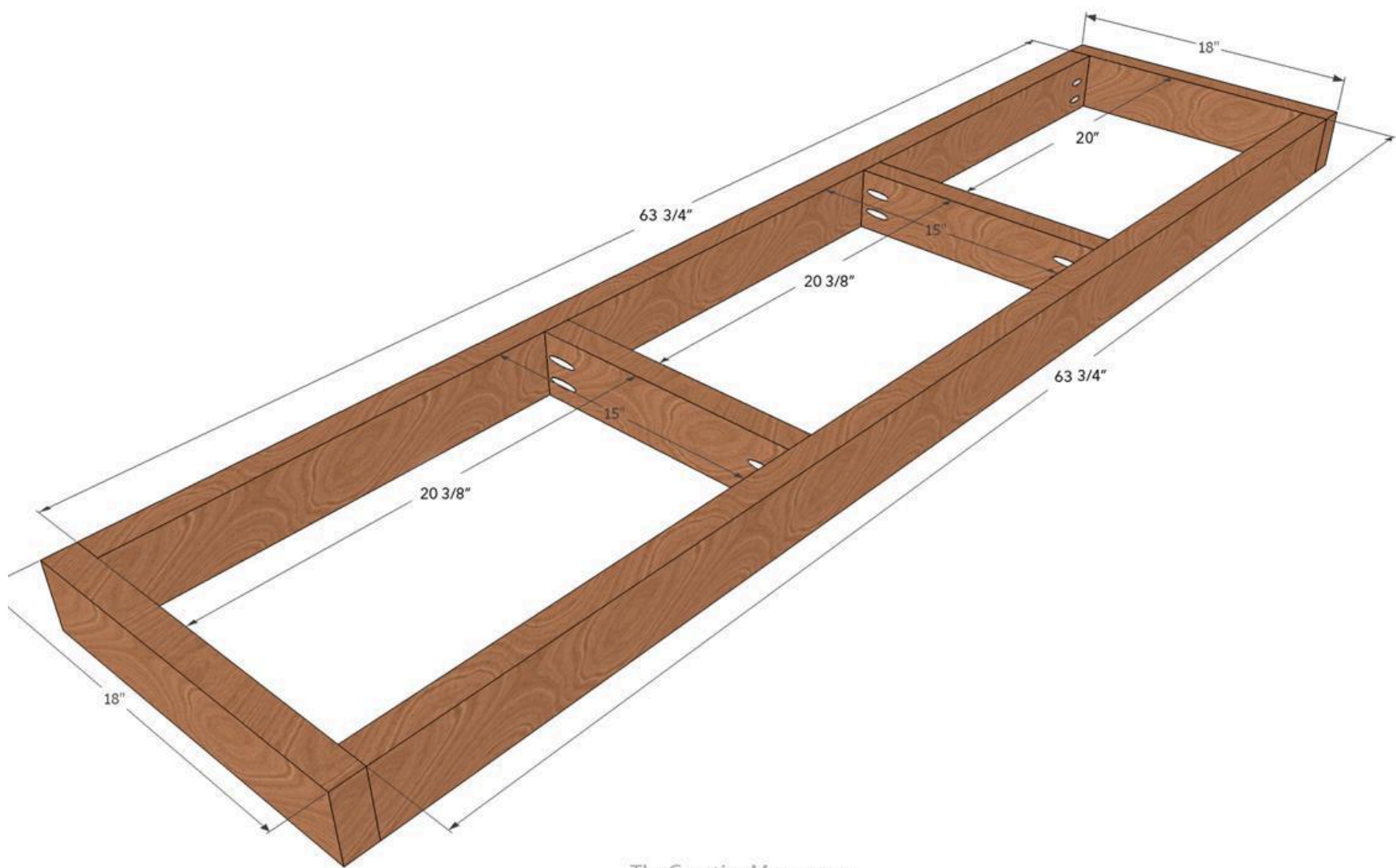

TheCreativeMom.com

2

Build End Panels

Cut 2- 18" 2x2's. Drill pocket holes in both ends.

Cut 2- 34 1/2" 2x2's.

Use wood glue and 2 1/2 inch pocket hole screws to build 2 frames for your end panels. Use a carpenters square to ensure your frames are square.

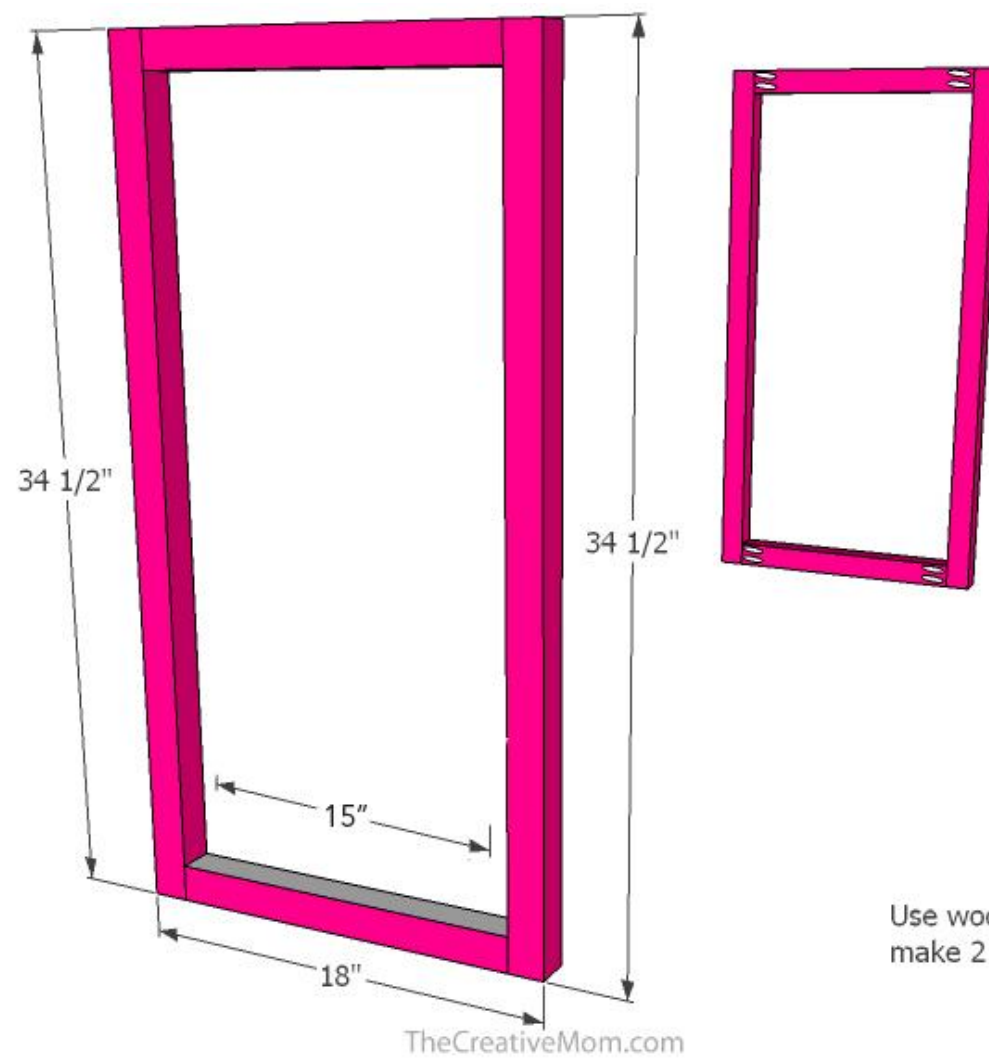

Use wood glue and pocket hole screws to make 2 frames for your end panels

3**Attach End Panel Frames**

Using 2 1/2 inch grabber screws to attach the end panel frames to the base frame. Make sure the screws are toward the inside of the frame so your plywood panel will cover it once it's attached.



4

Add plywood to end panels

Use a circular saw and the Kreg Rip-Cut to cut 2 pieces of 3/4" plywood 15" x 31 1/2". Drill pocket holes in the back of the plywood on each side.

Use wood glue and 1 1/4 inch pocket hole screws to attach plywood to the end panel frames. Make sure the plywood is flush with the inside (the side with the pocket holes) of the end panel frames.

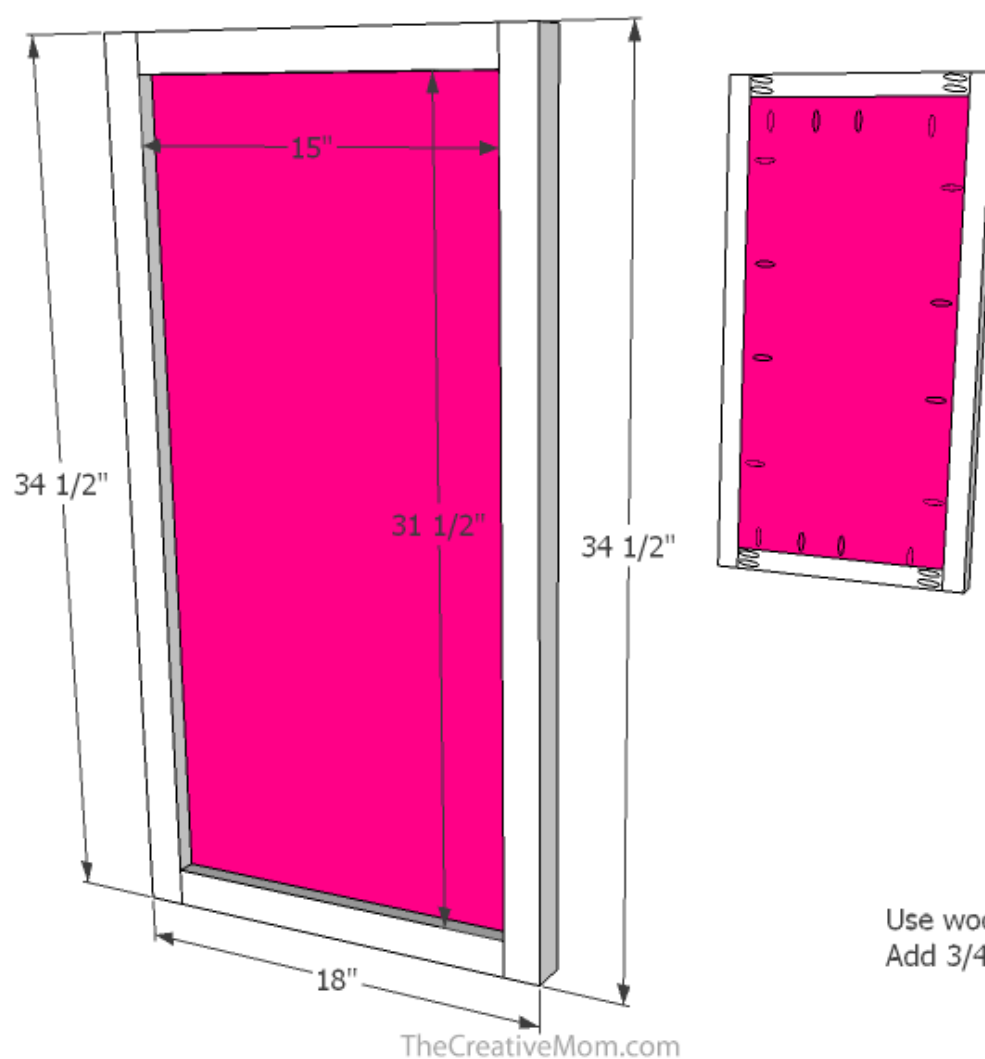

Use wood glue and pocket hole screws to
Add 3/4" plywood to inside of frames

5**Base frame + end panels**

At this point, you should have a base frame with end panels attached.

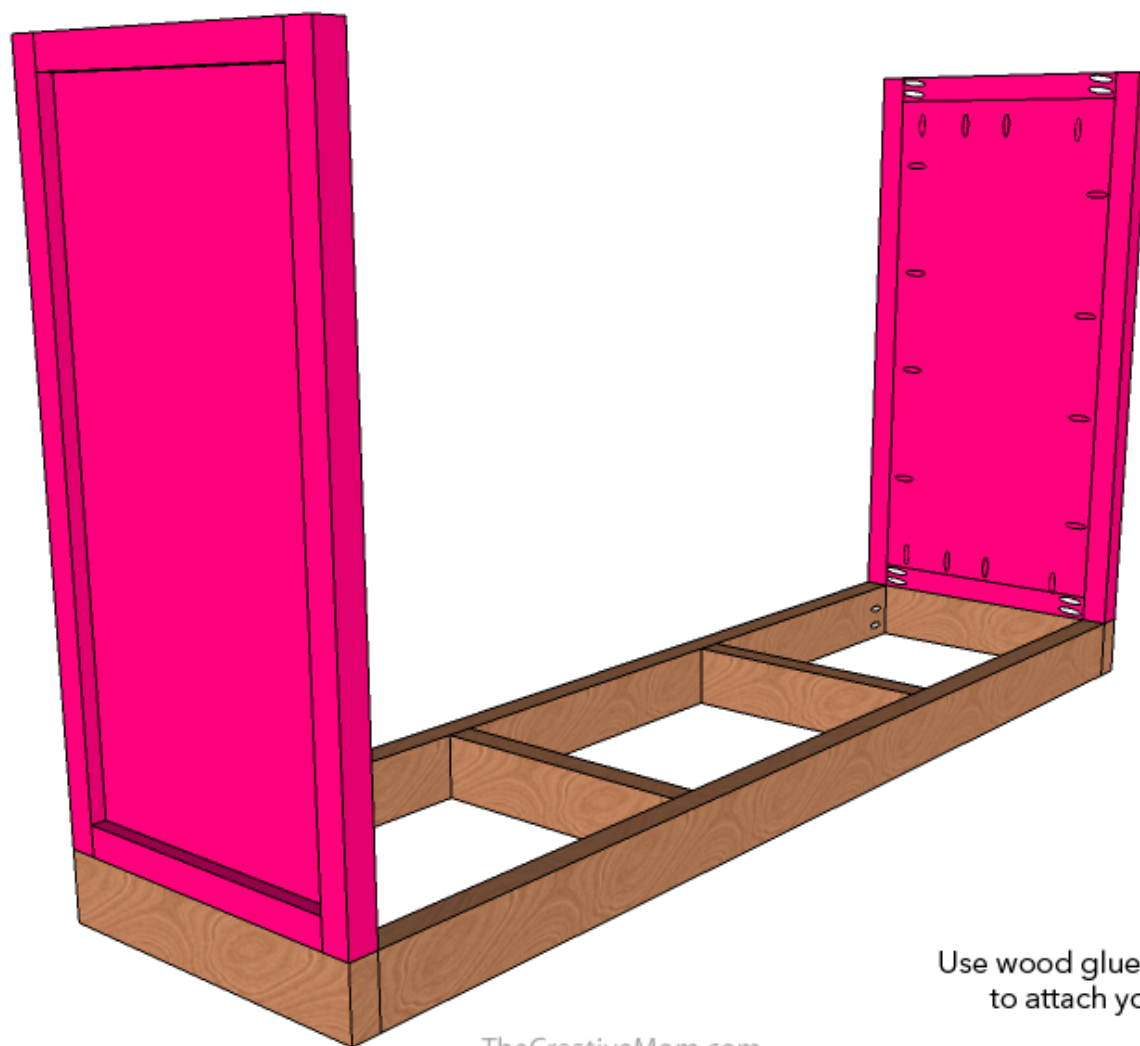

Use wood glue and pocket hole screws to attach your inlayed plywood.

6**Attach Horizontal Crossbar**

Cut a 63 3/4" 2x2. Use 2 1/2" grabber screws to attach the board to the front of the cabinet.

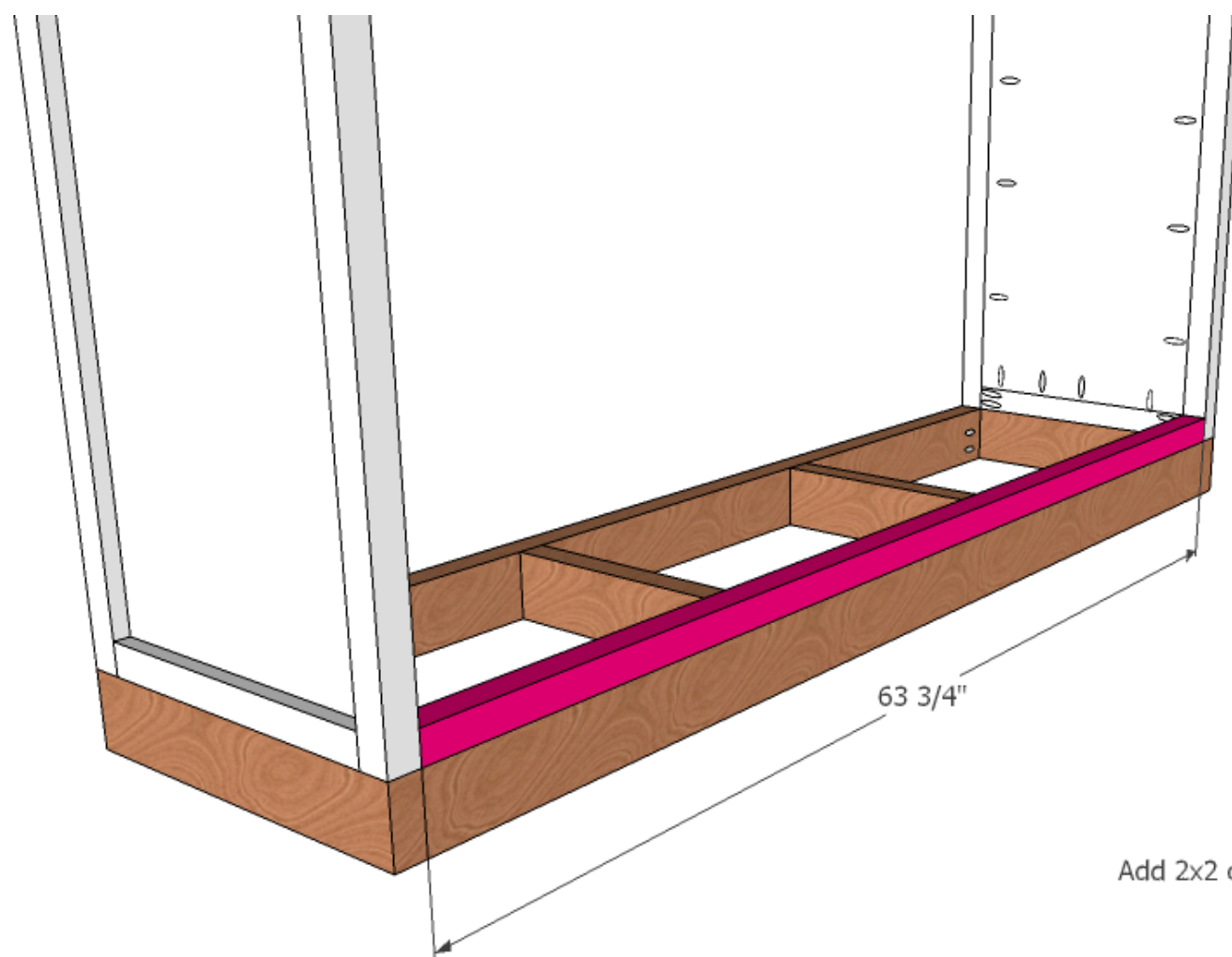

Add 2x2 cross bar on bottom of front

TheCreativeMom.com

7**Attach top frame**

Cut 2- 63 3/4" 2x2's. Drill pocket holes in the ends of both boards. Use 2 1/2" pocket hole screws to attach to the end panels.

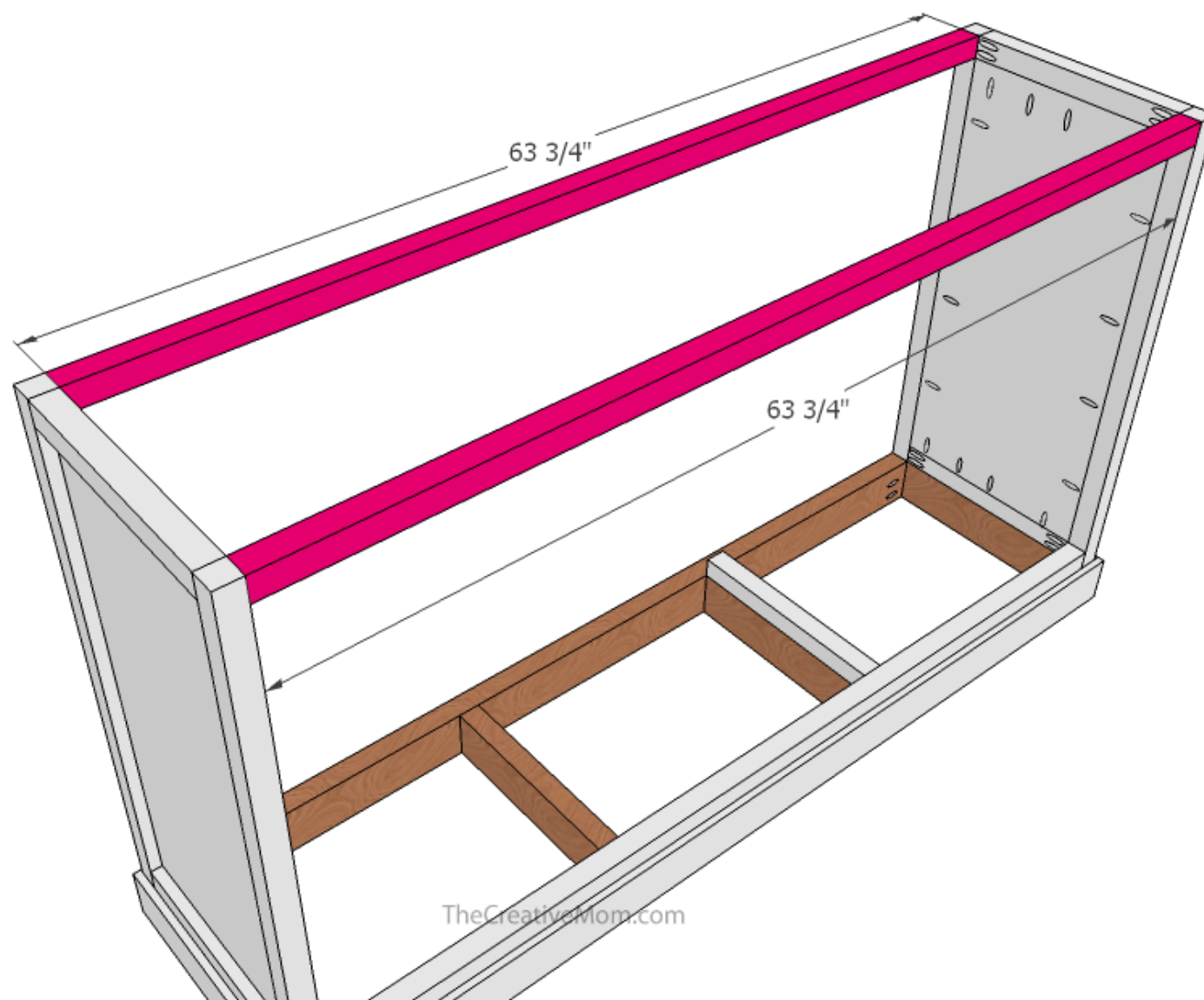

8

Build cabinet and drawer frames

Cut 2- 15" 2x2's. Drill pocket holes in the ends of each board. Use wood glue and 2 1/2" pocket hole screws to attach to the TOP of the cabinet frame. One board should be attached at the bottom of the frame next to the drawers (see diagram)

Cut 2- 33" 2x2's. Drill pocket holes in the ends of each board. Use wood glue and 2 1/2" pocket hole screws to attach to the BACK of the cabinet frame.

Cut 2- 31 1/2" 2x2's. Drill pocket holes in the ends of each board. Use wood glue and 2 1/2" pocket hole screws to attach to the FRONT of the cabinet frame.

The boards should be 20" from one side (the side with drawers) and 20 3/8" from the other side.

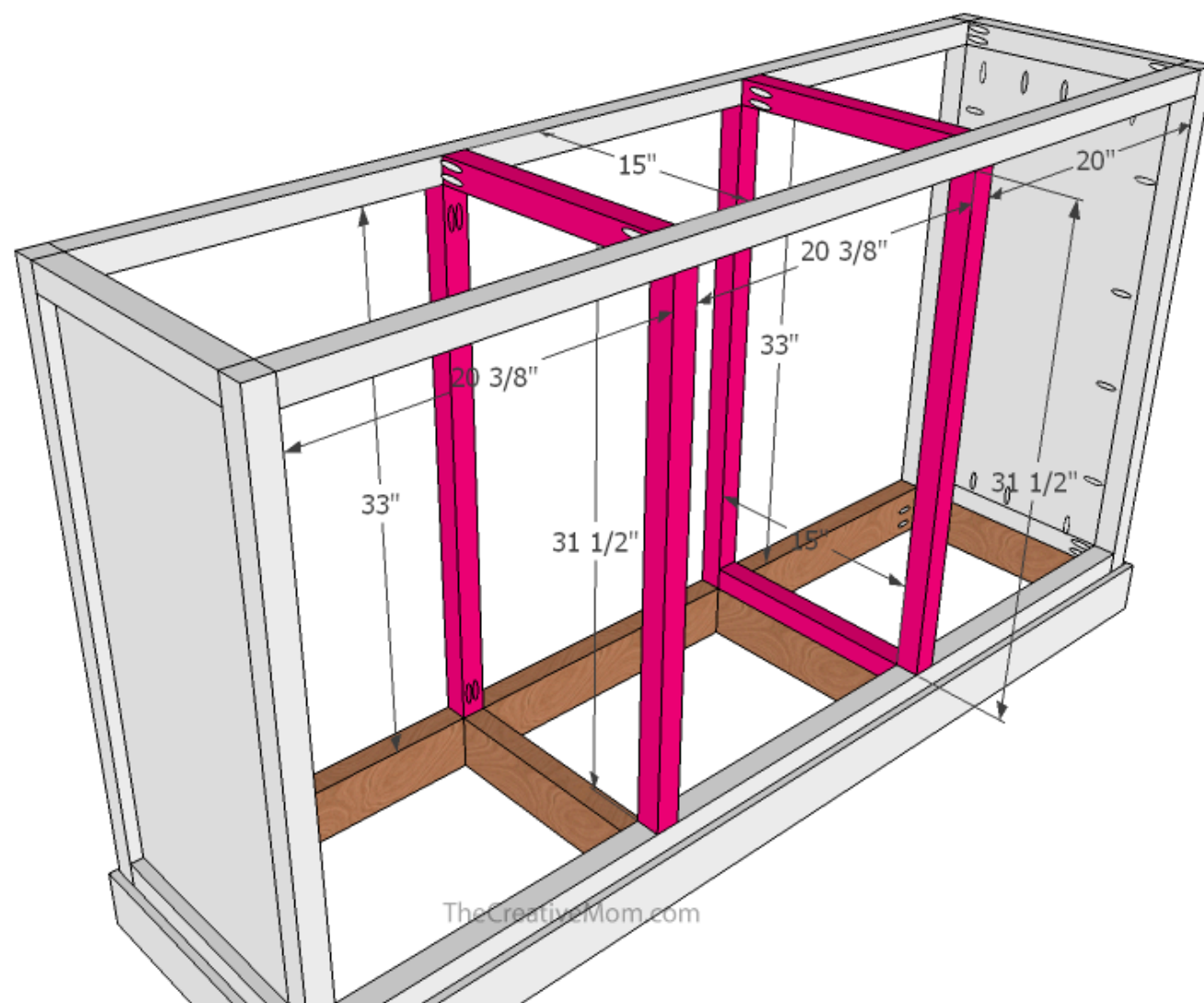

9**Attach middle panel**

Use a circular saw and the Kreg Rip-Cut to cut a piece of 3/4" plywood 15" x 31 1/2". Drill pocket holes on the back of the plywood on each side.

Use wood glue and 1 1/4 inch pocket hole screws to attach the plywood to the frame where your drawers will be (the frame 20" from the end) . Make sure the plywood is flush with the inside (the side where your drawers will be) of the end panel frames.

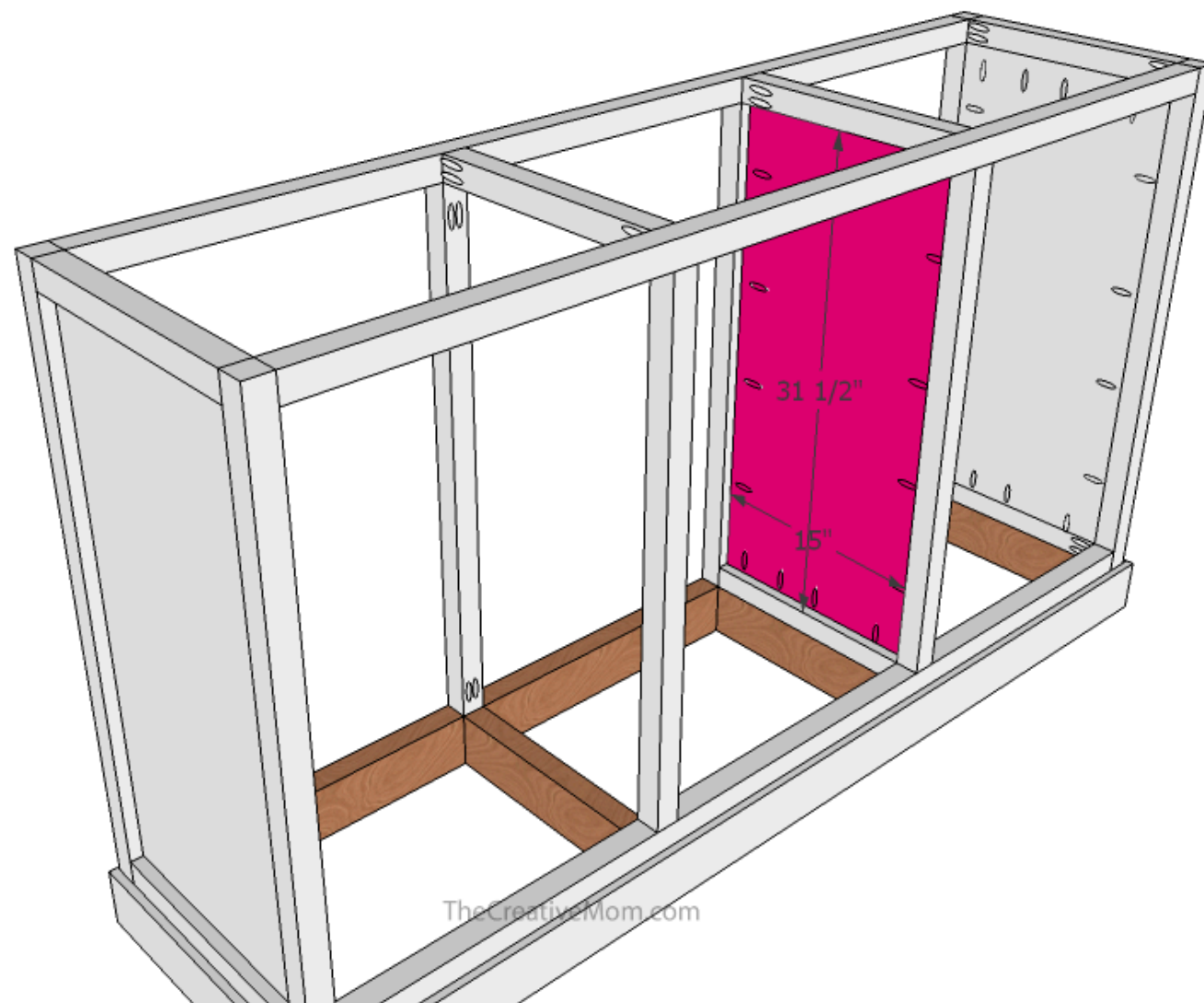

10

Buffet Frame

At this point, you should have something looking like this.



11

Add Drawer and Shelf Supports

Cut 2- 15" 1x2's and 1- 15" 2x2. Drill pocket holes on each end of the boards.

Use wood glue and 1 1/4" pocket hole screws to attach the boards to the vertical supports, 14 1/4" up from the base frame.

Cut 3- 20" 2x2's. Drill pocket holes on each end of the boards.

Use wood glue and 2 1/2" pocket hole screws to attach the boards to the vertical supports. There should be 6 3/4" between each board for the drawers.

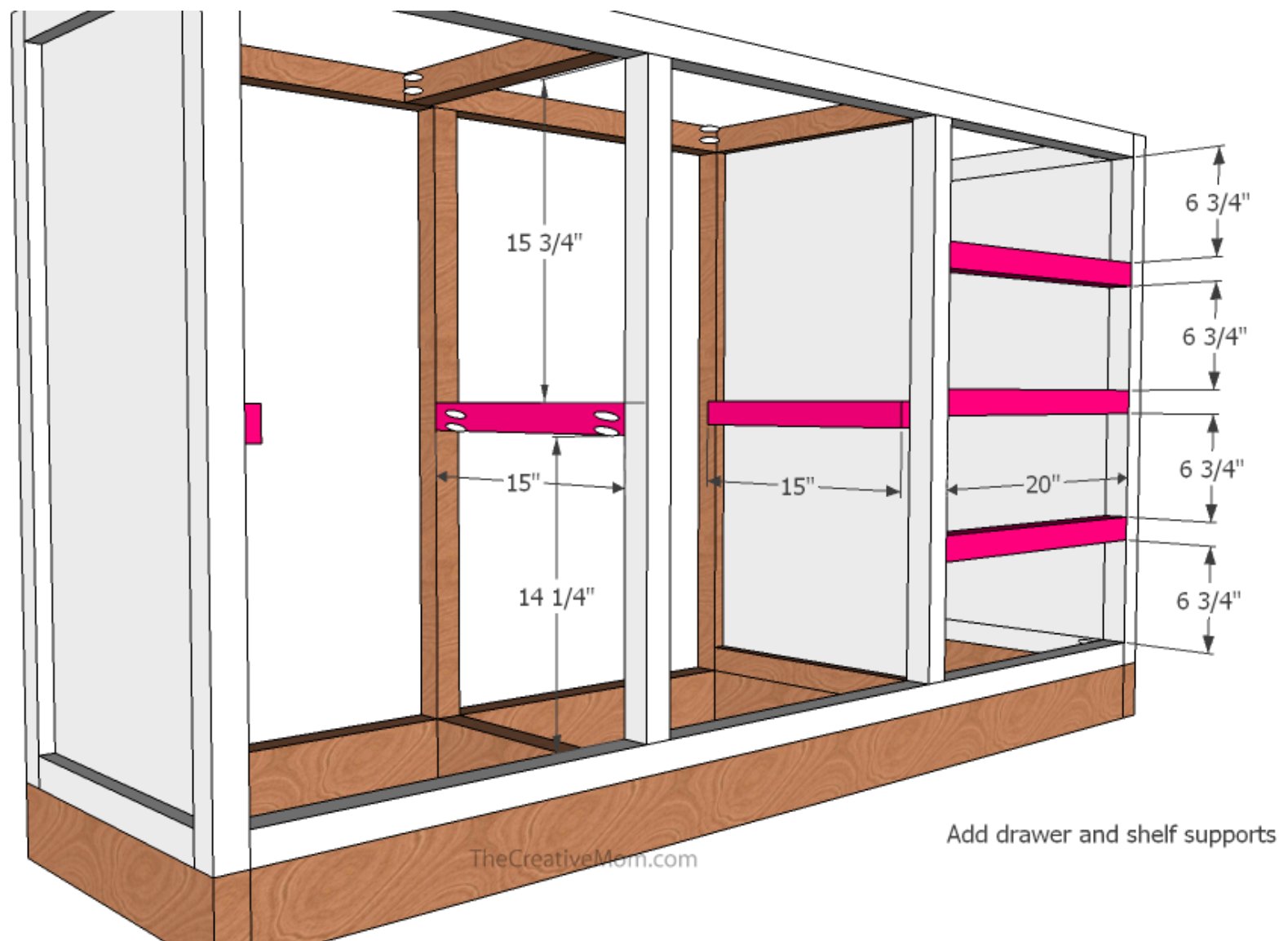

12**Attach Trim**

Cut 2- 18 1/4" 1x4s and a 67 3/4" 1x4. Using wood glue and finish nails, attach trim pieces to the bottom of your cabinet.

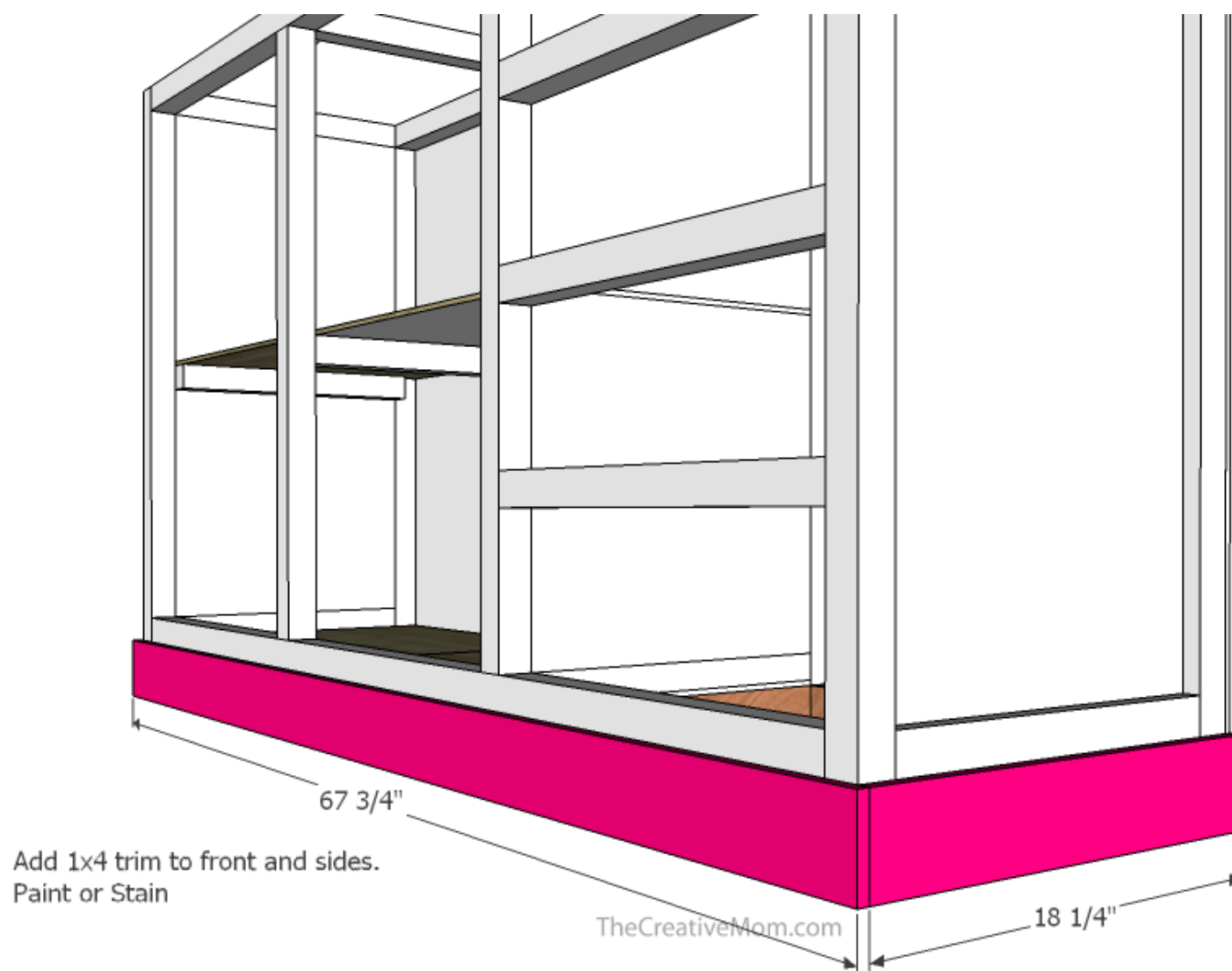

13

Build Shelves

Note: you may want to measure your cabinet to be sure of your shelf sizes before making any cuts.

Cut your first two shelves: Use a circular saw and the Kreg Rip-Cut to cut 2 pieces of $\frac{3}{4}$ " plywood $20\frac{3}{4}$ " x $16\frac{1}{2}$ ". Then, using a jigsaw, cut a notch in one corner, $\frac{3}{4}$ " x $1\frac{1}{2}$ ". So that the measurement at the notch will be 15 " x 20 ".

Cut your second two shelves: Use a circular saw and the Kreg Rip-Cut to cut 2 pieces of $\frac{3}{4}$ " plywood 23 " x $16\frac{1}{2}$ ". Then, using a jig saw, cut a notch in one corner, $\frac{3}{4}$ " x $1\frac{1}{2}$ ". Cut another notch in the adjacent corner, $1\frac{1}{2}$ " x $1\frac{1}{2}$ ". So that the measurement at the notch will be 15 " x $20\frac{3}{4}$ ".

You should have 2 of each shelf, 4 shelves total. See diagram

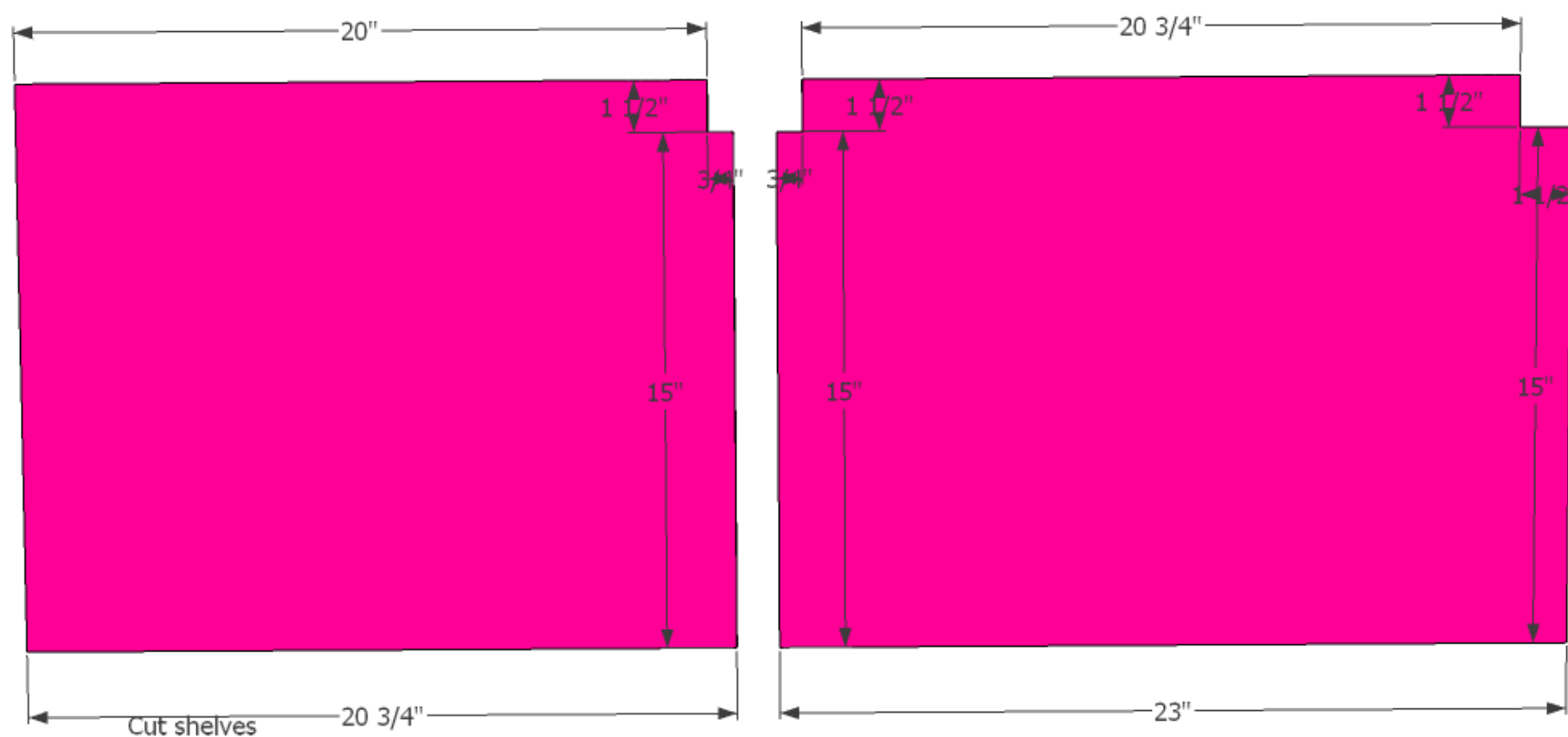

TheCreativeMom.com

14**Insert Shelves**

Make sure your shelves fit snugly in your cabinet. It should sit back 1 1/2" from the front of the cabinet, to account for the cabinet doors.

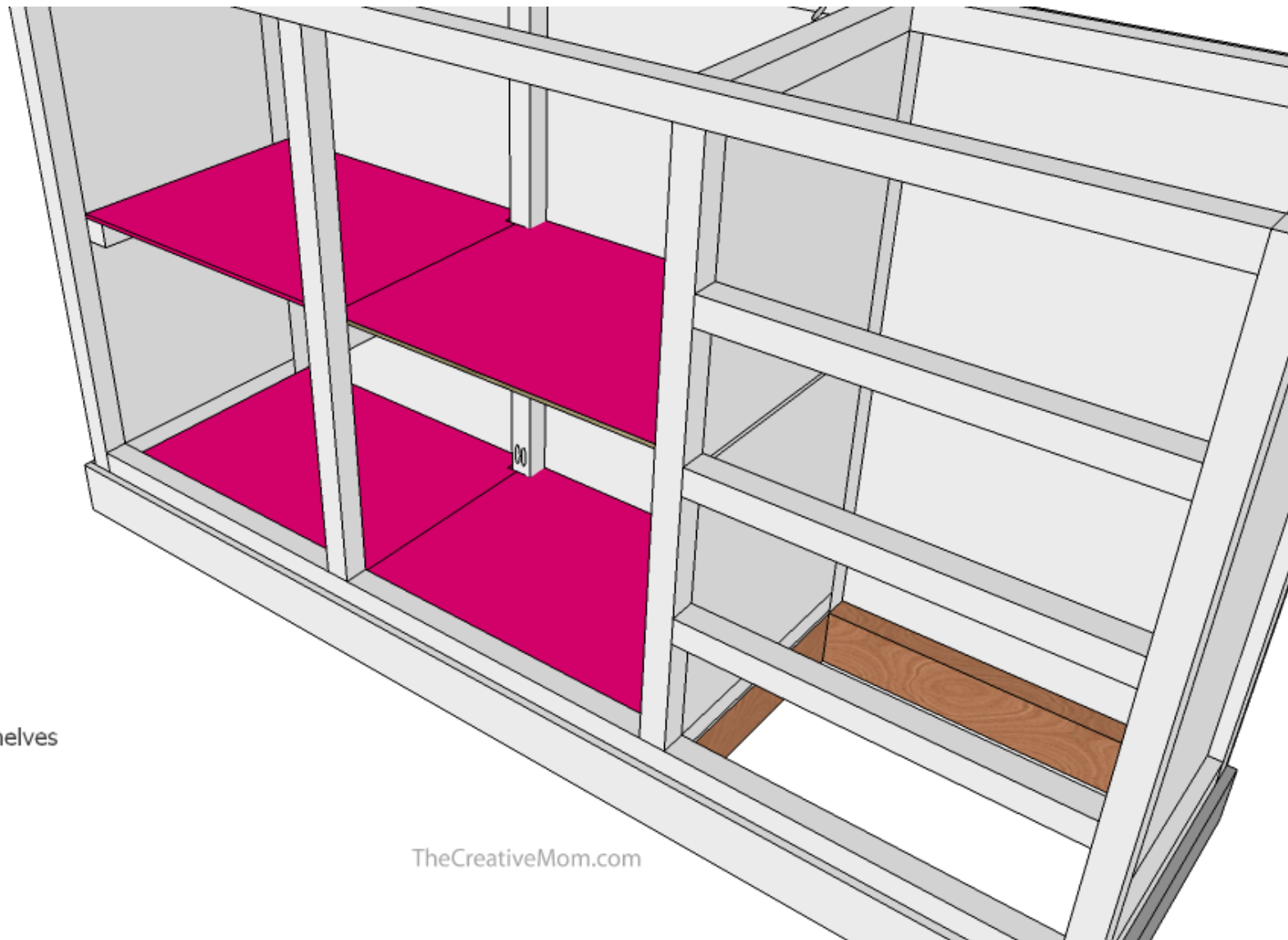

put in shelves

TheCreativeMom.com

15**Cut Cabinet Top**

Use a circular saw and the Kreg Rip-Cut to cut 3/4" plywood 69" x 19". Sand the edges so they are smooth.

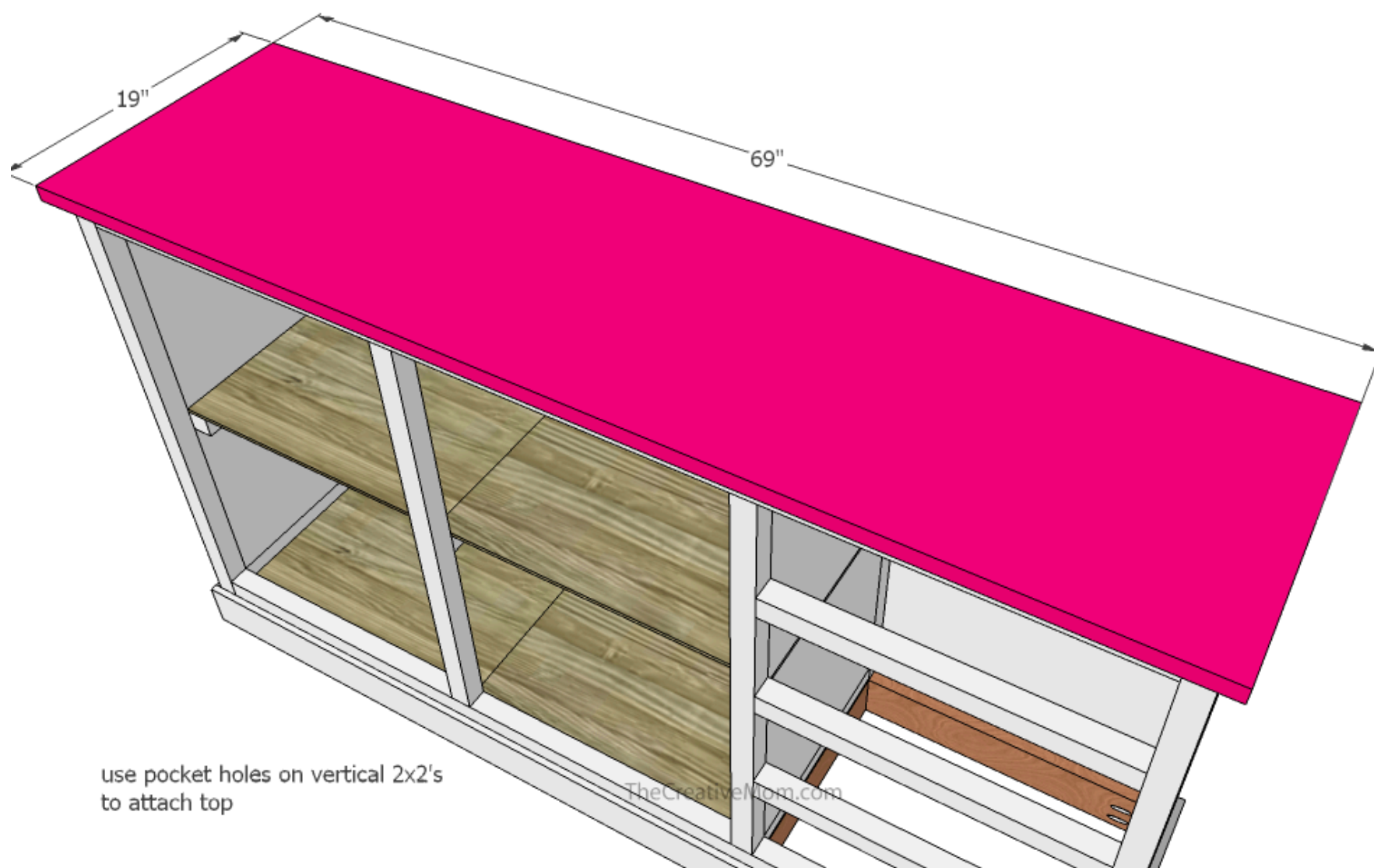

16

Cut Doors and Drawer Fronts

Note: Before making any cuts, measure your buffet cabinet. You want your doors and drawer fronts $\frac{1}{8}$ " smaller than your openings.

For the Doors: Use a circular saw and the Kreg Rip-Cut to cut 2 pieces of $\frac{3}{4}$ " plywood $20\frac{1}{4}$ " x $31\frac{3}{8}$ ".

For the Drawers: Use a circular saw and the Kreg Rip-Cut to cut 4 pieces of $\frac{3}{4}$ " plywood $19\frac{7}{8}$ " x $6\frac{5}{8}$ ".

Sand all the edges of the plywood.

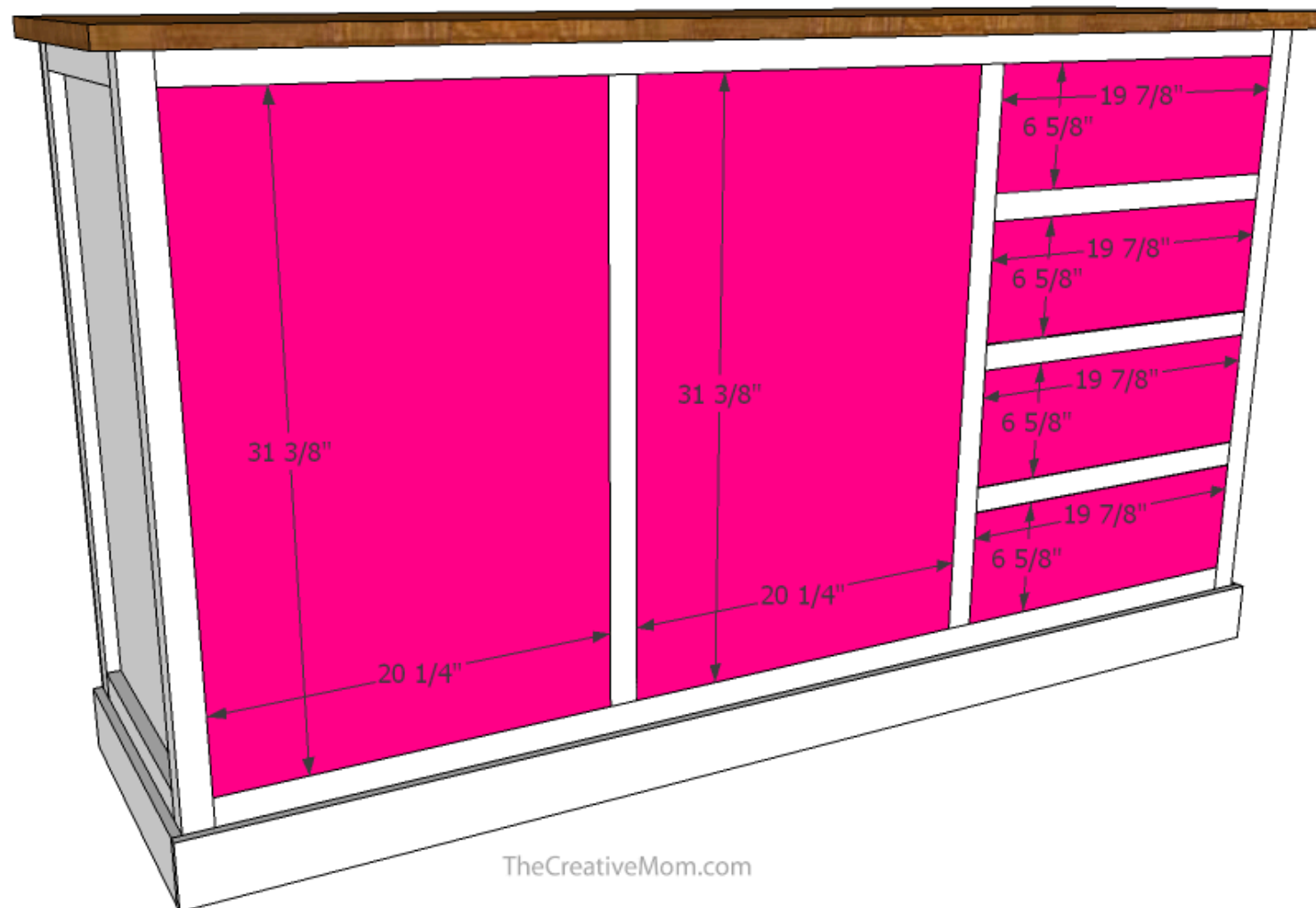

17**Door Trim**

Note: Measure your doors before making any cuts. Trim should fit flush with the edges of the door, and be fitted on top of the plywood.

Cut 4- 24 7/16" 1x4's. Cut 4- 20 1/4" 1x4's. Using wood glue, clamps, and finish nails. Attach the 1x4's to the top of the plywood doors.

Optional: Use 1x2's to add trim to the drawer fronts.

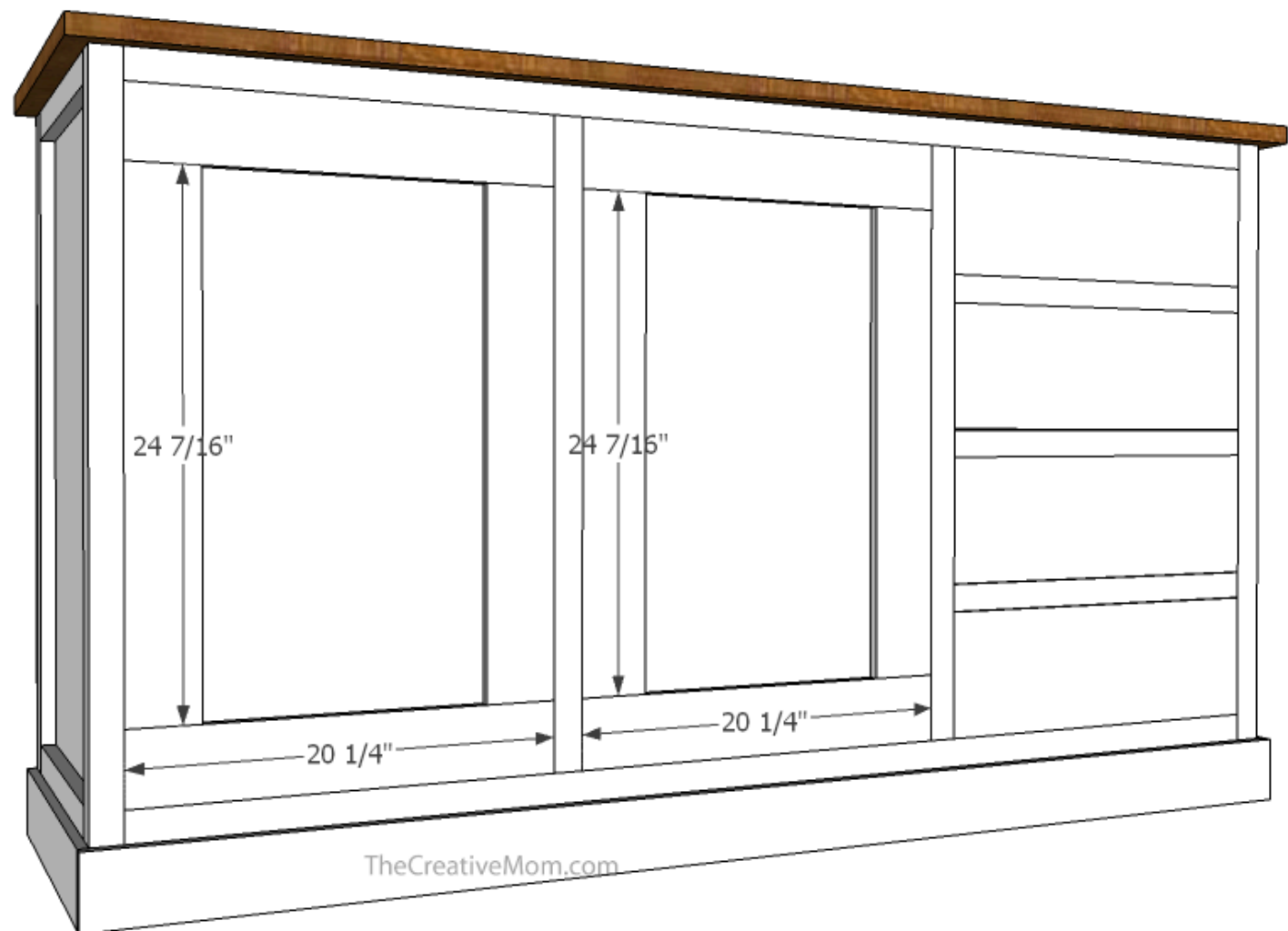
**18****Stain or Paint**

Before attaching the doors, drawer fronts, cabinet top, and shelves... Stain or paint the entire cabinet. Stain or paint all the doors, drawers, and other pieces.

19**Attach Doors and Drawer Fronts**

Using the Kreg Drawer slide Jig, attach drawer slides and fit the drawers in the buffet cabinet.

Using the Kreg Concealed Hinge Jig, attach hinges to the doors and the buffet.

Using the Kreg Cabinet Hardware Jig, fit the drawer pulls and door handles.

20**Build Drawer Boxes**

Note: all drawer slides are different. Make sure to measure your buffet cabinet, and take into account the drawer slides before building your drawer boxes. The measurements provided are for the cabinet I build with basic 16" drawer slides.

For the drawer bottoms: Use a circular saw and the Kreg Rip-Cut to cut 4 pieces of 3/4" plywood 18 1/4" x 15 1/4".

For the drawer sides: Use a circular saw and the Kreg Rip-Cut to cut 8 pieces of 3/4" plywood 5 1/2" x 16".

For the drawer backs: Use a circular saw and the Kreg Rip-Cut to cut 4 pieces of 3/4" plywood 5 1/2" x 18 1/4".

Drill pocket holes around the edges of the bottom plywood pieces. Using wood glue and 1 1/4" pocket hole screws, attach the sides & back pieces to create a box

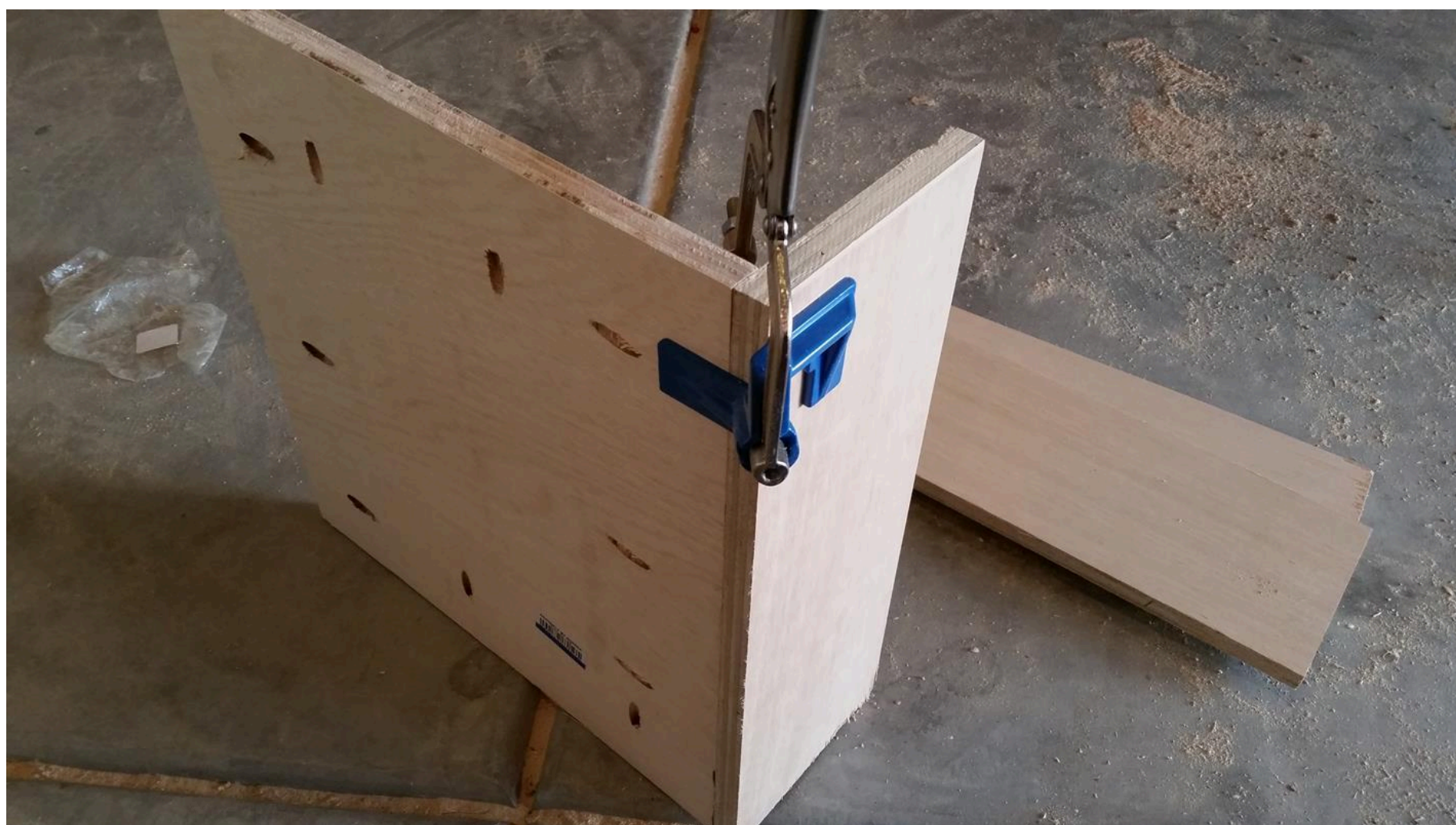
**21****Attach Drawer Fronts**

Once drawers are assembled and the drawer slides are attached, use wood glue and finish nails to attach drawer fronts to the drawer boxes.

22**Attach Table Top**

Use Simpson A21 (2" x 1-1/2" 90 degree Angle) ties and 1/2 inch screws to attach the table top to the buffet frame.

23**Attach Backing**

Cut a piece of 1/4" plywood- 38 x 66 3/4 (make sure to measure your cabinet for exact measurements). Use wood glue and finish nails to attach backing the the buffet cabinet.