

K-Cup Coffee Dispenser

By **lfrost**

Difficulty

Easy

An easy K-cup dispenser to hold K-cups or coffee pods.



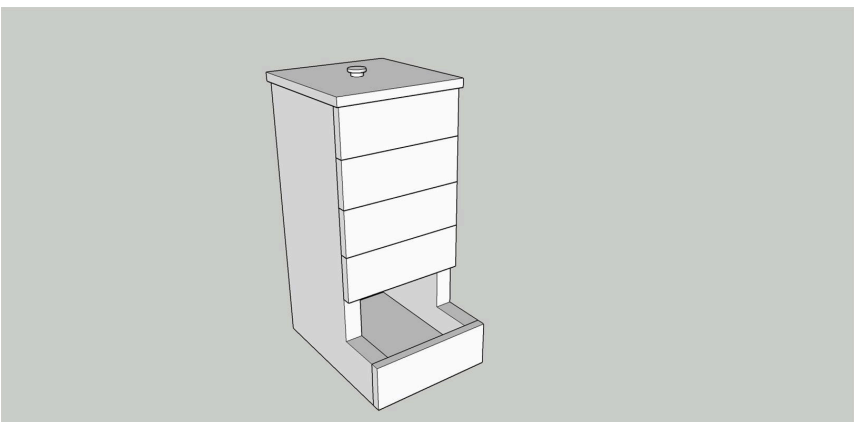

Tools

Kreg Tools



[Kreg® Pocket-Hole Jig 720](#)

Other Tools

- Jigsaw
- Miter Saw
- Table Saw
- Tape Measure
- Drill (cordless)
- Nail Gun
- Sander

Materials

Wood Products

- 1 Board , 1x8 , 36"
- 1 Board , 1x6 , 24"
- 1 Board , 3/8" , 48"

Hardware & Supplies

- 1 Top Pull
- 10 1 1/4" Kreg Pocket Hole Screws

Cut List & Parts

- 1 Base, $\frac{3}{4}$ " X 4" X $7\frac{1}{4}$ "
- 2 Sides, $\frac{3}{4}$ " X $7\frac{1}{4}$ " X 12"
- 1 Back, $\frac{3}{4}$ " X 4" X $11\frac{1}{4}$ "
- 4 Front Pieces, $\frac{3}{16}$ " X $5\frac{1}{2}$ " X 2"
- 1 Top, $\frac{3}{8}$ " X $5\frac{1}{2}$ " X $5\frac{5}{8}$ "
- 1 Sub-top, $\frac{3}{8}$ " X 4" X $4\frac{1}{2}$ "
- 1 Bottom Front Piece, $\frac{3}{8}$ " X $5\frac{1}{2}$ " X 2"

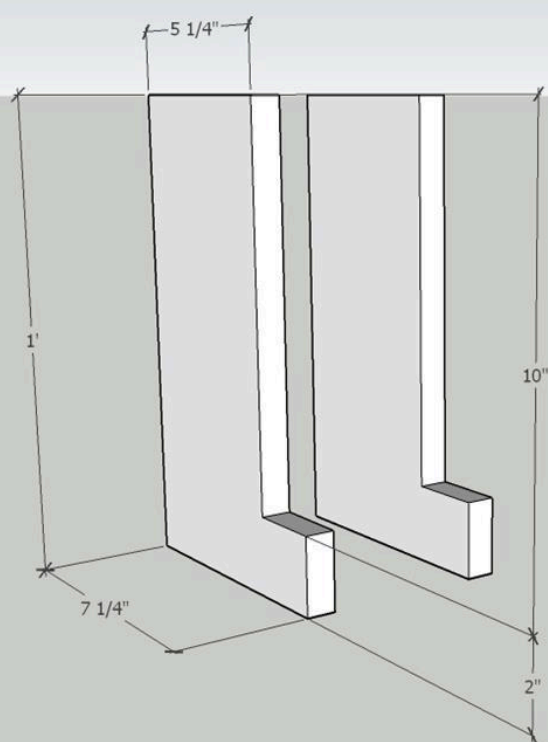
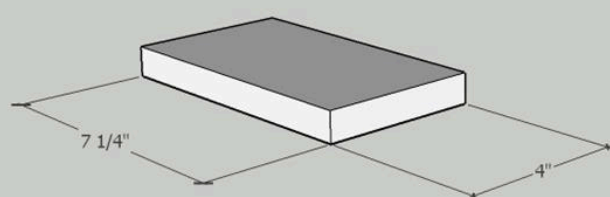

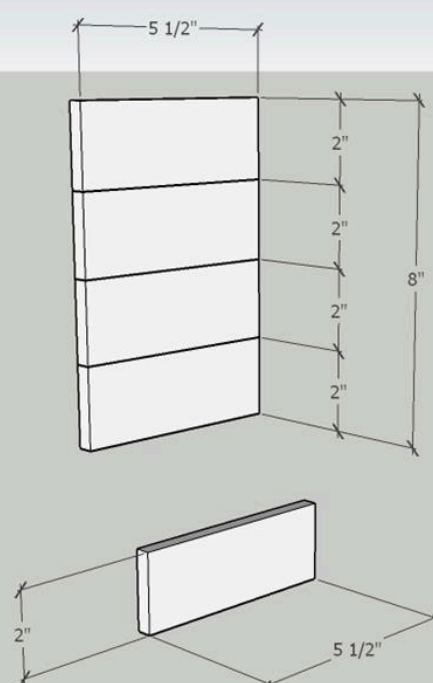
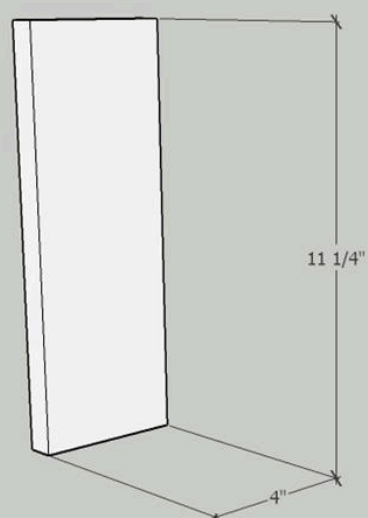

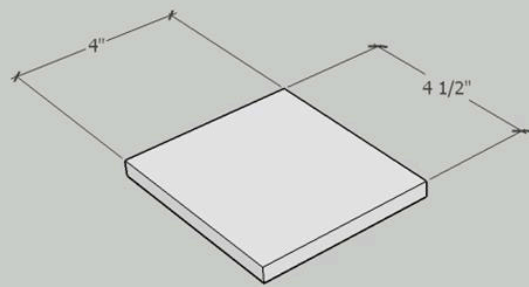
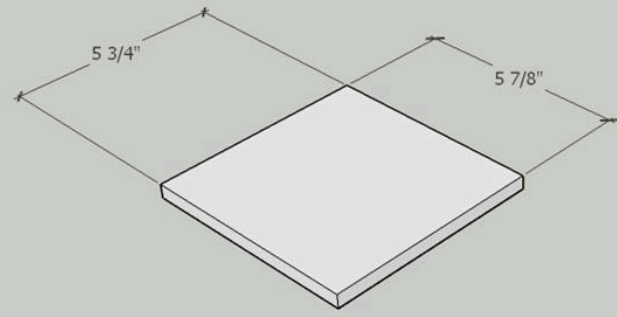

Directions

1**Cut the base**

Cut the base per the dimensions indicated.

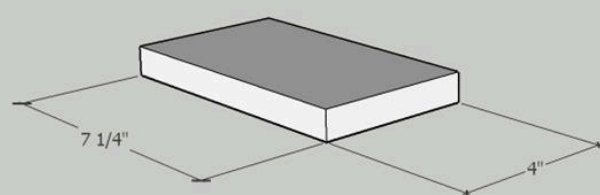
**2****Cut the sides**

Cut two side panels per the dimensions indicated

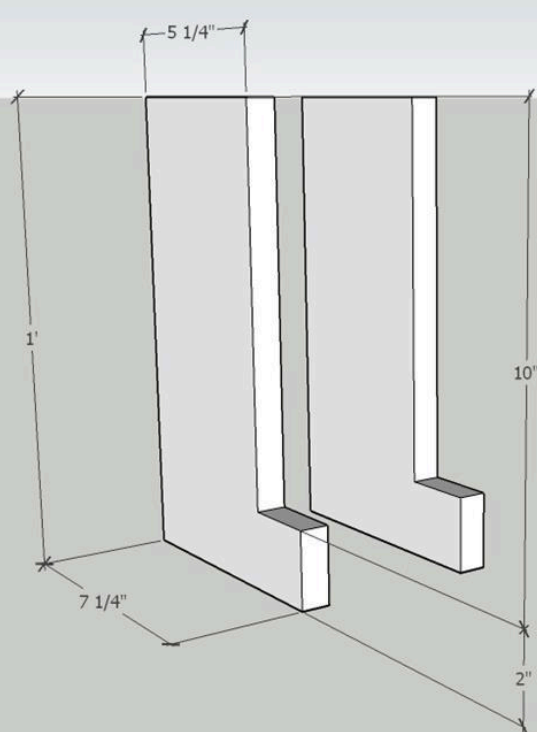

3

Cut the back

Cut the back panel per the dimensions indicated

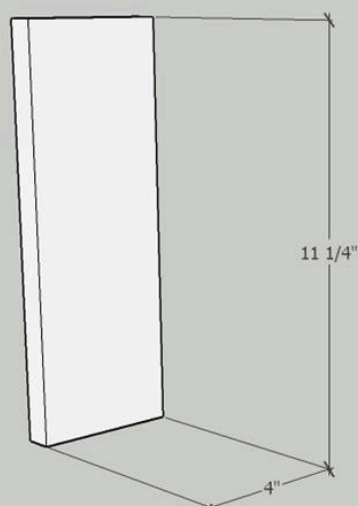

4

Cut the front pieces

Cut 5 front pieces per dimensions indicated

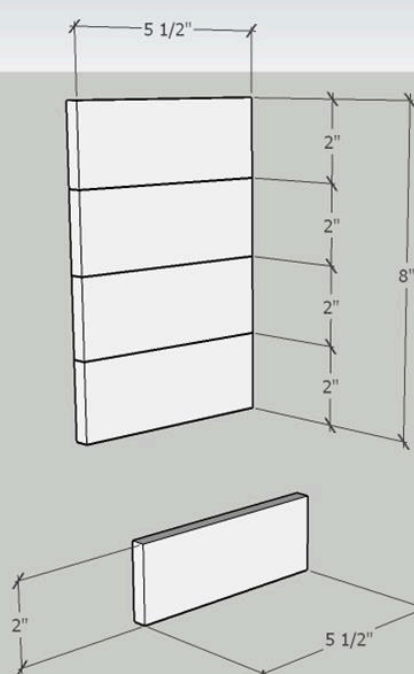

5**Cut the top**

Cut the top per dimensions indicated

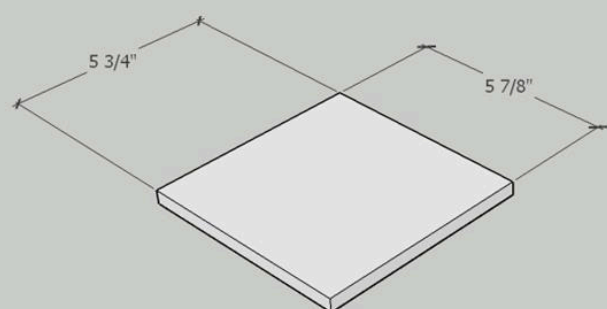
**6****Cut the sub-top**

Cut the sub-top per dimensions indicated

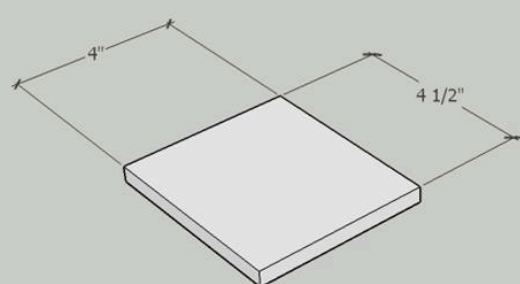

7

Join the two top pieces

Join the two top pieces by gluing and clamping

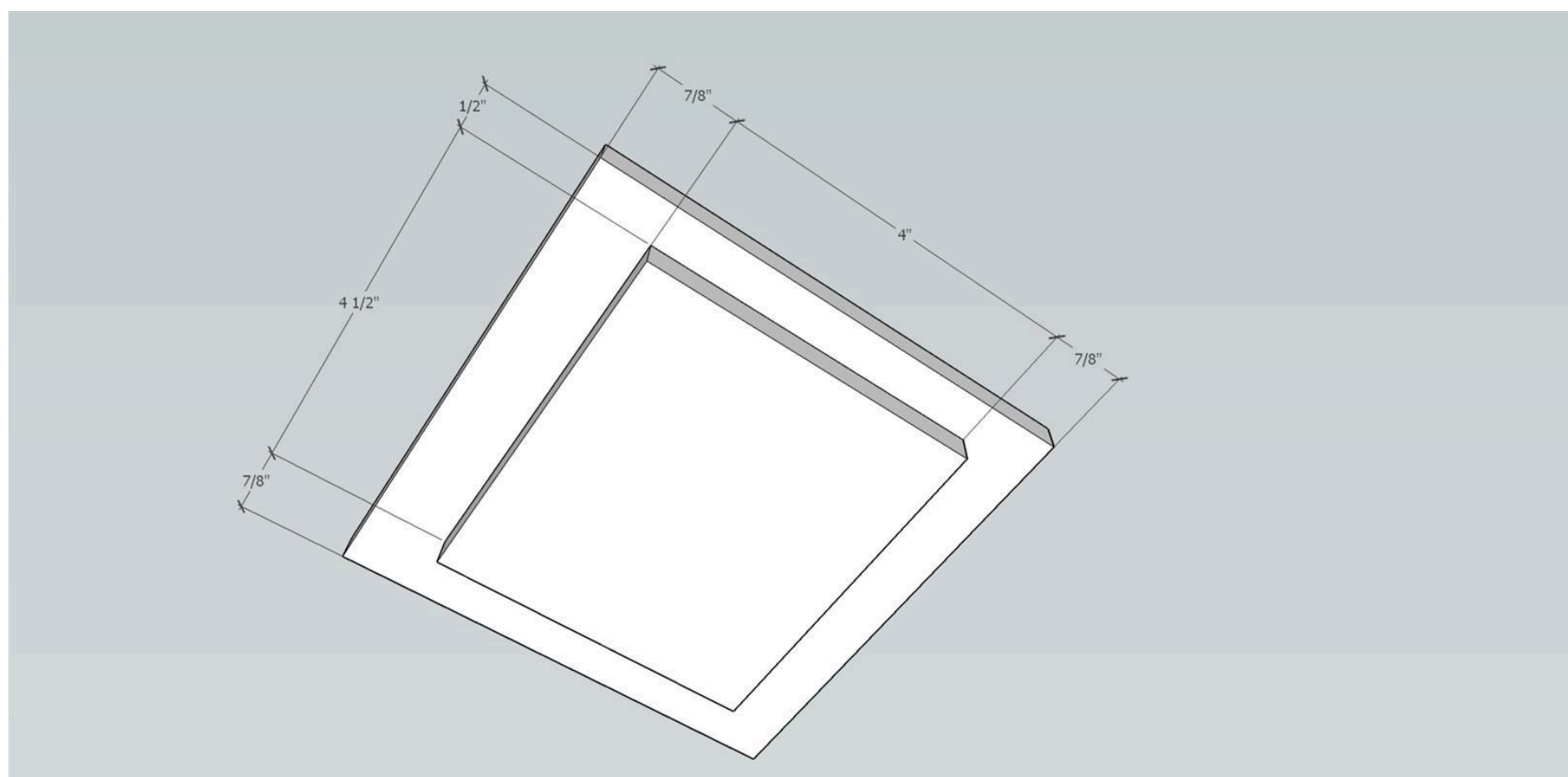

8

Join the sides to the base

Join the sides to the base by drilling pocket holes as shown in the base and attaching with 1 1/4" pocket hole screws.

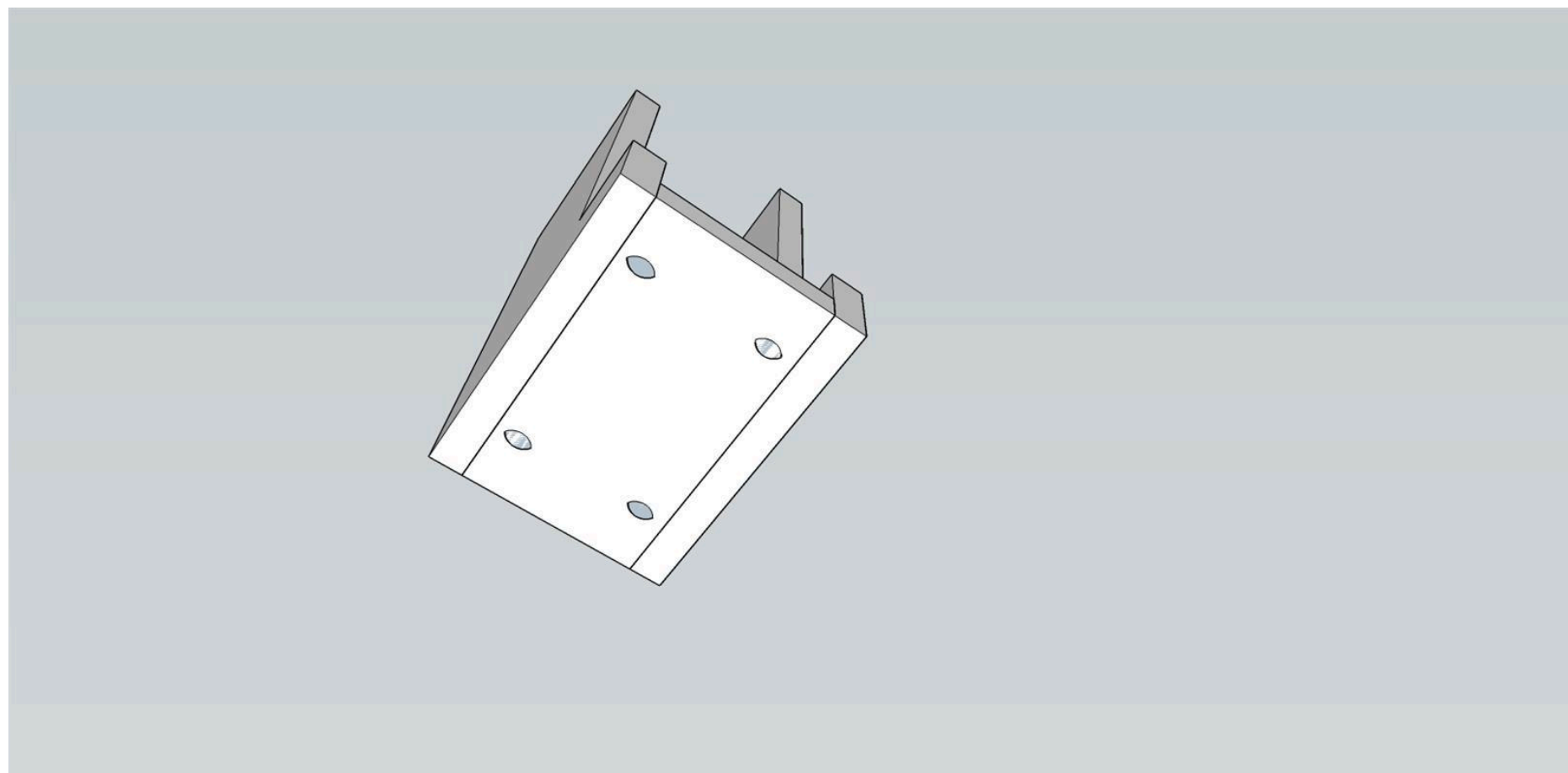

9**Join the back to the sides**

Join the back to the sides by drilling pocket holes as shown and attaching with 1 1/4" pocket hole screws.

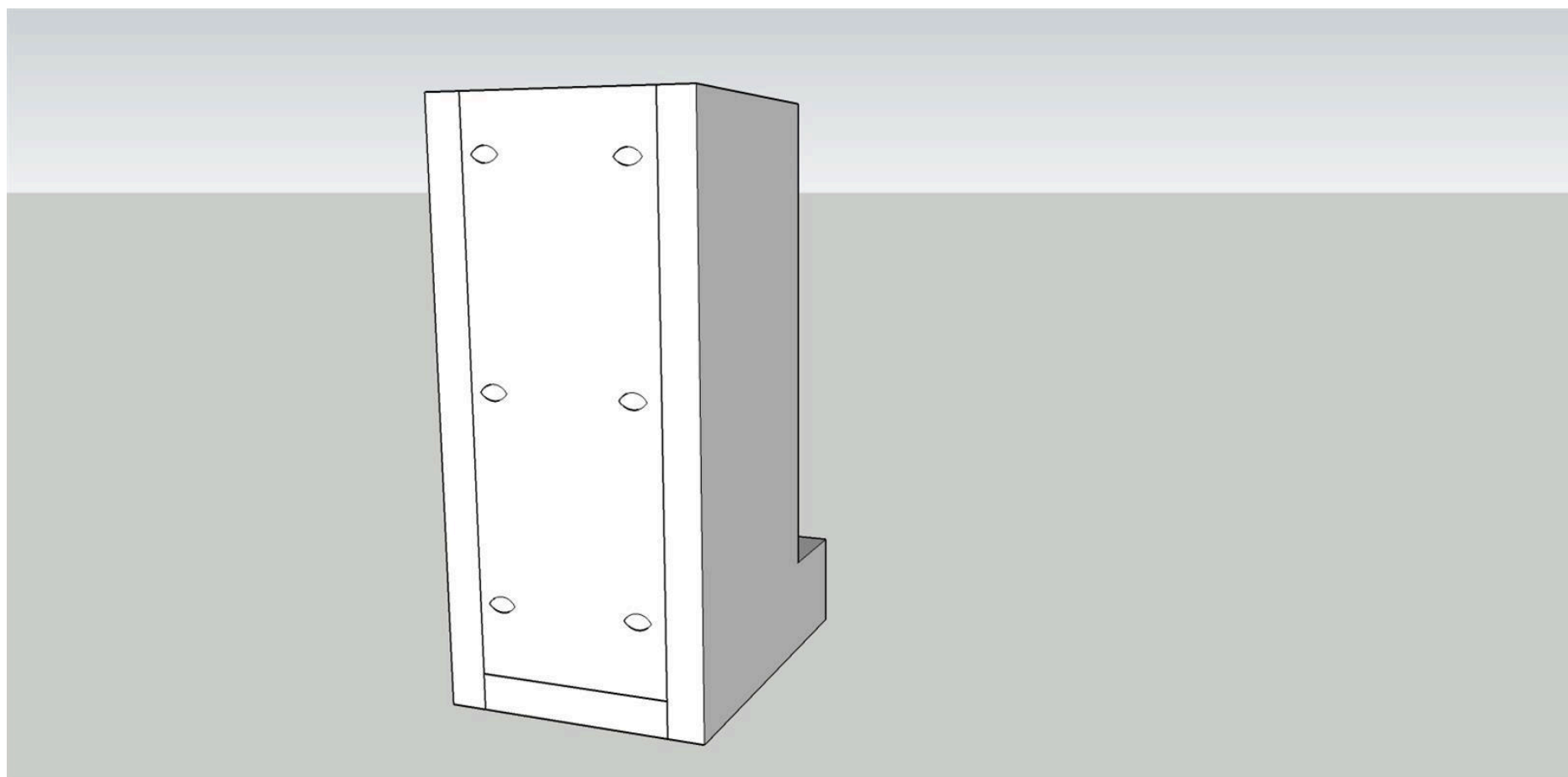
**10****Install the front pieces**

Install the front pieces as shown by gluing and clamping

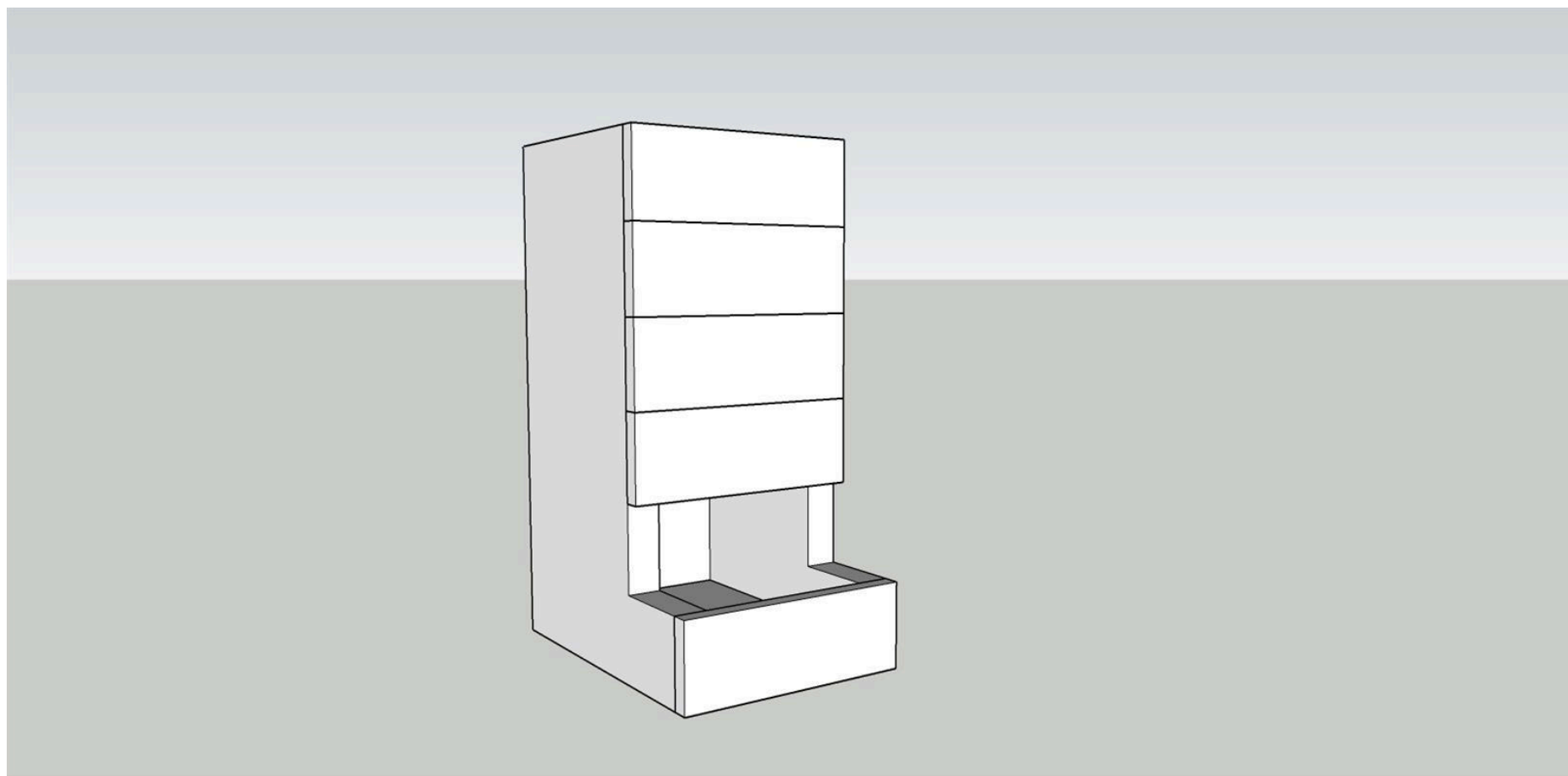

11**Install the top**

Verify that the top fits. Sand as required.

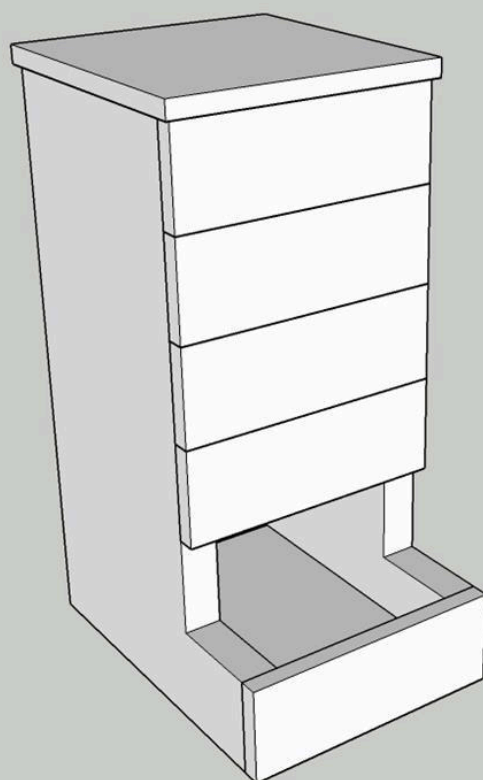
**12****Add top pull**

Add a pull of your choice to the top and finish the dispenser.

