

# Kids Play Kitchen

By **Sincerely, Marie Designs**

Difficulty

Moderate

Farmhouse style kitchen set for kids complete with fridge and freezer, oven, sink and plenty of storage for hours of imagination and play time!











# Tools

## Kreg Tools

Kreg®  
Pocket-  
Hole Jig  
720

[Kreg® Pocket-Hole Jig 720](#)

## Other Tools

Circular Saw (corded)

Jigsaw

Miter Saw

Tape Measure

Clamps

Nail Gun

Stapler

Sander

Air Compressor

# Materials

## Wood Products

- 1 Plywood , 1/2" Thick , Full Sheet
- 1 Plywood , 1/2" Thick , Half Sheet
- 3 Board , 1x2 , 96"
- 1 Board , 1x3 , 96"
- 1 Board , 2x2 , 96"
- 4 Board , 3/4" Thick , Round Wooden Discs
- 1 Board , 3/4" Thick , 16" X 48" Premade Shelf/Countertop

## Hardware & Supplies

- 1 Box 1" Kreg Screws
- 1 Box 1 1/4" Kreg Screws
- 3 Sets Of Hinges Of Choice
- 2 10" Bar Pull Handles
- 2 16" Bar Pull Handles
- 4 Stove Dials
- 1 Small Faucet Of Choice
- 1 Shallow, Metal Pan Or Bowl Of Choice
- 4 Wooden Circle Cutouts
- 3 Magnet Door Catches Of Choice
- 1 Paint Or Stain Of Choice
- 1 Box Brad Nails
- 4 1" Wood Screws
- 1 Roll 3/4th Adhesive Wood Veneer

# Cut List & Parts

- 2 Fridge Sides , 1/2" X 37" X 15"
- 2 Fridge Base & Top , 1/2" X 16 3/4" X 15"
- 1 Fridge Bottom Support , 1" X 3" X 16 3/4"
- 2 Fridge Shelves , 1/2" X 16 3/4" X 15"
- 1 Top Fridge Door , 1/2" X 21" X 18 1/4"
- 1 Bottom Fridge/Freezer Door , 1/2" X 14" X 18 1/4"
- 4 Cabinet Legs , 2" X 2" X 22"
- 2 Cabinet Side Panels , 1/2" X 20" X 12 3/4"
- 4 Cabinet Side Trim , 1" X 2" X 12 1/2"
- 1 Bottom Cabinet Base , 1" X 2" X 29"
- 1 Middle Cabinet Divider , 1/2" X 18 1/2" X 14 3/4"
- 1 Middle Cabinet Divider Trim , 1" X 2" X 18 1/2"
- 2 Top Cabinet Supports , 1" X 3" X 13 5/8"
- 1 Oven Door , 1/2" X 15 3/4" X 13 3/8"
- 4 Fridge Shelf Supports , 1" X 2" X 14"
- 2 Cabinet Shelves , 1/2" X 14 3/4" X 14"
- 4 Cabinet Shelf Supports , 1" X 2" X 12"
- 1 Fridge Back , 1/4" 37" X 18 1/4"
- 1 Cabinet Back , 1/4" X 31 1/2" X 20"
- 1 Cabinet Bottom Base/Shelf , 1/2" X 29" X 14 3/4"
- 1 Cabinet Counter Top , 3/4" X 32 1/2" X 16"

# Directions

1

## Making Cabinet Sides

Make 1/2" pocket holes in the sides and the top of the middle panels. Attach the middle panels to the cabinet legs using 1 1/4" Kreg screws. Make sure that panel is flush with the back of the legs as well as the top. There should be a 2" space from the bottom of the panel to the bottom of the legs. Attach the top and bottom trim pieces to the top of the middle panels using wood glue and brad nails.

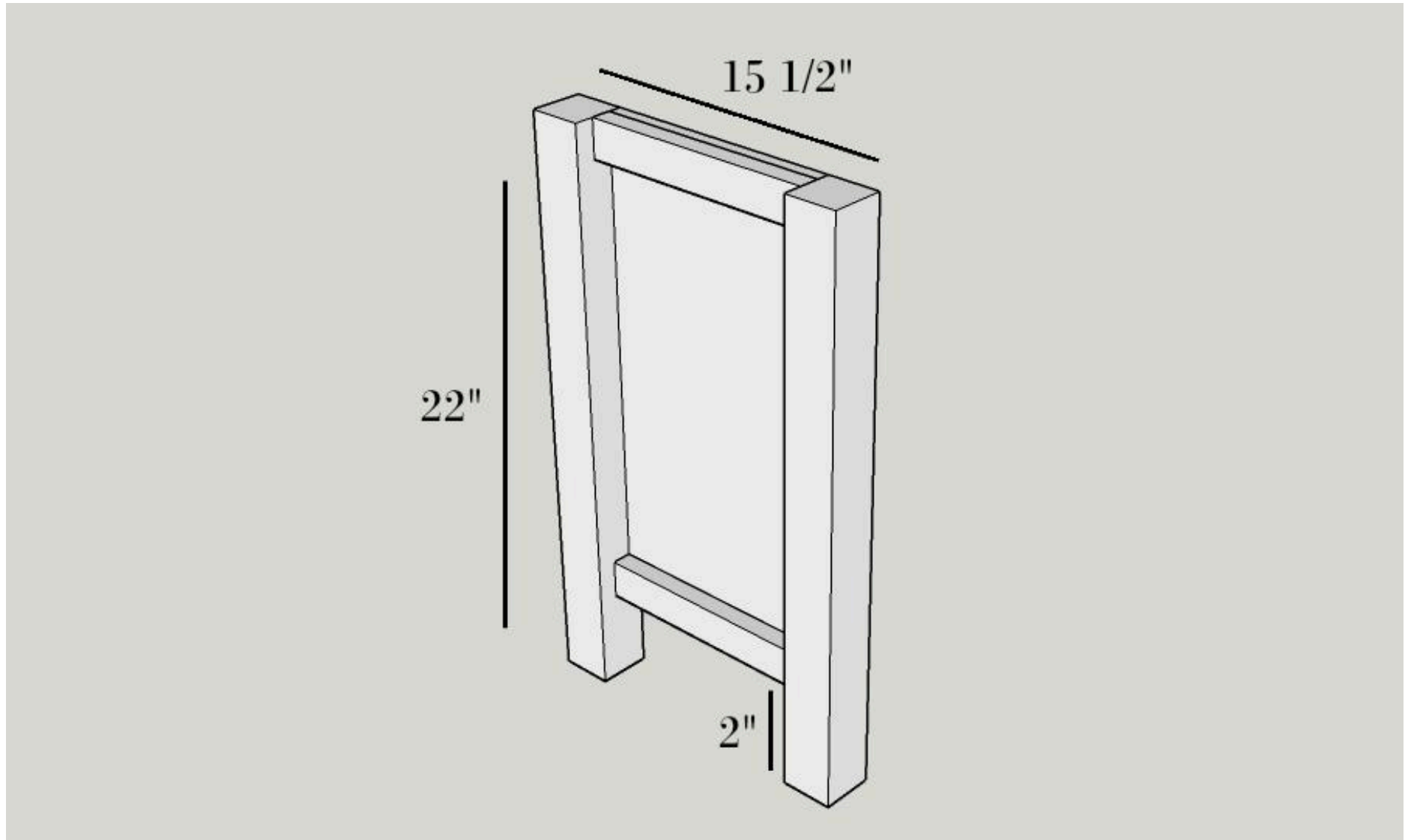

## 2

### Adding Bottom Support

Join the two sides by attaching the bottom 1"x2" support 2" from the bottom of the legs.

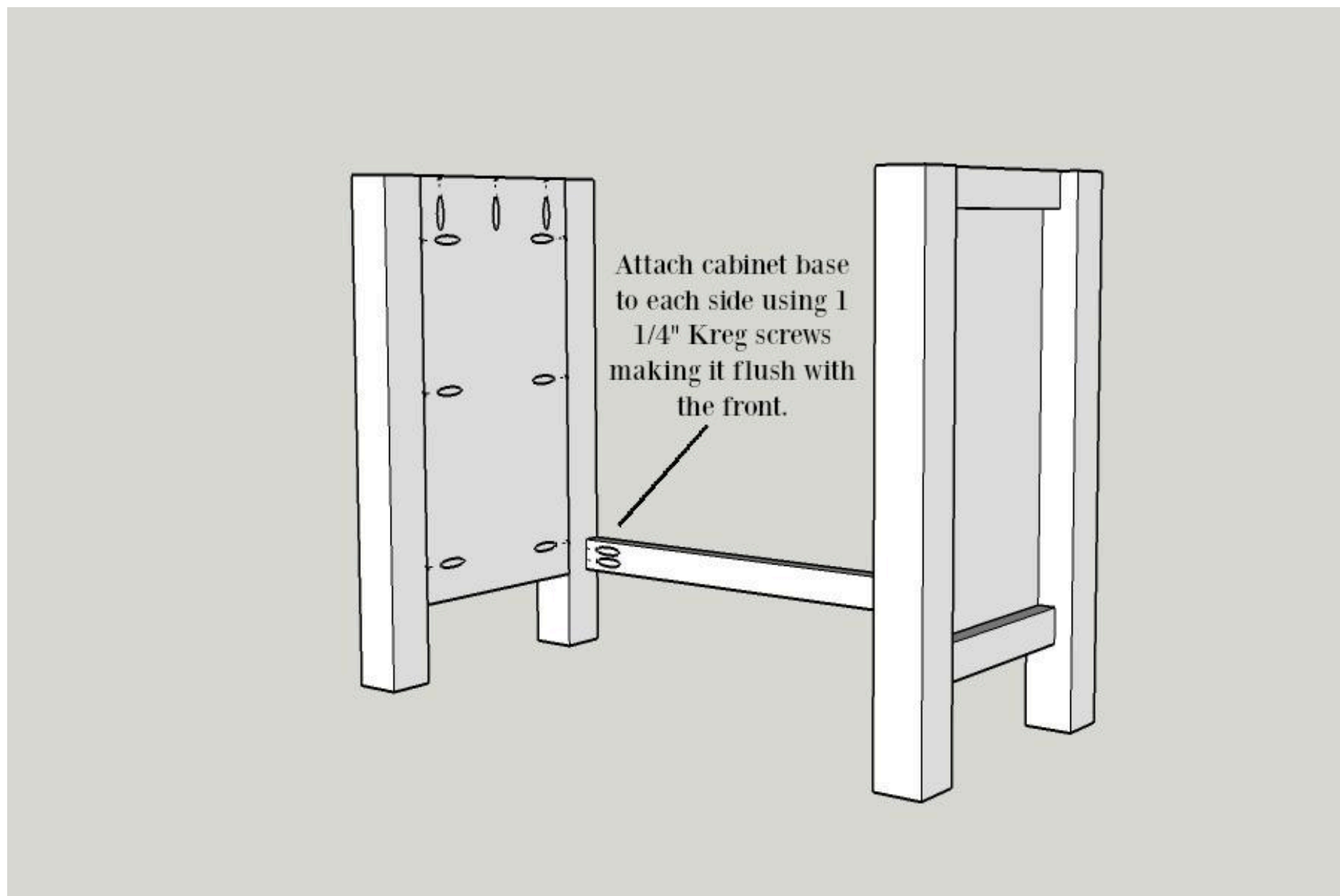

**3**

### Adding Cabinet Face Frame

Attach the middle frame as well as the top trim pieces using the Kreg to hold them in position. Make sure that the top trim pieces stay flush with the tops of the cabinet sides.

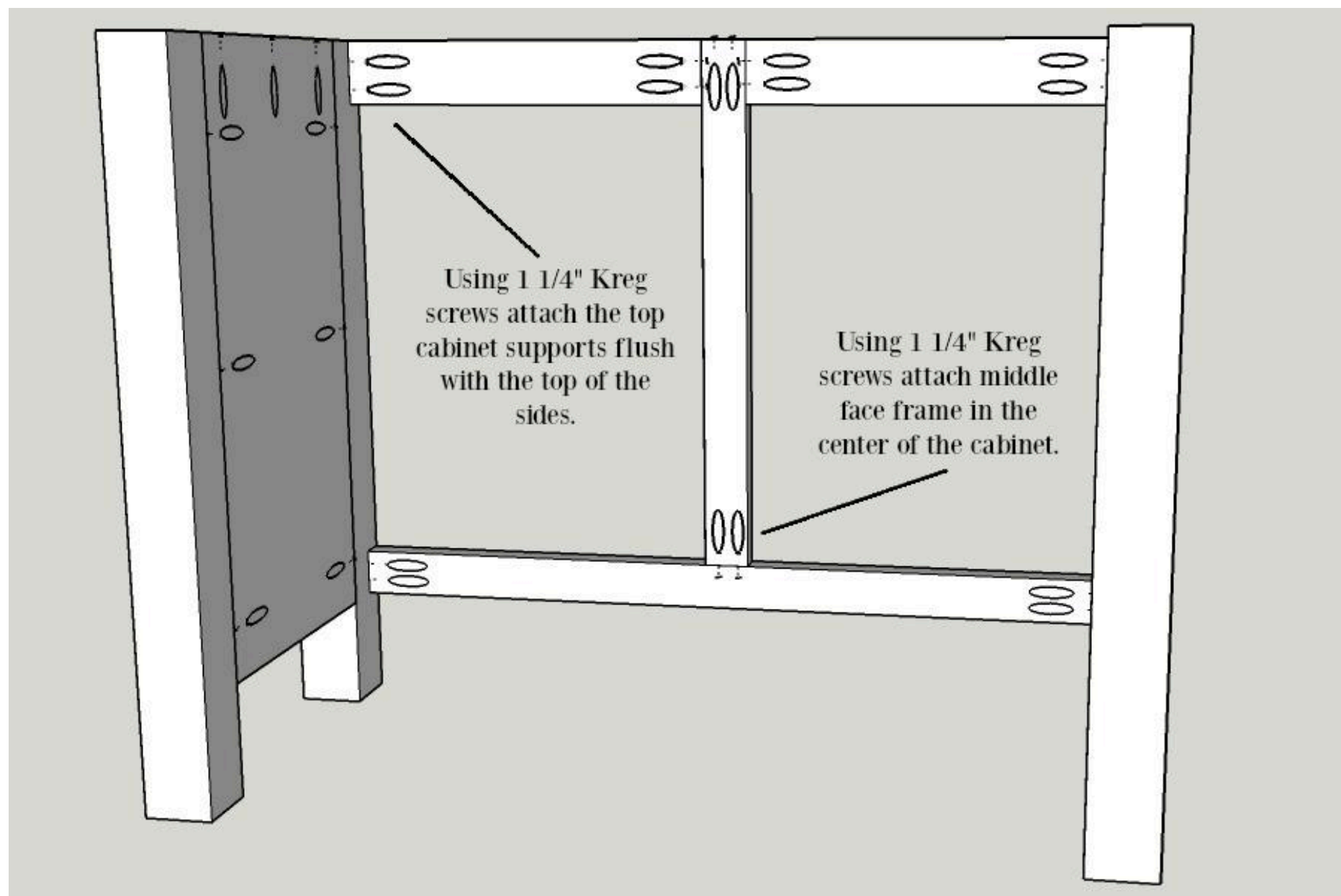



**4****Adding Cabinet Base, Divider & Top**

Make 1/2" pocket holes in the bottom sides and front of the cabinet base. Attach the cabinet base using 1" Kreg screws. The base should but up to the cabinet's bottom support and be flush with the back. Attach the counter top using 1 1/4" Kreg screws. Add the divider using the Kreg clamp to hold it center with the cabinet while you attach it using 1" Kreg screws. The divider should be flush with the back and but up to the front divider support.

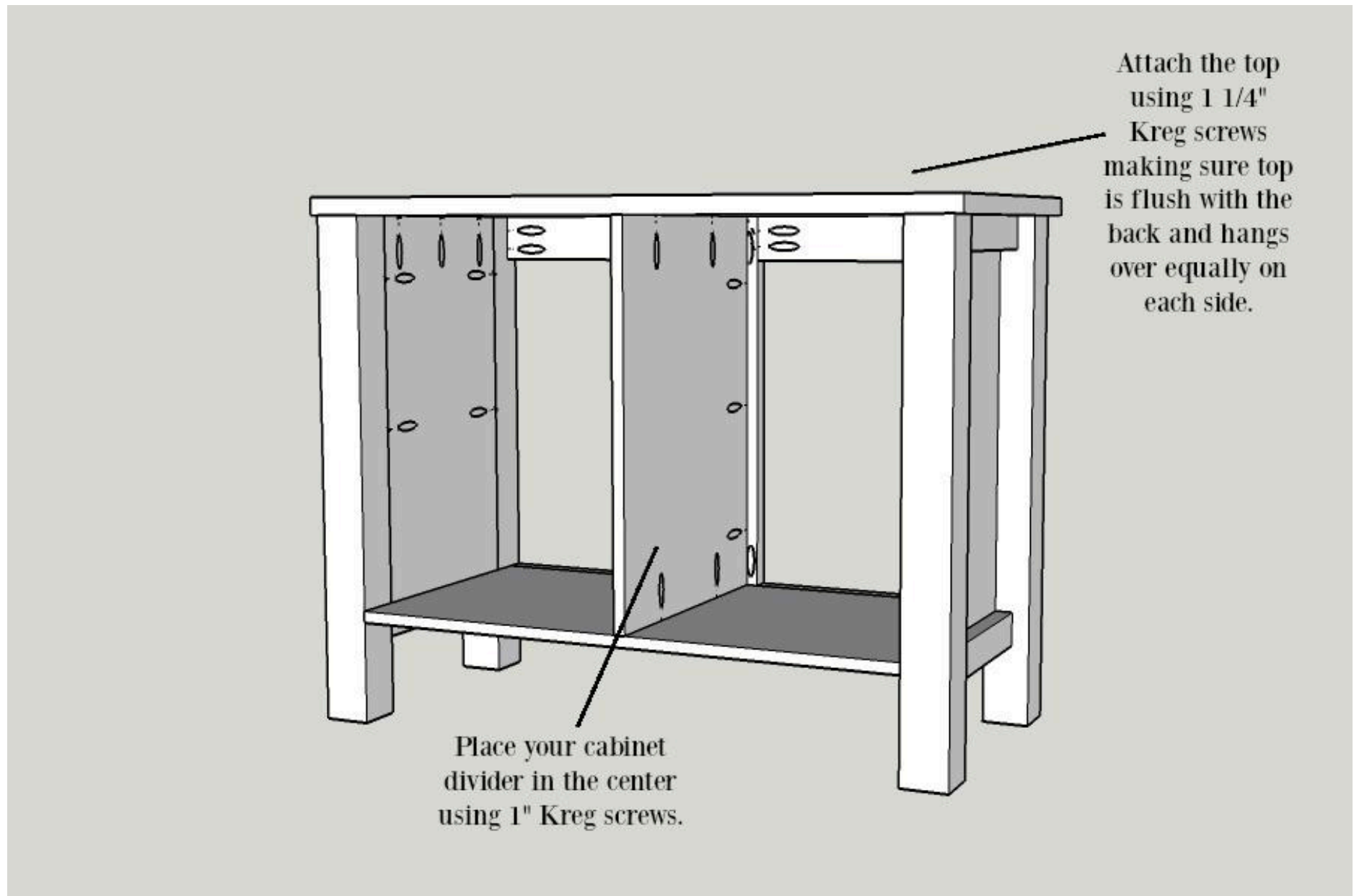

**5****Adding Cabinet Shelves**

Use wood glue and brad nails to attach the 1x2"s to the sides. The shelves will rest on up. You can nail them in place if you do not wish for them to be removable.

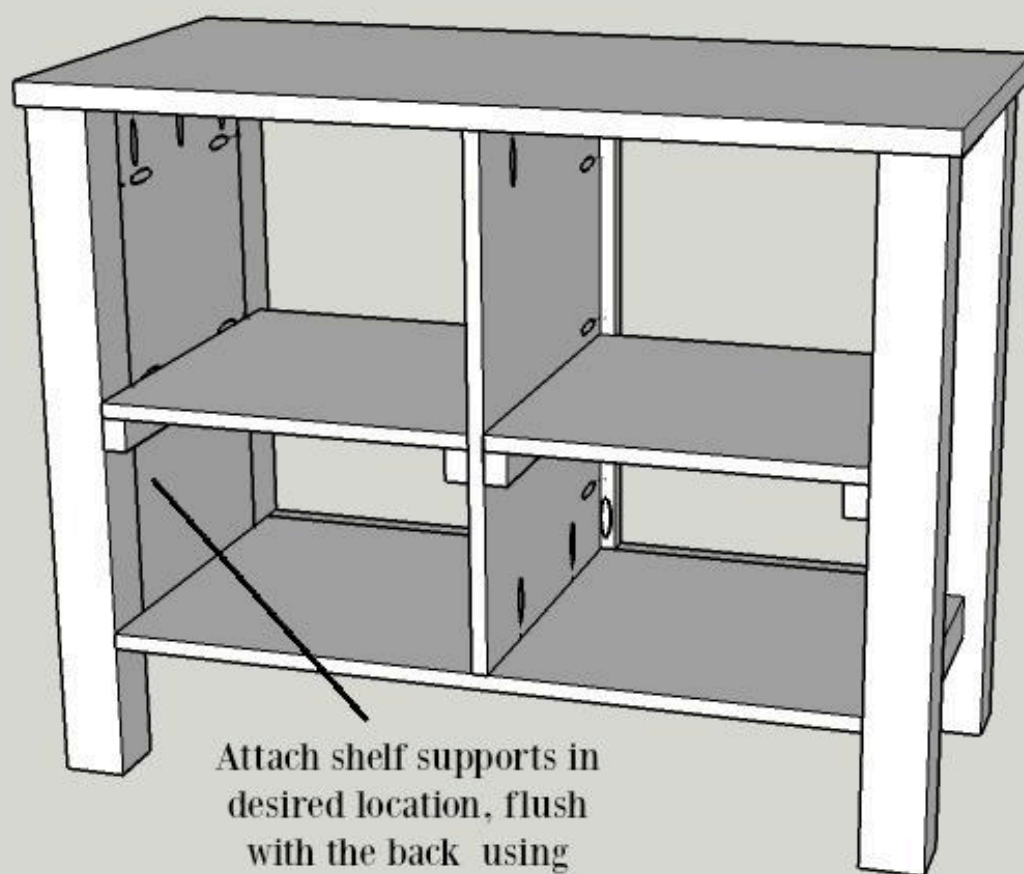

Attach shelf supports in desired location, flush with the back using wood glue and brad nails.

**6****Installing Oven Door**

Using hinges of choice, install the oven door with equal gaping on each side. Attach the bar pull to the top.

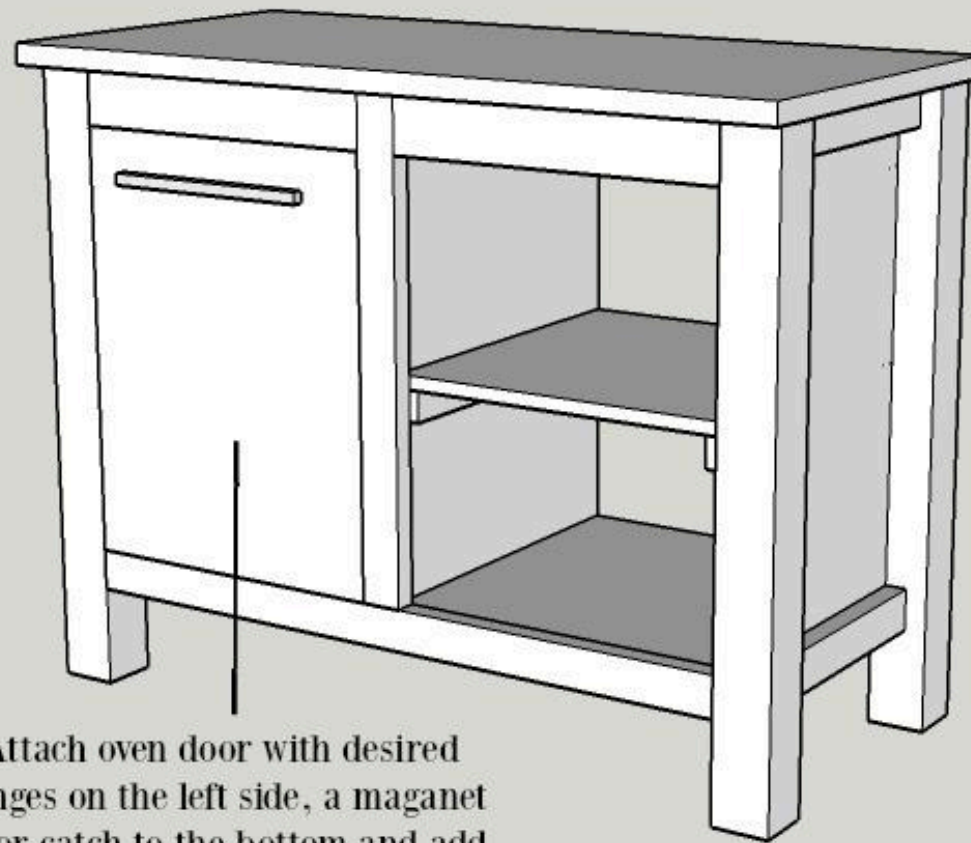

Attach oven door with desired hinges on the left side, a magnet door catch to the bottom and add 10" bar pull 1" from the top.

**7****Attach Cabinet Back**

Attach the cabinet back using air compressor and staples. Center the back on the back legs, just below the counter top.

## 8

### Build Fridge Base

Join fridge sides by attaching the fridge base flush with the front. Make 1/2" pocket holes on the undersides of the fridge bottom shelf as well as the top. Attach them both, flush with the front using 1" Kreg screws. The bottom shelf should rest on top of the fridge base support.

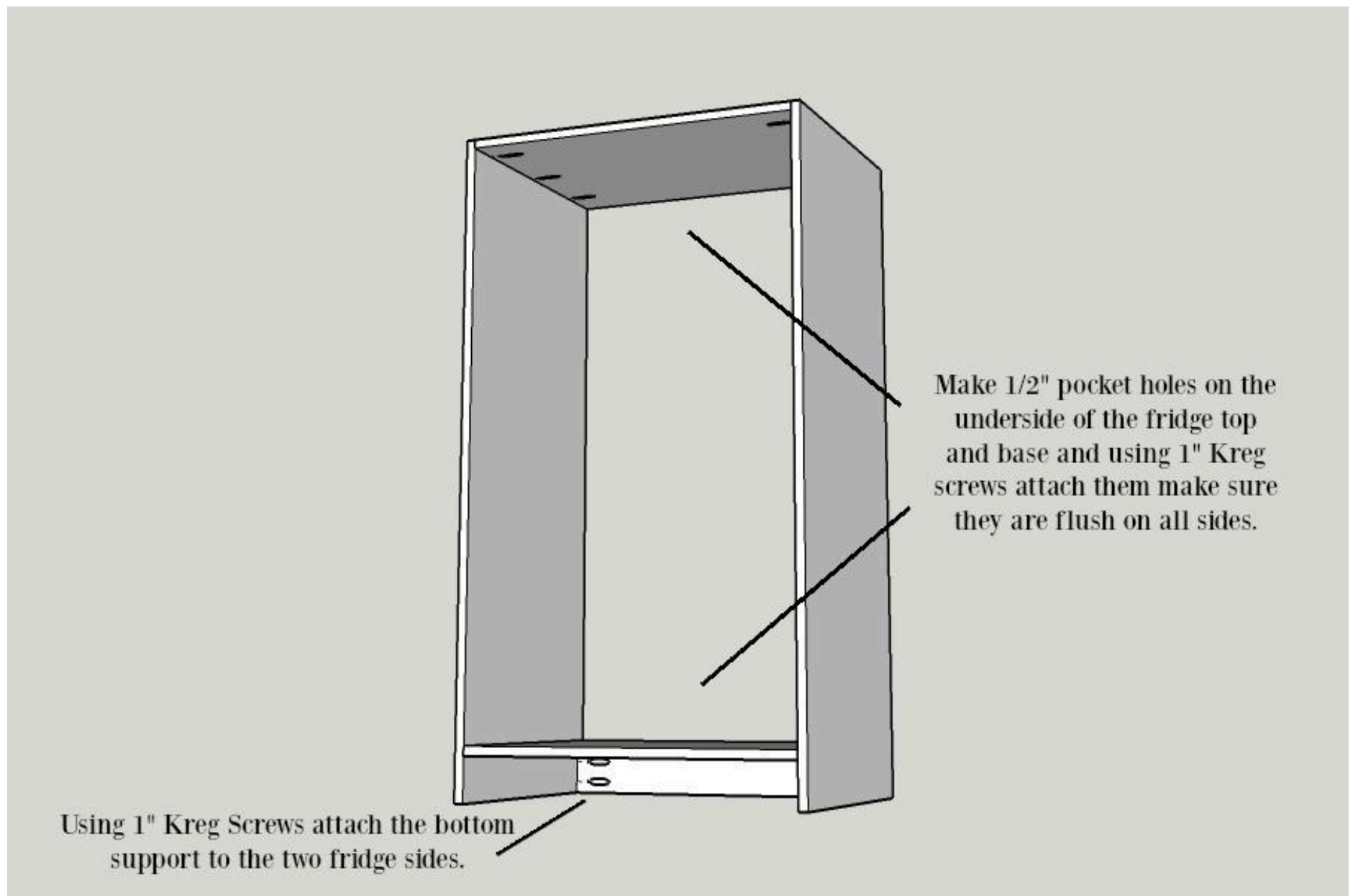



**9****Adding Fridge Shelves**

Use wood glue and brad nails to attach the shelf supports. Shelves will rest on the supports. Nailing in the lower shelf is recommended because the cabinet magnet latch will be installed on that shelf for the freezer door.

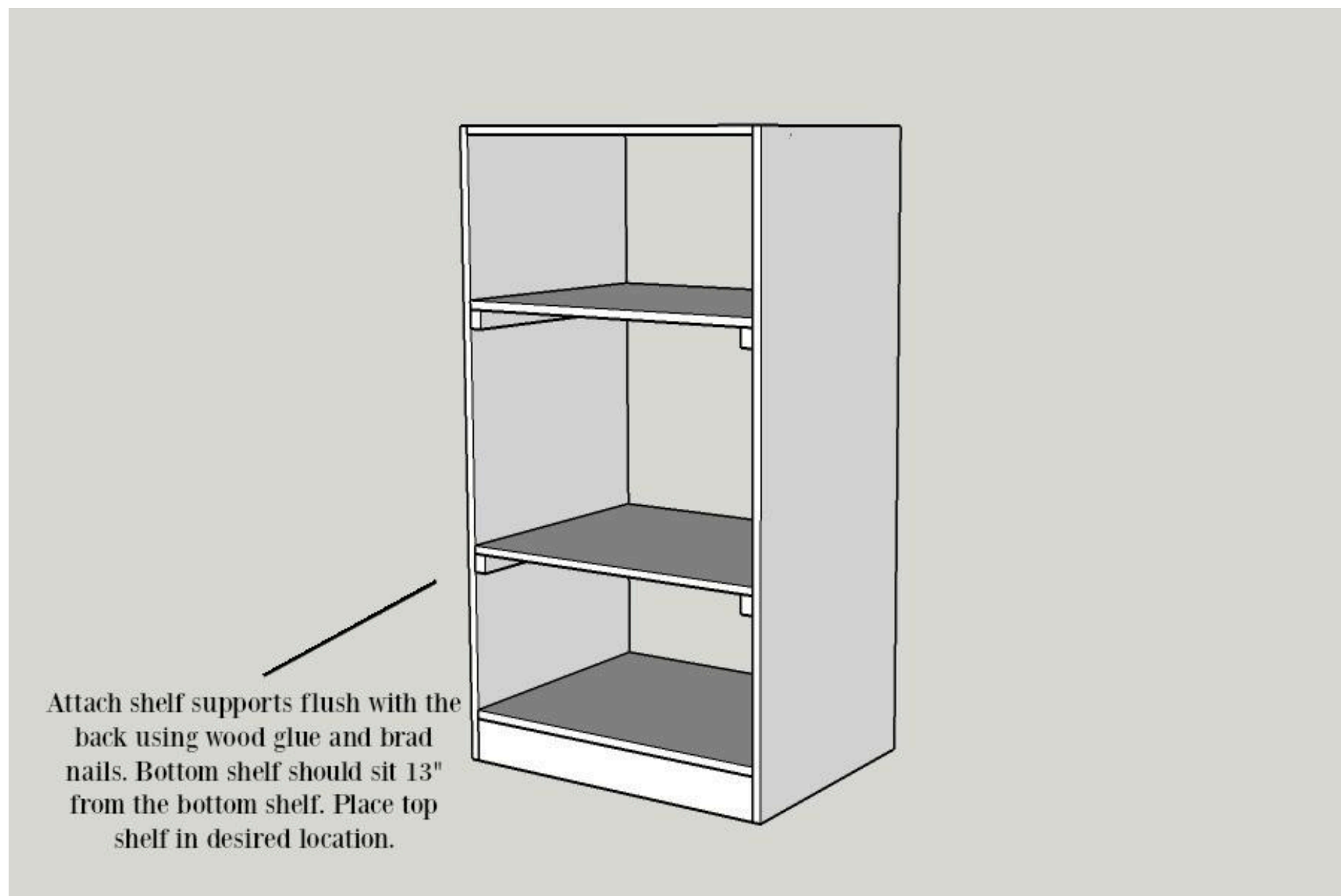

**10****Adding Fridge & Freezer Door**

Using desired hinges attach the fridge and freezer doors. The top fridge door should be flush with the top of the fridge and all sides. There should be 1/4" gap between the fridge and freezer door. Add ball pulls to the two doors to finish it.

Attach doors to the front using desired hinges. Make sure to meet the bottom of the top door and the top of the bottom door over middle shelf. Attach magnet cabinet latches to the middle shelf and the top shelf. Add bar pulls in desired location.

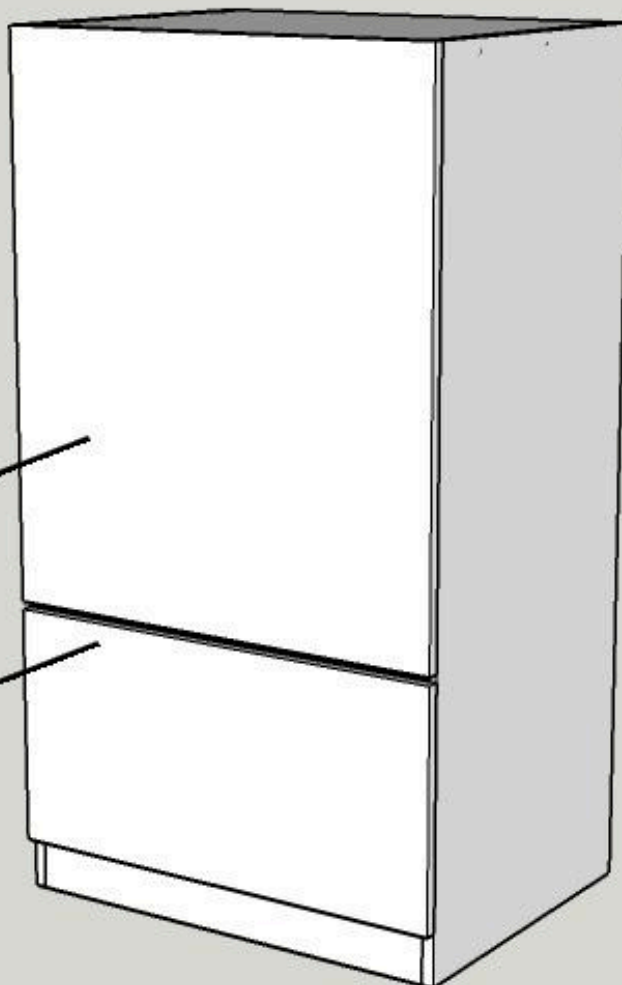
**11****Add Fridge Back**

Attach the back to the fridge/freezer using air compressor and staples. Make it flush with the top and sides.

**12****Paint or Stain**

Sand cabinet and fridge using 120 grit sandpaper. Paint or stain desired color and seal with poly if staining. Finish with a very fine grit sand paper to make a smooth finish.

**13****Add Stove Dials**

Space equally using 1" wood screws to attach to the front. Use the spacers provided in the dial kit.

**14****Add Stove Top**

Using wood glue, glue the wooden discs onto the top of the cabinet equally spacing them. You can also get more play space by not gluing them down so they're removable.

15

## Visit The Tale of an Ugly House

Visit me at [TheTaleofanUglyHouse.com](http://TheTaleofanUglyHouse.com)

the tale of an ugly house  
ugly house to lovely home

---