

DIY 4 Door Media Console

By **Shanty2Chic**

Difficulty

Moderate

We recently crashed our little sister's house and built her a ton of furniture! One of the things she was in need of was a cabinet to house her TV and components. We built her this great console! Not only is it great as a media cabinet, but would also work in any room of the house.



Tools

Kreg Tools



[Kreg® Pocket-Hole Jig 720](#)

Other Tools

Miter Saw

Table Saw

Tape Measure

Drill (cordless)

Nail Gun

Stapler

Sander

Materials

Wood Products

- 1 Board , 1x4 , 96"
- 1 Board , 1x4 , 72"
- 1 Board , 1x3 , 72"
- 3 Board , 1x2 , 72"
- 5 Board , 1x2 , 48"
- 2 Plywood , 3/4" Thick , 96"
- 1 MDF , 1/2" Thick , Quarter Sheet
- 1 MDF , 1/2" Thick , 24" X 24"
- 1 Laminated Board , 18" X 72" , 3/4" Thick

Hardware & Supplies

- 1 Refer To Supply List

Cut List & Parts

1 Refer To Cut List , 1x1

Make sure you read through the instructions carefully and take notice of any special construction notes prior to making any cuts. And always practice safe DIY'ing. Have fun!

PLEASE NOTE - many pieces may require you to cut them to fit a certain size while you are building it. Its best not to cut pieces until you need them. Take your time and study all the diagrams.

CUT LIST

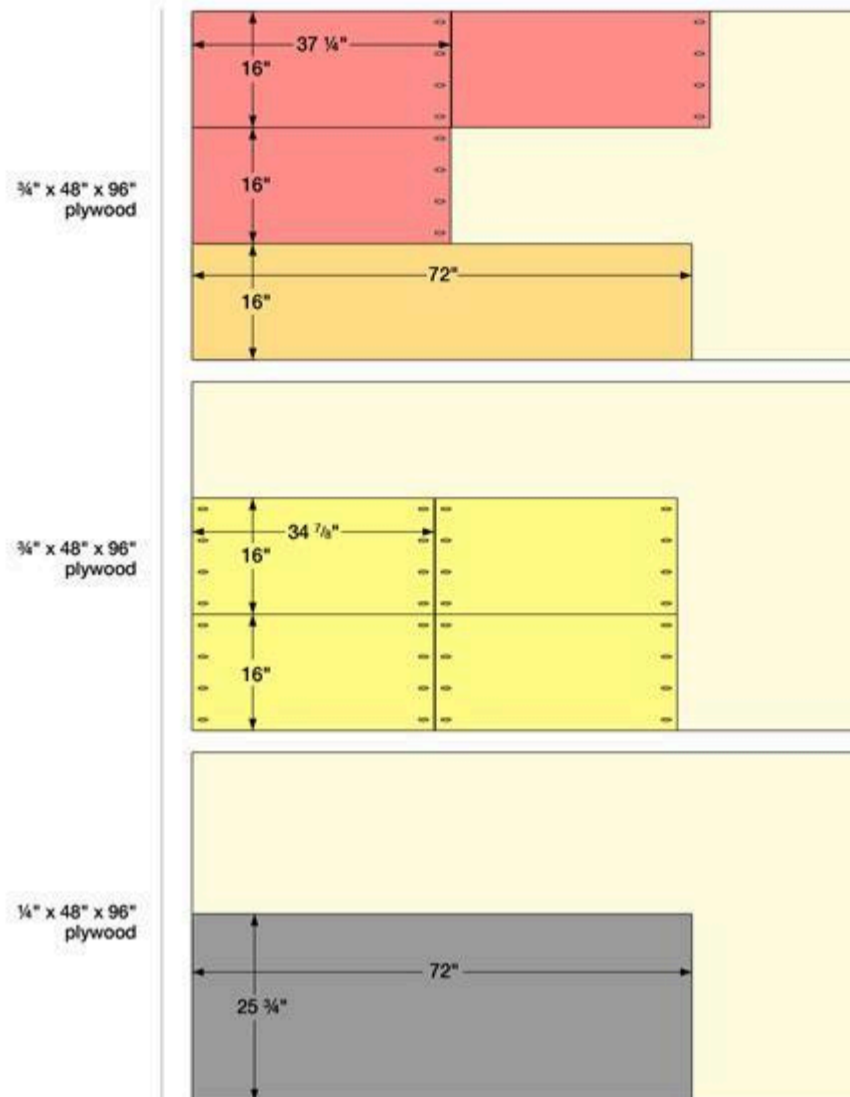

WWW.SHANTY-2-CHIC.COM

Remember!

Many of these cuts are best made as you go. If you have questions, check out the tutorial on our site!

CUT LIST

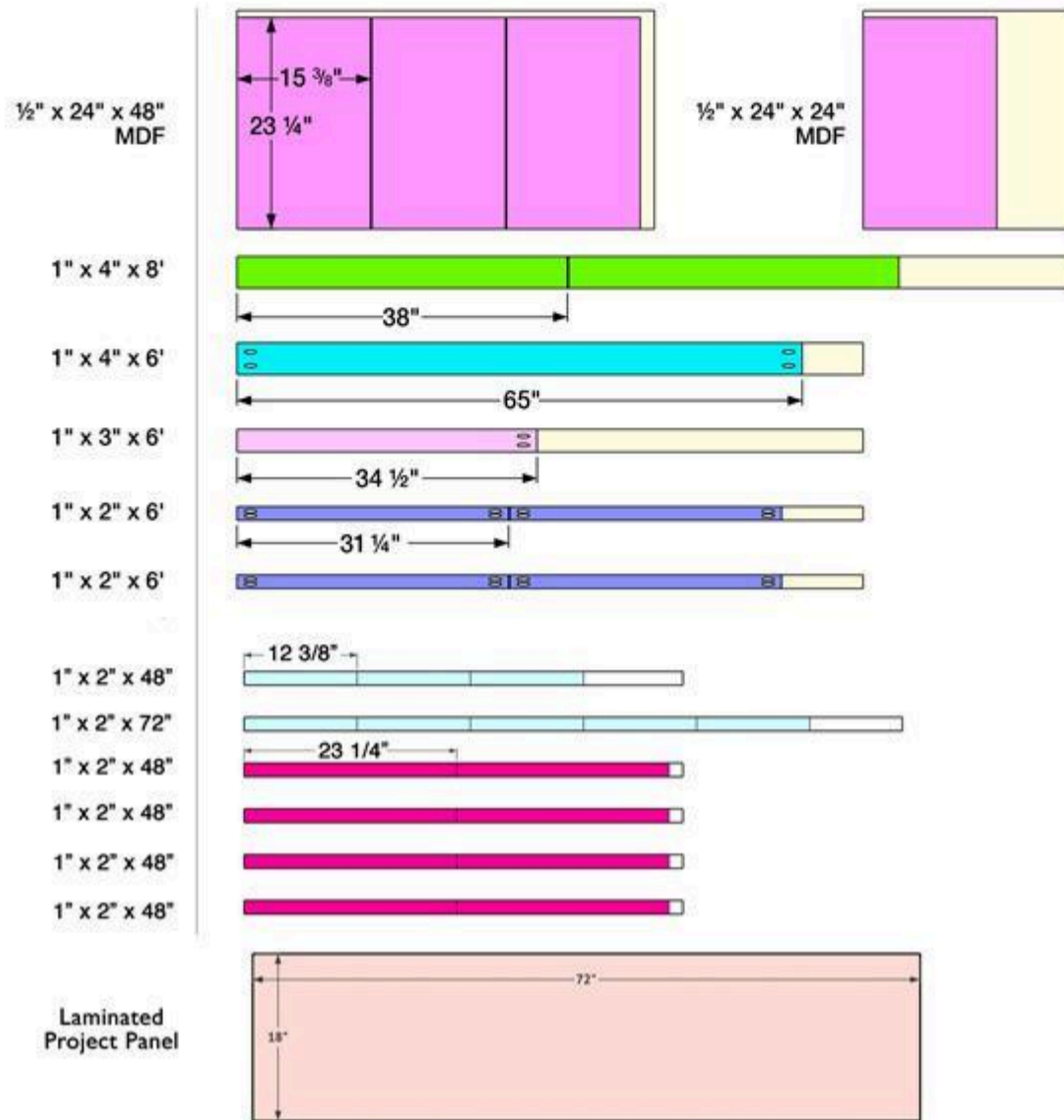

Item	Quantity	Description
1x4x8	1	pine or whitewood
1x4x6	1	pine or whitewood
1x3x6	1	pine or whitewood
1x2x6	3	pine or whitewood
1x2x4	5	pine or whitewood
3/4" plywood panel	2	48" x 96"
1/2" x 24" x 48" MDF	1	can also use hardwood plywood
1/2" x 24" x 24" MDF	1	can also use hardwood plywood
laminated project panel	1	at least 18' x 72"
wood glue		
brad nails		1.25"
staples		1"
pocket hole screws		1.25"

Directions

1**Step 1**

The body of this console is built with $\frac{3}{4}$ " hardwood plywood. You can have the hardware store rip it to 16" for you to make it easier to get home and make your shorter cross cuts at home. Attach the 3 vertical panels to the longer horizontal panel using wood glue and 1.25" pocket hole screws through $\frac{3}{4}$ " pocket holes. Make sure your pocket holes are facing in on the two outside panels so they will be hidden when finished.

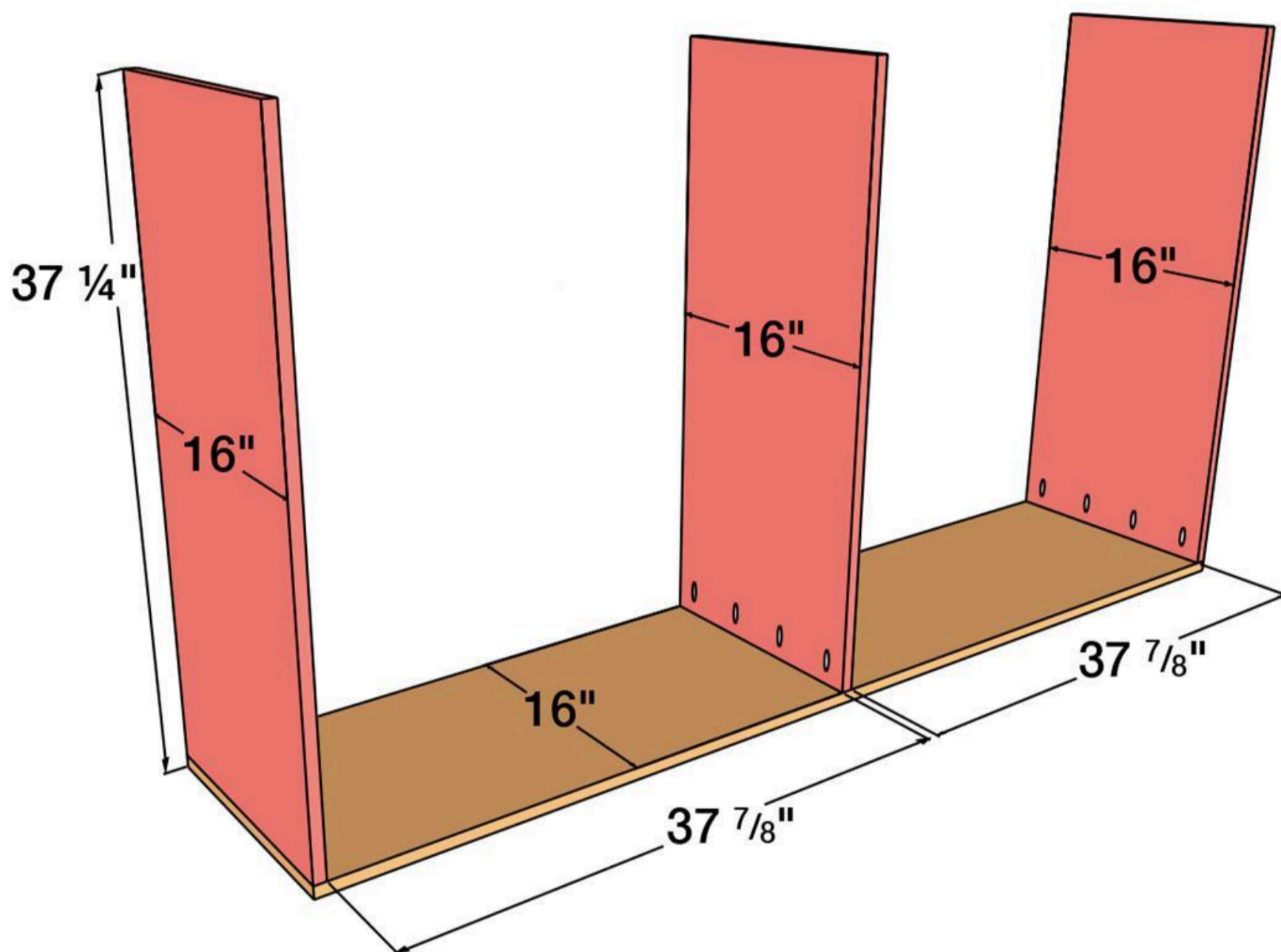

2

Step 2

Next, attach the shelf pieces. These are all equal lengths. Make sure to line them up and attach them square to help attach the doors in a later step.

Attach each shelf using wood glue and 1.25" pocket hole screws through

3/4" pocket holes on each piece. Make sure the pocket holes are facing up which will be the bottom side of the cabinet once standing up.

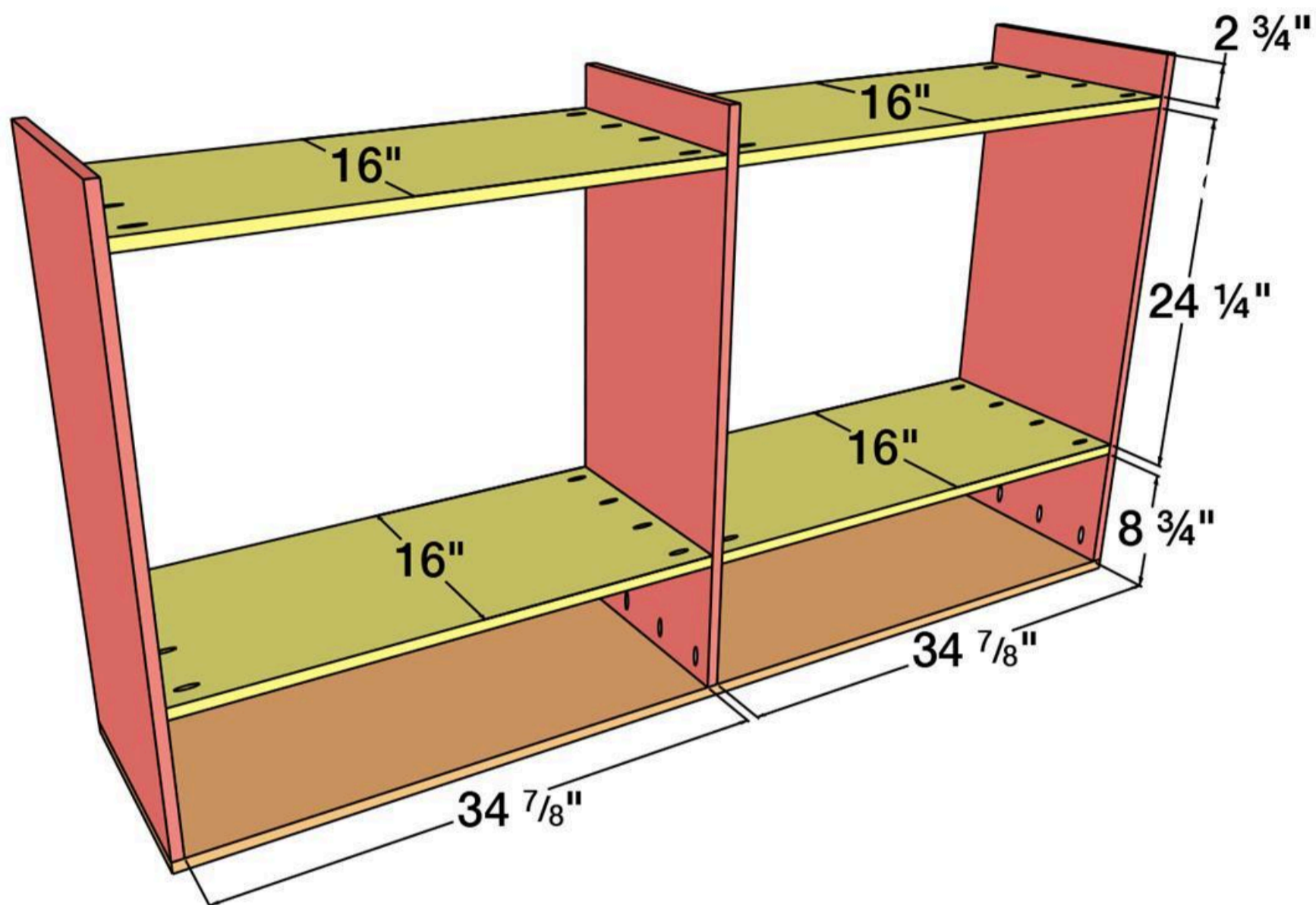

3

Step 3

Build the face frame for the cabinet next. These are whitewood or pine boards cut to size. Attach each piece using wood glue and 1.25" pocket holes through 3/4" pocket holes. The pocket holes should all be facing up which will be the back of the face frame and hidden once attached.

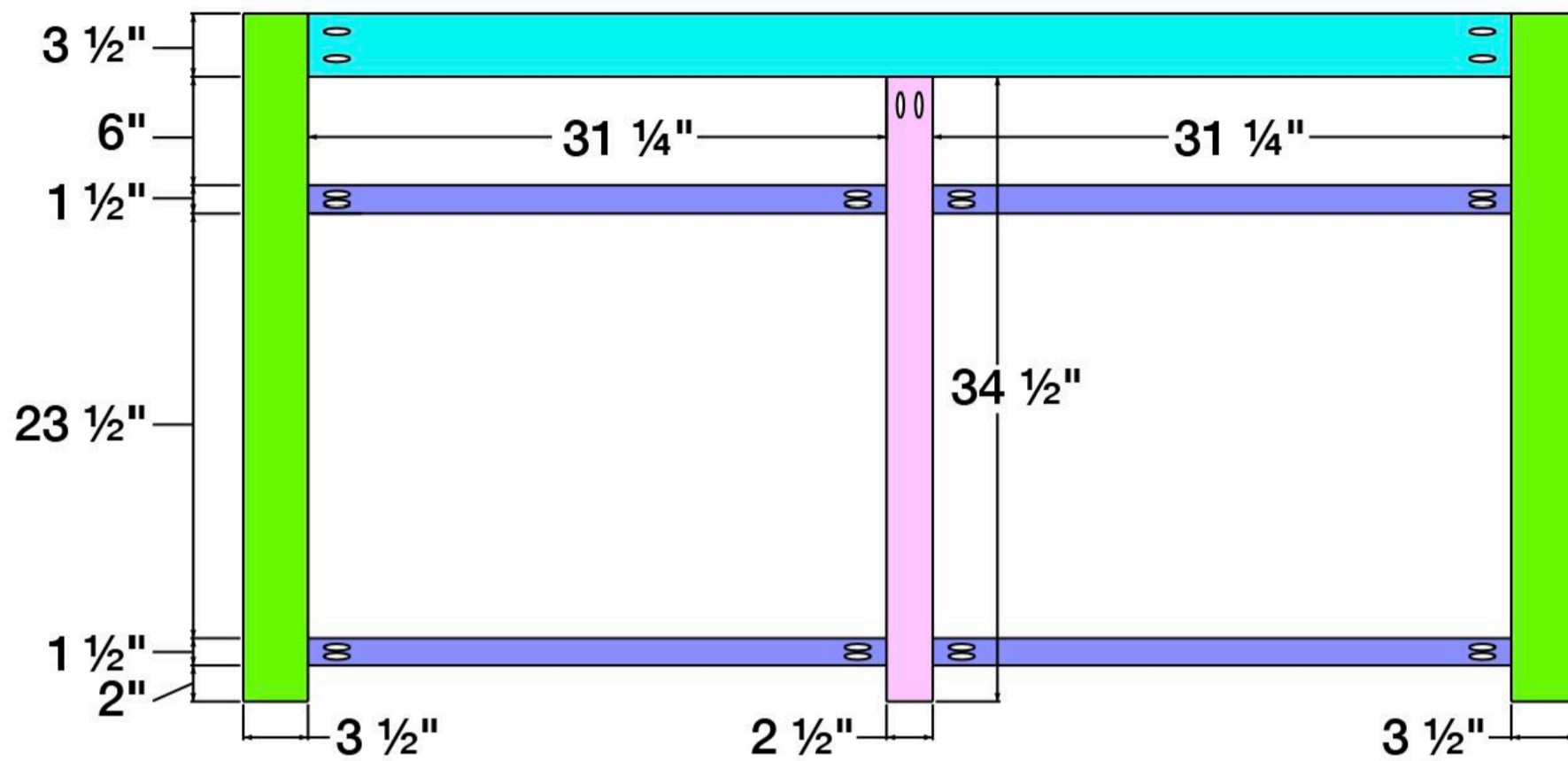

4

Step 4

Attach the face frame to the console using wood glue and 1.25" brad or finish nails through the face frame and into the body of the cabinet. The pocket holes will the cabinet on this part to hide them.

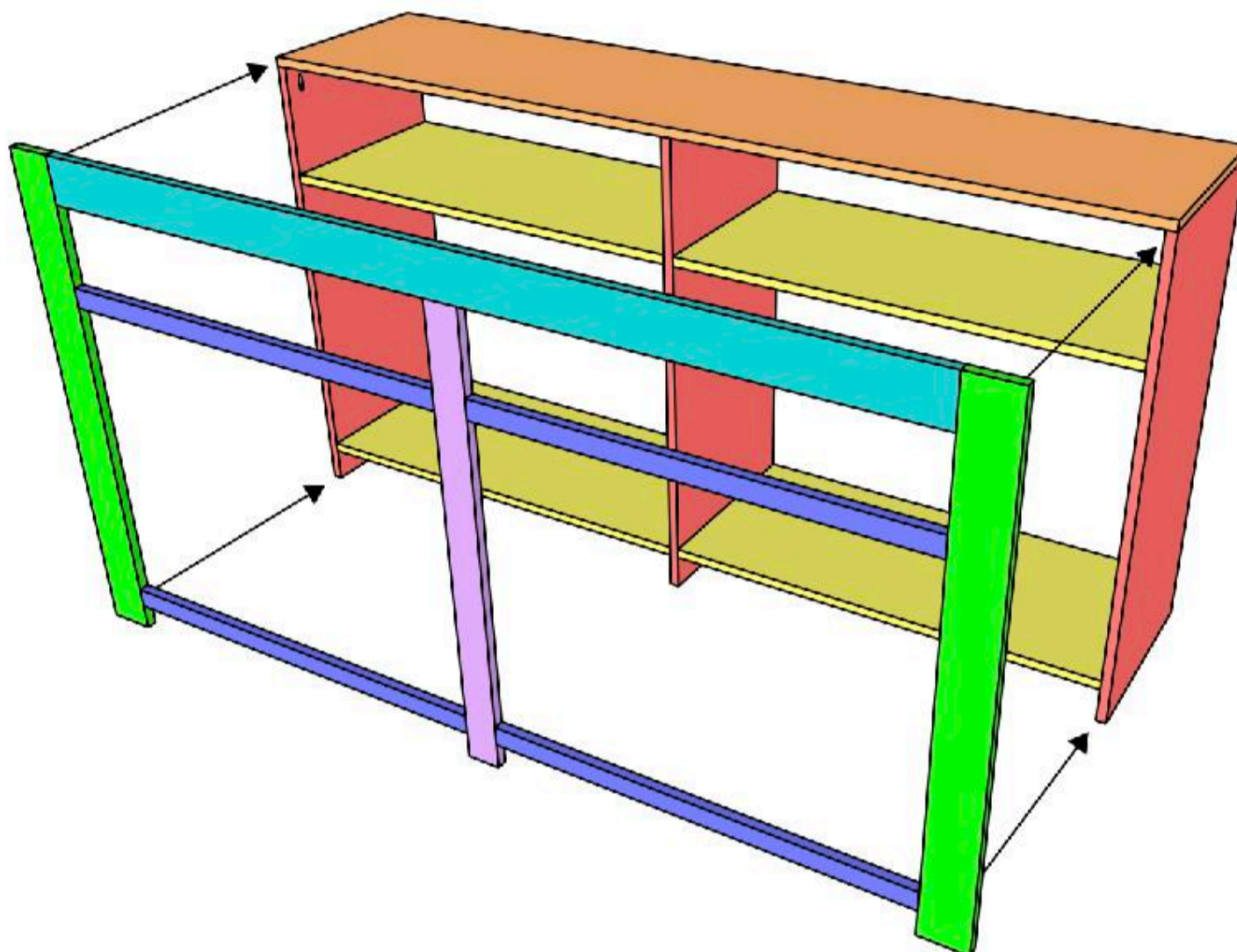

5

Step 5

Next, attach the back hardwood plywood panel. This is a 1/4" thick sheet of hardwood plywood that we had the hardware store cut to size. Attach it to the back and bottom of the cabinet using wood glue and 1" staples or brad nails.

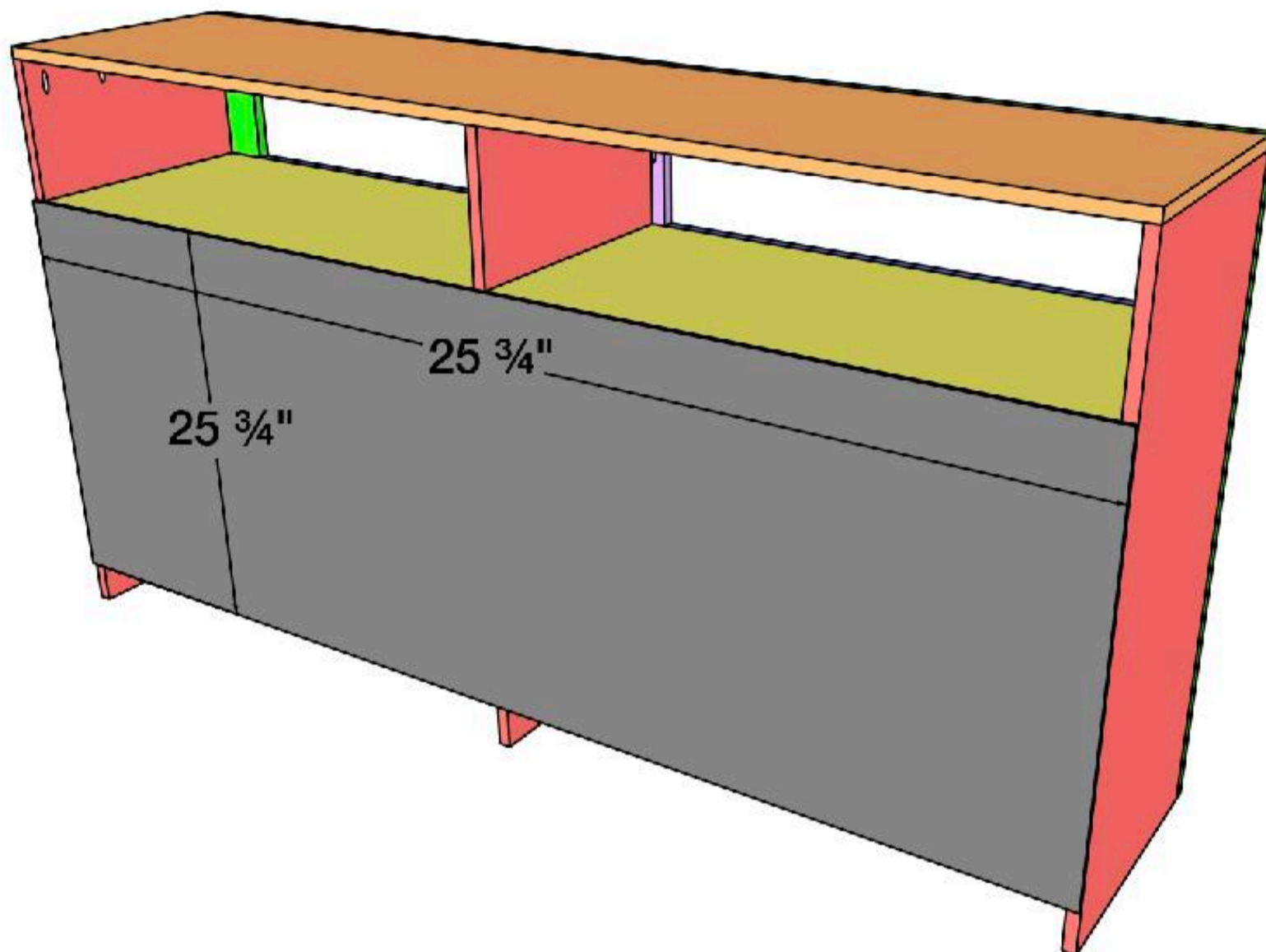

6**Step 6**

Build the doors next. You will build 4 identical doors for this cabinet. The door itself is made from 1/2" MDF, but you can also use hardwood plywood. Attach trim the edges as shown using wood glue and 1.25" brad nails through each trim piece and into the wood sheet. Now you can have fun with your finish! You can paint it at this point, or we added some hardwood planks to ours. ♦ This is the part where you can really make the cabinet your own!

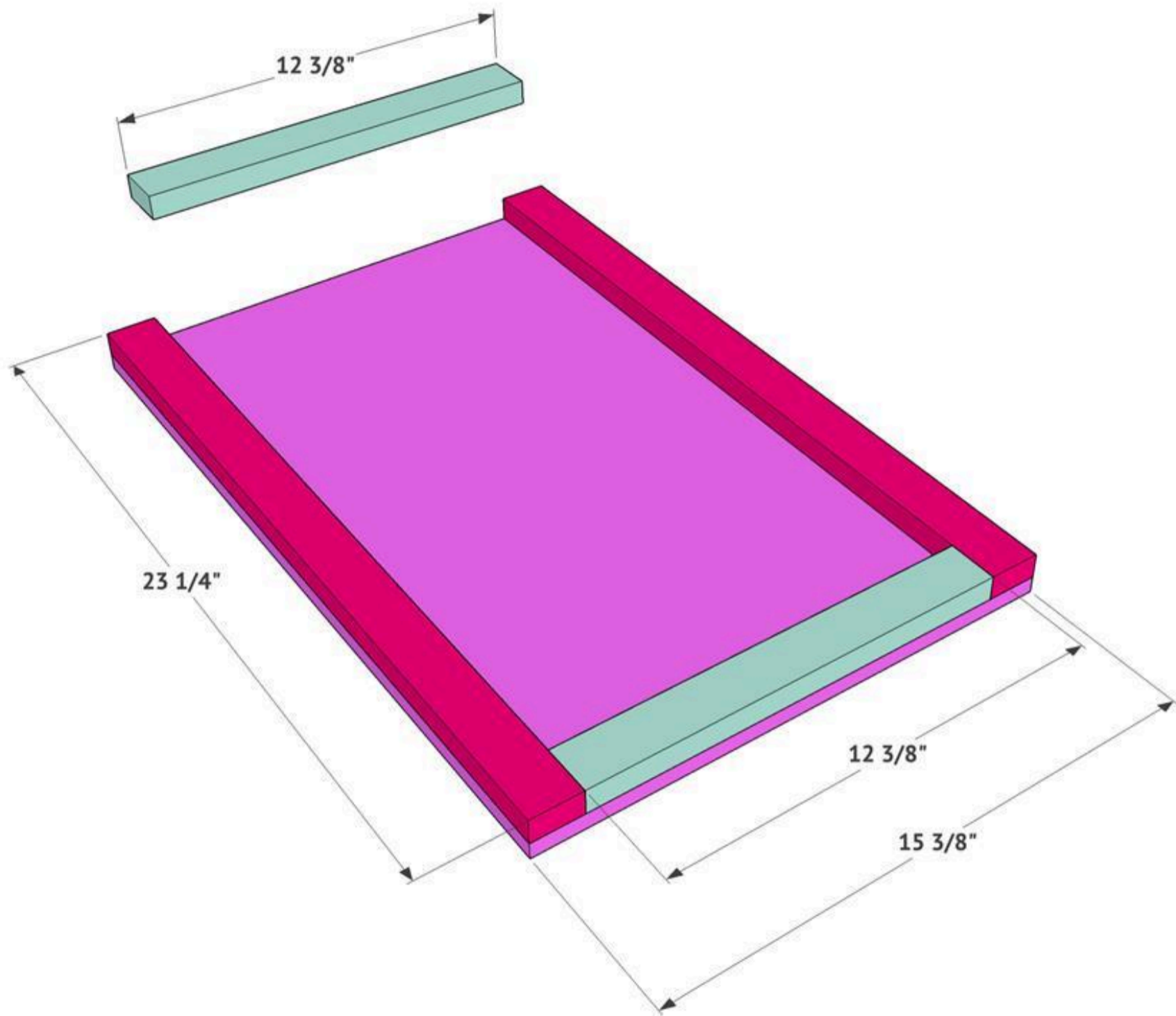

7**Step 7**

Attach the top project panel next. Center it on the top of the console and attach it using wood glue and 1.25" brad nails through the project panel and into the top of the console.

If you are staining this panel, you will want to do that before attaching.

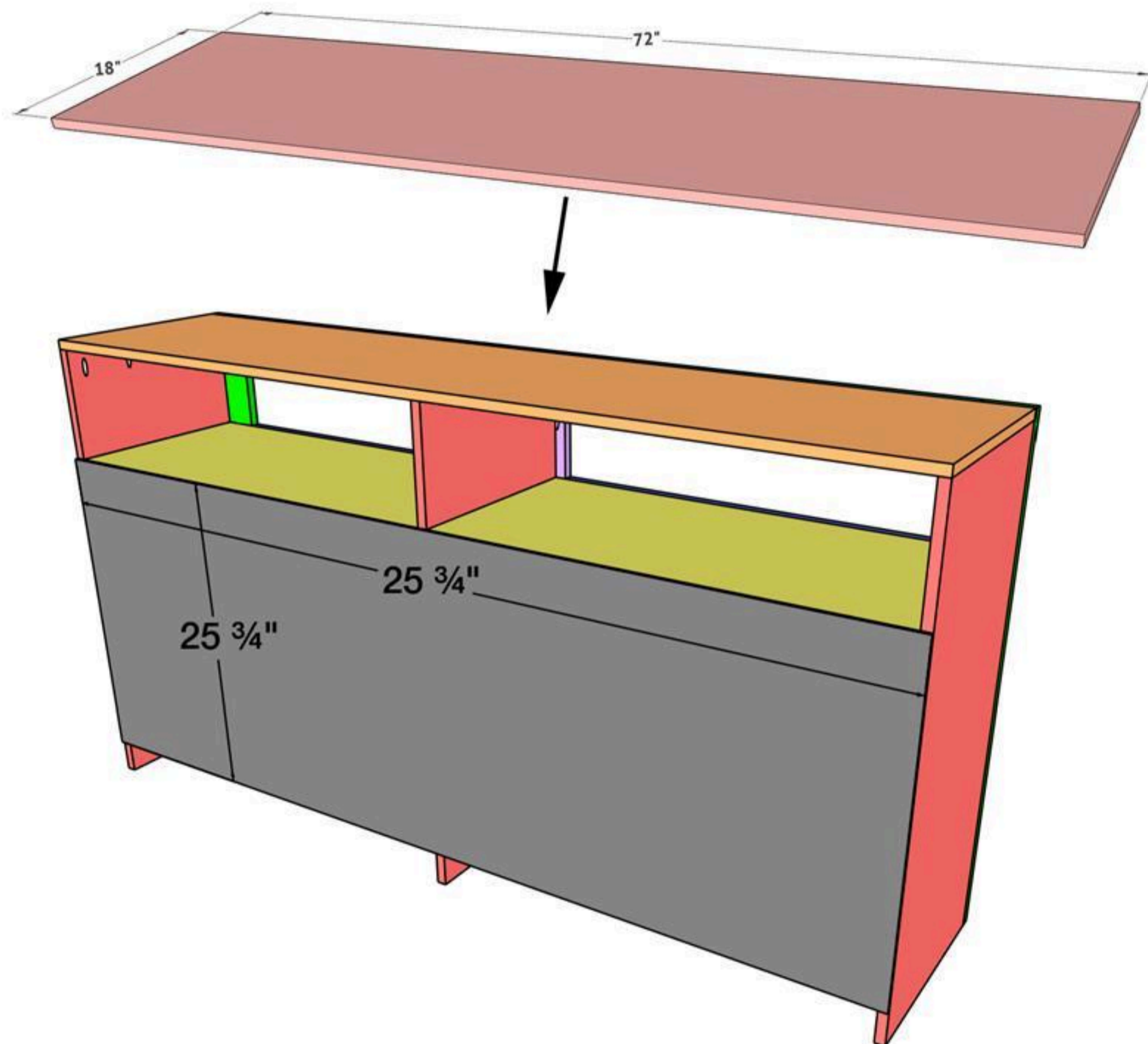
**8****Step 8**

We painted our sister's console Tricorn Black by Sherwin-Williams and stained the barnwood planks and project panel using Golden Oak Stain by Varathane. After painting and staining we attached all of the doors with the hardware. You can check out our website for info on where to find the cute hardware!