

Hot Cocoa Bar

By **House Becoming Home**

Difficulty

Easy

This simple build perfectly displays all the ingredients for a successful hot chocolate bar. Bring it out for your holiday parties, a winter wedding, or just a fun evening with friends and family. Made primarily from small pieces, you can likely put this together with scraps from other projects.

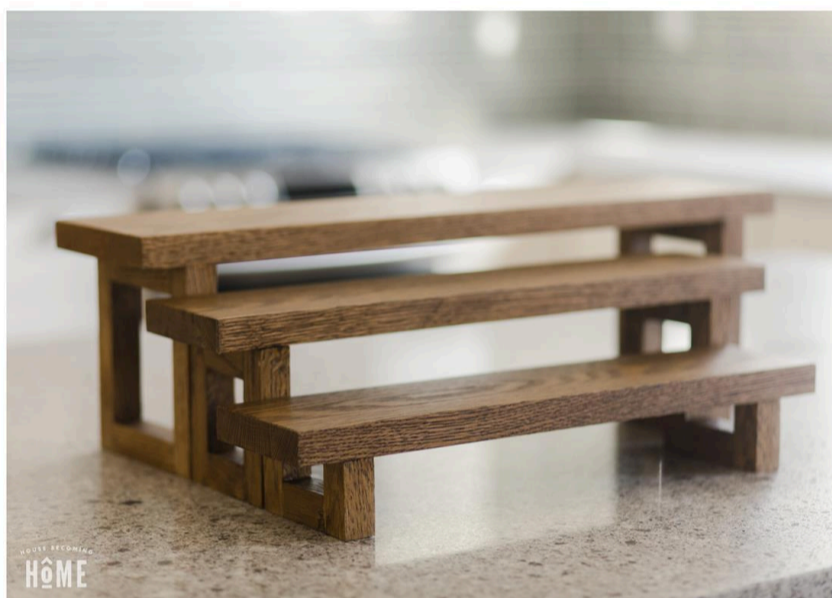

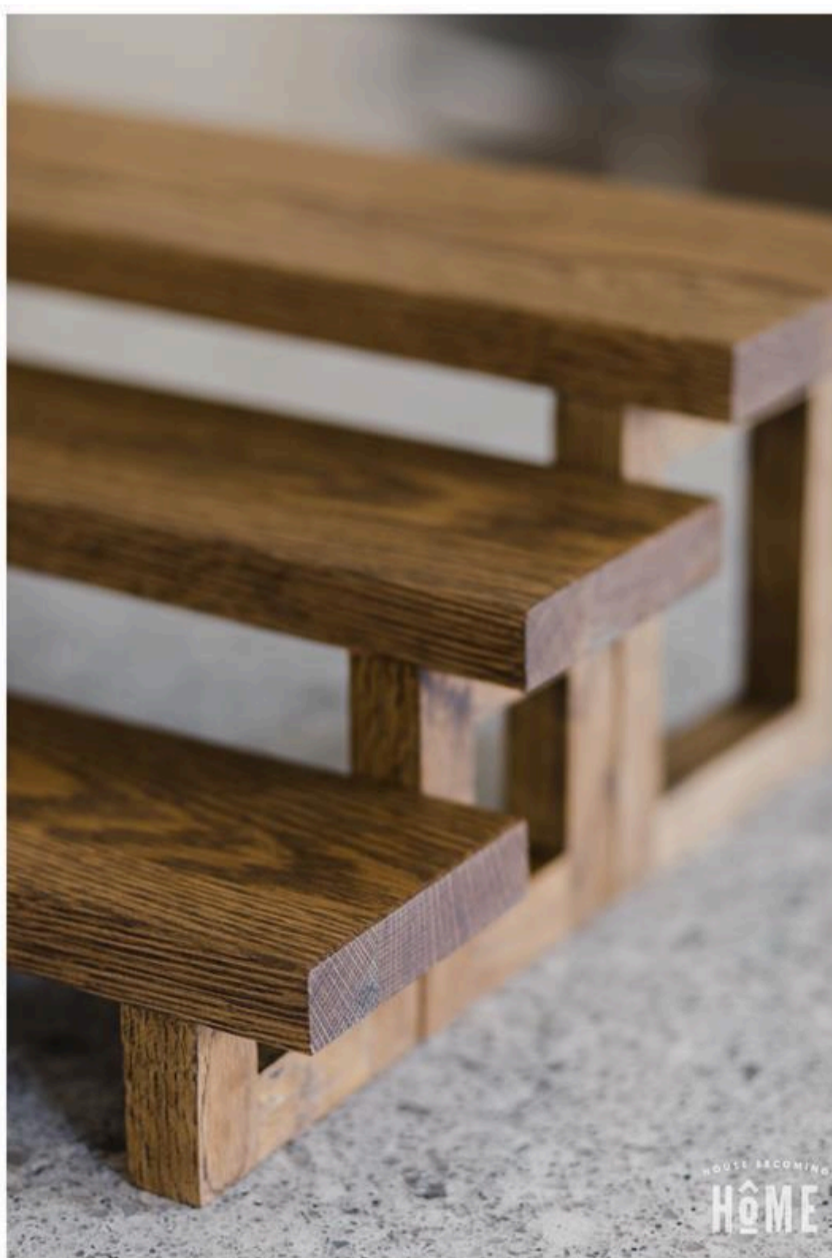

Tools

Kreg Tools

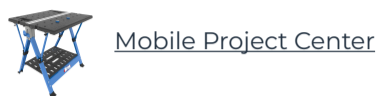

Other Tools

Miter Saw

Table Saw

Sander

Materials

Wood Products

1 Board , 1" X 11-1/2" , 43"

2 Board , 1" X 1" , 48"

Hardware & Supplies

1 Wood Glue

1 Sandpaper

1 Wood Stain

1 Polyurethane

Cut List & Parts

- 4 Small Tier Legs - Side Pieces , 1"x1"x2-1/4"
- 2 Small Tier Legs - Bottom Pieces , 1"x1"x2-3/4"
- 4 Medium Tier Legs - Side Pieces , 1"x1"x5"
- 4 Medium Tier Legs - Top & Bottom Pieces , 1"x1"x2-3/4"
- 4 Large Tier Legs - Side Pieces , 1"x1"x7"
- 4 Large Tier Legs - Top & Bottom Pieces 1"x1"x , 1"x1"x4-1/4"
- 1 Small Tier Top , 1"x20"x4-3/4"
- 1 Medium Tier Top , 1"x22"x4-3/4"
- 1 Large Tier Top , 1"x27"x6-1/4"

Directions

1

Cut Lumber

Cut lumber to size, then organize into groups: small, medium, and large tiers.



2**Assemble Small Tier Legs**

Using wood glue and clamps, assemble the legs of the small tier.

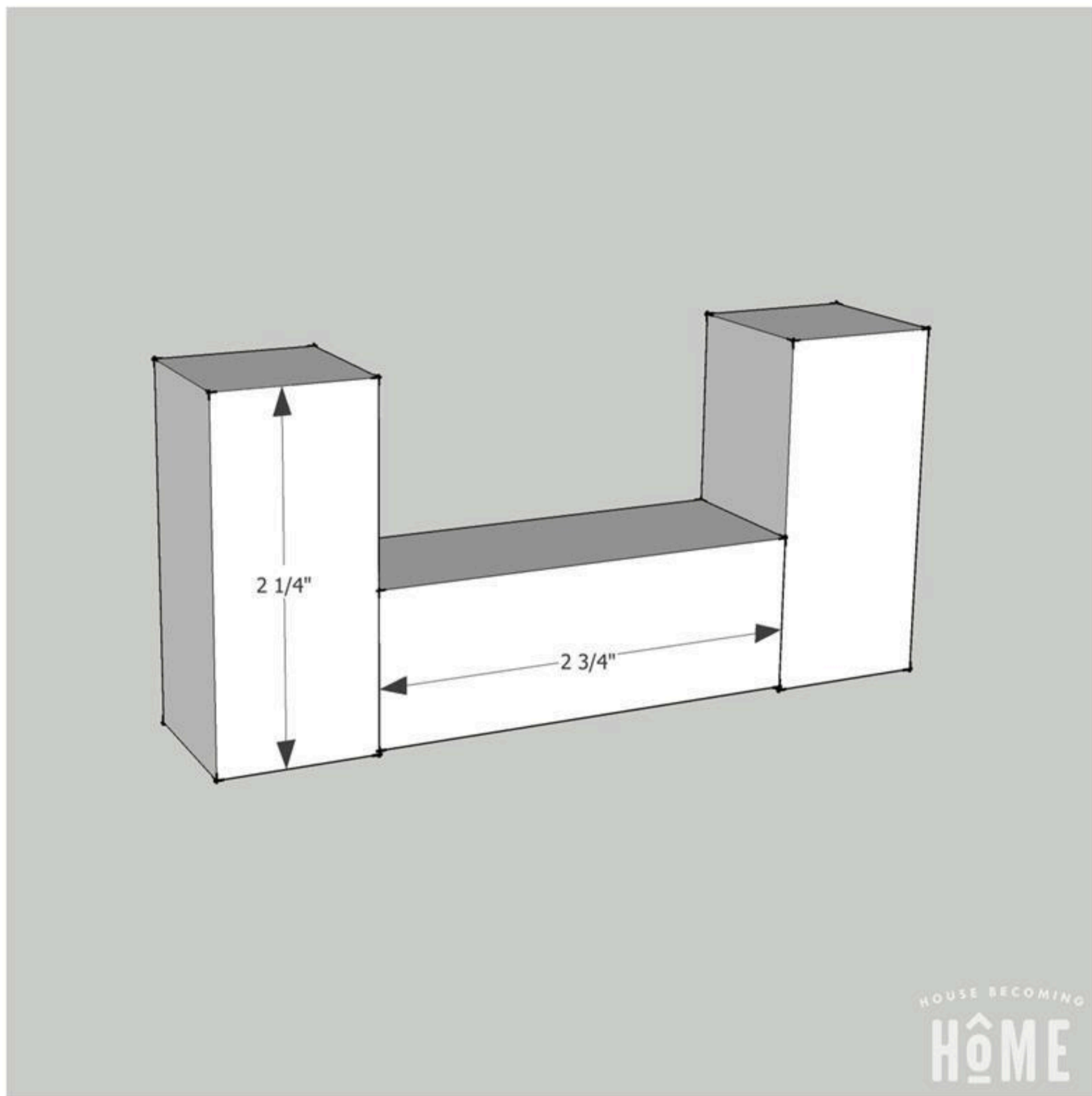

3**Assemble Medium Tier Legs**

Using wood glue and clamps, assemble the legs of the medium tier.

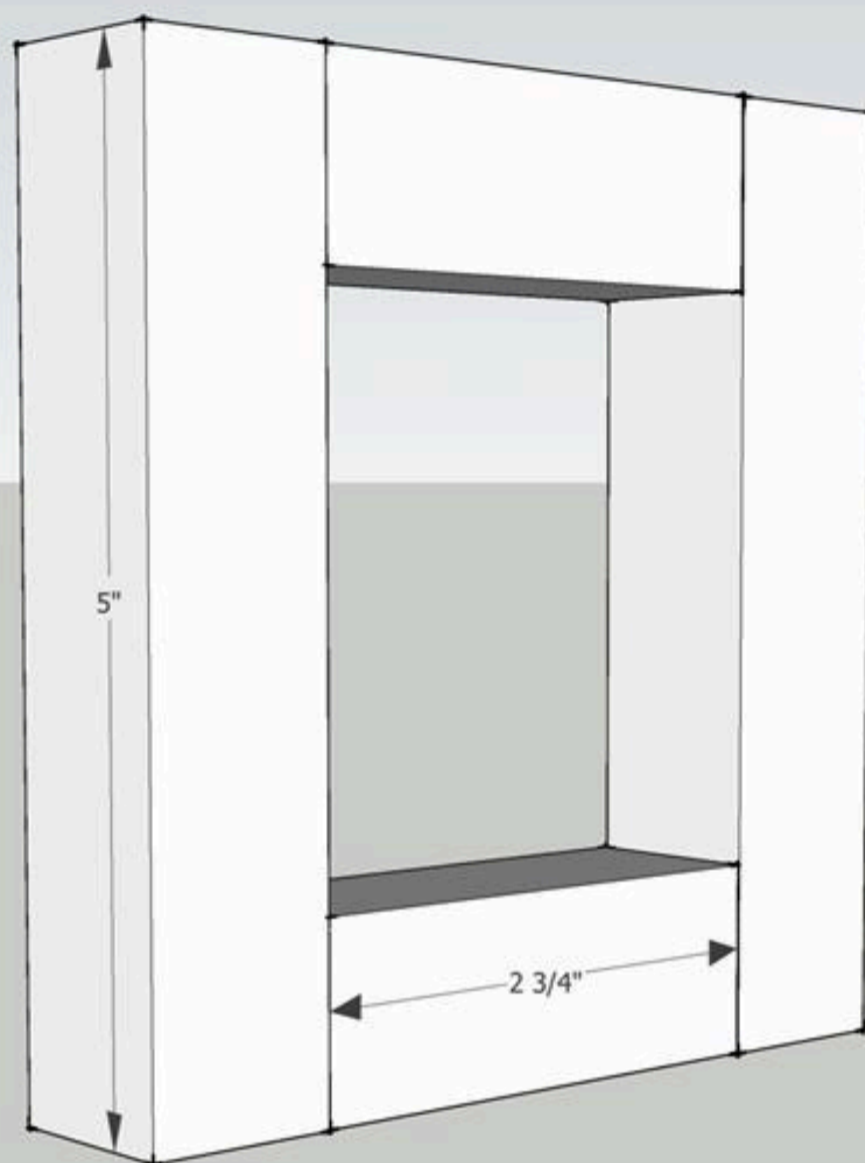

HOUSE BECOMING
HÔME

4

Assemble Large Tier Legs

Using wood glue and clamps, assemble the legs of the large tier.

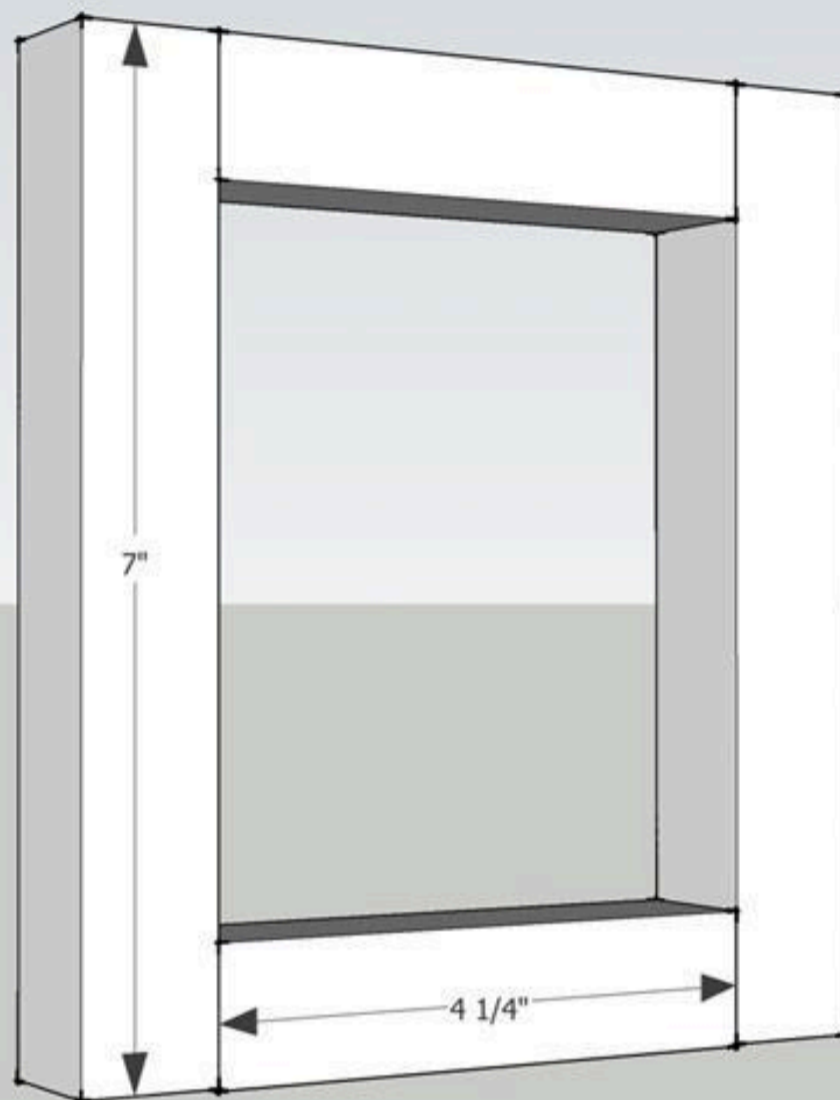

HOUSE BECOMING
HÔME

5**Attach Legs to Small Tier Top**

Using wood glue and clamps, attach completed legs to the small tier top, 1-1/2" from the edge. Use a carpenter's square to ensure legs are attached at 90 degrees.

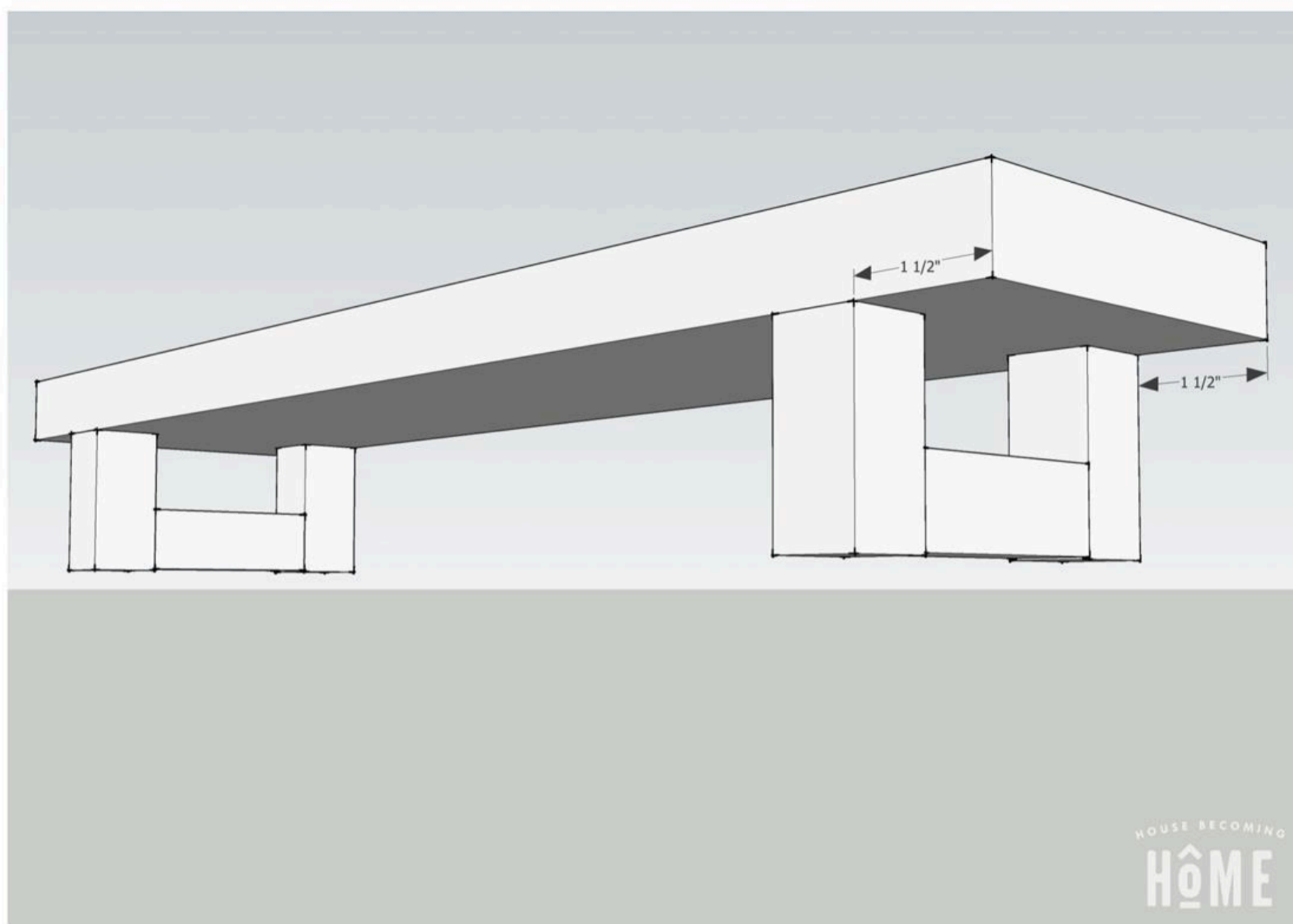

6

Attach Legs to Medium Tier Top

Using wood glue and clamps, attach completed legs to the medium tier top, 1-1/2" from the edge. Use a carpenter's square to ensure legs are attached at 90 degrees.

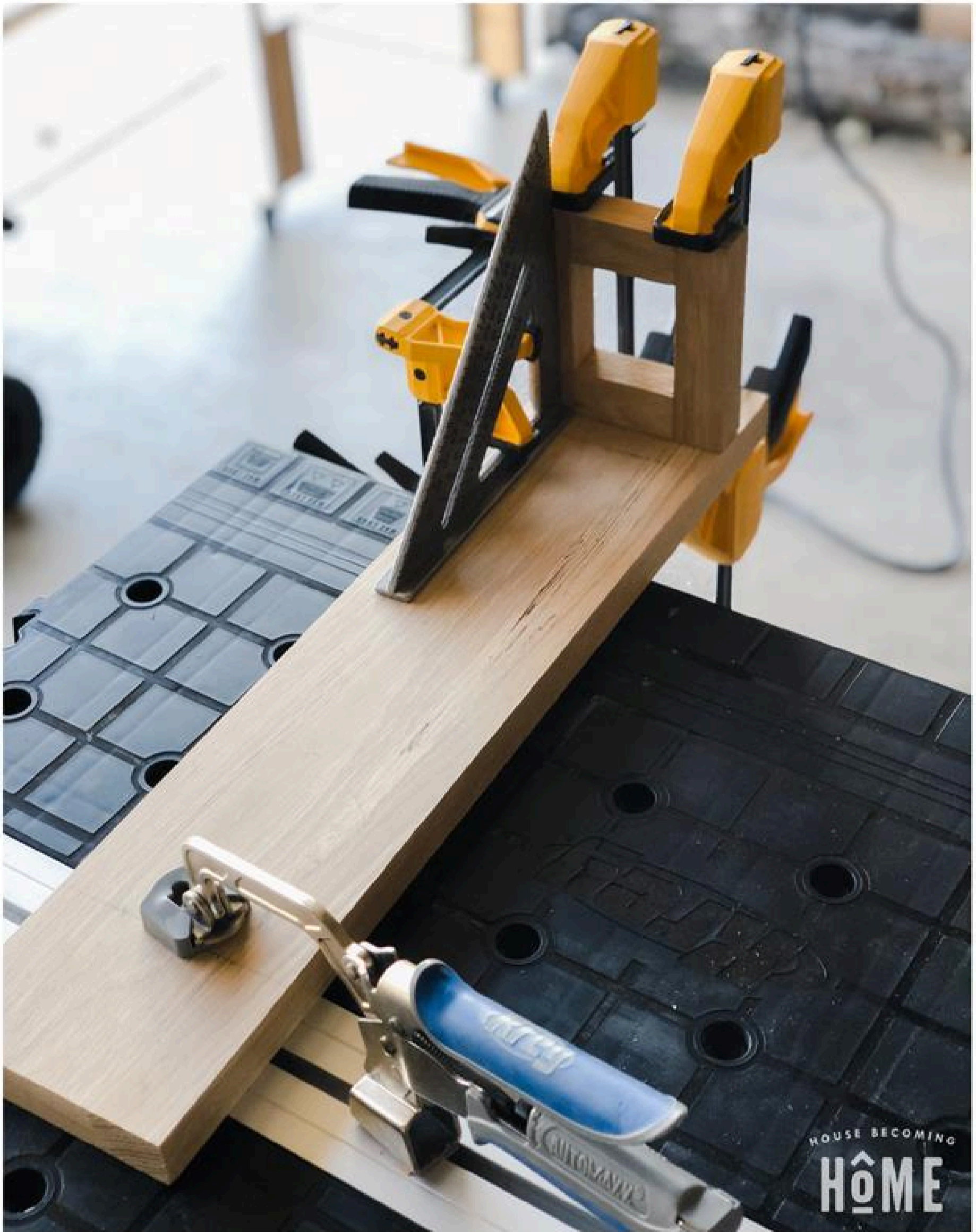

7

Attach Legs to Large Tier Top

Using wood glue and clamps, attach completed legs to the large tier top, 1-1/2" from the edge. Use a carpenter's square to ensure legs are attached at 90 degrees.

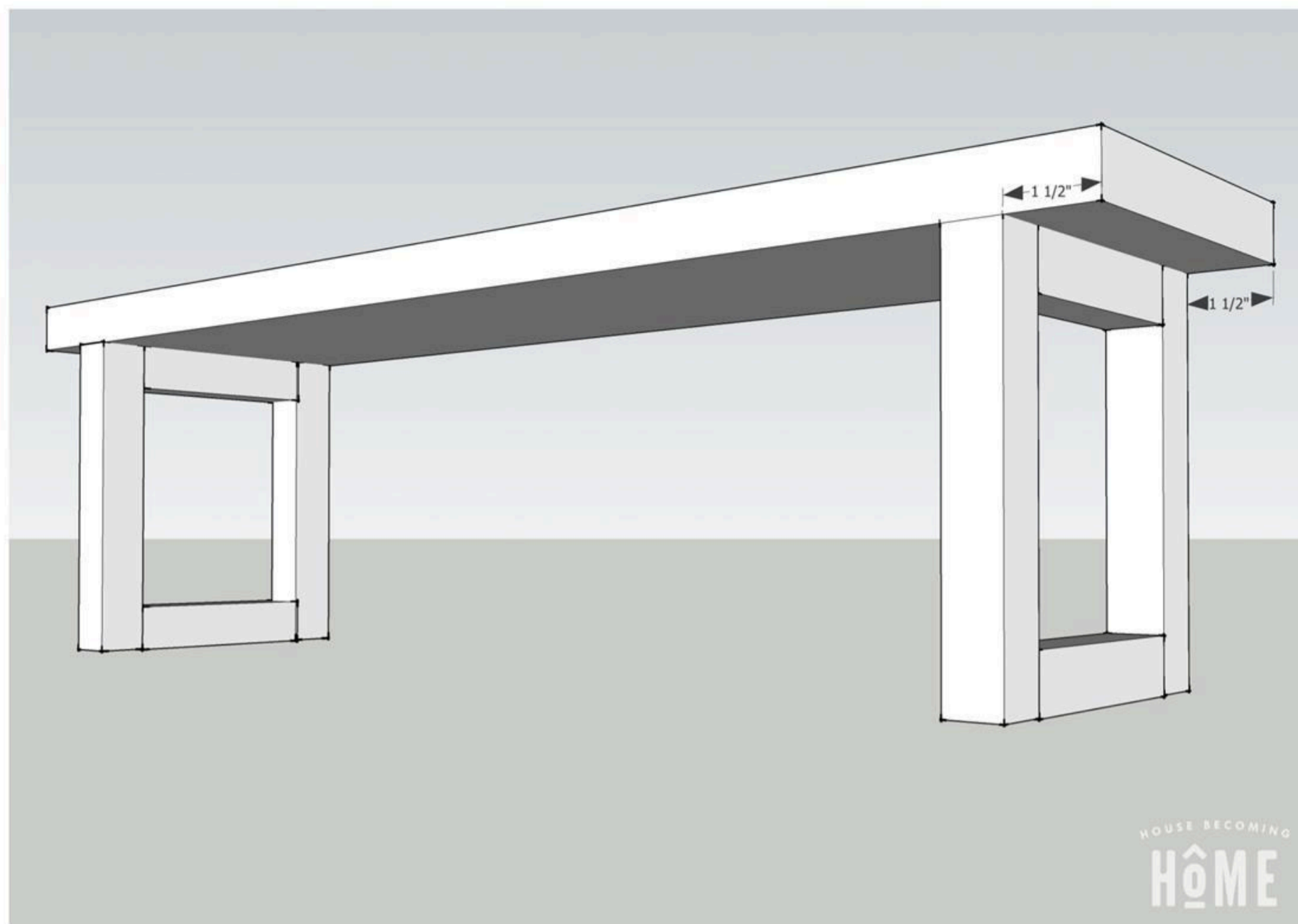

8

Sand

Sand all faces and the legs of each tier.

9

Stain

Stain all faces and legs of each tier. Once stain is dry, protect with several layers of polyurethane.

