

Modern TV Stand

By **CreatiffDIY**

Difficulty

Moderate

Build this beautiful tv console table that has lots of storage and magnetic door closures for a clean and modern look.





Tools

Kreg Tools

Kreg®
Pocket-Hole Jig [Kreg® Pocket-Hole Jig 720](#)

Rip-Cut™ [Rip-Cut™](#)

Zinc
Pocket-Hole Screws [Zinc Pocket-Hole Screws](#)

Solid-Wood
Pocket-Hole Plugs [Solid-Wood Pocket-Hole Plugs Plugs--Pine](#)

90°
Corner Clamp [90° Corner Clamp](#)

Concealed
Hinge Jig [Concealed Hinge Jig](#)

Concealed
Hinge Jig [Concealed Hinge Jig](#)

Other Tools

Miter Saw

Power Drill

Orbital Sander

Router

Brad Nailer

Iron

Tape Measure

Materials

Wood Products

- 1 3/4" Hardwood Plywood , 4'x8'
- 2 Pine , 1"x2"x8' , 3/4"x1 1/2"x8'
- 1 Edge Glued Panel, Pine , 3/4"x20"x8'
- 1 1/8" Hardboard , 4'x8'
- 1 Edge Banding

Hardware & Supplies

- 8 Inset Concealed Cabinet Hinges
- 4 Magnetic Push Open Latch
- 48 1 1/4" Pocket Hole Screws
- 1 Wood Glue
- 4 1 1/4" Wood Screws
- 40 5/8" Brad Nails
- Sand Paper
- Stain Or Paint
- Polycrylic Topcoat

Cut List & Parts

- 2 Top And Bottom, 3/4" Plywood , 72"x15 1/2"
- 2 Sides, 3/4" Plywood , 18 1/2"x15 1/2"
- 1 Middle Support, 3/4" Plywood , 18 1/2"x15 3/8"
- 4 Doors, 3/4" Pine Panel , 18 1/4"x17 1/4"
- 4 Base , 3/4"x1 1/2"x6"
- 4 Base , 3/4"x1 1/2"x10 1/2"
- 1 Base , 3/4"x1 1/2"x53"
- 1 Backing, Hardboard , 71"x19"

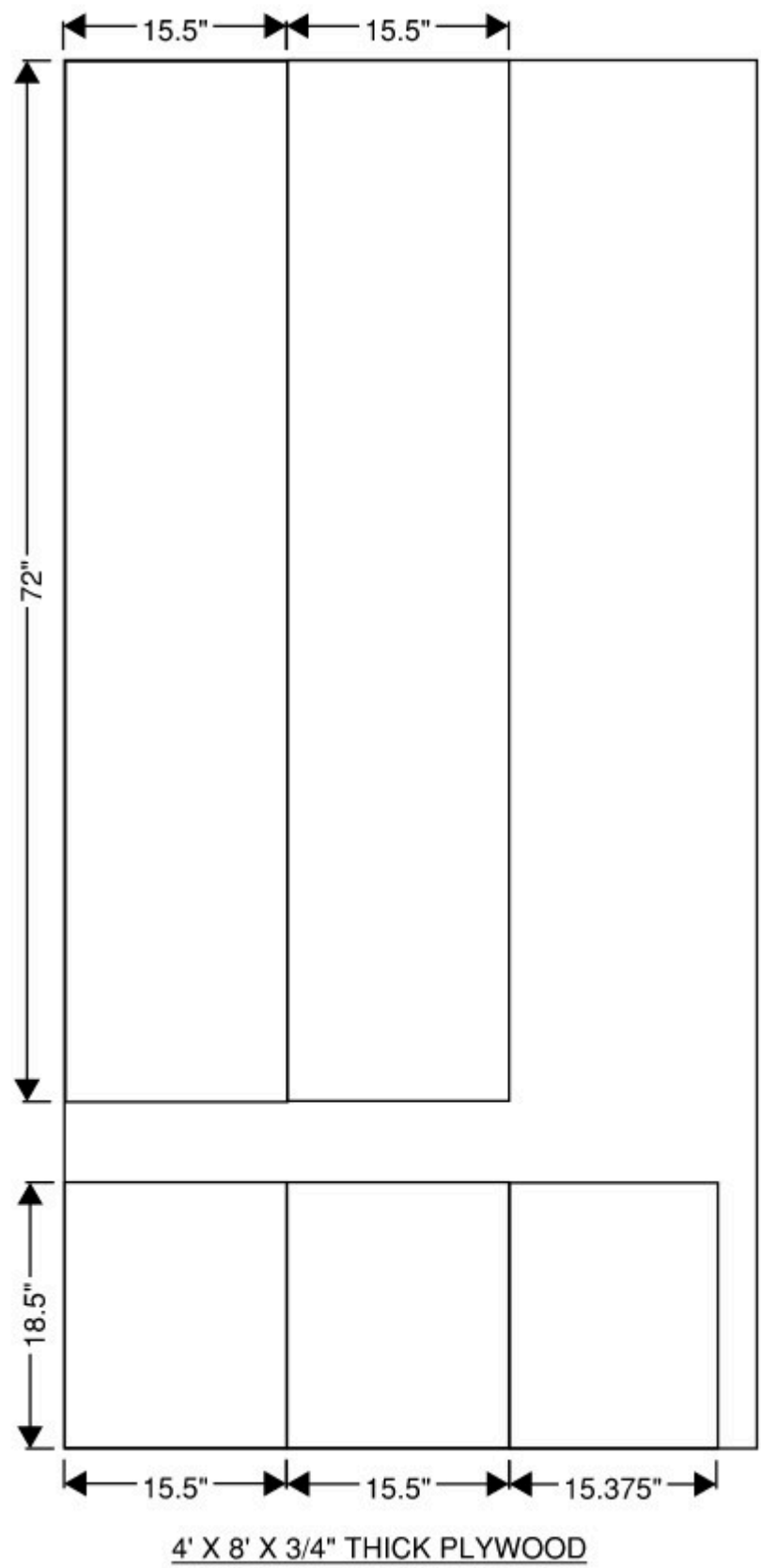

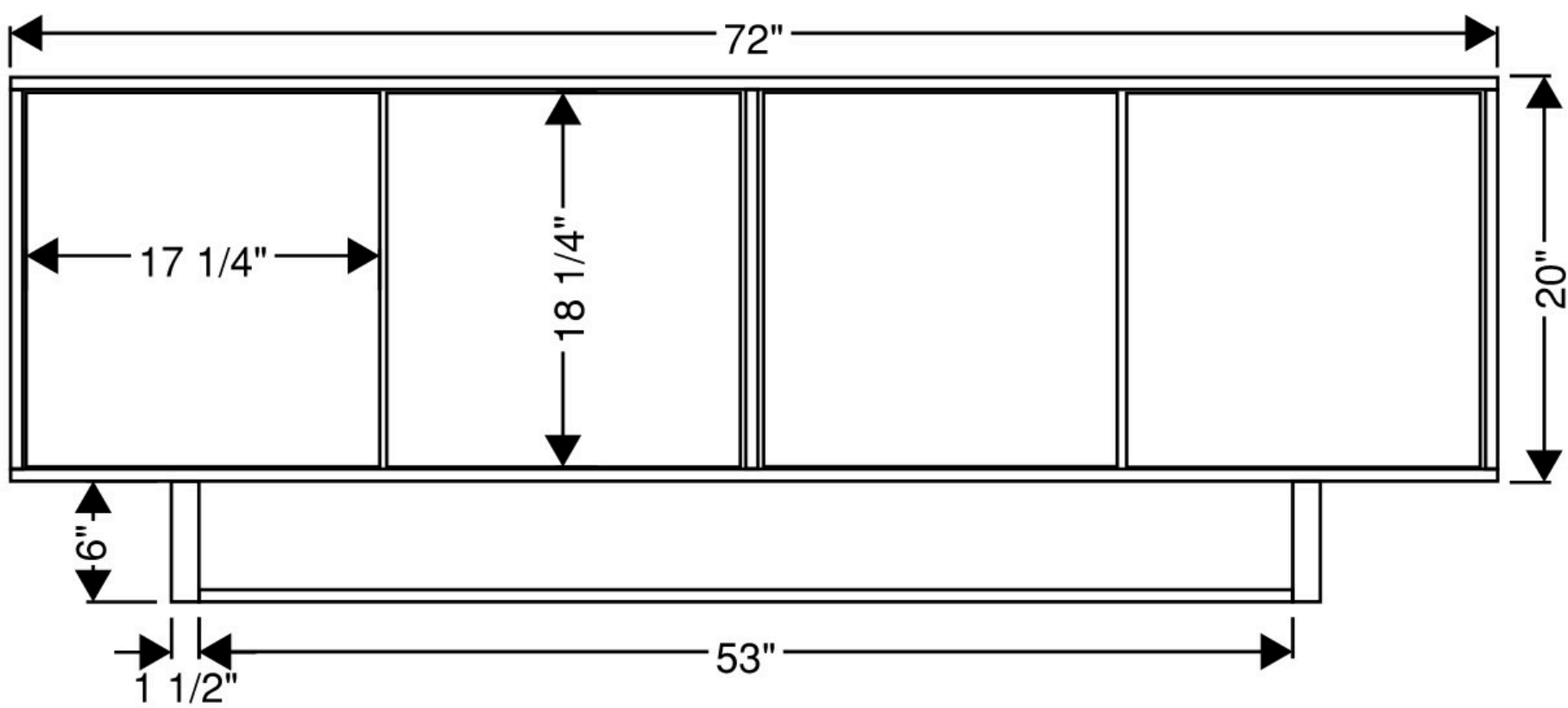

TV STAND DIMENSIONS

Directions

1

Cut Materials

Use the Kreg Rip Cut and a circular saw to cut all of the cabinet pieces from the sheet of 4'x8' plywood (see cut list images) and the doors from the edge glued pine panel.

Cut the pieces for the base from the 1"x2"x8' boards using a miter saw.

*Some hardware stores can cut large sheets of plywood down for easier transportation. Use the diagram to plan out cuts ahead of time to maximize material use.



2

Add Pocket Holes

Use a Kreg Pocket-Hole Jig and a drill to make pocket holes on the side and middle support pieces for the cabinet, as well as the 10 1/2" and 53" base pieces.

*I like to sand all of the pieces before assembling.

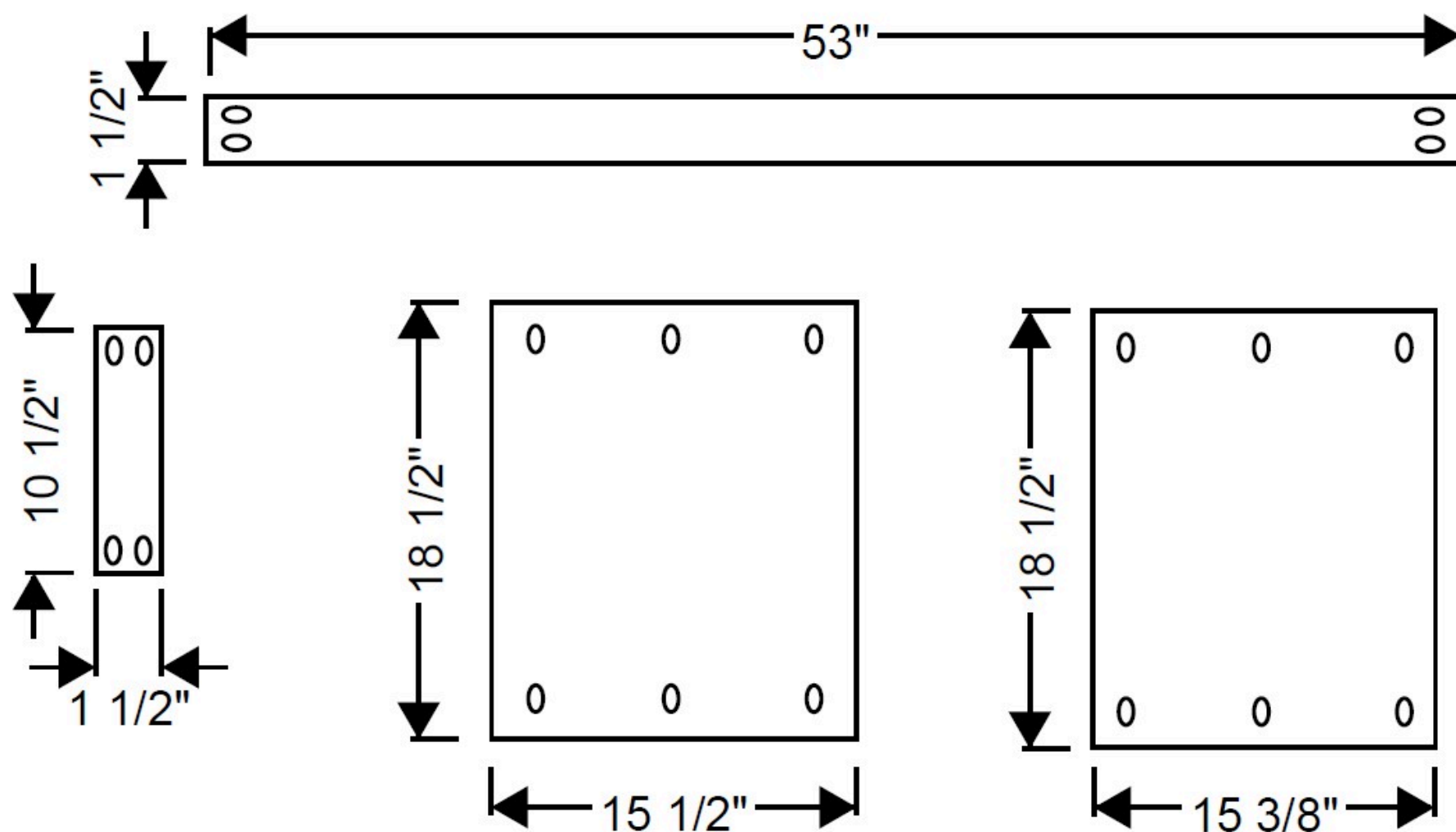

POCKET HOLE LOCATIONS

3

Assemble the Cabinet

Use the 1 1/4" pocket screws, clamps and wood glue to join the sides, top and bottom pieces. Make sure the pocket holes on the side pieces are facing the inside of the cabinet when assembling.

There is a 1/8" difference between the sides and the middle support to allow for the addition of the hard board back. Make sure that the middle support is flush with the front of the cabinet when installing. Measure and mark the middle of the cabinet (should be 35 1/4") and install the middle support using wood glue and pocket screws.

*optional: Use pocket hole plugs to fill the pocket holes on the inside of the cabinet.



4

Assemble the Base Part 1

Use clamps, wood glue and pocket screws to join two 6" and one 10 1/2" piece with the pocket holes facing out. Repeat for the base on the other side.

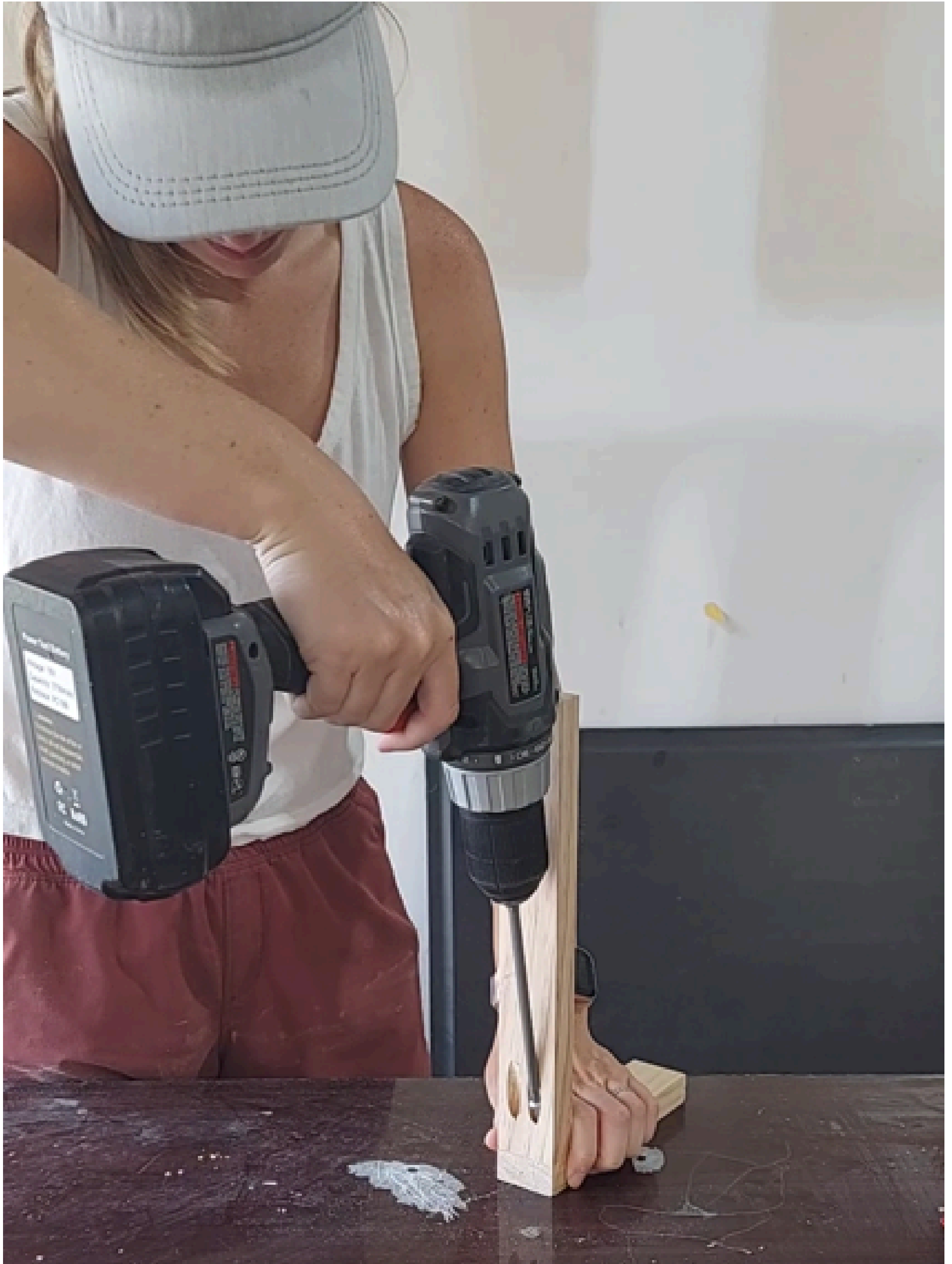

5**Install Base**

Measure and mark where the base will go:

-8 inches in from the side

-1 3/4 inches from the front and back

Drill pilot holes and install the base with wood glue and 1 1/4" wood screws (pocket holes facing the cabinet). Repeat on the other side.



6**Assemble the Base Part 2**

Use wood glue and pocket screws to add the remaining 10 1/2" base pieces between the two 6" base pieces on each side.

Measure and mark the middle of the bottom surface of the base (at 5 1/4"). Add the 53" piece in the center, between the legs making sure that the pocket holes will be facing the floor when the TV stand is in it's final upright position.



7

Add Edge Banding

Iron on the edge banding to the cabinet. Trim and lightly sand.



8**Use Concealed Hinge Jig**

Use the Kreg Concealed Hinge Jig and drill to prepare the doors. (Settings will depend on the hinges). Each door will have 2 hinges.



9**Stain or Paint**

Add 2 coats of gel stain and then a polycrylic topcoat. Read product directions for information on wait time between coats.

*Using a dark gel stain is a great option when building with plywood if you still want a visible wood grain.

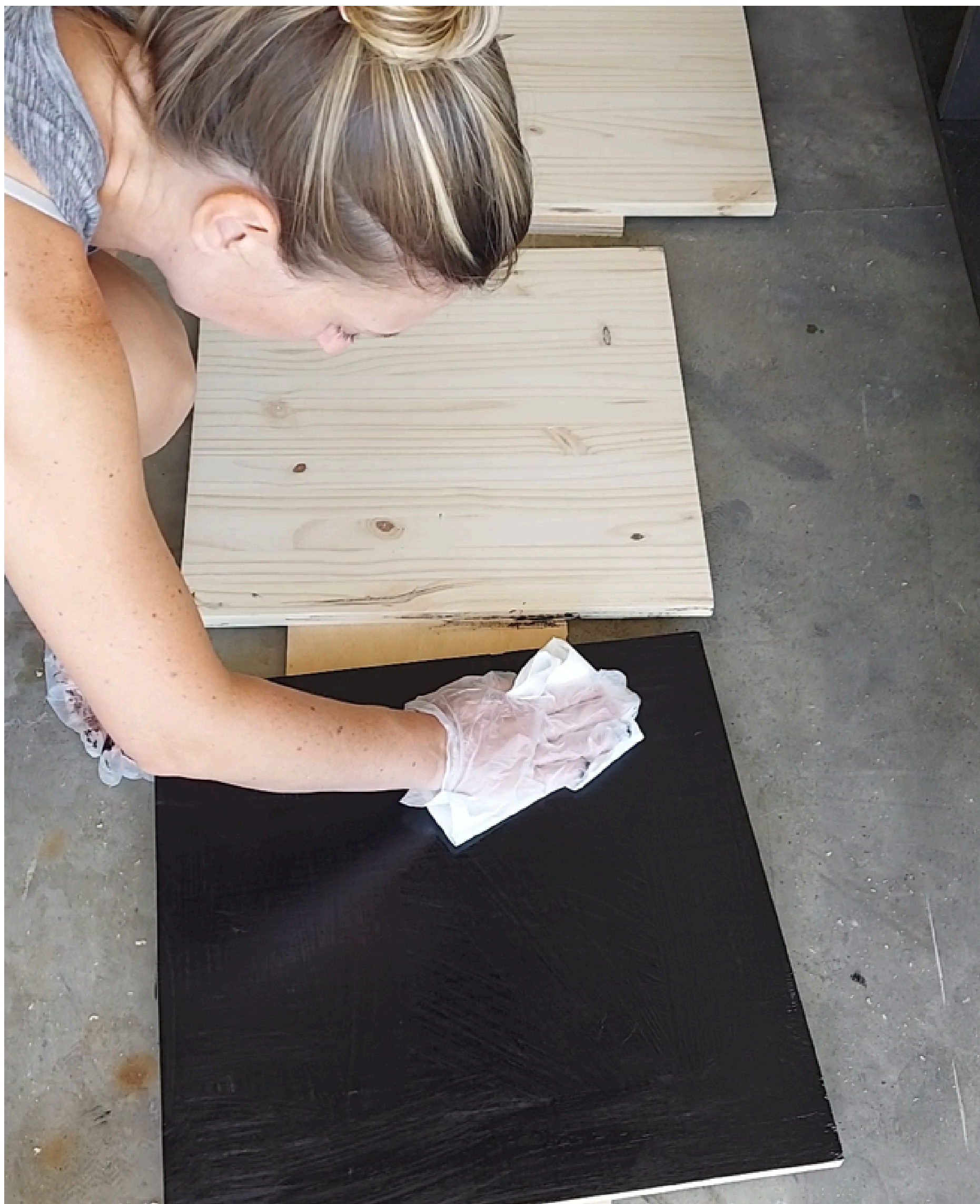

10**Install Doors**

Install the hinges and adjust according to the hinge specifications. This cabinet has been planned with a 1/8" spacing around the doors.

Install the magnetic push latch on the top surface of the cabinet according to the product directions.

**11****Install Cabinet Backing**

Use a rabbeting router bit at a depth of 1/8" along the inside ledge of the back of the cabinet to create room for the hardboard backing (1/4" wide). Cut the hardboard to size and use wood glue and brad nails to secure it in place.

*I find it easier to install the doors without the hardboard backing but feel free to do this step earlier in the building process if desired.