

Floating Wall Shelves with Gallery Rails

By **Built by Bec Designs**

Difficulty

Easy

This is a great beginner project for anyone who needs some extra storage, wants a place for their plant babies, storage for some books or a place to display their trinkets!

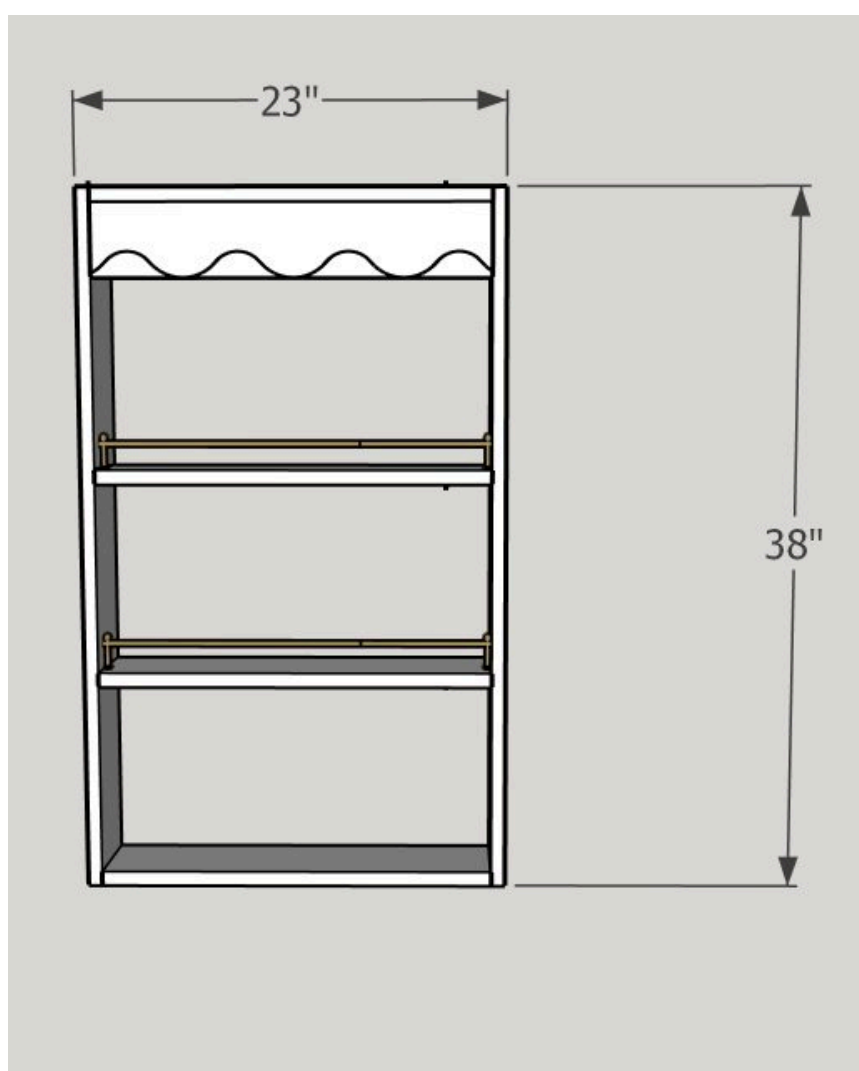



Tools

Kreg Tools

Kreg®
Pocket-
Hole Jig [Kreg® Pocket-Hole Jig 720PRO](#)
720PRO

Other Tools

Miter saw

Drill

Jigsaw

Table saw/circular saw

Materials

Wood Products

- 3** 1x6x8' , .75" X 5.25" X 96"
- 2** Gallery Rail , 20.5" Including Posts

Hardware & Supplies

- 25** Kreg Pocket Screws 1 1/4"
- 1** Super Glue
- 1** Stain Or Paint
- 3** Sandpaper - 80, 120 And 220
- 1** Wood Glue
- 2** Toggle Bolts For Wall Attachment

Cut List & Parts

- 2 Wall Shelf Sides , 3/4" X 5.25" X 38"
- 2 Top And Bottom , 3/4" X 5.25" X 21.5"
- 2 Shelves , 3/4" X 5.25" X 21.5"
- 1 Decorative Top , 3/4" X 4" X 21.5"
- 1 Wall Attachment Piece , 3/4" X 2.5" X 21.5"

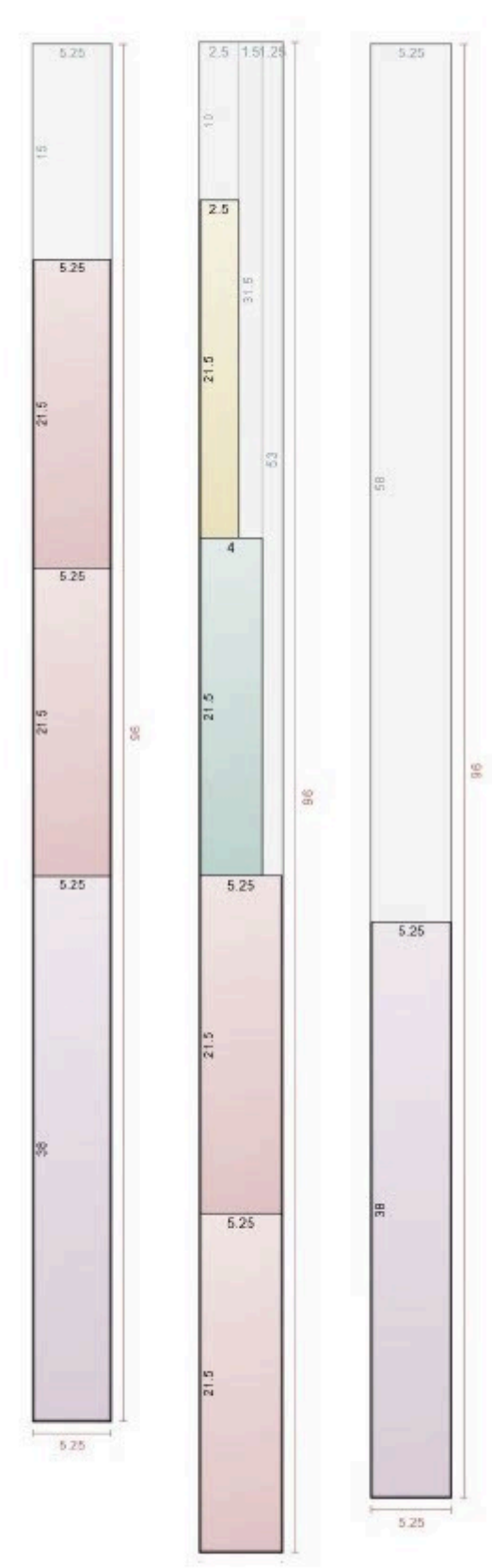

Directions

1

1

Attach the top and bottom pieces to the sides of the shelf with pocket holes and wood glue.

The pocket holes should be facing up at the top and down at the bottom.

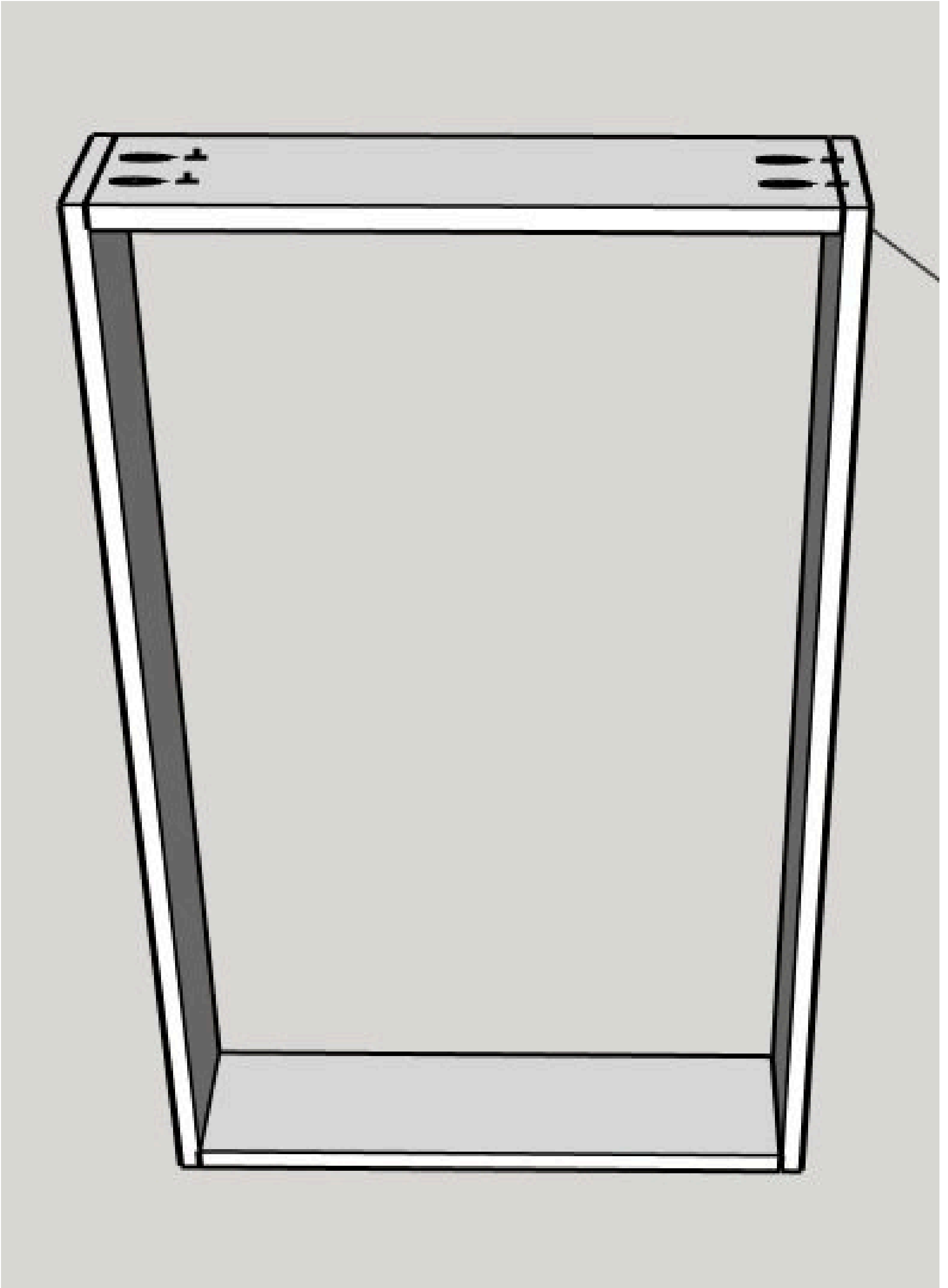

2**2**

Cut out the decorative top piece with a jigsaw.

I used random circular objects I had around the house to create the wave but you can really make any design you like for the top!

Attach the decorative top to the top of the shelf, underneath the top piece with wood glue and pocket screws.

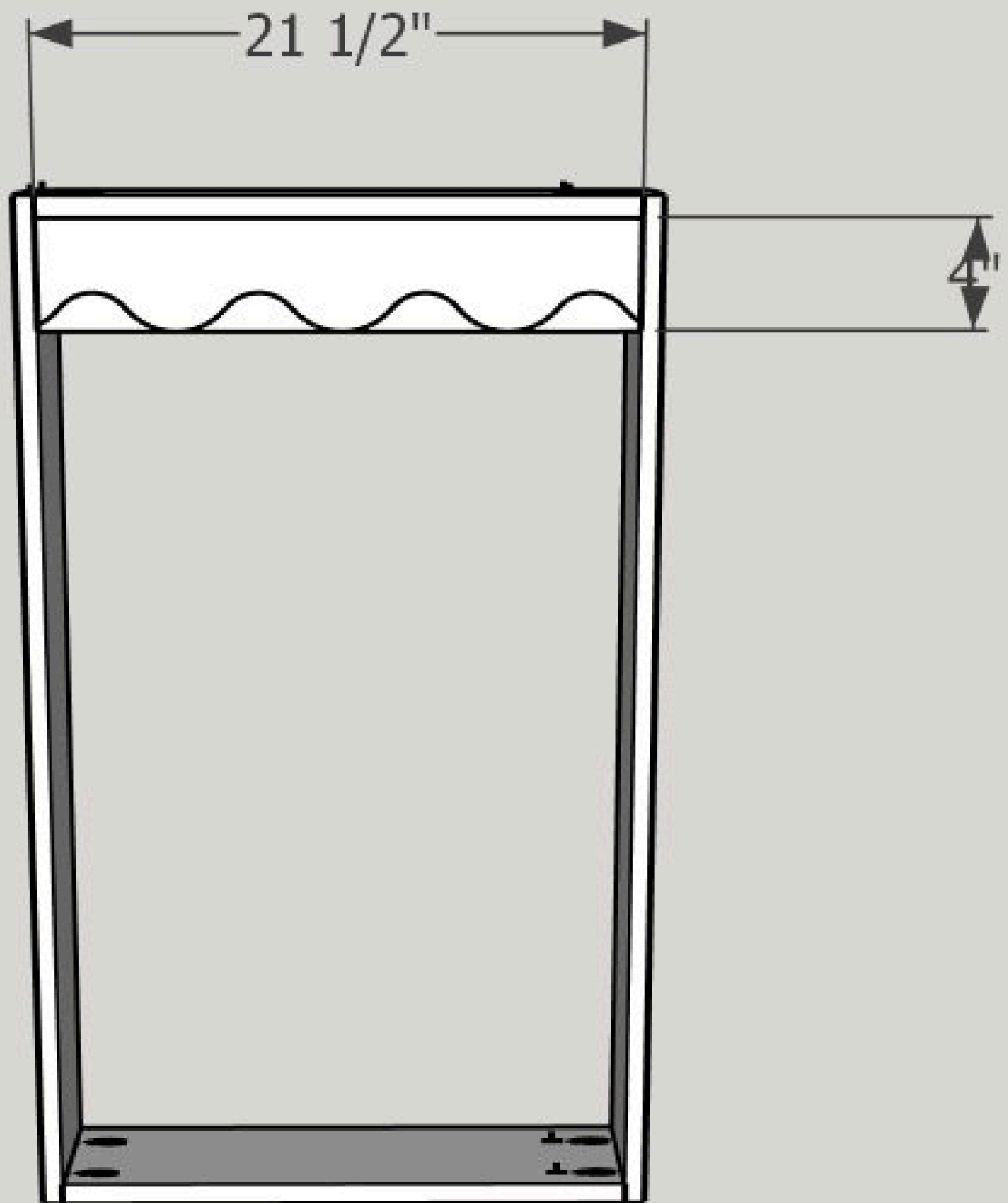

3**3**

Attach the shelves the same distance apart, measuring from the bottom of the decorative top piece.

Using a spacer block will make this step a lot easier!

Make sure the pocket holes are facing the bottom and screw the shelves into the sides with pocket holes and wood glue.

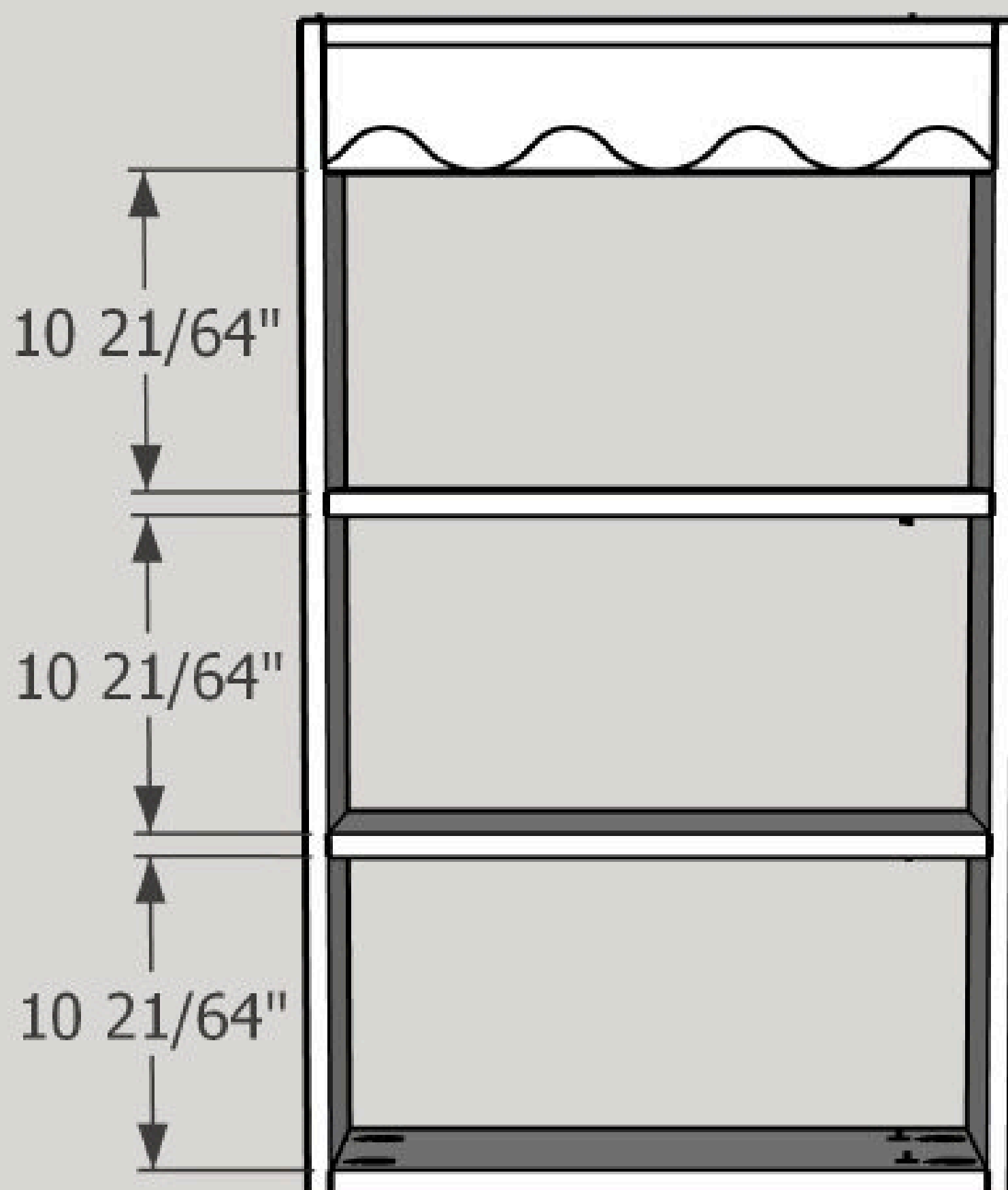

4

4

Screw in the wall shelf attachment to the back of the shelf with wood glue and pocket screws.

The wall shelf attachment should be 2.5" wide to allow room to screw into the wall.

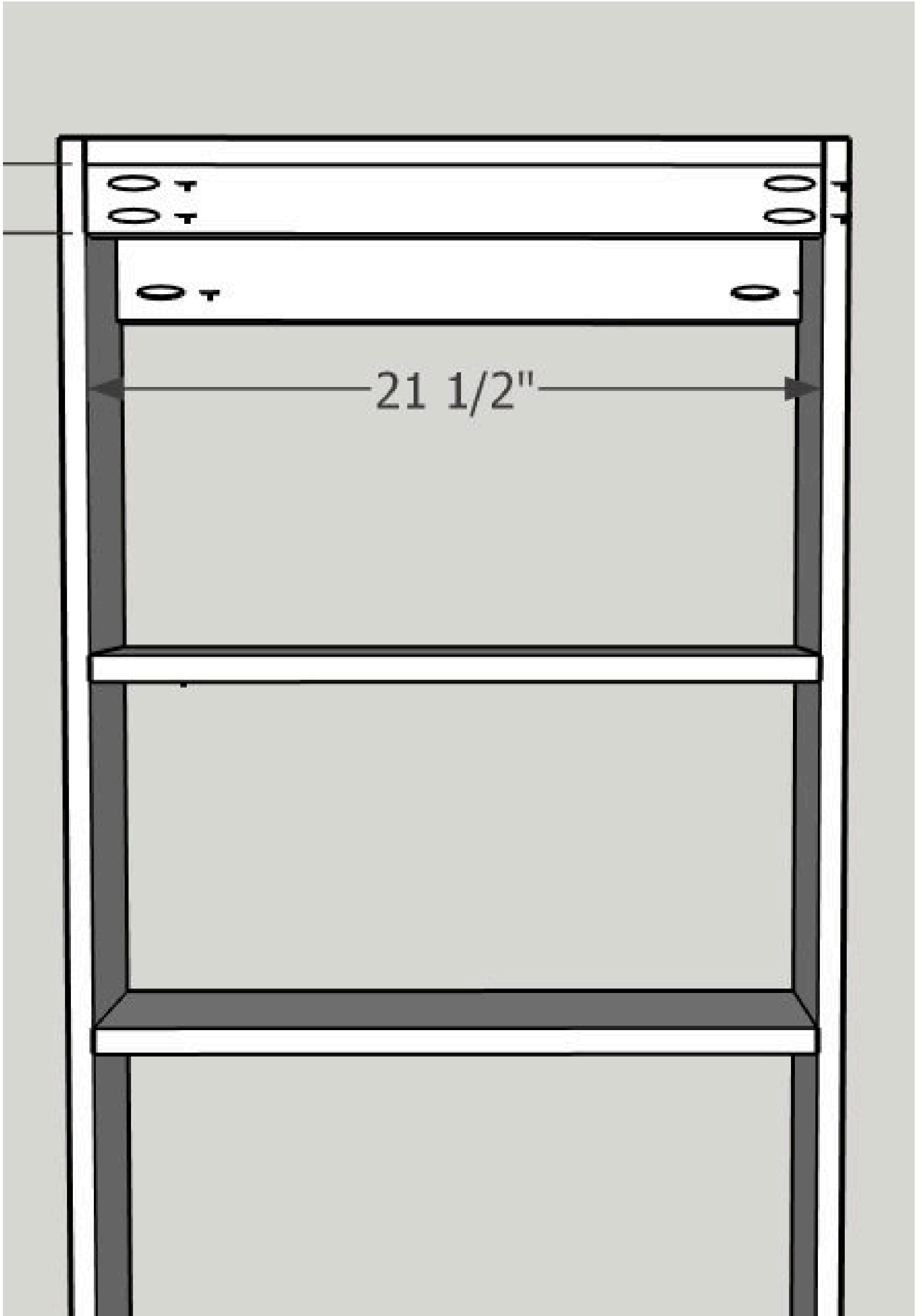

5

5

Sand from 80, to 120 and then 220. Finish with your favorite paint, stain and finish for durability.

6**6**

Glue the gallery rails to the two middle shelves. Use a dab of super glue and set the gallery rails about 1/2" back from the front of the shelves. Leave them to dry overnight.

This step is optional but definitely adds to the vintage charm of this shelf!

